

SURVEYOR'S CERTIFICATION

I, Jose L. Torres, certify that this project was completed under and responsible charge from an actual survey made under my that this ground survey was performed at the 95 percent cony sigma) to meet Federal Geographic Data Committee Standards; horizontal accuracy to 1:10,000+, that the vertical accuracy to that the original data was obtained on August 27, 2015; that completed on August 30, 2017; that contours shown meet the standard; all elevations are based on Finished Floor Elevation.

THE SURVEY CO-ORDINATES NOTED WERE DERIVED FROM GPS C BASED ON THE FOLLOWING:  
 1) CLASS OF SURVEY: CLASS C  
 2) POSITIONAL ACCURACY: MAXIMUM RESIDUAL 0.035 FT  
 3) TYPE OF GPS FIELD SURVEY: REAL TIME KINEMATIC VRS  
 4) DATE OF SURVEY: AUGUST 27, 2015  
 5) DATUM/EPOCH: NAD 83 NAVD 88  
 6) PUBLISHED/FIELD CONTROL CODE: NONE  
 7) GRID MODEL: GRID 12(CONUS)  
 8) COMBINED GRID FACTOR: 0.99994504  
 9) UNITS: US SURVEY FOOT  
 10) GPS INSTRUMENTATION: TRIMBLE 46 GNSS

CONSTRUCTION WASTE:  
 1. BY ORANGE COUNTY ORDINANCE, CLEAN WOOD WASTE, SCRAP METAL, AND CONCRETE, CARDBOARD; ALL PRESENT IN CONSTRUCTION WASTE MUST BE RECYCLED.  
 2. BY ORANGE COUNTY ORDINANCE, ALL HAULERS OF CONSTRUCTION WASTE MUST BE PROPERLY LICENSED.  
 3. PRIOR TO ANY DEMOLITION OR CONSTRUCTION ACTIVITY ON SITE, THE APPLICANT WILL HOLD A PRE-DEMOLITION/RE-CONSTRUCTION CONFERENCE WITH THE COUNTY'S SOLID WASTE STAFF. THIS MAY ME THE SAME MEETING HELD WITH OTHER DEVELOPMENT OFFICIALS.  
 4. THE PRESENCE OF ANY ASBESTOS CONTAINING MATERIAL (ACM) OR OTHER HAZARDOUS MATERIALS IN CONSTRUCTION AND DEMOLITION WASTE SHALL BE HANDLED IN ACCORDANCE WITH ANY AND ALL LOCAL, STATE, AND FEDERAL REGULATIONS AND GUIDELINES.

GENERAL NOTES:  
 1. TOPOGRAPHIC SURVEY INFORMATION PROVIDED BY RILEY SURVEYING, DATED AUGUST 27, 2015.  
 2. PRIOR TO BIDDING ON WORK AT THE SITE, THE CONTRACTOR SHALL VISIT THE SITE TO FIELD VERIFY THE EXISTING CONDITIONS.  
 3. PRIOR TO START OF WORK CONTRACTOR SHALL MEET WITH OWNER, ARCHITECT, & ENGINEER FOR A PRE-CONSTRUCTION MEETING.  
 4. NO WORK SHALL TAKE PLACE ON THE SITE UNTIL THE CONTRACTOR HAS CONTACTED NORTH CAROLINA B11 AND THE TOWN OF HILLSBOROUGH TO LOCATE UTILITIES.  
 5. ANY INTERRUPTION OF UTILITY SERVICE SHALL BE APPROVED AT LEAST 48 HOURS PRIOR TO WORK IN THAT AREA.  
 6. ANY SIGNIFICANT CHANGES IN ACTUAL SITE CONDITIONS FROM THOSE SHOWN ON THE PLANS SHALL BE BROUGHT TO THE ATTENTION OF THE ENGINEER OF RECORD.  
 7. ALL EXISTING WALKS, PAVEMENT, CURB, ETC. WHICH ARE DAMAGED DURING CONSTRUCTION SHALL BE REPAIRED TO MATCH EXISTING CONDITIONS.  
 8. ALL EXISTING FENCING, PAVEMENT, ETC. THAT IS REMOVED BY THE CONTRACTOR SHALL BE DISPOSED OF PROPERLY.  
 9. PROVIDE POSITIVE DRAINAGE AWAY FROM NEW AND EXISTING BUILDINGS.  
 10. CONTRACTOR STAGING AREAS SHALL BE RETURNED TO ORIGINAL CONDITION AT THE COMPLETION OF ALL WORK.  
 11. RESEED ALL DISTURBED AREAS AT COMPLETION OF ALL WORK.  
 12. ADJUST ALL EXISTING & NEW UTILITIES TO BE FLUSH WITH FINISHED GRADES, TYPICAL.  
 13. USE PAVEMENT PATCHING DETAIL FOR ALL UTILITY CUTS THROUGH EXISTING ASPHALT.  
 14. SAWCUT EXISTING ASPHALT ADJACENT TO PAVEMENT PATCHING.  
 15. NO WATERCOURSE OR 100-YEAR FLOOD PLAIN AS MAPPED BY F.E.M.A. OR AS DEFINED BY ANY FEDERAL, STATE, OR LOCAL AUTHORITY IS LOCATED ON THIS PROPERTY.

EXISTING CONDITONS LEGEND

- BOLLARD
- CURB INLET
- CATCH BASIN
- CLEAN OUT
- ⊕ FIRE HYDRANT
- LIGHT POLE
- ROOF DRAIN
- SANITARY SEWER MANHOLE
- WATER VALVE
- CHAINLINK FENCE
- SIGN
- FINISHED FLOOR ELEVATION
- HANDICAP ACCESS
- OVERHANG
- ELECTRIC MANHOLE
- ELECTRIC BOX
- TREE LINE
- EXISTING CONTOUR
- SURVEY LIMITS

DEMOLITION LEGEND

- ▨ DEMO CURB & GUTTER, SIDEWALK

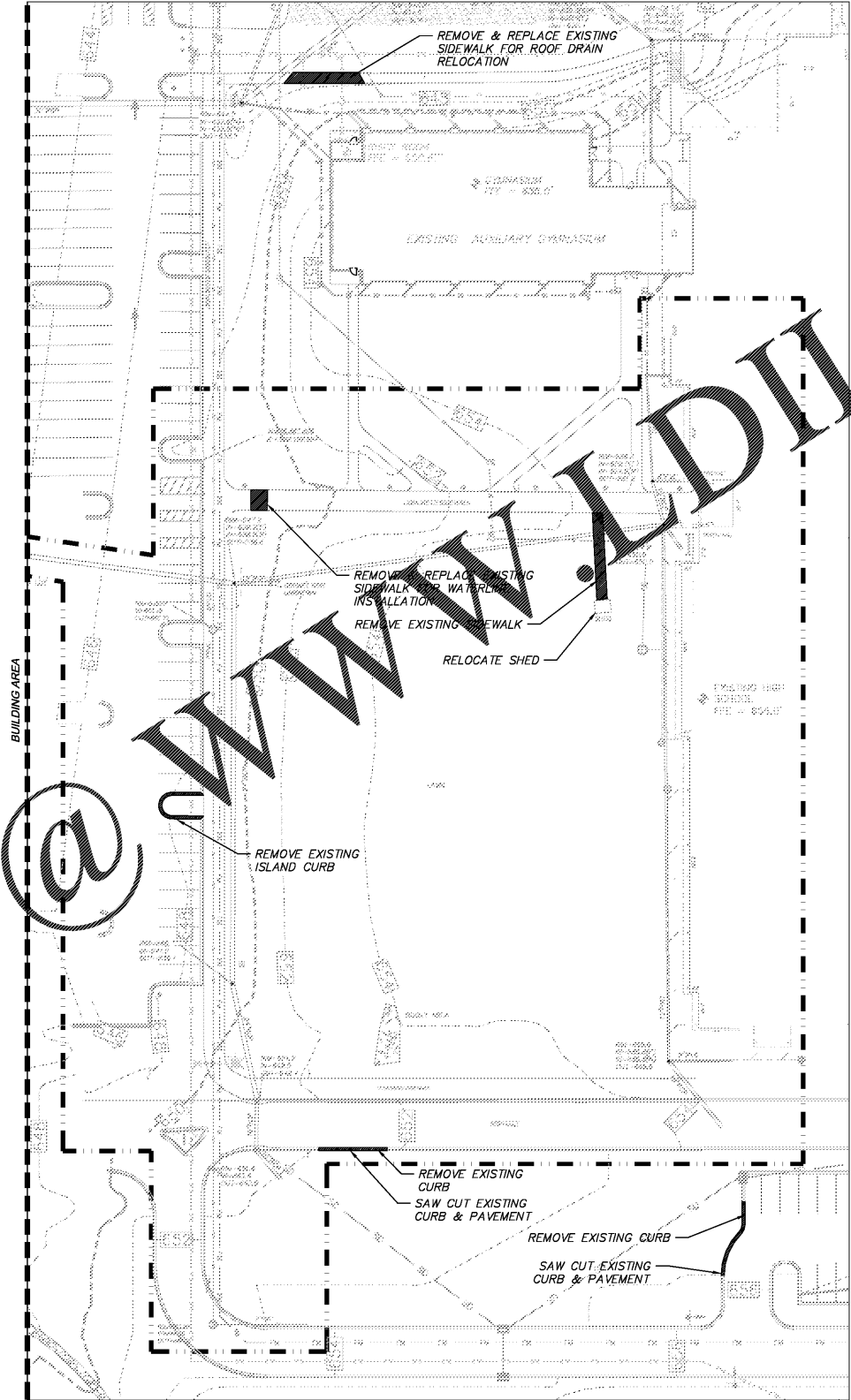
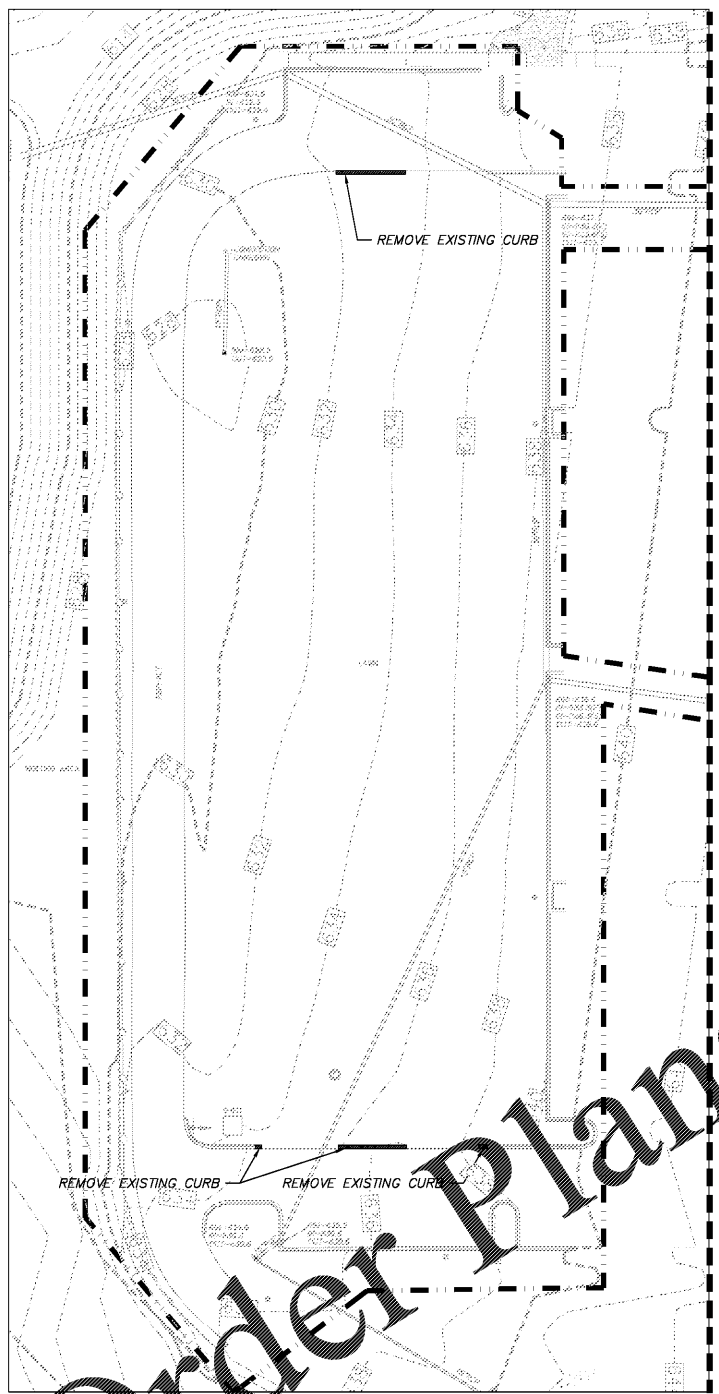

Order Plans

WWW.AJLDILING.COM

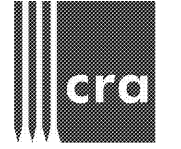

222 cloister court  
 chapel hill, nc 27514  
 919.401.8586  
 www.cra-ae.com

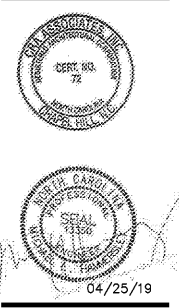

Cedar Ridge High School  
 Classroom Addition  
 Orange County Schools  
 1125 New Grady Brown School Road  
 Hillsborough, North Carolina

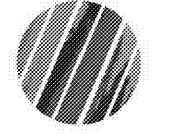

no. revisions

The use of these plans and specifications shall be restricted to the project for which they were prepared and publication thereof is expressly limited to such use. Re-use, reproduction, or publication by any method, in whole or in part, is prohibited. Title to the plans and specifications remain in the architect's office. All rights reserved. Please contact with these plans and specifications with the architect's office for any questions or the acceptance of these specifications.

drawn checked

C1.2  
 sheet  
 DEMOLITION  
 PLAN

project no. 1716

date 04/25/19

