

222 cloister court
 chapel hill, nc 27514
 919.401.8586
 www.cra-ae.com

SURVEYOR'S CERTIFICATION

I, Jose L. Torres, certify that this project was completed and responsible charge from an actual survey made in that this ground survey was performed at the 95 percent (95%) to meet Federal Geographic Data Committee Standard horizontal accuracy is 1:10,000+, that the vertical accuracy that the original data was obtained on August 27, 2015, completed on August 30, 2017; that contours shown on standard; all elevations are based on Finished Floor Elevation.

THE SURVEY CO-ORDINATES NOTED WERE DERIVED FROM BASED ON THE FOLLOWING:
 1) CLASS OF SURVEY: CLASS C
 2) POSITIONAL ACCURACY: MAXIMUM RESIDUAL 0.035 FT
 3) TYPE OF GPS FIELD SURVEY: REAL TIME KINEMATIC
 4) DATE OF SURVEY: AUGUST 27, 2015
 5) DATE/TIME: NAD 83 NAVD 88
 6) PUBLISHED/FIXED CONTROL USE: NO
 7) GRID MODEL: GEOID 12(COVUS)
 8) COMBINED GRID FACTOR: 0.9999
 9) UNITS: US SURVEY FOOT
 10) GPS INSTRUMENTATION: TRIMBLE GNSS

CONSTRUCTION WASTE:

1. BY ORANGE COUNTY ORDINANCE, CLEAN WOOD, METE, SCRAP METAL, AND CORRUGATED CARDBOARD, ALL PRESENT IN CONSTRUCTION WASTE MUST BE RECYCLED.
2. BY ORANGE COUNTY ORDINANCE, ALL HAULERS OF CONSTRUCTION WASTE MUST BE PROPERLY LICENSED.
3. PRIOR TO ANY DEMOLITION OR CONSTRUCTION ACTIVITY ON SITE THE APPLICANT WILL HOLD A PRE-DEMOLITION/PRE-CONSTRUCTION CONFERENCE WITH THE COUNTY'S SOLID WASTE STAFF. THIS MAY BE THE SAME MEETING HELD WITH OTHER DEVELOPMENT OFFICIALS.
4. THE PRESENCE OF ANY ASBESTOS CONTAINING MATERIAL ("ACM") OR OTHER HAZARDOUS MATERIALS IN CONSTRUCTION AND DEMOLITION WASTE SHALL BE HANDLED IN ACCORDANCE WITH ANY AND ALL LOCAL, STAT, AND FEDERAL REGULATIONS AND GUIDELINES.

GENERAL NOTES:

1. TOPOGRAPHIC SURVEY INFORMATION PROVIDED BY RILEY SURVEYING, DATED AUGUST 27, 2015.
2. PRIOR TO BIDDING ON WORK AT THE SITE, THE CONTRACTOR SHALL VISIT THE SITE TO FIELD VERIFY THE EXISTING CONDITIONS.
3. PRIOR TO START OF WORK CONTRACTOR SHALL MEET WITH OWNER, ARCHITECT, & ENGINEER FOR A PRE-CONSTRUCTION MEETING.
4. NO WORK SHALL TAKE PLACE ON THE SITE UNTIL THE CONTRACTOR HAS CONTACTED NORTH CAROLINA 811 AND THE TOWN OF HILLSBOROUGH TO LOCATE UTILITIES.
5. ANY INTERRUPTION OF UTILITY SERVICE SHALL BE APPROVED AT LEAST 48 HOURS PRIOR TO WORK IN THAT AREA.
6. ANY SIGNIFICANT CHANGES IN ACTUAL SITE CONDITIONS FROM THOSE SHOWN ON THE PLANS SHALL BE BROUGHT TO THE ATTENTION OF THE ENGINEER OF RECORD.
7. ALL EXISTING WALKS, PAVEMENT, CURB, ETC. WHICH ARE DAMAGED DURING CONSTRUCTION SHALL BE REPAIRED TO MATCH EXISTING CONDITIONS.
8. ALL EXISTING FENCING, PAVEMENT, ETC. THAT IS REMOVED BY THE CONTRACTOR SHALL BE DISPOSED OF PROPERLY.
9. PROVIDE POSITIVE DRAINAGE AWAY FROM NEW AND EXISTING BUILDINGS.
10. CONTRACTOR STAGING AREAS SHALL BE RETURNED TO ORIGINAL CONDITION AT THE COMPLETION OF ALL WORK.
11. RESEED ALL DISTURBED AREAS AT COMPLETION OF ALL WORK.
12. ADJUST ALL EXISTING & NEW UTILITIES TO BE FLUSH WITH FINISHED GRADES, TYPICAL.
13. USE PAVEMENT PATCHING DETAIL FOR ALL UTILITY CUTS THROUGH EXISTING ASPHALT.
14. SAWCUT EXISTING ASPHALT ADJACENT TO PAVEMENT PATCHING.
15. NO WATERCOURSE OR 100-YEAR FLOOD PLAIN AS MAPPED BY F.E.M.A. OR AS DEFINED BY ANY FEDERAL, STATE, OR LOCAL AUTHORITY IS LOCATED ON THIS PROPERTY.



04/25/19

Cedar Ridge High School
 Classroom Addition
 Orange County Schools
 1125 New Grady Brown School Road
 Hillsborough, North Carolina

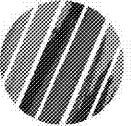

no.	revisions

The use of these plans and specifications shall be limited to the original site for which they were prepared and publication thereof is hereby prohibited in any form, in whole or in part, by reproduction, retransmission, or publication in any manner without the express written consent of the architect. The user of these plans and specifications shall be held responsible for their use and shall assume the responsibility for their use.

drawn checked

C1.0

sheet
OVERALL EXISTING CONDITIONS PLAN

project no. 1716

date 04/25/19

EXISTING CONDITIONS LEGEND

- BOLLARD
- ▣ CURB INLET
- ▣ CATCH BASIN
- ▣ CLEAN OUT
- FIRE HYDRANT
- LIGHT POLE
- ROOF DRAIN
- SANITARY SEWER MANHOLE
- WATER VALVE
- CHAINLINK FENCE
- SIGN
- FINISHED FLOOR ELEVATION
- HANDICAP ACCESS
- OVERHANG
- ELECTRIC MANHOLE
- ELECTRIC BOX
- TREE LINE
- EXISTING CONTOUR
- SURVEY LIMITS

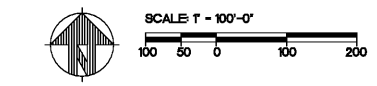

Order Plans @

WWW.LDILLING.COM

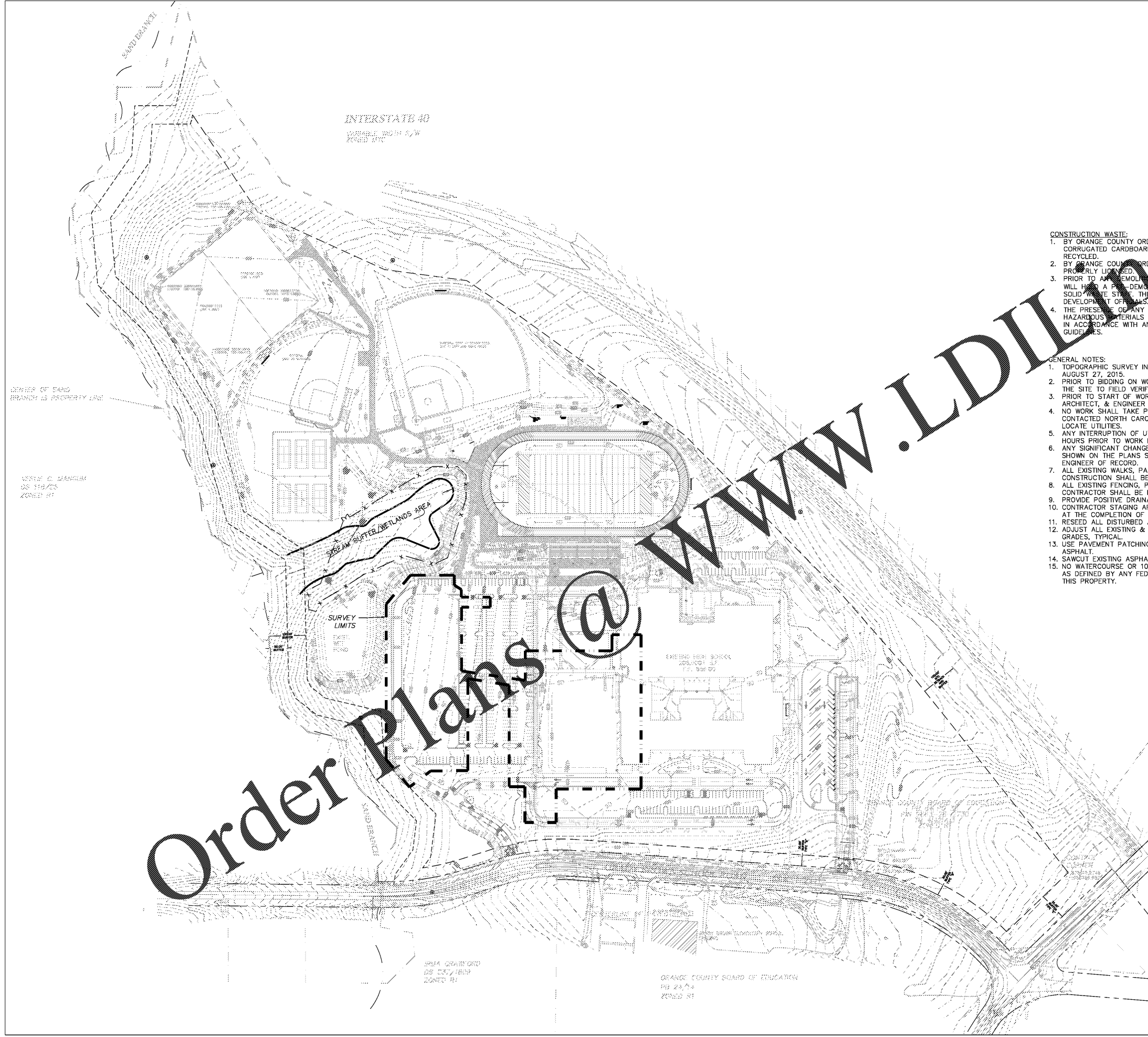

INTERSTATE 40
 VARIABLE WIDTH R/W
 POINTS 270'

CENTER OF SAND
 BRANCH IS PROPERTY LINE

WEST C. MANORUM
 DS 116/25
 ZONED RT

SURVEY LIMITS

EXISTING HIGH SCHOOL
 205,1001 SF
 17, 958 SQ

SMA GRABBER
 DS 127/1809
 ZONED RT

ORANGE COUNTY BOARD OF EDUCATION
 PG 24 OF 24
 ZONED RT