

- EXISTING CONDITIONS NOTES**
1. THE CONTRACTOR IS OBLIGATED TO INSPECT FOR EXISTING CONDITIONS/INSTALLATIONS AND AVAILABLE INFORMATION PRIOR TO SUBMITTING A BID, REFER TO SPECIFICATIONS ALSO.
 2. EXISTING INSTALLATIONS (SUCH AS WATER MAINS/LINES, GAS MAINS/LINES, SEWER MAINS/LINES, TELEPHONE LINES, POWER LINES, AND UTILITY STRUCTURES IN THE VICINITY OF THE WORK TO BE DONE) ARE INDICATED ON THE DRAWINGS ONLY TO THE EXTENT THAT SUCH INFORMATION HAS BEEN MADE AVAILABLE TO OR DISCOVERED BY THE ENGINEER IN PREPARING THE DRAWINGS. THERE IS NO GUARANTEE AS TO THE ACCURACY OR COMPLETENESS OF SUCH INFORMATION, AND ALL RESPONSIBILITY FOR THE ACCURACY AND COMPLETENESS THEREOF IS EXPRESSLY DISCLAIMED.
 3. THE CONTRACTOR SHALL BE SOLELY RESPONSIBLE FOR LOCATING ALL EXISTING INSTALLATIONS.
 4. ANY DELAY, ADDITIONAL WORK, FEES OR EXTRA COST TO THE CONTRACTOR CAUSED BY OR RESULTING FROM DAMAGE TO OR MODIFICATION OF EXISTING INSTALLATIONS BY THE CONTRACTOR OR AFFECTED UTILITY COMPANY SHALL NOT CONSTITUTE A CLAIM FOR EXTRA WORK, ADDITIONAL PAYMENT OR DAMAGES.
 5. THE CONTRACTOR SHALL FIELD VERIFY ALL EXISTING CONSTRUCTION PRIOR TO SUBMITTING HIS BID. NO EXTRAS WILL BE PAID DUE TO UNANTICIPATED EXISTING CONDITIONS/INSTALLATIONS.

**CONTRACTOR CAUTION!!!
VERIFY SEWER LINE ELEVATION**

BEFORE STARTING ANY BUILDING PAD GRADING AND PLUMBING WORK, THE CONTRACTOR SHALL FIELD VERIFY LOCATION, MATERIAL, CONDITION, ACCESSIBILITY (INCLUDING STATE HIGHWAY OR OTHER RIGHTS-OF-WAY) AND WORKABLE FLOW LINE ELEVATION OF THE EXISTING SANITARY SEWER SERVICE LINE OR MAIN.

IF A WORKABLE FLOW LINE HAS NOT BEEN ESTABLISHED AT THE TIME OF FINAL SANITARY SEWER SERVICE CONNECTION, THEN THE CONTRACTOR SHALL BE RESPONSIBLE FOR ALL EXPENSES ASSOCIATED WITH THE INSTALLATION OF A NEW GRINDER PUMP SYSTEM (LIBERTY PUMPS #D4896LSG203-36-S-FRPHD).
PHONE: (518) 346-6161 TO MEET OWNER AND LOCAL REQUIREMENTS.

TELEPHONE SERVICE REQUIREMENTS

SPECIAL NOTE: NEW PHONE SERVICE TO BUILDING SHALL BE AN UNDERGROUND SERVICE. CONTRACTORS TO SCHEDULE INSTALLATION OF U/G TELEPHONE SERVICE CONDUIT WITH OWNER. CONTACT (417) 874-7288.

CONTRACTOR SHALL CONTACT PHONE COMPANY AND VERIFY REQUIRED SIZE OF CONDUIT (2", 3" OR 4") PVC SCHEDULE 40 CONDUIT WITH RIGID GALVANIZED STEEL LONG SWEEP BENDS @ 18"-24" DEPTH FOR PHONE SERVICE. PROVIDE MINIMUM 1/4" POLYPROPYLENE PULL LINE. PLACE CONDUIT A MINIMUM OF 12" FROM U/G ELECTRIC CONDUIT IN SAME TRENCH.

CAP END OF CONDUIT AT PROPERTY LINE BELOW FINISHED GRADE AND INSTALL CABLE MARKER FOR PHONE COMPANY. IF NECESSARY, OTHERWISE, CONTINUE PHONE SERVICE CONDUIT TO A POLE AND INSTALL RIGID GALVANIZED STEEL CONDUIT A MINIMUM 10' (H.L.) ABOVE FINISHED GRADE ATTACHED TO POLE.

CONTRACTOR SHALL COORDINATE INSTALLATION AND VERIFY REQUIREMENTS WITH PHONE COMPANY. PLUS INCLUDE ALL FEES (IF ANY) BY PHONE COMPANY FOR INSTALLATION OF NO LESS THAN 10 PAIR CABLE, IN MENTIONED CONDUIT, TO CONTRACTOR INSTALLED 4' X 6' X 3/4" FIRE RETARDING BACKBOARD (IF PLYWOOD, PAINT BOARD W/FIRE RETARDING PAINT) WITHIN BUILDING. CONTRACTOR TO PROVIDE #6 AWG CU. GROUND TO TELEPHONE EQUIPMENT LOCATION FROM ELECTRICAL GROUNDING ELECTRODE SYSTEM. FINAL CONNECTIONS AND INSIDE PHONE WIRING BY OWNER.

ONLY IF UNDERGROUND PHONE SERVICE IS NOT AVAILABLE-THEN MAY CONTRACTOR INSTALL APPROPRIATE OVERHEAD PHONE SERVICE RISER, WEATHER HEAD, ETC. COORDINATE WITH OWNER & PHONE CO.

EXISTING FIRE HYDRANT LOCATION

THE NEAREST FIRE HYDRANT IS ROUGHLY 185 FEET SOUTH OF THE PROPERTY AS THE TRUCK TRAVELS, IN FRONT OF MCDONALD'S AT THE CORNER OF COUNTY LINE ROAD AND ARBOR TERRACE.

GENERAL NOTE:

PRIOR TO INSTALLATION, GENERAL CONTRACTOR SHALL CONFIRM THAT LIGHT POLES, LANDSCAPING AND UTILITIES DO NOT CONFLICT WITH SIGN LOCATION SHOWN. IF ANY POTENTIAL CONFLICT IS DISCOVERED, GENERAL CONTRACTOR SHALL CONTACT THE O'REILLY PROJECT ADMINISTRATOR BEFORE PROCEEDING.

EMS KEYNOTE

EMS / LIGHTING CONTROL PANEL. SEE EM SHEETS FOR MORE INFORMATION.

WATER METER LOCATIONS

SEE CIVIL SHEETS FOR WATER AND IRRIGATION METERS AND BACKFLOW DEVICE LOCATIONS.

STOP-CALL BEFORE YOU DIG!

811

UTILITIES CONTACTS:

ELECTRIC: ATHENS UTILITIES, RICHARD JOHNSON: 256-233-8750
TELEPHONE: AT&T, JOSHUA PRESCOTT: 256-532-8746
WATER: REFER TO CIVIL
SEWER: REFER TO CIVIL
GAS: REFER TO CIVIL

CONTRACTOR TO CONTACT UTILITY COMPANIES FOR TAPPING AND FINAL CONNECTION RESPONSIBILITIES.

NEW UTILITIES

W - WATER SERVICE
IR - IRRIGATION SERVICE
UGE - UNDERGROUND ELECTRIC
UGT - UNDERGROUND PHONE
S - SANITARY SEWER
OHE - OVERHEAD ELECTRIC
OHT - OVERHEAD PHONE
G - GAS SERVICE (BY GAS CO.)

SAW CUT
BORE
GRAVEL

P.O.C. = POINT OF CONNECTION BETWEEN SITE PIPING (SPEC 02700) AND BUILDING PIPING (SPEC 21 13 13, 22 00 00) LOCATED 5'-0" OUTSIDE BUILDING, AS NECESSARY
SPEC 21 13 13 DENOTES LANDSCAPE IRRIGATION.

STATE OF ALABAMA LIMITATION

I HEREBY CERTIFY THAT THESE ENGINEERING DOCUMENTS WERE PREPARED BY ME OR UNDER MY DIRECT PERSONAL SUPERVISION AND THAT I AM A DULY LICENSED PROFESSIONAL ENGINEER UNDER THE LAWS OF THE STATE OF ALABAMA.

Abby L. Thurman 5/10/19
ABBY L. THURMAN (DATE)

LICENSE RENEWAL DATE IS DECEMBER 31, 2019

PAGES OR SHEETS COVERED BY THE SEAL: US1, SP1, SP2, SP3, ME1, P1, P2, M1, M2, M3, E1, E2, E3 AND E4.

THE ABOVE-STATED DRAWINGS ARE VALID AND AUTHENTIC ONLY IF EACH COPIED SHEET BEARS THE SEAL, SIGNATURE, AND DATE AFFIXED TO THE ORIGINAL DRAWING BY THE ENGINEER.

THE AUTHORSHIP AND COPYRIGHT OF THE ABOVE STATED DRAWINGS AND SPECIFICATIONS REMAIN WITH SMITH-GOTH ENGINEERS, INC. NO CHANGES BY OTHERS ARE AUTHORIZED. THEY ARE AN INSTRUMENT OF SERVICE AND ARE INTENDED FOR USE ON THE INDICATED PROJECT ONLY. THEY SHALL NOT BE REPRODUCED OR USED FOR ANY OTHER WORK WITHOUT THE WRITTEN PERMISSION OF THE ENGINEER.

PAGES OR SHEETS DESIGNED BY OTHERS AND INCLUDED ONLY, FULL REFERENCE: EM1.0, EM1.1 AND EM1.2.

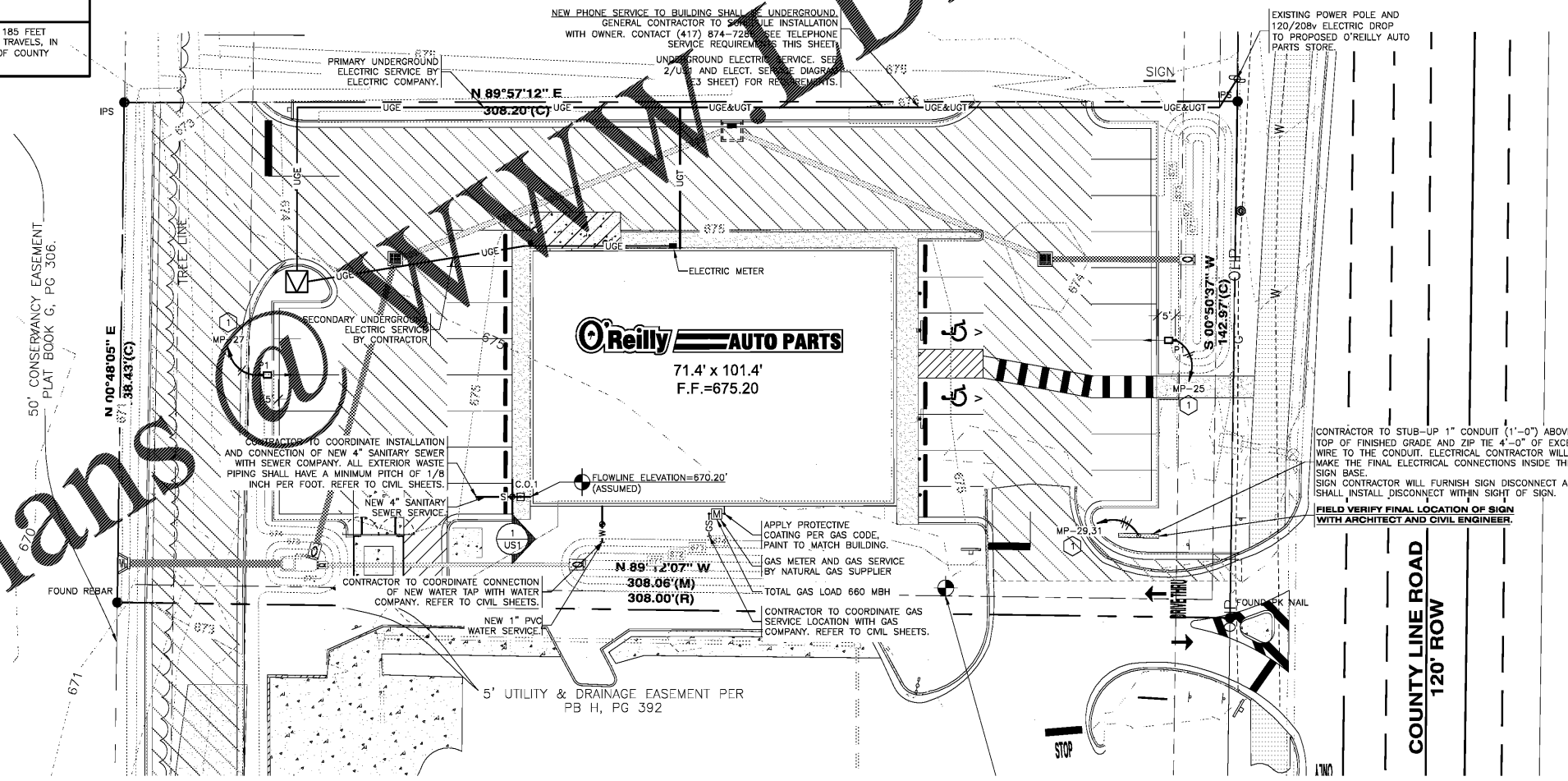

Order Plans

UTILITIES SITE PLAN

SCALE: 1" = 20'-0"

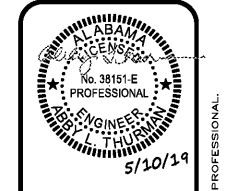

ENGINEER OF RECORD
ABBY L. THURMAN
ENGINEER LICENSE NUMBER
38151-E

SHEETS BEARING THIS SEAL ARE AUTHENTICATED. RESPONSIBILITY FOR ALL OTHER PLANS, SPECIFICATIONS OR INSTRUMENTS ARE DISCLAIMED.

SMITH-GOTH ENGINEERS, INC.
3885 S. JEFFERSON AVE. P.O. BOX 2200
SPRINGFIELD, MISSOURI 65782-1166
WWW.SMITHGOOTH.COM

PROJECT:
NEW O'REILLY AUTO PARTS STORE
11178 COUNTY LINE ROAD
MADISON, AL 35758

UTILITIES SITE PLAN

O'Reilly AUTO PARTS

CORPORATE OFFICES
235 SOUTH PATTERSON
SPRINGFIELD, MISSOURI 65802
(417) 862-6874 TELEPHONE

DRAWN BY: CEV
CHECKED BY: AT/BC
DATE: 05/10/2019
REVISION:

PROJECT NUMBER:
19098-MS3

SHEET NUMBER
US1