

Order Plans @

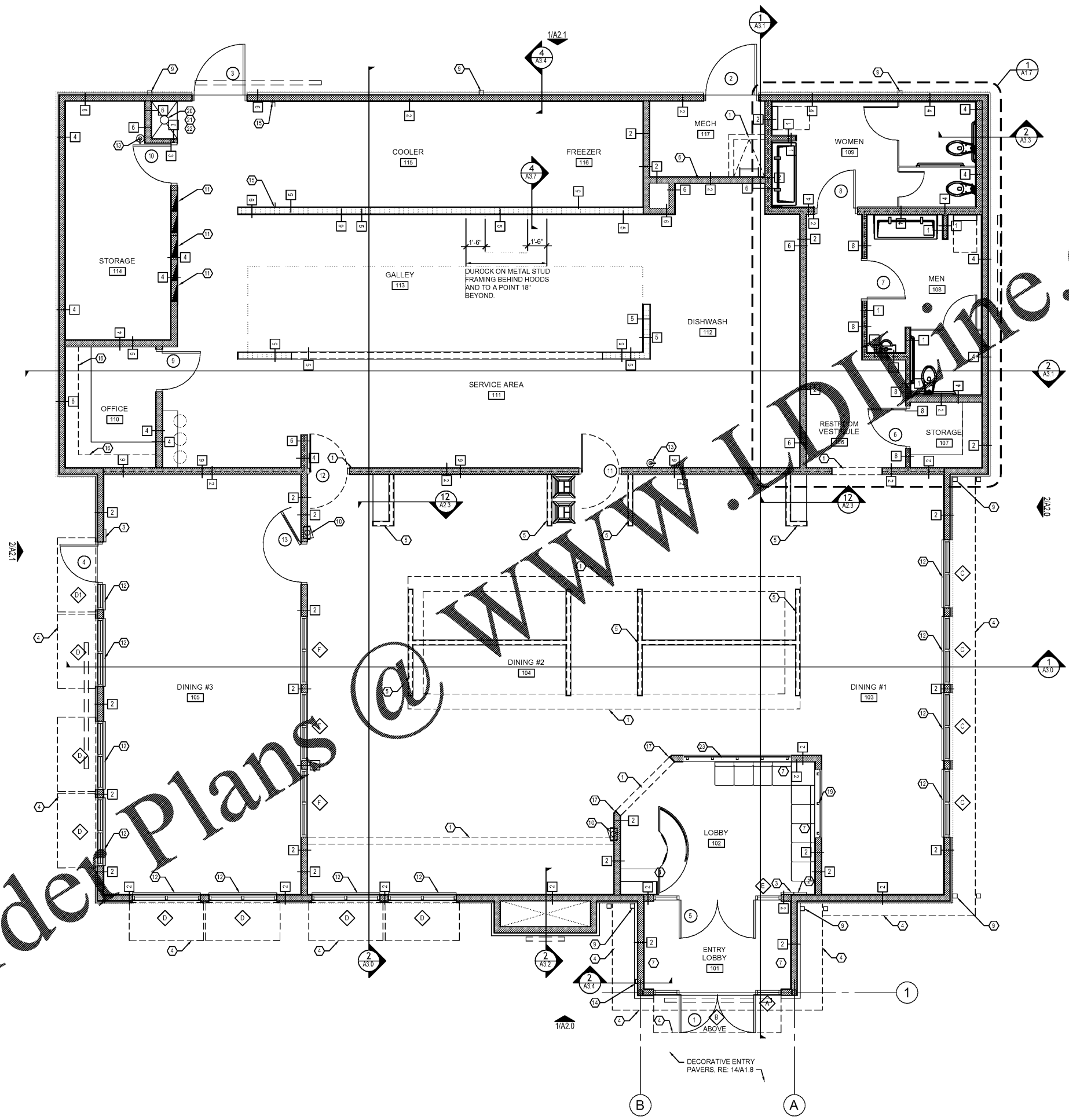

GENERAL NOTES									
1	REFER TO FINISH SCHEDULE PLAN AND ELEVATIONS FOR APPLIED FINISHES								
2	WALLS TO STRUCTURAL DECK MUST BE THOROUGHLY SEALED AROUND PENETRATIONS.								
3	REFER TO WALL TYPE SCHEDULE BELOW FOR WALLS.								
4	PROVIDE WATER RESISTANT GYPSUM BOARD AT KITCHEN AND RESTROOM WALL SURFACES.								
KEY NOTES									
1	LINE OF BULKHEAD ABOVE, RE: A1.4								
2	OCCUPANCY LOAD SIGN, VERIFY LOCATION WITH FIRE MARSHAL PRIOR TO INSTALL								
3	TACTILE 'EXIT ROUTE' SIGN, VERIFY FINAL LOCATION AND WORDING WITH FIRE MARSHAL PRIOR TO INSTALL								
4	LINE OF ROOF OVERHANG/AWNING ABOVE								
5	LOW WALL PROVIDED BY MILLWORK								
6	6" CONCRETE CURB, RE: STRUCTURAL								
7	WAITING BENCH BY MILLWORK								
8	HOSTESS COUNTER BY MILLWORK								
9	DOWNSPOUT RE: 15/A3.6								
10	FIRE EXTINGUISHER CABINET RE: 2/A3.7								
11	ELECTRICAL PANEL RE: ELECTRICAL								
12	WINDOW ROLLER SHADE, PROVIDED AND INSTALLED BY GC OVER EXTERIOR WINDOWS								
13	WALL MOUNTED FIRE EXTINGUISHER, COORDINATE FINAL LOCATION WITH FIRE MARSHAL. (PROVIDE 'K' TYPE EXTINGUISHER AT KITCHEN)								
14	KNOX BOX, VERIFY LOCATION WITH FIRE MARSHAL PRIOR TO INSTALL								
15	METAL CLOSURE STRIP BY KEC								
16	OFFICE CABINETS BY MILLWORK, RE: INTERIOR ELEVATIONS								
17	3/4" CLEAR PLASTIC CORNER GUARDS FROM CHAIR RAIL TO TOP OF OPENING								
18	NOT USED								
19	WOOD SLAT DIVIDER BY MILLWORK								
20	MOP SINK								
21	MOP RACK BY KEC								
22	CLEANING PRODUCT RACK BY OWNER								
23	BUBBLE SCREEN BY MILLWORK, RE: 15/A2.4								
WALL LEGEND									
[Symbol]	FULL HEIGHT WALLS/ WALL INFILL								
[Symbol]	PARTIAL HEIGHT WALLS								
[Symbol]	COOLER/FREEZER WALL, BY K.E.C.								
[Symbol]	WALL WITH SOUND ATTENUATING INSULATION								
[Symbol]	FULL HEIGHT METAL STUD WALL								
WALL TYPE SCHEDULE									
MATERIALS	1	2	3	4	5	6	7	8	9
FRAMING									
2x4 WOOD STUDS	●	●	●	●	●	●	●	●	●
2x6 WOOD STUDS	●	●	●	●	●	●	●	●	●
6" METAL STUDS									
LOW WALL									
5/8" GYPSUM BOARD	●	●	●	●	●	●	●	●	●
5/8" DUROCK									
5/8" BACKER BOARD TO 12" A.F.F.	●	●	●	●	●	●	●	●	●
5/8" PLYWOOD									

L/P
 2138 N Cleveland Massillon Rd
 Akron, Ohio 44333
 3303.609.3161
 www.lorenzpartners.com

L/P Architecture
 USE OF DOCUMENTS: Drawings, specifications and other documents prepared by the Architect are instruments of the profession. They are to be used only with respect to the Project. They are not to be used for any other Project, in any other medium, in any other form, in any other location, in any other manner, without the written consent of the Architect.

IHOPE

05/07/2019

PROJECT NO.:
 DRAWN BY: L+P
 CHECKED BY: L+P
 ISSUED DATE: 05.07.19

ISSUED REVISIONS:

3070 Highland Pte. Dr.
 Owensboro, KY 42303

IHOPE
 Rise and Shine Prototype
 Noted Floor Plan