

EROSION AND SEDIMENT CONTROL NOTES:

- 1.) SITE DESCRIPTION:
 - A.) FUNCTION OF THE PROJECT
THE SUBJECT PROPERTY IS LOCATED IN OWENSBORO, KENTUCKY IN DAVIESS COUNTY AND KNOWN AS HIGHLAND POINTE LOT 7 (380 HIGHLAND POINTE DRIVE).
 - B.) SIGNIFICANT ACTIVITIES
THE DEVELOPER PROPOSES TO DEVELOP THE SITE TO ACCOMMODATE THE SUBJECT RESTAURANT, ASSOCIATED PARKING, UTILITIES, AND STORM DRAINAGE.
 - C.) ESTIMATE OF AREA TO BE DISTURBED AREA:
APPROXIMATELY 1.10 ACRES.
 - D.) DESCRIPTION OF THE WATER QUALITY CLASSIFICATION OF RECEIVING WATER(S):
THE RECEIVING BODY OF WATER IS A TRIBUTARY OF HORSE FORK.
- 2.) SITE MAP:
A-K.) SEE THIS SHEET.
- 3.) OTHER INDUSTRIAL ACTIVITIES
A.) NO DISCHARGES ARE PROPOSED FROM INDUSTRIAL ACTIVITIES.
- 4.) DOCUMENTATION OF STORMWATER CONTROLS TO REDUCE POLLUTANTS:
 - A.) DOCUMENTATION OF EROSION PREVENTION MEASURES
PERIMETER CONTROL MEASURES ARE TO BE INSTALLED BY THE CONTRACTOR PRIOR TO DISTURBANCE OF SOILS IN THE GENERAL VICINITY OF THE ADJOINING PROPERTIES AS SHOWN.

SILT FENCE CONTROLS SHALL BE INSTALLED IN THE LOCATIONS SHOWN HEREON. THE SILT FENCE SHALL MEET OR EXCEED CURRENT STANDARDS ESTABLISHED BY LOCAL OFFICE OF STORMWATER MANAGEMENT. ALL CONSTRUCTION, INSTALLATION, AND MAINTENANCE DETAILS FOR PERIMETER CONTROLS SHOWN HEREON CAN BE FOUND IN THE BOWLING GREEN BEST MANAGEMENT PRACTICES MANUAL.

WHERE POSSIBLE NATURAL BUFFERS (i.e. TREE LINES, FENCE ROWS, ETC.) SHOULD REMAIN UNDISTURBED TO PROVIDE NATURAL SEDIMENT AND EROSION CONTROL. AREAS OF NATURAL BUFFER ARE SHOWN.

LOCAL REQUIREMENTS REQUIRE THAT ALL PERIMETER CONTROLS SHALL BE INSTALLED PRIOR TO MOBILIZATION OF EQUIPMENT AND START OF CONSTRUCTION.

DUST EROSION SHALL BE PREVENTED BY APPLYING WATER IN ACCORDANCE WITH GOOD HOUSEKEEPING PRACTICE GHP-16.

CONTRACTOR WILL BE REQUIRED TO INSTALL A STABILIZED CONSTRUCTION ENTRANCE AS TYPICALLY REQUIRED TO PREVENT TRACKING OF SOILS ONTO THE PUBLIC ROADWAYS.

 - B.) STABILIZATION
SEEDING AND MULCHING SHALL BE INSTALLED IN ALL DISTURBED AREAS UNLESS LANDSCAPING OR OTHER STABILIZATION METHODS ARE PROPOSED. SEEDING SHALL BEGIN WITHIN 14 DAYS ON AREAS OF THE SITE WHERE CONSTRUCTION ACTIVITIES HAVE TEMPORARILY OR PERMANENTLY CEASED FOR 21 DAYS OR MORE. DURING IN CLIMATE WEATHER SEEDING SHOULD BEGIN AS SOON AS SITE CONDITIONS PERMIT. SEVERAL INSTALLATION METHODS ARE ACCEPTABLE FOR APPLICATION OF SEED INCLUDING HYDRO-SEEDING OR SEEDING WITH BLOWN STRAW MULCH.
 - C.) LIMITATION OF THE TIME BARE SOIL IS EXPOSED
AREAS SHOULD BE LEFT UNDISTURBED UNTIL CONSTRUCTION ACTIVITIES ARE REQUIRED.
 - D.) CONTROL AND TRAPPING OF SEDIMENT
THE CONTROL OF SEDIMENT WILL BE VIA SILT FENCES AS PREVIOUSLY DESCRIBED. THE PROPOSED CONSTRUCTION ACTIVITY AND GENERAL FLATNESS OF THE TOPOGRAPHY WILL NOT WARRANT THE USE OF A SEDIMENT BASIN OR SILT TRAPS.
 - E.) SITE PRACTICES
 - CONSTRUCTION MATERIALS SHALL BE HANDLED, STORED, MAINTAINED, AND DISPOSED OF PROPERLY TO AVOID CONTAMINATION OF RUNOFF TO THE MAXIMUM EXTENT PRACTICABLE.
 - PROTECT CONSTRUCTION MATERIALS, CHEMICALS, AND LUBRICANTS FROM EXPOSURE TO RAINFALL.
 - PREVENT LITTER, CONSTRUCTION DEBRIS, AND CONSTRUCTION CHEMICALS FROM ENTERING RECEIVING WATERS.
 - LIMIT EXPOSURE OF FRESHLY PLACED CONCRETE TO RAINFALL THAT RESULTS IN RUNOFF.
 - SEGREGATE STORMWATERS AND OTHER WASTEWATERS FROM FUELS, LUBRICANTS, SANITARY WASTES, AND OTHER CHEMICALS SUCH AS PESTICIDES, HERBICIDES, AND FERTILIZERS TO PREVENT RUNOFF BEING CONTAMINATED.
 - NEATLY AND ORDERLY STORE CHEMICALS, PESTICIDES, HERBICIDES, FERTILIZERS AND FUELS.
 - PROMPTLY COLLECT AND MANAGE TRASH AND SANITARY WASTE.
 - PROMPTLY CLEANUP SPILLS OF LIQUIDS AND SOLID MATERIALS THAT COULD CAUSE POLLUTANTS.
 - REGULARLY REMOVE OFF-SITE ACCUMULATIONS OF SEDIMENT.
 - F.) ALTERNATE PROTECTIVE PRACTICES
THE CONTRACTOR IS SOLELY RESPONSIBLE FOR SEDIMENT CONTROL. THE CONTRACTOR SHALL REFER TO THE "KENTUCKY BEST MANAGEMENT PRACTICES (BMPs) FOR CONTROLLING EROSION, SEDIMENT, AND POLLUTANTS RUNOFF FROM CONSTRUCTION SITES" PLANNING AND TECHNICAL SPECIFICATIONS MANUAL IN THE EVENT THAT ADDITIONAL BMP MEASURES ARE REQUIRED TO CONTROL SITE RUNOFF OF SILT AND/OR POLLUTANTS.
 - G.) SEQUENCE OF MAJOR STORMWATER CONTROLS
SILT FENCES WILL BE INSTALLED AS NEEDED AND IN THE LOCATIONS SHOWN HEREON.
- 5.) MAINTENANCE OF STORMWATER CONTROLS:
 - A.) SILT FENCE SHALL BE CLEANED BEFORE SEDIMENT BUILDS TO 1/3 OF THE SILT FENCE HEIGHT.
 - B.) ROCK ON THE STABILIZED CONSTRUCTION ENTRANCE SHALL BE REPLACED AS REQUIRED TO PREVENT TRACKING OF SOILS ONTO THE PUBLIC ROADWAYS.
 - C.) INLET SEDIMENT CONTROLS SHALL BE REPAIRED AND/OR REPLACED AS REQUIRED TO PREVENT SEDIMENT FROM ENTERING PUBLIC STORM SYSTEMS.
- 6.) NON-STORM WATER DISCHARGE MANAGEMENT:
THE PROPOSED SITE HAS SEPARATE SANITARY AND STORM WATER SYSTEMS AND THERE ARE NO ANTICIPATED NON-STORMWATER DISCHARGES TO THE WATERS OF THE COMMONWEALTH.
- 7.) INSPECTION:
 - A.) QUALIFIED PERSONNEL SHALL INSPECT ALL STORM WATER CONTROL MEASURES, DISCHARGE LOCATIONS, VEHICLE EXITS, DISTURBED AREAS OF CONSTRUCTION, AND MATERIAL STORAGE AREAS
 - AT LEAST ONCE EVERY SEVEN (7) CALENDAR DAYS OR
 - AT LEAST ONCE EVERY FOURTEEN (14) CALENDAR DAYS, AND WITHIN 24 HOURS AFTER ANY STORM EVENT OF 0.5 INCHES OR GREATER. (KYDOW RECOMMENDS THAT THE PERMIT HOLDERS PERFORM A "WALK THROUGH" INSPECTION OF THE CONSTRUCTION SITE BEFORE ANTICIPATED STORM EVENTS.)
 - B.) AREAS THAT HAVE BEEN TEMPORARILY OR FINALLY STABILIZED AT LEAST ONCE A MONTH UNTIL THE COVERAGE HAS BEEN TERMINATED.
 - C.) INSPECTIONS SHALL BE PERFORMED BY PERSONNEL KNOWLEDGEABLE AND SKILLED IN ASSESSING CONDITIONS AT THE CONSTRUCTION SITE THAT COULD IMPACT STORMWATER QUALITY AND ASSESSING THE EFFECTIVENESS OF EROSION PREVENTION MEASURES, SEDIMENT CONTROLS MEASURES, AND OTHER SITE MANAGEMENT PRACTICES. INSPECTORS SHALL HAVE TRAINING IN STORMWATER CONSTRUCTION MANAGEMENT SUCH AS KEFSC, CEPSC, CPSWQ, TNPSIC, CESSWI, OR OTHER SIMILAR TRAINING.
 - D.) INSPECTORS SHALL CONDUCT VISUAL INSPECTIONS ADDRESSING PROPER INSTALLATION, MAINTENANCE, AND EFFECTIVENESS OF BMPs.
 - E.) VISUAL INSPECTION SHALL COMPRISE A MINIMUM EROSION PREVENTION MEASURES, SEDIMENT CONTROL MEASURES, SITE MANAGEMENT PRACTICES, DISTURBED AREAS, AREAS USED FOR STORAGE, AND DISCHARGE POINTS.

CONTROL MEASURES SHALL BE INSPECTED TO ENSURE CORRECT OPERATION. ACCESSIBLE DISCHARGE LOCATIONS SHALL BE INSPECTED TO ENSURE THAT VELOCITY DISSIPATION DEVICES ARE EFFECTIVE IN PREVENTING SIGNIFICANT IMPACTS TO RECEIVING WATERS. VEHICLE EXITS SHALL BE INSPECTED FOR EVIDENCE OF OR THE POTENTIAL FOR OFF-SITE SEDIMENT TRACKING. DISTURBED AREAS, MATERIAL STORAGE AREAS THAT ARE EXPOSED TO PRECIPITATION SHALL BE INSPECTED FOR EVIDENCE OF OFF-SITE POTENTIAL FOR POLLUTANTS ENTERING THE DRAINAGE SYSTEM.

 - F.) A REPORT SUMMARIZING THE SCOPE OF THE INSPECTION, NAMES AND QUALIFICATIONS OF PERSONNEL MAKING THE INSPECTION, THE DATE OF THE INSPECTION, MAJOR OBSERVATIONS RELATING TO THE IMPLEMENTATION OF THE BMP PLAN, AND ANY CORRECTIVE ACTIONS TAKEN SHALL BE MADE AND KEPT AS PART OF THE BMP PLAN FOR AT LEAST THREE (3) YEARS AFTER THE DATE OF INSPECTION. ONE YEAR AFTER THE EXPIRATION OF THIS PERMIT ENDS. THE REPORT SHALL BE SIGNED IN ACCORDANCE WITH PART II OF THE PERMIT.

CONTRACTOR SHALL MAINTAIN A RECORD OF ALL INSPECTIONS AND MAINTENANCE ACTIVITIES AT THE PROJECT SITE.

- 8.) MAINTAIN AN UPDATED PLAN:
 - A.) THE STORMWATER POLLUTION PREVENTION PLAN (SWPPP) SHALL BE REVISED WHENEVER EROSION PREVENTION MEASURES, SEDIMENT CONTROL MEASURES, OR OTHER SITE MANAGEMENT PRACTICES ARE SIGNIFICANTLY MODIFIED IN RESPONSE TO A CHANGE IN DESIGN, CONSTRUCTION METHOD, OPERATION, MAINTENANCE PROCEDURE, ETC.
 - B.) KYTC PROJECTS N/A
 - C.) THE SWPPP SHALL BE AMENDED IF INSPECTIONS OR INVESTIGATIONS BY SITE STAFF OR BY LOCAL, STATE, OR FEDERAL OFFICIALS DETERMINE THAT THE EXISTING SEDIMENT CONTROL MEASURES, EROSION CONTROL MEASURES, OR OTHER SITE MANAGEMENT PRACTICES ARE INEFFECTIVE IN ELIMINATING OR SIGNIFICANTLY MINIMIZING POLLUTANTS IN STORMWATER DISCHARGES FROM THE CONSTRUCTION SITE.
 - D.) IF AN INSPECTION REVEALS DESIGN INADEQUACIES, THE SITE DESCRIPTION AND SEDIMENT CONTROLS MEASURES, EROSION CONTROL MEASURES, OR OTHER SITE MANAGEMENT PRACTICES IDENTIFIED IN THE SWPPP SHALL BE REVISED.
 - E.) ALL NECESSARY MODIFICATIONS TO THE SWPPP SHALL BE MADE WITHIN SEVEN (7) CALENDAR DAYS FOLLOWING THE INSPECTION UNLESS GRANTED AN EXTENSION OF TIME BY THE KY DIVISION OF WATER.
 - F.) IF EXISTING SEDIMENT CONTROL MEASURES, EROSION CONTROL MEASURES, OR OTHER SITE MANAGEMENT PRACTICES NEED TO BE MODIFIED OR IF ADDITIONAL SEDIMENT PRACTICES ARE NECESSARY, IMPLEMENTATION SHALL BE COMPLETED BEFORE THE NEXT STORM EVENT WHENEVER PRACTICABLE. IF IMPLEMENTATION BEFORE THE NEXT STORM EVENT IS IMPRACTICABLE, THE SITUATION SHOULD BE DOCUMENTED IN THE SWPPP AND THE CHANGES SHALL BE IMPLEMENTED AS SOON AS PRACTICABLE.
- 9.) CONTRACTORS & SUB CONTRACTORS:
THE CONTRACTOR SHALL SUBMIT A KPDES NOTICE OF INTENT (NOI-SW) FORM AT LEAST 30 DAYS PRIOR TO BEGINNING CONSTRUCTION OR DISTURBANCE OF SOIL. THE CONTRACTOR MAY ELECT TO FILE AN ANDI (ELECTRONIC NOTICE OF INTENT), WHICH SHALL BE SUBMITTED AT LEAST 7 DAYS BEFORE CONSTRUCTION BEGINS.

LEGEND

- ⊙ PROP. SEWER MANHOLE
- ⊙ PROP. FIRE HYDRANT ASSEMBLY
- ⊙ CURB BOX INLET
- ⊙ PER O.M.P.C. PI SPECS, EXHIBIT 7-5
- ⊙ DROP BOX INLET
- ⊙ DRAINAGE MANHOLE
- ⊙ EX. UTILITY POLE
- EXISTING CONTOUR
- REGRADE CONTOUR
- PERMETER CONTROL B.M.P.
- ⊙ GRAVEL BAG SEDIMENT FILTERS
- ⊙ PER O.M.P.C. PI SPECS, EXHIBIT NO. 11-7

WENDELL FORD EXPRESSWAY (RIGHT-OF-WAY VARIES)

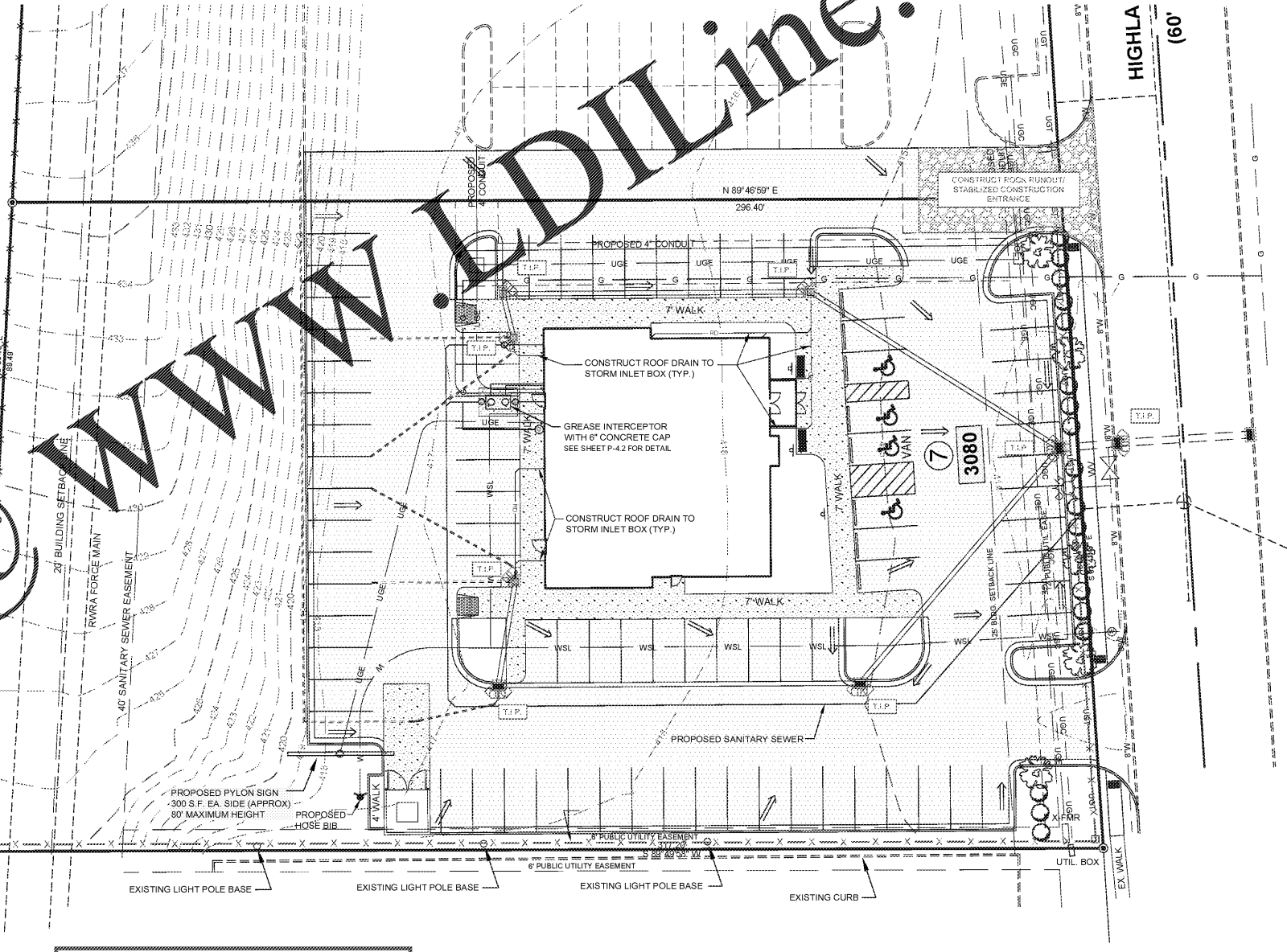

Owner Plans

Kentucky811

CALL BEFORE YOU DIG!
1-800-752-6007
IT'S THE LAW!

PLANS INCLUDE INFORMATION THAT IS COLOR CODED ~TO BE PLOTTED IN COLOR~

GRAPHIC SCALE

(IN FEET)
1 inch = 20 feet

OWNER/DEVELOPER RIVER ROAD RESTAURANT, LLC 417 MAIN STREET NATCHEZ, MS 39120	<table border="1" style="width: 100%; border-collapse: collapse;"> <thead> <tr> <th colspan="4">REVISIONS</th> </tr> <tr> <th>NO.</th> <th>DATE</th> <th>DESCRIPTION</th> <th>BY</th> </tr> </thead> <tbody> <tr><td> </td><td> </td><td> </td><td> </td></tr> <tr><td> </td><td> </td><td> </td><td> </td></tr> <tr><td> </td><td> </td><td> </td><td> </td></tr> </tbody> </table>	REVISIONS				NO.	DATE	DESCRIPTION	BY													EROSION PREVENTION & SEDIMENT CONTROL PLAN	IHOP 3080 HIGHLAND POINTE DRIVE	DATE: MM-DD-YYYY SCALE: 1"=20' JOB NO.: 19-5953 SHEET C7.0	<p style="font-size: 8pt;">1511 FARMERSVILLE RD., SUITE 21102 OWENSBORO, KENTUCKY 42304 (270) 685-2811</p>
REVISIONS																									
NO.	DATE	DESCRIPTION	BY																						