

EROSION CONTROL & MAINTENANCE PLAN NOTES

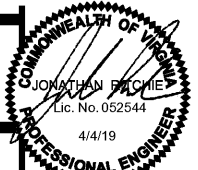

1. RETAIN FLOATABLE WIND BLOWN MATERIALS ON SITE BY STORING ALL TRASH AND BUILDING MATERIAL WASTE IN ENCLOSURES UNTIL PROPER DISPOSAL AT OFF-SITE FACILITIES. CHECK ADJACENT AREAS DAILY AND PICK UP CONSTRUCTION WASTE MATERIALS AND DEBRIS THAT HAVE BLOWN OR WASHED OFF SITE.
2. PERMANENTLY STABILIZE ALL SURFACE AREA WITHIN AND ADJACENT TO THIS SITE THAT IS DISTURBED BY VEHICLES, GRADING AND OTHER CONSTRUCTION FOR THE PROPOSED FACILITY. STABILIZATION IS OBTAINED WHEN THE DISTURBED SURFACES COVERED WITH STRUCTURES, PAVING AND/OR PERENNIAL VEGETATION HAVING A UNIFORM COVERAGE DENSITY OF AT LEAST 70%. STABILIZATION OF ALL DISTURBED AREAS IS SECURED BEFORE TERMINATING MAINTENANCE AND REMOVAL OF EROSION CONTROL MEASURES.
3. CONTRACTORS SHALL INSPECT POLLUTION CONTROL MEASURES AT LEAST ONCE EVERY 14 DAYS AND WITHIN 24 HOURS AFTER A STORM EVENT OR 12 INCH OR GREATER. DAMAGED MEASURES THAT PROVE TO BE INEFFECTIVE SHALL BE REPLACED WITH MORE EFFECTIVE MEASURES OR ADDITIONAL MEASURES WITHIN SEVEN DAYS. FAILURE OF A CONTROL MEASURE REQUIRES INSTALLATION OF A MORE SUITABLE MEASURE TO PREVENT DISCHARGE OF POLLUTANTS FROM THE SITE.
4. INSTALLATION OF ADDITIONAL EROSION CONTROL MEASURES MAY BE REQUIRED BY THE CITY CODE. CONTRACTOR TO VERIFY REQUIREMENTS PRIOR TO BEGINNING ANY WORK ON THE PROJECT SITE.
5. CARE SHALL BE TAKEN TO MINIMIZE THE ENCROACHMENT OF SEDIMENT INTO ADJACENT AREAS, INCLUDING PUBLIC STREETS AND ONTO PRIVATE PROPERTY USING IMPERVIOUS MATERIAL (ROAD/PARKING AREA SURFACE) IS LAYED OR UNLAP. PROPOSED LANDSCAPE HAS BEEN ESTABLISHED.
6. REFER TO THE DETAILS FOR SILT FENCE CONSTRUCTION.
7. ALL STEEP SLOPES WHICH EXCEED 3:1 (H:V) SHALL UTILIZE CONTECH CONSTRUCTION PRODUCTS TURF REINFORCEMENT MATS (CS) OR IMPROVED EQUAL MATS SHALL BE INSTALLED PER MANUFACTURER'S RECOMMENDATIONS. CONTRACTOR SHALL COORDINATE INSTALLATION INSPECTION WITH MANUFACTURER.

CRAIG A. SCHNEIDER, AIA
ARCHITECT
 1736 East Sunshine, Suite 417
 Springfield, Missouri 65904
 417-862-6586
 Fax: 417-862-8265
 e-mail: architect@estertyschneider.com

STAGE OF CONSTRUCTION NOTES

- THE FOLLOWING CONSTRUCTION SEQUENCE IS RECOMMENDED:
- PHASE I**
1. CONTRACTOR TO OBTAIN ALL NECESSARY PERMITS.
 2. PRIOR TO ANY EARTH DISTURBANCE, CONTRACTOR TO CONTACT THE COUNTY AND SCHEDULE A PRE-CONSTRUCTION MEETING.
 3. THE CONTRACTOR SHALL CONTACT FRANKLIN COUNTY DEPARTMENT OF PLANNING AND COMMUNITY DEVELOPMENT - SEDIMENT AND EROSION CONTROL INSPECTOR AT (540) 483-3027 IN WRITING A MINIMUM FIVE (5) BUSINESS DAYS IN ADVANCE OF THE PRE-CONSTRUCTION MEETING. FAILURE TO DO SO MAKES THIS A VIOLATION OF THE APPROVED PLAN AND IS A FINABLE OFFENSE.
 4. CONTRACTOR SHALL STAKE AND FLAG LIMITS OF CLEARING.
 5. INSTALL STABILIZED CONSTRUCTION ENCROACHMENT (AS SHOWN).
 6. INSTALL PERIMETER EROSION CONTROL BARRIER (SILT FENCE AND TREE PROTECTION) (AS SHOWN). CONTRACTOR TO REMOVE TREES ONLY NECESSARY FOR INSTALLATION OF PERIMETER SEDIMENT CONTROLS.
 7. INSTALL INLET PROTECTION (AS SHOWN).
 8. ONCE PERIMETER CONTROLS ARE INSTALLED BEGIN CONSTRUCTION OF THE TEMPORARY SEDIMENT TRAP. CONTRACTOR TO APPLY SOIL STABILIZATION BLANKETS AS NECESSARY TO SEDIMENT TRAP TO MINIMIZE EROSION.
 9. ONCE SEDIMENT TRAP IS OPERATIONAL, INSTALL UPSLOPE DIVERSION DIKES AND SOIL STABILIZATION BLANKETS.
 10. CONTRACTOR TO OBTAIN APPROVAL FROM COUNTY INSPECTOR OF PHASE I MEASURES PRIOR TO PROCEEDING.
- PHASE II**
- IMPORTANT: GC TO COMPLETE ALL STEPS IDENTIFIED IN PHASE I PRIOR TO BEGINNING WORK IN PHASE II.
1. ONCE ALL E&S MEASURES ARE IN PLACE, CONTRACTOR SHALL BEGIN TO GRADE THE SITE, PREPARING SUBGRADES AND MAKE ANY NECESSARY SOIL IMPROVEMENTS.
 2. ONCE SITE HAS BEEN GRADED TO SUBGRADE ELEVATIONS, CONTRACTOR TO START CONSTRUCTION OF BUILDING PAD AND STRUCTURES.
 3. TEMPORARILY STABILIZE THROUGHOUT CONSTRUCTION AND IMMEDIATELY FOLLOWING THE COMPLETION OF THE MOST RECENT LAND DISTURBING/GRADING ACTIVITY. ANY DISTURBED AREAS, INCLUDING MATERIAL STOCKPILES THAT ARE SCHEDULED OR LIKELY TO REMAIN INACTIVE FOR 7 DAYS OR MORE.
 4. AREAS TO BE VEGETATED SHALL BE PERMANENTLY STABILIZED IMMEDIATELY AS THEY ARE BROUGHT TO FINAL GRADE.
 5. INSTALL UTILITIES, UNDERDRAINS, CURBS AND GUTTERS. CONTRACTOR TO INSTALL INLET PROTECTION AS UTILITIES, UNDERDRAINS, CURBS AND GUTTERS ARE INSTALLED.
 6. PREPARE SITE FOR PAVING.
 7. PAVE SITE IN NECESSARY AREAS.
 8. COMPLETE GRADING AND INSTALLATION OF PERMANENT STABILIZATION OVER ALL AREAS, IF NECESSARY.
 9. INSTALL LANDSCAPE PLANTINGS IN ACCORDANCE WITH THE LANDSCAPE PLAN.
 10. ONCE SWM FACILITY IS CONSTRUCTED, THE ENTIRE STORM SYSTEM SHALL BE FLUSHED. CONTRACTOR TO REMOVE ANY MATERIAL FROM SYSTEM.
 11. THE CONTRACTOR SHALL CONTACT FRANKLIN COUNTY FOR A FINAL SITE INSPECTION CONFIRMING THAT THE SITE HAS BEEN FULLY STABILIZED AND ALL CONSTRUCTION HAS BEEN COMPLETED, THEN:
 - A. WITHIN 30 DAYS REMOVE ALL REMAINING TEMPORARY EROSION AND SEDIMENT CONTROL MEASURES.
 - B. REMOVE ALL TEMPORARY CONSTRUCTION EQUIPMENT, CONSTRUCTION MATERIALS AND DEBRIS FROM THE SITE.
 - C. STABILIZE ANY AREAS DISTURBED BY THE REMOVAL OF TEMPORARY MEASURES.
- NOTE: THE CONTRACTOR SHALL REFER TO THE GEOTECHNICAL REPORT FOR SPECIFIC CONSTRUCTION RECOMMENDATIONS.

PROJECT:
NEW O'REILLY AUTO PARTS STORE
OLD FRANKLIN TURNPIKE
ROCKY MOUNT, VA
EROSION CONTROL PLAN

O'Reilly AUTO PARTS
 CORPORATE OFFICES
 233 SOUTH PATTERSON
 SPRINGFIELD, MISSOURI 65902
 (417) 862-2674 TELEPHONE

COMM # 4252
 DATE: 11-2-18
 REVISION DATE: 2-22-19
 4-4-19

CONSTRUCTION EGRESS NOTES

1. CONSTRUCTION EGRESS SHALL BE 25" MINIMUM WIDTH AND 30" MINIMUM LENGTH AND 8" MIN THICKNESS OF STONE (1.5" 3.5" COARSE AGGREGATE WITH GEOTEXTILE UNDERLINER. REFER TO CITY OR STATE FOR ANY ADDITIONAL REQUIREMENTS.
2. THE EXIT SHALL BE MAINTAINED IN A CONDITION WHICH WILL PREVENT TRACKING OR FLOW OF MUD ONTO PUBLIC RIGHT-OF-WAY. THIS MAY REQUIRE PERIODIC TOP DRESSING WITH 1.5-3.5 INCH STONE, AS CONDITIONS DEMAND, AND REPAIR AND/OR CLEAN OUT OF ANY STRUCTURE USED TO TRAP SEDIMENT. ALL MATERIALS SPILLED, DROPPED, WASHED, OR TRACKED FROM VEHICLES OR INTO ROADWAYS OR INTO STORM DRAINS MUST BE REMOVED IMMEDIATELY.
3. WHEELS MUST BE CLEANED TO REMOVE MUD PRIOR TO ENTRANCE ONTO PUBLIC RIGHT-OF-WAY. WHEN WASHING IS REQUIRED, IT SHALL BE DONE ON AN AREA WITH CRUSHED STONE WHICH DRAINS INTO AN APPROVED SEDIMENT TRAP OR SEDIMENT BASIN LOCATED PER CITY OR STATE REQUIREMENTS.

PLAN REFERENCES

- REFER TO EROSION CONTROL DETAILS FOR ADDITIONAL EROSION NOTES & DETAILS
- THIS PLAN TO BE UTILIZED FOR EROSION PURPOSES ONLY



PROJECT No. V183205 SCALE: 1"=30'
 DRAWN BY / CHECKED BY: DSH/JUR CAD I.D. SS1

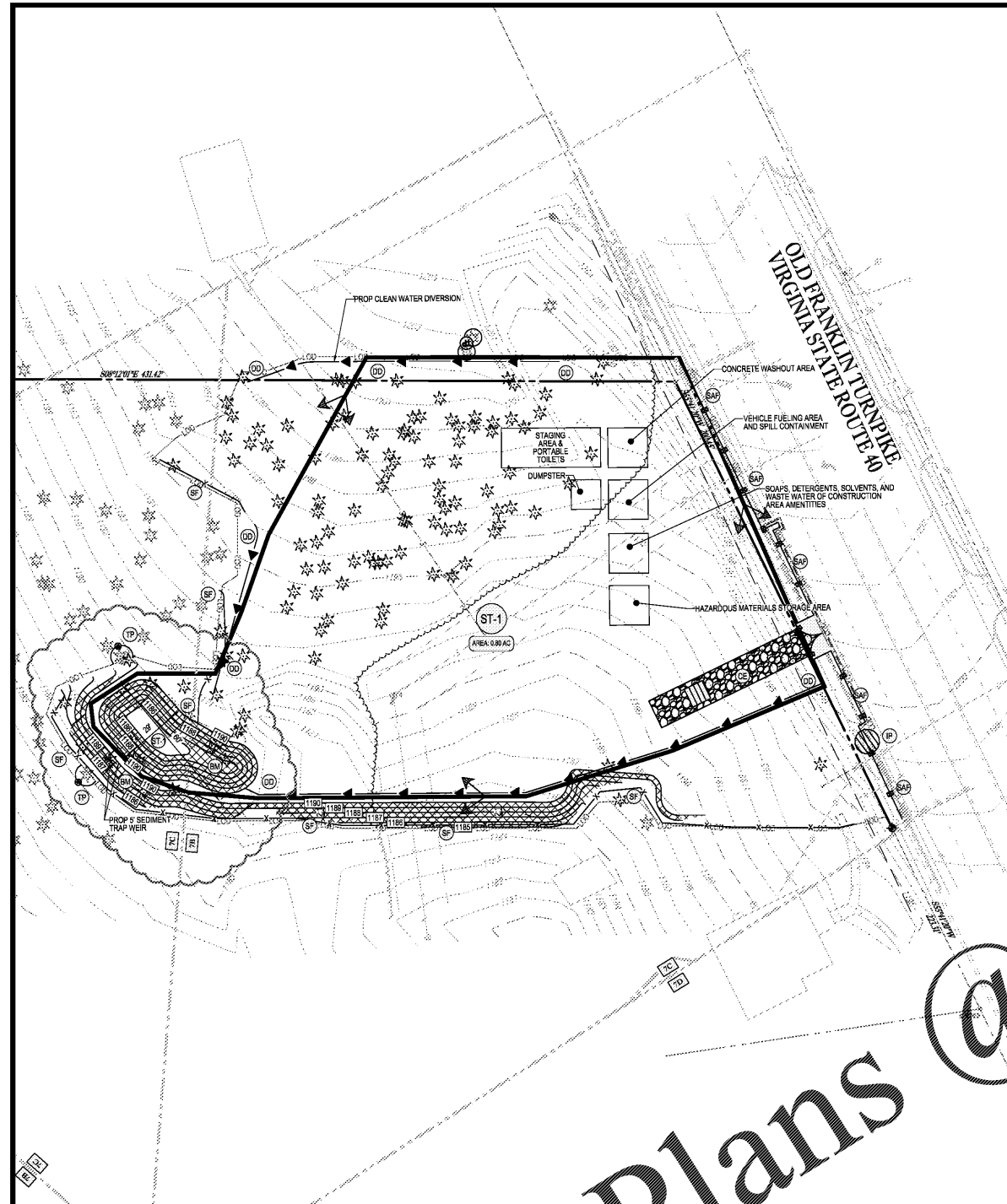

2 E&S CONTROL PLAN - PHASE I
 C3.1

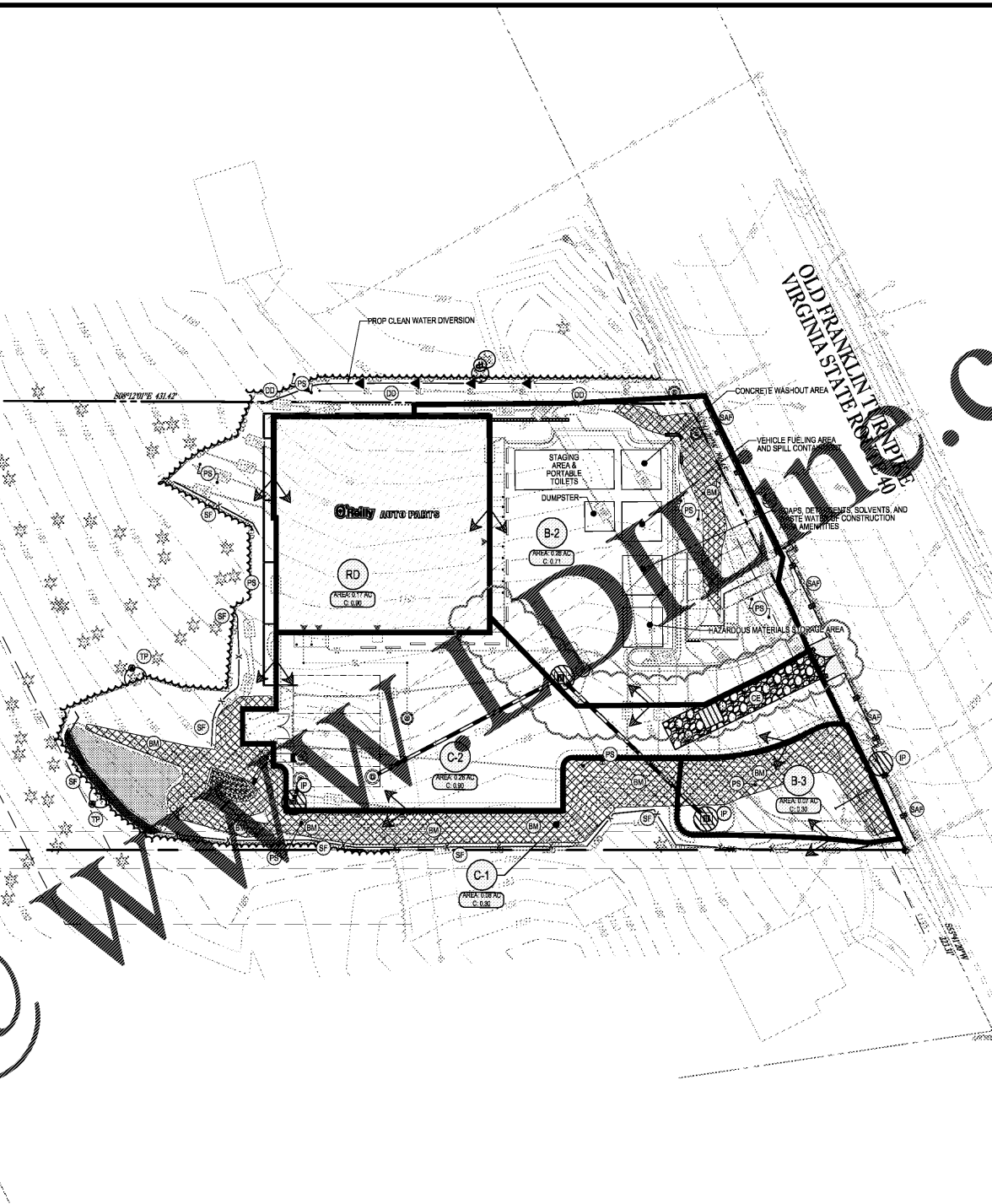

2 E&S CONTROL PLAN - PHASE II
 C3.1 SCALE: 1" = 30'

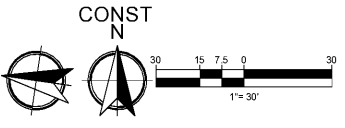
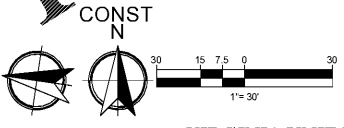

VIRGINIA UNIFORM CODING SYSTEM FOR EROSION AND SEDIMENT CONTROL PRACTICES

NO.	TITLE	KEY	SYMBOL	NO.	TITLE	KEY	SYMBOL
3.01	SAFETY FENCE	SAF	[Symbol]	3.11	TEMPORARY SEDIMENT TRAP	ST	[Symbol]
3.02	TEMPORARY STONE CONSTRUCTION ENTRANCE	CE	[Symbol]	3.12	PERMANENT SEEDING	PS	[Symbol]
3.06	SILT FENCE	SF	[Symbol]	3.16	SOIL STABILIZATION BLANKETS AND MATTING	BM	[Symbol]
3.07	STORM DRAIN INLET PROTECTION	IP	[Symbol]	3.18	TREE PRESERVATION AND PROTECTION	TP	[Symbol]
3.09	TEMPORARY DIVERSION DIKE	DD	[Symbol]				

SOIL LEGEND

[Symbol]	SOILS TYPE
----------	------------

SOILS TABLE

SYMBOL	SOIL NAME	SLOPES
7B	CLIFFORD FINE SANDY LOAM	2-8%
7C	CLIFFORD FINE SANDY LOAM	8-15%
7D	CLIFFORD FINE SANDY LOAM	15-25%



Order Plans @