



**Craig A. Schneider, AIA**  
**ARCHITECT**  
 1736 East Sunshine, Suite 417  
 Springfield, Missouri 65804  
 417.862.0556  
 Fax: 417.862.3265  
 e-mail: architect@estertyschneider.com

**PROJECT:**  
**NEW O'REILLY AUTO PARTS STORE**  
**OLD FRANKLIN TURNPIKE**  
**ROCKY MOUNT, VA**  
**CODE SUMMARY PLAN**

**O'Reilly AUTO PARTS**  
 CORPORATE OFFICES  
 233 SOUTH PATTERSON  
 SPRINGFIELD, MISSOURI 65802  
 (417) 862-2674 TELEPHONE

COMM # 4252  
 DATE: 11-2-18  
 REVISION  
 DATE:

G1.1

**BUILDING CODE**

BUILDING OFFICIAL CONTACT NUMBER: (540) 483-3047  
 COUNTY: FRANKLIN  
 ZIP CODE: 24151

**GOVERNING CODES AND ORDINANCES**  
 BUILDING CODE: 2012 VBFC  
 PLUMBING CODE: 2012 VPC  
 MECHANICAL CODE: 2012 VMC  
 ELECTRICAL CODE: 2011 NEC  
 FIRE CODE: 2012 VBFC  
 ENERGY CODE: 2012 VECC  
 AMENDING ORDINANCE: VA STATE

**USE GROUP & CONSTRUCTION TYPE**  
 PRIMARY USE GROUP: M (MERCANTILE)  
 CONSTRUCTION TYPE: II-B  
 (NON-COMBUSTIBLE / UNPROTECTED)

**AREA MODIFICATIONS**  
 FRONTAGE INCREASE: NOT APPLIED  
 AUTOMATIC SPRINKLER INCREASE: NOT PROVIDED

**ALLOWABLE HEIGHT & BUILDING AREA**  
 NO. STORIES: 2 STORIES  
 AREA: 12,500 SQ. FT.

**ACTUAL HEIGHT & BUILDING AREA**  
 NO. OF STORIES: 2 STORIES  
 BUILDING HEIGHT: 17'-0"  
 GROSS BUILDING AREA: 12,500 SQ. FT.

**FIRE PROTECTION SYSTEMS**  
 AUTOMATIC SPRINKLER SYSTEM: NOT REQUIRED  
 SURFACE MOUNTED FIRE EXTINGUISHERS: REQUIRED  
 FIRE ALARM SYSTEM: NOT REQUIRED  
 AUTOMATIC DETECTION SYSTEM: NOT REQUIRED

**STRUCTURAL DESIGN (RISK CATEGORY II)**  
 (REFER TO STRUCTURAL DRAWINGS)  
 LIVE LOADS  
 ROOF: 20 PSF  
 REDUCIBLE

2. ROOF COLLATERAL LOADS  
 A. ARCHITECTURAL/MECHANICAL: 2.5 PSF  
 B. CEILING SYSTEM (PARTS AREA "A"): 2.0 PSF  
 C. SPRINKLER SYSTEM:  
 UNIFORM BRANCH PIPE LOAD: 0 PSF  
 LINEAL LOOP/TEE MAIN PIPE LOAD: 0 PLF  
 D. STUDS AND GYP SHEATHING: 0 PSF

3. SNOW LOADS Ce = 1.0 Ct = 1.0  
 GROUND LOAD (Pg): 25 PSF  
 MINIMUM ROOF SNOW LOAD (Pm): 20 PSF  
 IMPORTANCE FACTOR (Is): 1.0

4. WIND LOADS Gcpi = ± 0.18  
 BASIC WIND SPEED: V<sub>ASD</sub> = 89 MPH  
 V<sub>ULT</sub> = 115 MPH  
 EXPOSURE: C

5. SEISMIC  
 Ss: 0.182  
 S1: 0.076  
 Sds: 0.194  
 Sd1: 0.122  
 IMPORTANCE FACTOR (Ie): 1.0  
 SITE CLASS (GEOTECHNICAL REPORT): D  
 DESIGN CATEGORY: B

6. LOAD COMBINATIONS:  
 LOAD COMBINATIONS SHALL BE PER THE ABOVE REFERENCED BUILDING CODE.

7. BUILDING DEFLECTION LIMITS:  
 (REFERENCED CODE DEFLECTION LIMITS, WHERE MORE STRINGENT CODE DEFLECTION APPLY, SHALL SUPERSEDE THE FOLLOWING DEFLECTION LIMITS.)  
 MAX. ROOF SNOW OR LIVE LOAD: SPAN/240  
 MAX. ROOF TOTAL LOAD: SPAN/180  
 MAX. METAL BUILDING RIGID FRAME  
 LATERAL DEFLECTION: HEIGHT/150  
 MAX. METAL BUILDING HORIZONTAL GIRT  
 LATERAL DEFLECTION: SPAN/240

**COMMERCIAL ENERGY EFFICIENCY CODE**  
 COMPLIANCE WITH BUILDING ENERGY EFFICIENCY REQUIREMENTS BASED UPON APPLICABLE ENERGY CODE (PERFORMANCE METHOD).

CERTIFICATE OF COMPLIANCE AND CALCULATIONS TO BE PROVIDED UPON REQUEST UNDER SEPARATE COVER.

**GENERAL NOTES**

- (A) REFER TO PROJECT MANUAL FOR ADDITIONAL REQUIREMENTS.
- (B) REFER TO PLANS, SECTIONS, AND DETAILS FOR CONSTRUCTION OF FIRE RATED ASSEMBLIES. WHERE UNDERWRITERS LABORATORY (UL) TEST NUMBERS ARE REFERENCED, CONTRACTOR SHALL PROVIDE CONSTRUCTION MATERIALS, MEANS AND METHODS TO COMPLY WITH TESTED ASSEMBLY.
- (C) REFER TO MECHANICAL AND ELECTRICAL DRAWINGS FOR ADDITIONAL REQUIREMENTS.
- (D) OWNER FURNISHED AND INSTALLED FURNISHINGS AND FIXTURES SHOWN FOR REFERENCE ONLY.
- (E) CONTRACTOR TO PROVIDE PORTABLE FIRE EXTINGUISHERS DURING CONSTRUCTION. REQUIRE TO PROTECT THE WORK AREA AND EACH STORAGE UNIT AND TRAILER PER THE FIRE CODE.
- (F) SURFACE MOUNTED PORTABLE FIRE EXTINGUISHERS SHALL BE UL LISTED ABC TYPE WITH 5 LBS. CAPACITY. REFER TO DETAIL 10/A4 FOR TYPICAL MOUNTING REQUIREMENTS.
- (G) EXIT DOOR AND LARGE DOORS, PROVIDE TACTILE EXIT SIGNS STATING "EXIT" WITH BRAILLE LETTERING, SIGN AND MOUNTING TO COMPLY WITH ANSIA117.1. REFER TO FLOOR PLAN FOR LOCATIONS.

**SYMBOLS LEGEND**

- 325 SF ROOM SQUARE FOOTAGE:
- DESIGN OCCUPANT LOAD SERVED BY EXIT:  
 MAXIMUM ALLOWABLE CAPACITY (EXAMPLE: 39' / 2' = 180):
- OCCUPANT LOAD SERVED BY EXIT BUT NOT COUNTED IN TOTAL OCCUPANT LOAD:
- ROOM OCCUPANT LOAD AT 30 SQ. FT. GROSS PER PERSON:
- ROOM OCCUPANT LOAD AT 100 SQ. FT. GROSS PER PERSON:
- ROOM OCCUPANT LOAD AT 300 SQ. FT. GROSS PER PERSON:
- FIRE EXTINGUISHER (SURFACE MOUNTED)
- TES → LOCATION OF TACTILE EXIT SIGNAGE
- EGRESS TRAVEL PATH STARTING POINT
- EXIT ACCESS TRAVEL DISTANCE (LENGTH IN FEET)
- CLEAR FLOOR AREA (EXIT DOOR AND / OR FIRE EXTINGUISHER)

REFER TO LIGHTING PLAN FOR EMERGENCY EXIT LIGHTING LOCATIONS

**PLUMBING FIXTURE SUMMARY**

**GENERAL**  
 IPC TABLE 403.1  
 PRIMARY OCCUPANCY: (M) MERCANTILE  
 TOTAL OCCUPANCY: 126

OCCUPANCY LOAD CALCULATED PER SEX:  
 FEMALE: 126 / 2 = 63  
 MALE: 126 / 2 = 63

**PLUMBING FIXTURES**  
 WATER CLOSETS (URINALS): 1 PER 500  
 REQUIRED FOR FEMALE: 63/500 = 1  
 PROVIDED FOR FEMALE: 1  
 REQUIRED FOR MALE: 63/500 = 1  
 PROVIDED FOR MALE: 1 AND 1 URINAL

LAVATORIES:  
 REQUIRED FOR FEMALE: 1 PER 750  
 PROVIDED FOR FEMALE: 63/750 = 1  
 1  
 REQUIRED FOR MALE: 63/750 = 1  
 PROVIDED FOR MALE: 1

DRINKING FOUNTAINS:  
 REQUIRED: 1 PER 1,000  
 PROVIDED: 126/1000 = 1  
 2

SERVICE SINK REQUIRED: 1  
 SERVICE SINK PROVIDED: 1

**HAZARDOUS MATERIALS INVENTORY STATEMENT (HMIS)**

- (A) UPON REQUEST OWNER TO PROVIDE UNDER SEPARATE COVER, PROJECT HAZARDOUS MATERIALS INVENTORY STATEMENT (HMIS) FOR COMMODITY TYPES, HAZARD CLASS, AND QUANTITIES.
- (B) OWNER RESPONSIBLE FOR MONITORING INVENTORY COMMODITY TYPES AND QUANTITIES TO NOT EXCEED CODE REQUIREMENTS.

**OCCUPANCY LOAD SUMMARY**

ROOM OR AREA (REFER TO FLOOR PLAN)	AREA PER OCCUPANT (S.F.)	OCCUPANTS (QTY.)
100 - PARTS AREA "A"	30	112
101 - PARTS AREA "B"	300	6
102 - OFFICE	100	1
103 - RESTROOM	N/A	0
104 - RESTROOM	N/A	0
105 - PARTS AREA "C"	300	7
<b>TOTAL OCCUPANCY</b>		<b>126</b>

**PROJECT DATA**

REAL ESTATE PROPERTY GROSS AREA:	78,064 GSF
SITE PARKING GROSS AREA:	16,508 GSF
<b>BUILDING</b>	
BUILDING GROSS AREA:	7,453 GSF
BUILDING INTERIOR AREA:	7,193 SF

**1 CODE SUMMARY PLAN**  
 G1.1 SCALE: 1/8" = 1'-0"

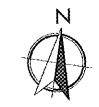

EAST WALL TO BE 1 HOUR FIRE RATED PER UL #905. REFER TO DETAIL 2/A1.1.

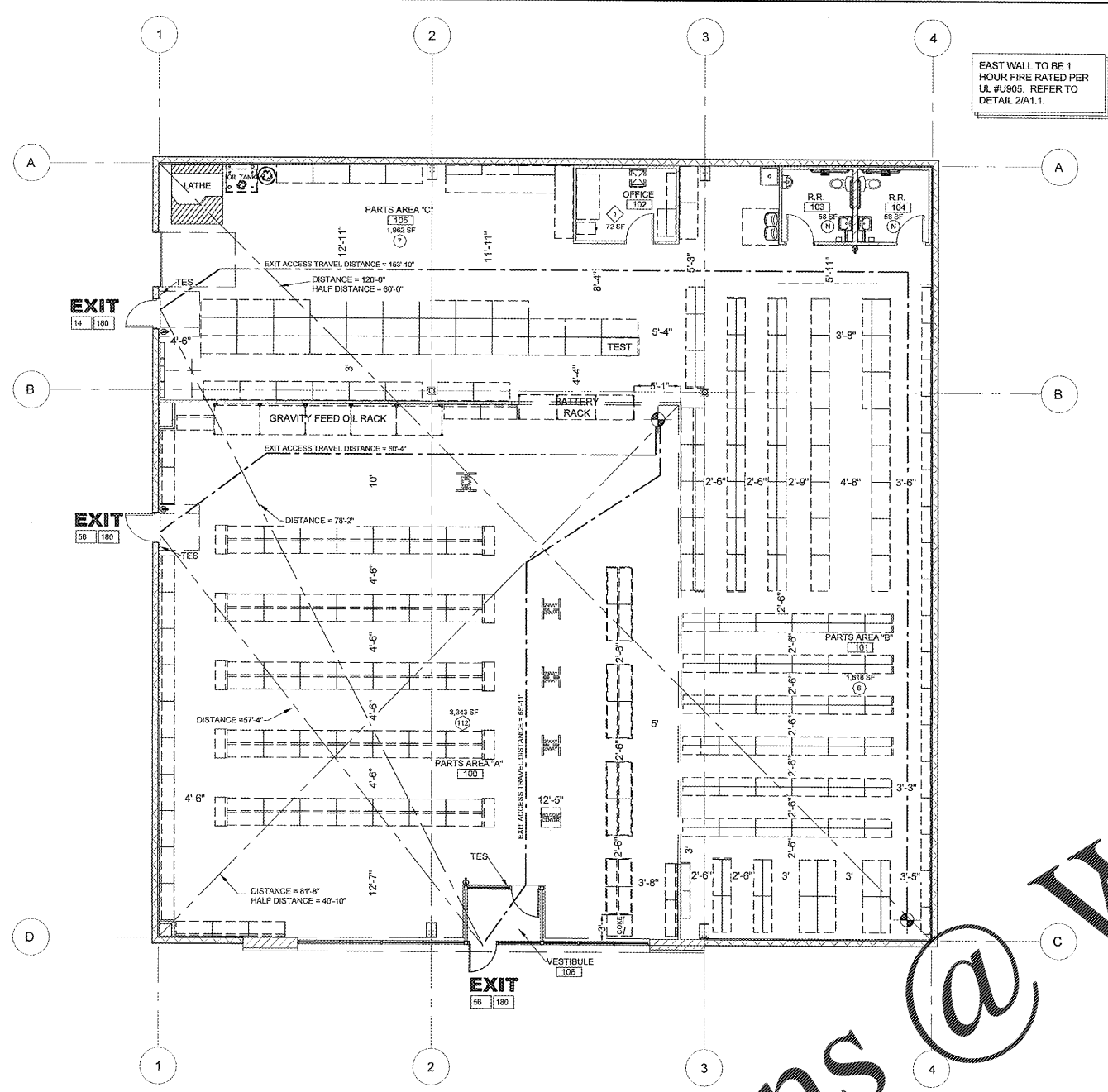

Order Plans @ WWW.LDOnline