



1927 South Tryon St., Suite 300, Charlotte, NC 28203  
150 Fayetteville St., Suite 520, Raleigh, NC 27601



SCO #16-15889-02A

**RICHMOND  
COMMUNITY  
COLLEGE**

LINDSEY-PETRIS  
CAFETERIA / DINING  
ADDITION VOL.1

BID DOCUMENTS

**CEILING PLAN -  
LIGHTING**

DATE 4-5-2019  
PROJECT NO 16063

REVISIONS

NO	DATE	DESCRIPTION

THIS DRAWING IS THE PROPERTY OF ADW ARCHITECTS, P.A. AND SHALL NOT BE REPRODUCED OR COPIED IN WHOLE OR IN PART, IT SHALL NOT BE USED ON ANY OTHER PROJECT OR GIVEN TO ANY OTHER COMPANY OR AGENCY WITHOUT THE CONSENT OF ADW ARCHITECTS, P.A.



SEAL 04/02/19

SHEET NUMBER **E101**  
8 OF 11  
OPTIMA # 17-0017

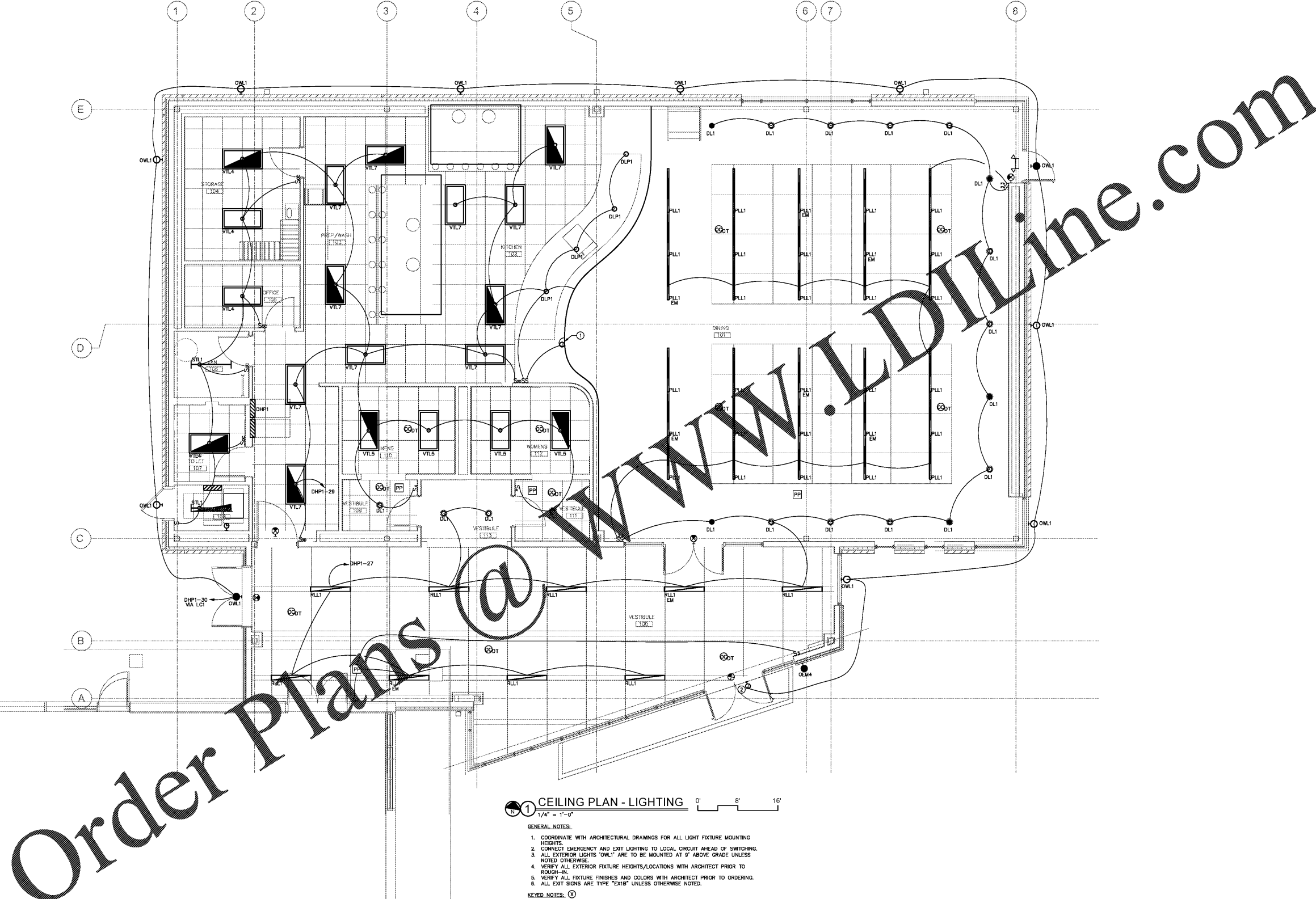

**1** CEILING PLAN - LIGHTING  
1/4" = 1'-0"

- GENERAL NOTES:
- COORDINATE WITH ARCHITECTURAL DRAWINGS FOR ALL LIGHT FIXTURE MOUNTING HEIGHTS.
  - CONNECT EMERGENCY AND EXIT LIGHTING TO LOCAL CIRCUIT AHEAD OF SWITCHING.
  - ALL EXTERIOR LIGHTS "OWL" ARE TO BE MOUNTED AT 8' ABOVE GRADE UNLESS NOTED OTHERWISE.
  - VERIFY ALL EXTERIOR FIXTURE HEIGHTS/LOCATIONS WITH ARCHITECT PRIOR TO ORDERING.
  - VERIFY ALL FIXTURE FINISHES AND COLORS WITH ARCHITECT PRIOR TO ORDERING.
  - ALL EXIT SIGNS ARE TYPE "EXIT" UNLESS OTHERWISE NOTED.

- KEYED NOTES: (K)
- PROVIDE LED COVE LIGHT "LCT1" AT THIS LOCATION. COORDINATE WITH ARCHITECT FOR EXACT LOCATION AND FIXTURE LENGTH.
  - J-BOX FOR CANOPY SIGN/LIGHT. COORDINATE WITH ARCHITECT FOR LOCATION.