



SCO #16-15889-02A

**RICHMOND  
COMMUNITY  
COLLEGE**

LINDSEY-PETRIS  
CAFETERIA/DINING  
ADDITION VOL.1

BID DOCUMENTS

SCHEDULES (DOORS &  
WINDOWS)

DATE: 04.05.2019  
PROJECT NO: 16063

REVISIONS  
NO. DATE: DESCRIPTION:

THIS DRAWING IS THE PROPERTY OF ADW ARCHITECTS, P.A. AND SHALL NOT BE REPRODUCED OR COPIED IN WHOLE OR PART. IT SHALL NOT BE USED ON ANY OTHER PROJECT OR GIVEN TO ANY OTHER COMPANY OR AGENCY WITHOUT THE CONSENT OF ADW ARCHITECTS, P.A.

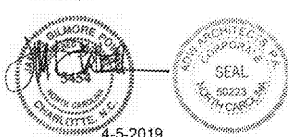

4-5-2019

SHEET NUMBER

**A600**

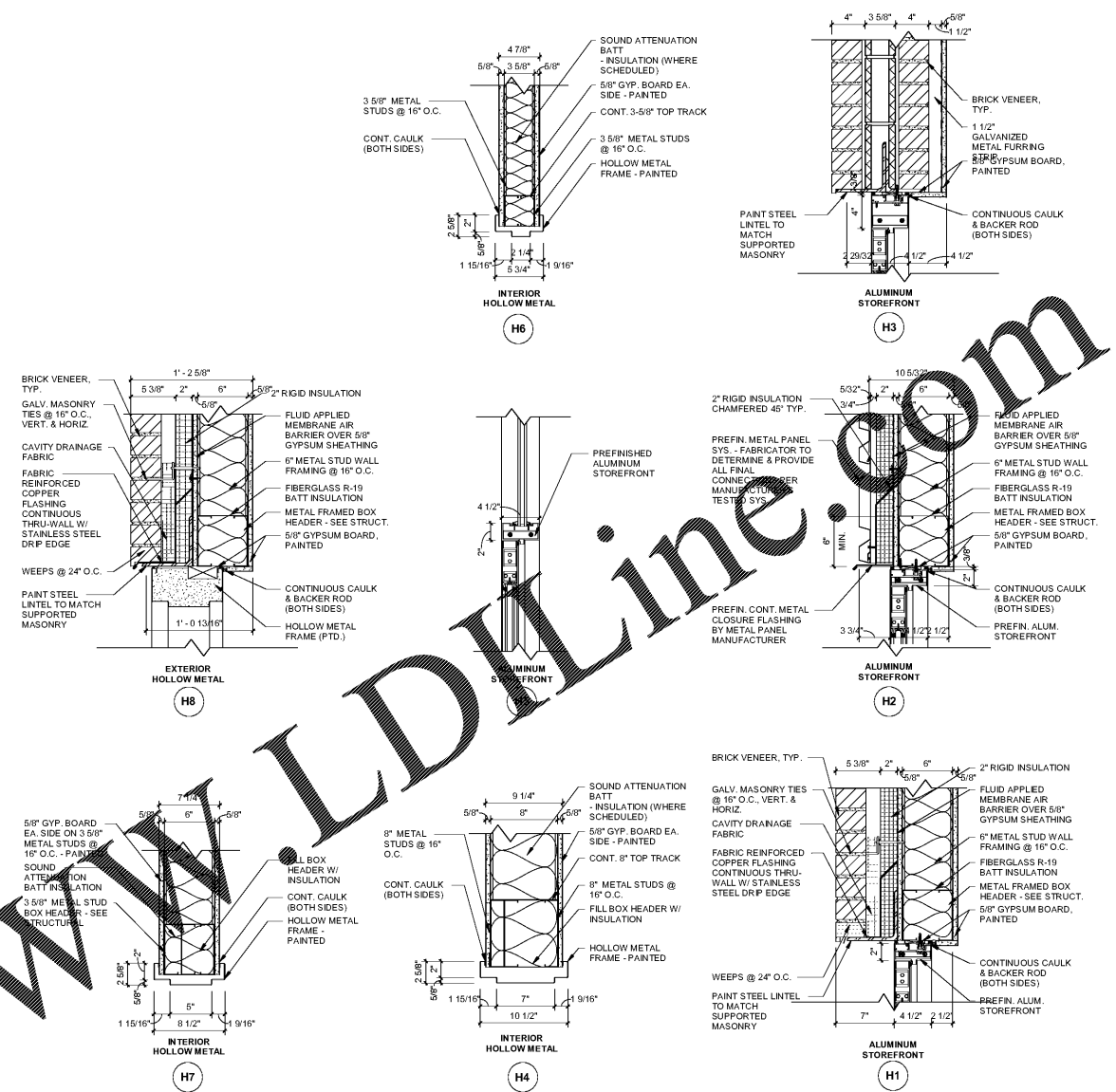

HEAD DETAILS | 1 1/2" = 1'-0" | 02

- DOOR FRAME NOTES:**
1. PROVIDE NON-REMOVABLE PINS AT EXTERIOR DOORS (U.N.O.)
  2. PROVIDE SOFT FILLER MATERIAL INSIDE METAL FRAME TO ACCOMMODATE ATTACHMENT OF WEATHER STRIPPING & METAL DRIP
  3. ALL THRESHOLDS TO BE A.D.A. COMPLIANT. THE FINISHED FLOOR ELEVATION ON BOTH SIDES OF A DOOR SHALL NOT BE MORE THAN 1/2" LOWER THAN THE THRESHOLD OF THE DOORWAY.
  4. SEE STRUCTURAL DRAWINGS FOR REINFORCEMENT AT DOOR HEADS.
  5. FILL JAMB & HEADER STUDS WITH INSULATION (TYPICAL IN WALLS SCHEDULED TO RECEIVE INSULATION).
  6. MAXIMUM DOOR OPENING EFFORTS (2012 I.B.C. SECTION 1008.1.3)
    1. SHALL NOT EXCEED 5 LB OF FORCE FOR PUSHING OR PULLING OPEN DOORS, OTHER THAN FIRE DOORS.
    2. A 15 LB FORCE SHALL RELEASE A LATCH.
    3. A 30 LB FORCE SHALL SET A DOOR IN MOTION.
    4. A 15 LB FORCE SHALL SWING FULLY OPEN.
  7. ALL DOORS PROVIDED WITH LATCHING HARDWARE SHALL BE EQUIPPED WITH SINGLE EFFORT, NON-GRASP HARDWARE (IE LEVER UNLESS PROVIDED WITH PANIC HARDWARE).
  8. LEVER & PANIC HARDWARE SHOULD BE MOUNTED BETWEEN 30" AND 44" ABOVE THE FINISHED FLOOR.

**GLAZING LEGEND**

(G-1)	UNCOATED CLEAR FULLY TEMPERED FLOAT GLASS 1/4" THICK
(G-2)	LOW-E TINTED TEMPERED INSULATED GLASS 1" THICK

**DOOR, FRAME AND HARDWARE SCHEDULE**

DOOR #	ROOM NAME	RATING	ELEVATION	DOOR				FRAME			HARDWARE		REMARKS				
				WIDTH	HEIGHT	THICKNESS	FINISH	MATERIAL	TYPE	MATERIAL	HEAD	JAMB		CLOSER	PANIC	SMOKE SEAL	AUTO Matic DOOR OPERATOR
100A	VESTIBULE	5	6'-0"	8'-0"	1 3/4"	ALUM. ANO.	ALUM.	SF-1	ALUM.	H5	J5	Yes	Yes	No			
100B	VESTIBULE	5	6'-0"	7'-0"	1 3/4"	ALUM. ANO.	ALUM.	SF-10	ALUM.	H2	J2	Yes	Yes	No			
100C	VESTIBULE	5	6'-0"	7'-0"	1 3/4"	ALUM. ANO.	ALUM.	SF-12	ALUM.	H3	J3	Yes	No	No			
101A	DINING	5	6'-0"	8'-0"	1 3/4"	ALUM. ANO.	ALUM.	SF-11	ALUM.	H5	J5	Yes	Yes	No			
101B	DINING	5	3'-0"	8'-0"	1 3/4"	ALUM. ANO.	ALUM.	SF-7	ALUM.	H5	J1	Yes	Yes	No			
103	PREP/WASH	3	4'-0"	7'-0"	1 3/4"	PAINTED	S.C. WOOD	HM-1	HM	H7	J7	No	No	No			
104	STORAGE	2	3'-0"	7'-0"	1 3/4"	PAINTED	METAL	HM-1	HM	H6	J6	No	No	No			
105	OFFICE	4	3'-0"	7'-0"	1 3/4"	PAINTED	METAL	HM-1	HM	H6	J6	No	No	No			
106	JAN.	2	3'-0"	7'-0"	1 3/4"	PAINTED	METAL	HM-1	HM	H6	J6	No	No	No			
107	STAFF TOILET	2	3'-0"	7'-0"	1 3/4"	PAINTED	METAL	HM-1	HM	H4	J4	Yes	No	No			
108	ELECTRICAL	1	3'-0"	7'-0"	1 3/4"	PAINTED	METAL	HM-2	HM	H8	J8	Yes	Yes	No			
109	VESTIBULE	3	3'-0"	7'-0"	1 3/4"	STAINED	S.C. WOOD	HM-1	HM	H6	J6	Yes	No	No			
111	VESTIBULE	3	3'-0"	7'-0"	1 3/4"	STAINED	S.C. WOOD	HM-1	HM	H6	J6	Yes	No	No			

DOOR SCHEDULE | 01

NOT USED

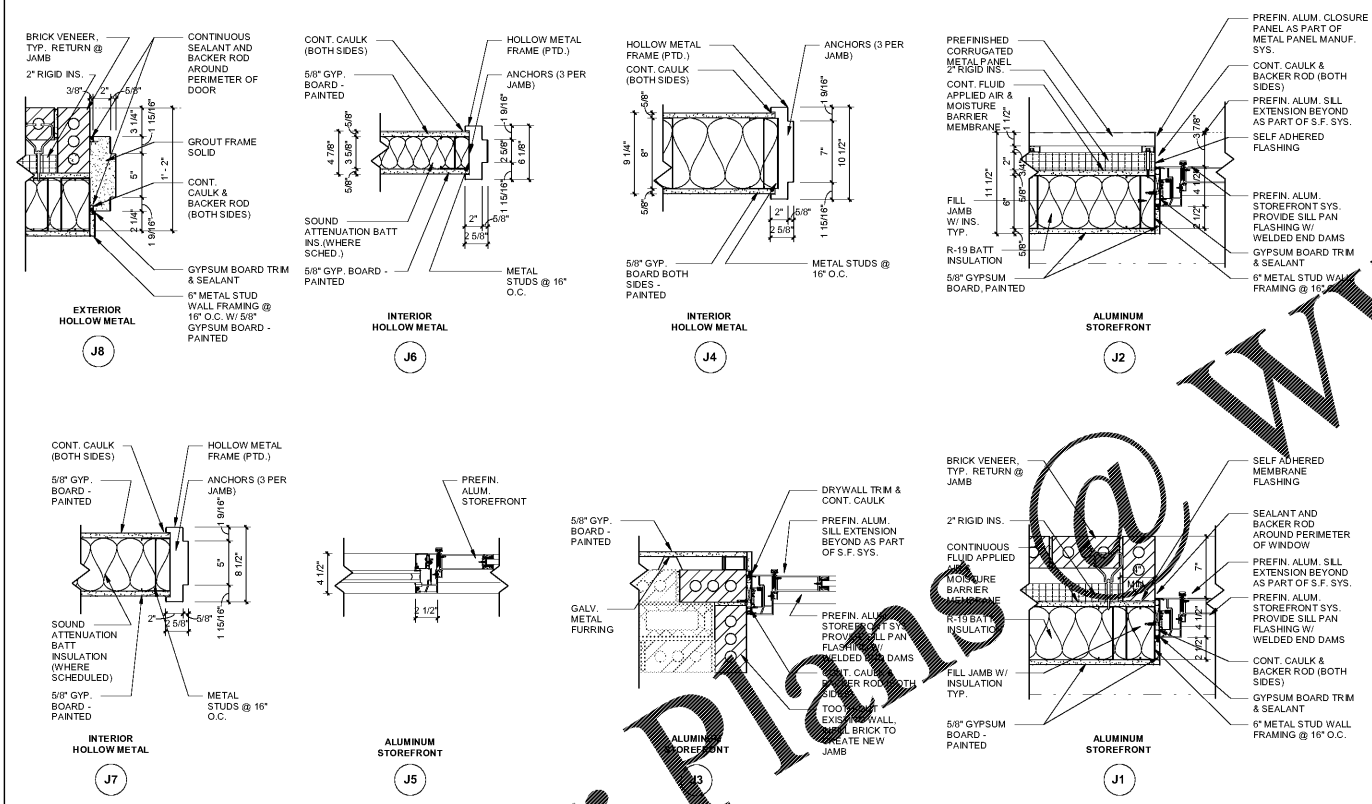

JAMB DETAILS | 1 1/2" = 1'-0" | 04

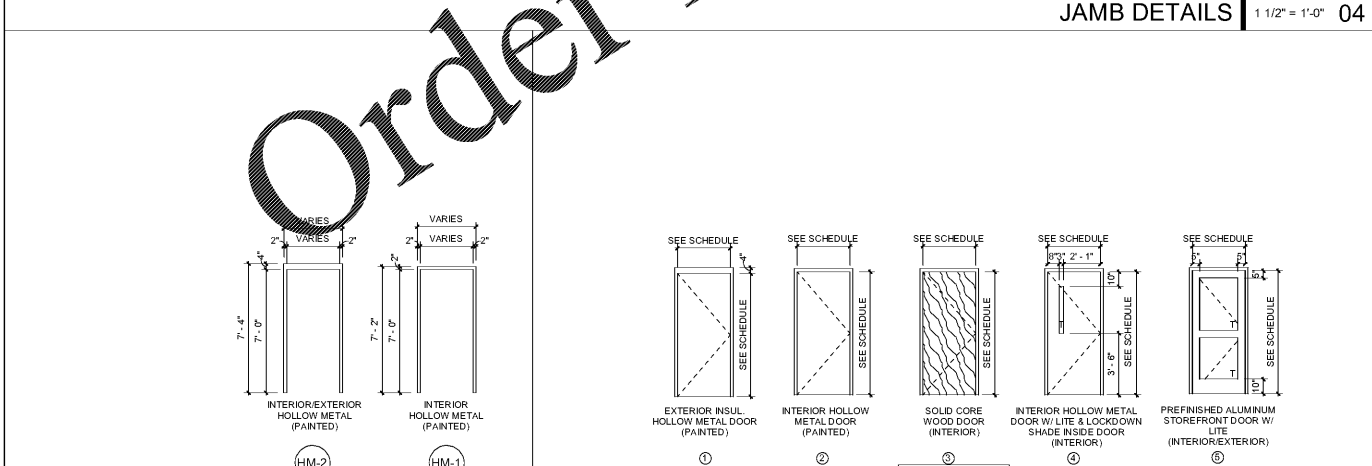

DOOR ELEVATIONS | 1/4" = 1'-0" | 03

HOLLOW METAL FRAMES | 1/4" = 1'-0" | 05