

VICINITY MAP
NTS

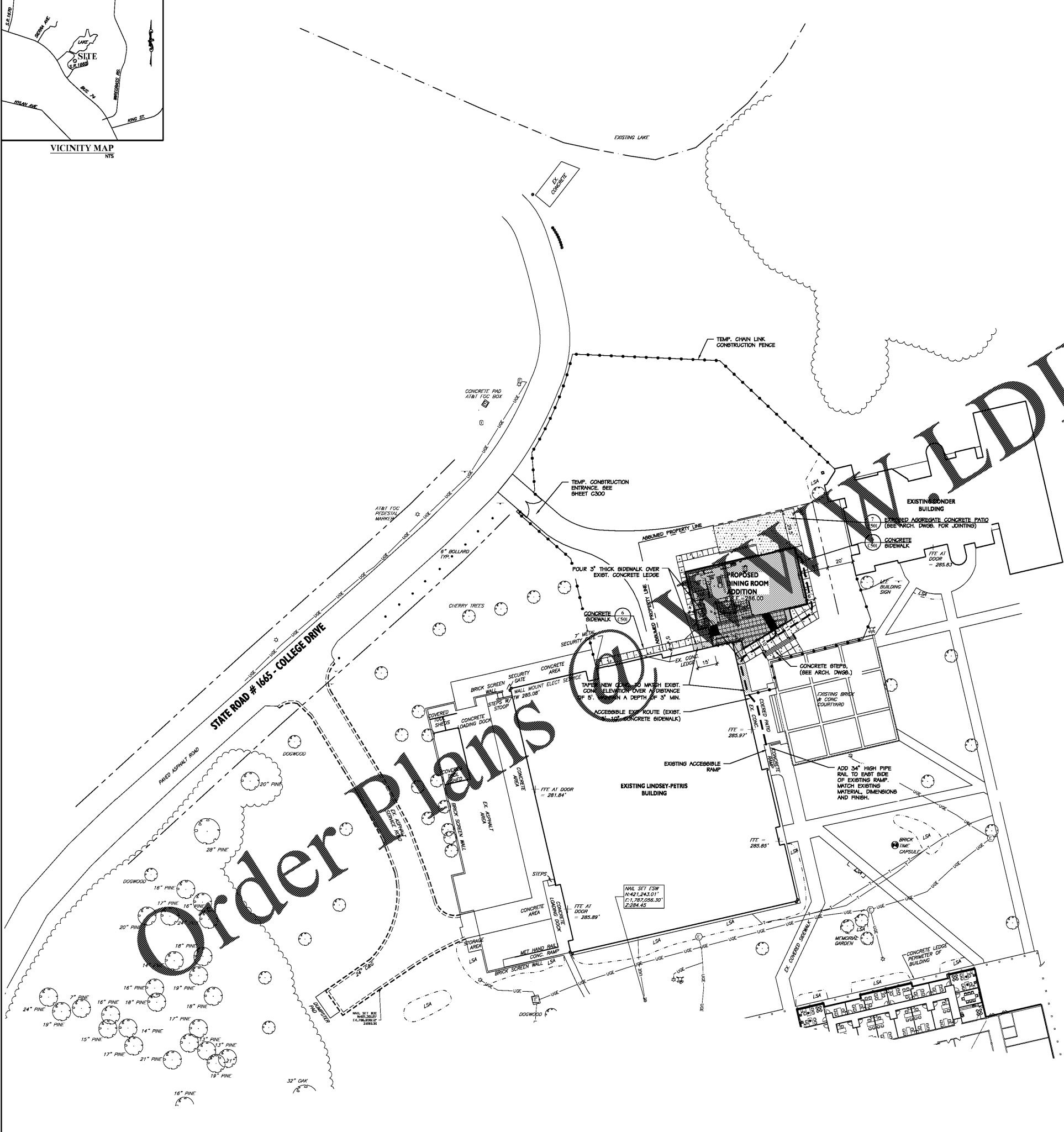

SITE NOTES

1. DIMENSIONS AND COORDINATE POINTS ARE TO FACE OF CURB, EDGE OF PAVEMENT, OR CORNER OF BUILDING UNLESS OTHERWISE NOTED.
2. ALL IMPROVEMENTS AND CONSTRUCTION SHALL BE IN ACCORDANCE WITH STATE AND LOCAL STANDARDS.
3. ANY DISCREPANCIES FOUND IN THE FIELD SHALL BE CALLED TO THE ATTENTION OF THE OWNER OR ENGINEER PRIOR TO PROCEEDING WITH WORK.
4. PRIOR TO BEGINNING CONSTRUCTION, UNLESS OTHERWISE PROVIDED IN THE CONTRACT DOCUMENTS, THE CONTRACTOR SHALL SECURE AND PAY FOR ALL PERMITS (BOTH SITE AND BUILDING RELATED) INCLUDING BUT NOT LIMITED TO REGULATORY FEES, LICENSES, AND INSPECTIONS NECESSARY FOR PROPER EXECUTION AND COMPLETION OF THE WORK.
5. THE GENERAL CONTRACTOR SHALL CONTACT ALL OWNERS OF SUBSISTENTS, UTILITIES, AND RIGHT-OF-WAYS, PUBLIC AND PRIVATE, PRIOR TO WORKING IN THESE AREAS.
6. GENERAL CONTRACTOR SHALL MAINTAIN THE SITE IN A MANNER SO THAT WORKERS AND THE PUBLIC SHALL BE PROTECTED FROM INJURY.
7. BIGHT TRIANGLES SHOWN ARE THE MINIMUM REQUIRED.
8. USE CAUTION WHEN REPRODUCING COPIES OF THE CONSTRUCTION DRAWINGS. COPIES ARE SUBJECT TO DISTORTION AND INACCURACY IN THE SCALE OF DRAWINGS. VERIFY ANY DISCREPANCIES WITH BENECH.
9. ALL SIGNS, PAVEMENT MARKINGS, AND OTHER TRAFFIC CONTROL DEVICES SHALL CONFORM TO THE MANUAL ON UNIFORM TRAFFIC CONTROL DEVICES (MUTCD), LATEST EDITION AS AMENDED.
10. ALL PAVEMENT MARKINGS SHALL BE FOUR (4) INCHES WIDE UNLESS INDICATED OTHERWISE ON THE DRAWINGS.
11. CONTRACTOR SHALL FURNISH AND INSTALL ALL PAVEMENT MARKINGS AS SHOWN ON THE PLANS.
12. CONTRACTOR SHALL SAW-CUT EXISTING ASPHALT PAVEMENT AREAS TO TIE IN SMOOTHLY TO PROPOSED PAVEMENT AT DRIVEWAY ENTRANCES.
13. REFER TO ARCHITECTURAL PLANS FOR ACTUAL BUILDING DIMENSIONS.
14. THE ENGINEER WILL PROVIDE THE CONTRACTOR WITH AN ELECTRONIC FILE OF THESE DRAWINGS UPON REQUEST.
15. CONTACT THE UTILITY COMPANY TO RELOCATE ANY EXISTING UTILITY POLES. ALL EXISTING FACILITIES WHICH CONFLICT WITH THE IMPROVEMENTS UNDER THE SCOPE OF THIS PROJECT MUST BE RELOCATED AT THE EXPENSE OF THE OWNER.
16. STOP BEFORE YOU DIG. CALL 811. IT'S THE LAW.
17. HEAVY DUTY PAVEMENT SHOWN ON THIS PLAN IS CAPABLE OF SUPPORTING AN 80,000 LB FIRE TRUCK.

LEGEND

—	EXISTING SIGN	— — — —	EXISTING CURB AND GUTTER
- - -	PROPOSED SIGN	— — — —	PROPOSED CURB AND GUTTER
IP	EXISTING IRON PIN	— — — —	PROPOSED FLUSH CURB AND GUTTER
OP	EXISTING LIGHT POLE	— — — —	PROPOSED PROPERTY LINE
R/W	RIGHT-OF-WAY	— — — —	EXISTING EASEMENT
HC	ACCESSIBLE SPACE	— — — —	EXISTING FENCE
⊙	EXISTING TREE TO REMAIN	— — — —	PROPOSED FENCE
⊙	EXISTING FIRE HYDRANT	— — — —	EXISTING OVERHEAD UTILITY LINE
⊙	# OF PARKING SPACES	— — — —	EXISTING ASPHALT PAVEMENT
⊙	CENTERLINE	— — — —	PROPOSED STANDARD DUTY ASPHALT PAVEMENT
R	ACCESSIBLE RAMP	— — — —	PROPOSED HEAVY DUTY ASPHALT PAVEMENT
		— — — —	PROPOSED EXPOSED AGGREGATE CONCRETE
		— — — —	PROPOSED CONCRETE SIDEWALK
		— — — —	EXISTING LANDSCAPE AREA

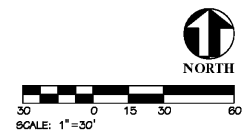

www.adwline.com

Order plans

adwarchitects
environments for life
architecture planning interiors
2815 COLISEUM CENTRE DRIVE
SUITE 500
CHARLOTTE, NORTH CAROLINA 28217
9704.378.1919
F704.378.1920
www.adwarchitects.com

benesch
Alfred Benesch & Company
2559 Perimeter Pointe Parkway, Suite 350
Charlotte, NC 28209
www.benesch.com
774.521.9889
Corp. NC License: F.1320
Project #17-002228



SCO #16-15889-02A
**RICHMOND
COMMUNITY
COLLEGE**

LINDSEY-PETRIS
CAFETERIA / DINING
ADDITION VOL.1

BID DOCUMENTS

SITE PLAN

DATE 04.05.2019
PROJECT NO 16063

REVISIONS

NO	DATE	DESCRIPTION

THIS DRAWING IS THE PROPERTY OF ADW ARCHITECTS, P.A. AND SHALL NOT BE REPRODUCED OR COPIED IN WHOLE OR IN PART. IT SHALL NOT BE USED ON ANY OTHER PROJECT OR GIVEN TO ANY OTHER COMPANY OR AGENCY WITHOUT THE CONSENT OF ADW ARCHITECTS, P.A.



SEAL 4/5/19

SHEET NUMBER **C200**