



ARCHITECTURE
LANDSCAPE ARCHITECTURE
PLANNING
INTERIOR DESIGN

PO BOX 1308
300 SOUTH DAWSON STREET
RALEIGH, NORTH CAROLINA 27602
919.821.5547

www.hagersmith.com © Copyright 2018

SEAL

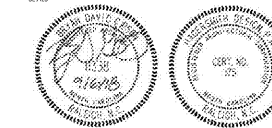

ASSOCIATES /



BASS, NIXON & KENNEDY, INC.
CONSULTING ENGINEERS

6310 CHAFFI HILL ROAD
RALEIGH, NC 27607
PHONE: 919.851.4422
FAX: 919.851.8968

PROJECT 555-019

**BILTMORE HILLS
COMMUNITY
CENTER
RENOVATIONS**

2615 FITZGERALD DR
RALEIGH, NC 27610

CLIENT



222 W. HARGETT ST - 6TH FLOOR
RALEIGH, NC

DRAWING TITLE

REFLECTED CEILING PLAN

REVISIONS

NUMBER	DESCRIPTION	DATE

DRAWN BY

Author

A-102

CHECKED BY

Checker

DATE ISSUED

9/6/18

OF

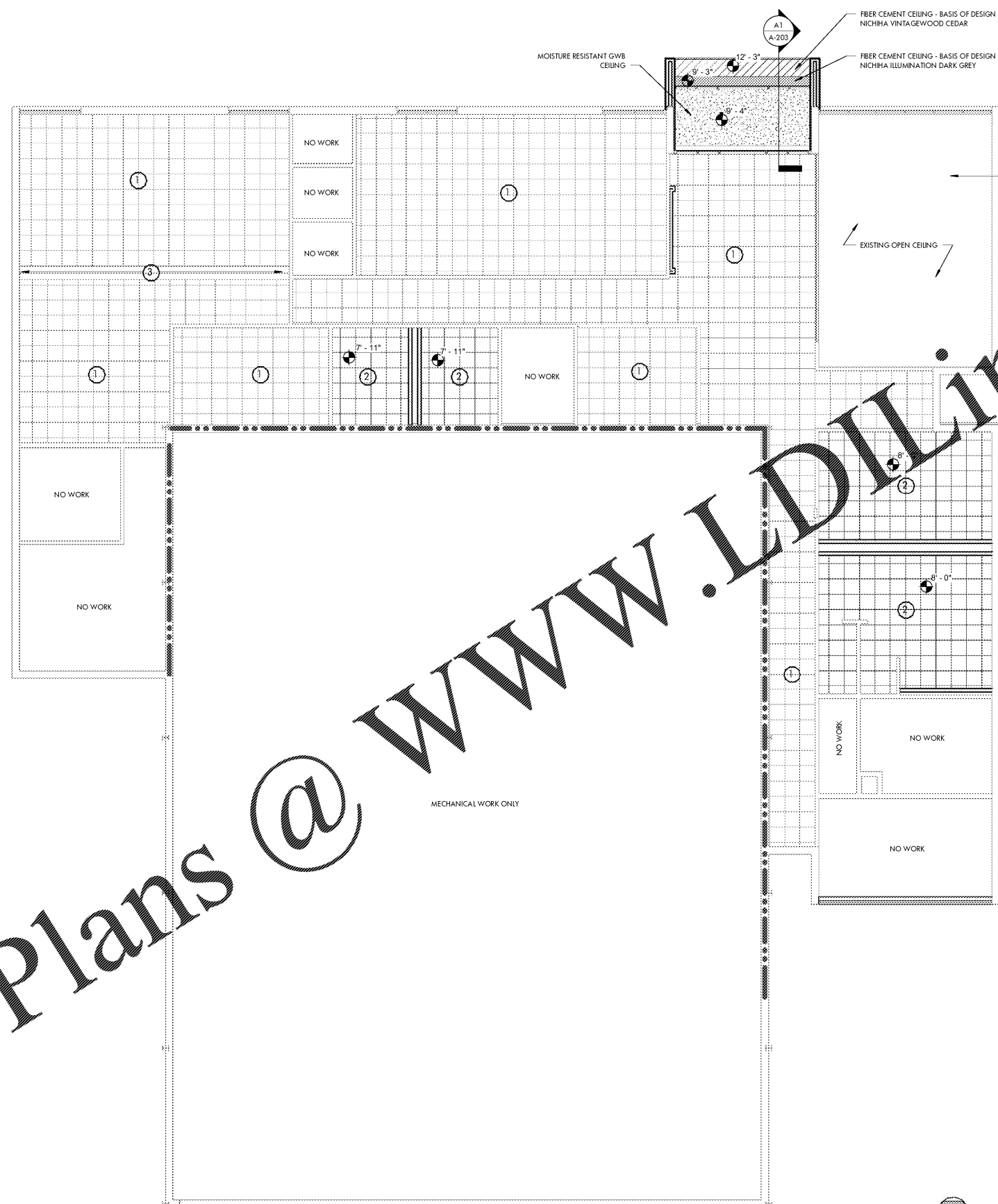

- CEILING NOTES**
- ① EXISTING GRID TO REMAIN - PROVIDE NEW 2'X2' ACOUSTIC CEILING TILE
 - ② PROVIDE NEW CEILING GRID & 2' X 2' MOISTURE RESISTANT ACOUSTIC CEILING TILE
 - ③ PAINT EXISTING GWB SOFFIT - REFER TO FINISH SCHEDULE

- NEW CONSTRUCTION PARTITION LEGEND**
- EXISTING 6" CMU PARTITION TO BE DEMOLISHED
 - EXISTING 6" CMU PARTITION TO REMAIN
 - EXISTING 2 HOUR CMU FIRE BARRIER TO DECK TO REMAIN
 - NEW 6" CMU PARTITION TO DECK
 - NEW PARTITION TO GRID - PROVIDE 3 5/8" METAL STUDS AT 16" OC WITH 5/8" GWB ONE SIDE TO GRID

A1 REFLECTED CEILING PLAN
A-102 1/8" = 1'-0"

Order Plans @ www.IDIline.com