



EXPIRATION DATE:
 COPYRIGHT NOTICE
 THE DRAWINGS ARE THE PROPERTY OF RIVER STREET ARCHITECTURE LLC. ANY REUSE, REPRODUCTION, DISPLAY OR SALE OF THESE DRAWINGS WITHOUT THE EXPRESS WRITTEN CONSENT OF THE ARCHITECT IS STRICTLY PROHIBITED.

river street architecture
 architecture planning interiors
 123 E 7th street, suite 400, chattanooga, tennessee 37402
 p: 423 634 0806 www.riverstreetarchitecture.com

RENOVATION + PET/CT PROJECT
 CHATTANOOGA OUTPATIENT CENTER
 1301 MCCALLIE AVE, CHATTANOOGA TN 37404

Revision Schedule		
Rev. #	Rev. Date	Revision Description

Release Date: 5.3.2019
 Project No.: 19010
POWER PLAN

Project #: 1921
E2.02

ELECTRICAL NOTES:

REFERENCED:

- 1 PROVIDE POWER FOR MOBILE CT TRAILER. MOBILE CT RECEPT. PROVIDE 3P-200A DISC SW FUSED AT 150A (NEMA 3R) AND RUSSELLSTOLL RECEPTACLE #DF 2504 FRABO WITH SPRING DOOR. MOUNT RECEPTACLE MIN 42" AFF. PROVIDE CONC BASE AND UNISTRUT SUPPORT AS REQUIRED. VERIFY EXACT LOCATION WITH OWNER AND VENDOR. PROVIDE 2"C. FOR TEL & DATA FROM MOBILE UNIT TO BUILDING AS DIRECTED.
- 2 TV WALL BOX (VERIFY MOUNTING HEIGHT PRIOR TO ROUGH-IN), WITH DUPLEX RECEPTACLE AND COAXIAL CONNECTOR FOR TV. BOX TO BE STEEL, FLUSH MOUNTED, 2 GANG, WITH WHITE TRIM PLATE, EQUAL TO ARLINGTON TVBSS05. STUB 3/4"C. FROM LOW VOLTAGE COMPARTMENT TO AN ACCESSIBLE LOCATION ABOVE CEILING OR AS DIRECTED.
- 3 PROVIDE CAT5e OUTLET ABOVE CEILING FOR WIFI ACCESS POINT. VERIFY EXACT LOCATIONS AND REQUIREMENTS WITH OWNER.
- 4 PROVIDE POWER FOR VAV BOX. PROVIDE LOCAL DISCONNECT AT VAV BOX.
- 5 PROVIDE WIRING AND RACEWAYS FOR PET/CT SYSTEM (SIEMENS BIOGRAPH SENSATION 16, 277/480V, 3PH) AS INDICATED ON VENDOR DRAWINGS, INCLUDING 277/480V, 3PH MAIN POWER FEEDER (MIN 4 #1/0, #1/0 GD, 2"C.) FROM 3P-125A BKR (HBA-2,4,6), 3P-150A MAIN ENCLOSED CIRCUIT BREAKER WITH SHUNT TRIP (NEMA 1, SURFACE MOUNTED), DOOR SWITCH, WARNING LIGHT, EMERGENCY STOP, INTERCONNECTING RACEWAYS, J-BOXES, ENCLOSURES, AND CABLING, AS APPLICABLE. COORDINATE REQUIREMENTS WITH VENDOR PRIOR TO ROUGH-IN.
- 6 PROVIDE DUPLEX RECEPTACLE (WP, GF TYPE) AT HVAC EQUIPMENT, LOCATED WITHIN 25 FT. OF ROOF-MOUNTED EQUIPMENT. CONNECT RECEPTACLE(S) TO NEAREST SUITABLE 1P-20A CIRCUIT OR AS INDICATED.
- 7 PROVIDE POWER FOR PET/CT CHILLER ON ROOF. PROVIDE 3P-30A FUSED DISCONNECT SWITCH (NEMA 3R) WITH 3 #8, #10 GD, 1"C. CIRCUIT TO 3P-30A BKR (HBA-1,3,5). COORDINATE REQUIREMENTS WITH VENDOR PRIOR TO ROUGH-IN.

UNREFERENCED:

- A COMPLY WITH MANUFACTURER'S INSTALLATION INSTRUCTIONS. ALL EQUIPMENT TO BE INSTALLED IN STRICT ACCORD WITH MANUFACTURER'S INSTALLATION INSTRUCTIONS, UNLESS SPECIFICALLY DIRECTED OTHERWISE BY THE OWNER. ADJUST RATINGS AND TYPES OF CIRCUIT OVERCURRENT PROTECTION DEVICES TO COMPLY WITH ACTUAL NAMEPLATE DATA OF EQUIPMENT. COORDINATE REQUIREMENTS WITH OTHER CONTRACTORS AND VENDORS.
- B PENETRATIONS OF FIRE-RATED BUILDING COMPONENTS BY RACEWAYS AND CABLES TO BE PROVIDED WITH APPROPRIATE FIRE BARRIERS. METHODS AND MATERIALS TO BE UL LISTED AND SHALL CONFORM TO THE REQUIREMENTS OF ASTM-E814/UL1479.
- C PENETRATIONS OF SMOKE BARRIER BUILDING COMPONENTS BY RACEWAYS AND CABLES TO BE PROVIDED WITH APPROPRIATE SMOKE-TIGHT CAULKING AND/OR SEALS.
- D WHERE CONDITIONS DICTATE THAT BOXES CAN NOT BE OFFSET 24", PROVIDE INTUMESCENT PUTTY PADS AROUND EXTERIOR OF BOX, EQUAL TO STI "SSP PUTTY PADS". WHERE EXTERNAL PADS CANNOT BE USED, PROVIDE FIRESTOP INSERT IN BOX, EQUAL TO STI "EP POWER SHIELD INSERTS".
- E MULTIWIRE BRANCH CIRCUITS ARE NOT PERMITTED. MULTIPLE LIGHTING AND APPLIANCE CIRCUITS MAY NOT BE COMBINED TO UTILIZE COMMON NEUTRAL CONDUCTOR. (REFER TO NEC 210.4)
- F WHERE POSSIBLE, IN FINISHED AREAS CONCEAL WIRING IN NEW CONSTRUCTION. WHERE IMPRACTICAL TO CONCEAL AT EXISTING CONSTRUCTION, USE SURFACE RACEWAY SYSTEM EQUAL TO WIREMOLD #2000.
- G WHERE APPLICABLE, RECEPTACLES INSTALLED IN AREAS CLASSIFIED BY NEC ARTICLE 517 AS "PATIENT CARE AREA" TO BE NEMA 5-20R "HOSPITAL GRADE". WIRING METHODS IN THESE AREAS TO COMPLY WITH NEC 517.
- H ALL INFORMATION FOR IMAGING EQUIPMENT SHOWN IS FOR ESTIMATING PURPOSES ONLY. COORDINATE ALL REQUIREMENTS FOR IMAGING EQUIPMENT WITH OWNER AND IMAGING SYSTEM VENDOR PRIOR TO ROUGH-IN.

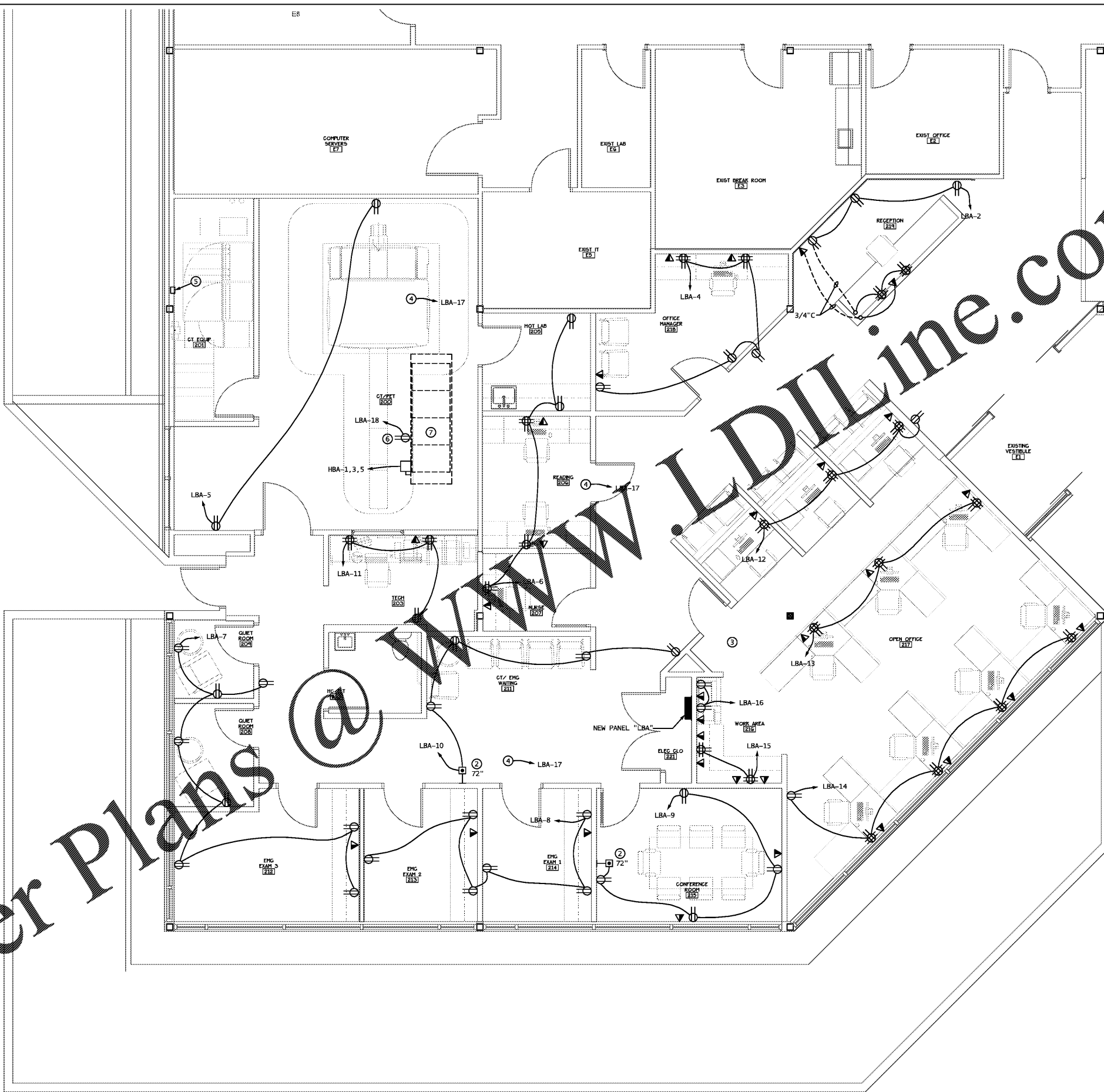

Order Plans @ WWW.IDIline.com

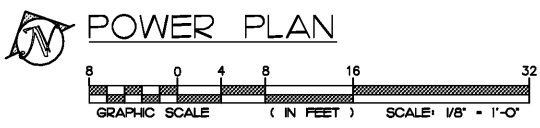

Smith Engineering
 Mechanical & Electrical
 Professional Corporation
 103 Jordan Drive STE 1 Chattanooga, TN 37421
 Phone: (423)499-9332 Fax: (423)894-4440