



# CHARLOTTE PREMIUM OUTLETS

5518 NEW FASHION WAY, SUITE #510  
CHARLOTTE, NC 28278

TENANT FIT UP  
STORE #232

**NOTE TO G.C.'S**  
REFERENCE TENANT CONTRACTOR INFORMATION AND REGULATIONS INCLUDED IN BID DOCS.

**DEFERRED SUBMITTALS**  
SPRINKLER, FIRE ALARM, SIGNAGE

**LIST OF DRAWINGS**

	LL REVIEW & PERMIT 4/15/19	Release Issue 2	Release Issue 3	Release Issue 4	Release Issue 5	Release Issue 6	Release Issue 7	Release Issue 8	Release Issue 9
<b>GENERAL</b>									
G 110	TITLE SHEET	●							
G 120	LIFE SAFETY PLAN & CODE REVIEW	●							
G 121	ACCESSIBILITY DETAILS	●							
G 130	GENERAL INFORMATION & NOTES	●							
G 140	SCHEDULES	●							
<b>DEMOLITION</b>									
D 110	DEMOLITION PLAN, RCP & NOTES								
<b>ARCHITECTURAL</b>									
A 110	CONSTRUCTION PLAN & DETAILS								
A 120	REFLECTED CEILING PLAN & SCHEDULE	●							
A 130	FIXTURE PLAN & SCHEDULE	●							
A 131	REFLECTED CEILING DISPLAY DETAILS	●							
A 140	FINISH PLAN & SCHEDULE	●							
A 150	POWER & DATA PLAN & DETAILS	●							
A 151	LOW VOLTAGE DIAGRAMS	●							
A 210	EXTERIOR ELEVATIONS	●							
A 310	INTERIOR ELEVATIONS	●							
A 410	DETAILS & ELEVATIONS	●							
A 420	DETAILS & ELEVATIONS	●							
A 510	DOOR SCHEDULE & DETAILS	●							
<b>ENGINEERING</b>									
SP 110	SPRINKLER PLAN	●							
P 110	PLUMBING PLAN	●							
M 110	MECHANICAL PLAN	●							
M 120	MECHANICAL SCHEDULE & SCHEMATICS	●							
M 130	MECHANICAL SPECIFICATIONS	●							
E 110	POWER PLAN	●							
E 111	POWER PLAN	●							
E 120	LIGHTING PLAN	●							
E 121	LIGHT FIXTURE SCHEDULE	●							
E 130	ELECTRICAL SCHEDULES & SCHEMATICS	●							
E 140	ELECTRICAL SPECIFICATIONS	●							
E 150	LIGHTING CONTROL GENERAL INFORMATION	●							

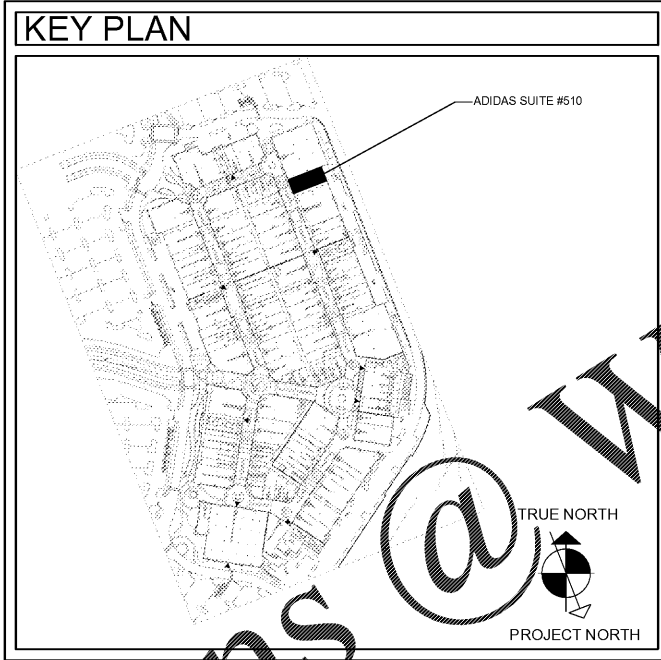
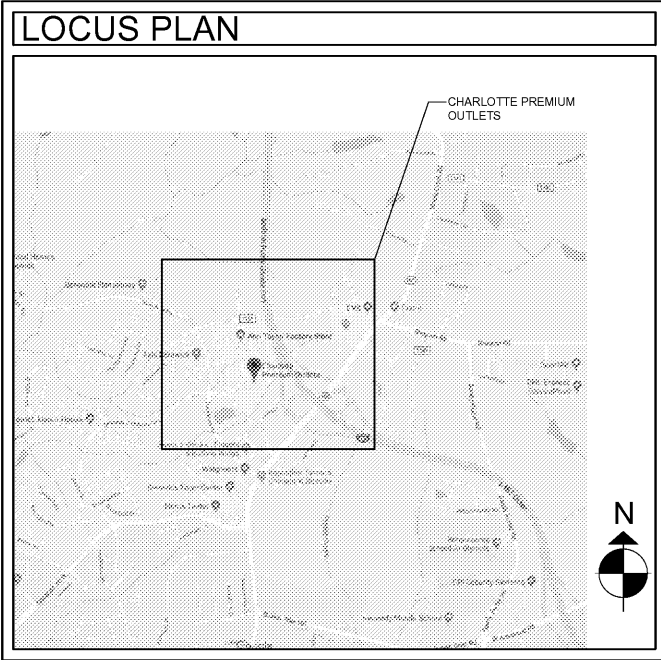

**PROJECT DIRECTORY**

<b>OWNER</b>	REEBOK INTERNATIONAL, LTD. 25 DRYDOCK AVENUE, SUITE 110E BOSTON, MA 02210	
<b>ARCHITECT</b>	BKA ARCHITECTS, INC. 142 CRESCENT ST. BROCKTON, MA 02301	LINDSAY MCARDLES KEITH BATTEN COURT LMCARDLES@BKAARCHS.COM (508) 583-5603
<b>ME/FP/ENGINEER</b>	MENGINEERING 75 BROOKSIDE BLVD WATERVILLE, ME 04891	CHRISTINE DEWULF CDEWULF@ENGINEERING.US.COM
<b>BUILDING DEPARTMENT</b>	MECKLENBURG COUNTY CODE ENFORCEMENT 145 SUTTLE AVE. CHARLOTTE, NC 28208	980-314-2633
<b>TENANT REPRESENTATOR</b>	SIMON PROPERTIES 104 FALABELLA DR STEPHENS CITY, VA 22655	JOAN SCHNEIDER JSCHNEIDER@SIMON.COM 862-485-9741 (CELL) 540-868-8857 (OFFICE)

**DRAWING LEGEND**

	DEMOLITION U.N.O.	<b>Room name</b>	ROOM NUMBER
	NEW CONSTRUCTION		101
	EXISTING TO REMAIN		DOOR NUMBER
	PARTITION TYPE		WINDOW TYPE
	ELEVATION		INTERIOR FINISH TYPE
	SECTION		EXTERIOR FINISH TYPE
	DETAIL		GRID LINE
	EXTERIOR ELEVATION		REVISION NO. AND REVISION CLOUD
	INTERIOR ELEVATION		

**ABBREVIATIONS**

A.C.	ACCESSORY CEILING PANEL	EXT.	EXTERIOR	NO	NUMBER	U.N.O.	UNLESS NOTED OTHERWISE
A.F.F.	ABOVE FINISH FLOOR	F.D.	FLOOR DRAIN	O.A.E.	OR APPROVED EQUAL	U.S.	UNDERSIDE
A.L.J.	AUTHORITY HAVING JURISDICTION	F.O.	FINISHED OPENING	O.C.	ON CENTER	VIF	VERIFY IN FIELD
A.D.J.	ADJUSTABLE	F.R.G.W.B.	FIRE RATED GYPSUM WALL BOARD	O.F.	OUTSIDE FACE	W	WITH
ALT	ALTERNATE	F.S	FRAME SIZE	O.F.C.I.	OWNER FURNISHED CONTRACTOR INSTALLED		
ALUM	ALUMINUM	FIN	FINISH	OPP	OPPOSITE		
B.O.	BOTTOM OF	FLR	FLOOR	P. LAM	PLASTIC LAMINATE		
B.O.H.	BOARD OF HEALTH	FNDN	FOUNDATION	P.R	PATCH AND REPAIR		
BLDG	BUILDING	GA	GAUGE	PREP	PREPARE		
C.L.	CENTER LINE	GC	GENERAL CONTRACTOR	PTD	PAINTED		
CLG	CEILING	GWB	GYPSUM WALLBOARD	R.O.	ROUGH OPENING		
CLR	CLEAR	GYP	GYPSUM	REQ'D	REQUIRED		
CMU	CONCRETE MASONRY UNIT	HR	HOUR	REV.	REVISION(S) OR REVISED		
CONC	CONCRETE	INSUL	INSULATED	S.A.	SOUND ATTENUATING		
CONST	CONSTRUCTION	INT.	INTERIOR	SIM	SIMILAR		
CONT	CONTINUOUS	M.O.	MASONRY OPENING	SPEC	SPECIFICATIONS		
D.A.F.S.	DIRECTLY APPLIED FINISH SYSTEM	M.R.G.W.B.	MOISTURE RESISTANT GYPSUM WALL BOARD	STFT	STOREFRONT		
D.F.	DRINKING FOUNTAIN	MAX	MAXIMUM	STRUCT	STRUCTURAL		
DB	DESIGN BUILD	MFGR'S	MANUFACTURER'S	SUB-C	SUBCONTRACTOR		
DIM	DIMENSION	MIN	MINIMUM	T.M.E.	TO MATCH EXISTING		
DWG	DRAWING	MIRR	MIRROR	T.O.	TOP OF		
E.T.R.	EXISTING TO REMAIN	MTD	MOUNTED	TELE	TELEPHONE		
ENG	ENGINEER	MTL	METAL	TEMP	TEMPERED		
ENG'D	ENGINEERED	N.T.S	NOT TO SCALE	TYP.	TYPICAL		
EXIST.	EXISTING	N/A	NOT APPLICABLE	U.L	UNDERWRITERS LABORATORIES		
		NIC	NOT IN CONTRACT				

CONSULTANT

SEAL

ISSUED

4/12/19 LL & PERMIT REVIEW

REVISIONS

OWNER/CLIENT  
**REEBOK INTERNATIONAL**

PROJECT  
**CHARLOTTE PREMIUM OUTLETS**

5518 NEW FASHION WAY  
SUITE #510  
CHARLOTTE, NC 28278

DRAWING TITLE  
**TITLE SHEET**

DRAWING INFORMATION  
Job Number: **219007**  
Checked By: **KTB**  
Drawn By: **LJM**

DRAWING NUMBER  
**G**  
**110**