

PRELIMINARY NOT FOR CONSTRUCTION

PROJECT: STARBUCKS SHELL BUILDING
CORNER OF US 321 AND SEEHORNE STREET
LENOIR, NC
DRAWING: ROOF PLAN

Revisions

REVISION	DATE

PROJECT DATE
11/01/2018

Drawn By
MTP

Checked By
TD

Sheet No.
A161

WALL TYPE LEGEND

6" MTL. STUD EXTERIOR WALL - 1/2" OSB SHEATHING ON EXTERIOR FACE OF STUDS - REFER TO EXTERIOR ELEVATIONS FOR FINISH

DIMENSION NOTES:

- 3'-0" TO FACE OF STUD
- 3'-0" MIN. MINIMUM DIMENSION ALLOWED (MAY BE MORE)
- 3'-0" MAX. MAXIMUM DIMENSION ALLOWED (MAY BE LESS)
- 3'-0" CONTACT DISTANCE BETWEEN FINAL FINISHED SURFACES (DIMENSIONS ARE TO FACE OF FRAMING UNLESS OTHERWISE NOTED)
- 3'-0" TARGET DIMENSION WHICH MAY NOT BE ACHIEVED IN FIELD - BE AWARE OF POSSIBLE CHANGE
- ALIGN ALIGN THESE FINISH SURFACES

GENERAL NOTES

- G.C. TO COORDINATE ALL ROOF PENETRATIONS WITH ROOFING CONTRACTOR, MECHANICAL CONTRACTOR AND PRODUCTION EQUIPMENT SUPPLIER.
- ROOFING VENDOR TO PROVIDE AND INSTALL ROOFING MEMBRANE, SCUPPERS, MAIN ROOF DOWNSPOUTS, DRAIN SADDLES, MECHANICAL CURBS, WALL FLASHING, ROOF FLASHING (INCLUDING ROOF WALK WAY MATS).

CONSTRUCTION NOTES

- MECHANICAL HVAC UNIT - RE: MECH DWGS. FOR EXACT LOCATION
- EXTERIOR WALL SIGNAGE TO BE PROVIDED & INSTALLED BY OWNERS NATIONAL SIGN VENDOR. EC TO COORDINATE WITH SIGN VENDOR AND PROVIDE ELECTRICAL SUPPLY AT SIGN LOCATIONS AS REQUIRED. SEE ELEC. FOR J-BOX LOCATIONS.
- LINE OF CANOPY BELOW - PROVIDED AND INSTALLED BY CANOPY VENDOR, GENERAL CONTRACTOR TO PROVIDE AND INSTALL BLOCKING AS REQUIRED.
- MANUFACTURER FINISHED 2-PIECE FLEX SNAP-ON COMPRESSION EDGING OVER CONTINUOUS SINGLE-PLY ROOF MEMBRANE - REFER TO DRAWING A- FOR CANOPY DIMENSIONS AND DETAILS.
- INTERIOR ROOF DRAIN AND OVERFLOW REFER TO DETAIL -- AND SEE PLUMBING DRAWINGS AND CIVIL DRAWINGS. TIE INTO STORM WATER.
- GAS PIPING TO RUN UP AND OVER PARAPET WALL - REFER TO PLUMBING DRAWINGS.
- EXTERIOR ROOFTOP ACCESS LADDER REFER TO DETAIL 4/A9, 8/A12 AND 7/A13.
- CRICKET FOR POSITIVE DRAINAGE W/ TAPERED RIGID INSUL. - SLOPE 1/4" PER FOOT MIN.
- ROOFING VENDOR TO PROVIDE SINGLE PLY REPAIR KIT MOUNTED TO SIDE OF PARAPET WALL FOR FUTURE USE.
- DURO-LAST SINGLE PLY ROOF MEMBRANE.
- PROVIDE AND INSTALL RIGID ROOF INSULATION AS REQUIRED PER LOCAL ENERGY CODE - SEE ENERGY CODE SUMMARY ON THE APPENDIX B FOR FURTHER INFORMATION. INSTALL REQUIRED RIGID INSULATION AND THEN INSTALL SLOPED TAPERED INSULATION FOR POSITIVE WATER DRAINAGE ON THE ROOF.
- WALK MATS PROVIDED & INSTALLED BY NATIONAL ROOFING VENDOR. UNDER SEPARATE CONTRACT.
- ROOF TOP CONDENSING UNIT FASTENED TO TREATED 4X4. PROVIDE ADDITIONAL LAYER OF ROOF MEMBRANE UNDER CONDENSERS. TREATED 4X4 UNDER EQUIPMENT TO BE INSTALLED IN THE DIRECTION OF THE ROOF SLOPE.
- RESTROOM EXHAUST FAN - REFER TO MECHANICAL DRAWINGS

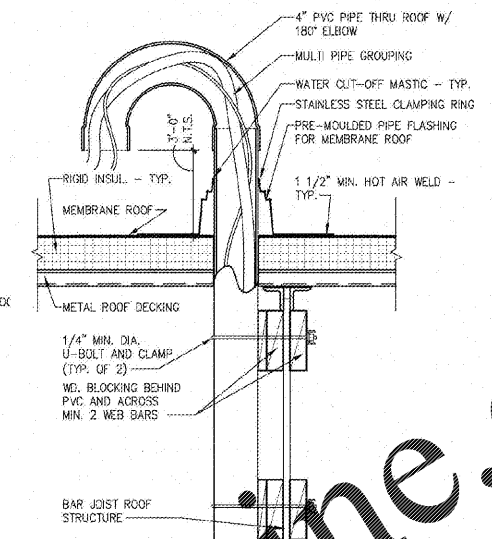

2 CONDUIT PENETRATION DETAIL
A161 SCALE: 1 1/2" = 1'-0"

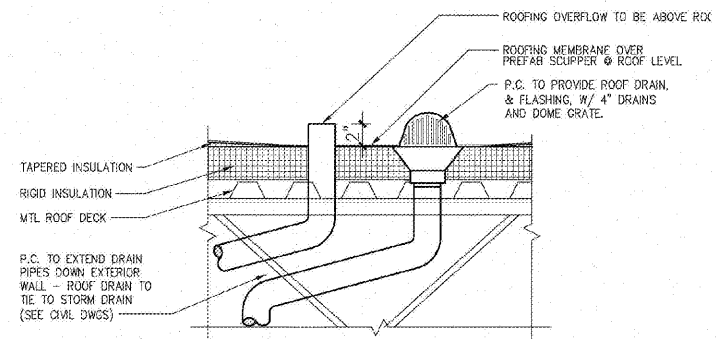

3 INTERNAL ROOF DRAIN AND OVERFLOW DETAIL
A161 SCALE: 1 1/2" = 1'-0"

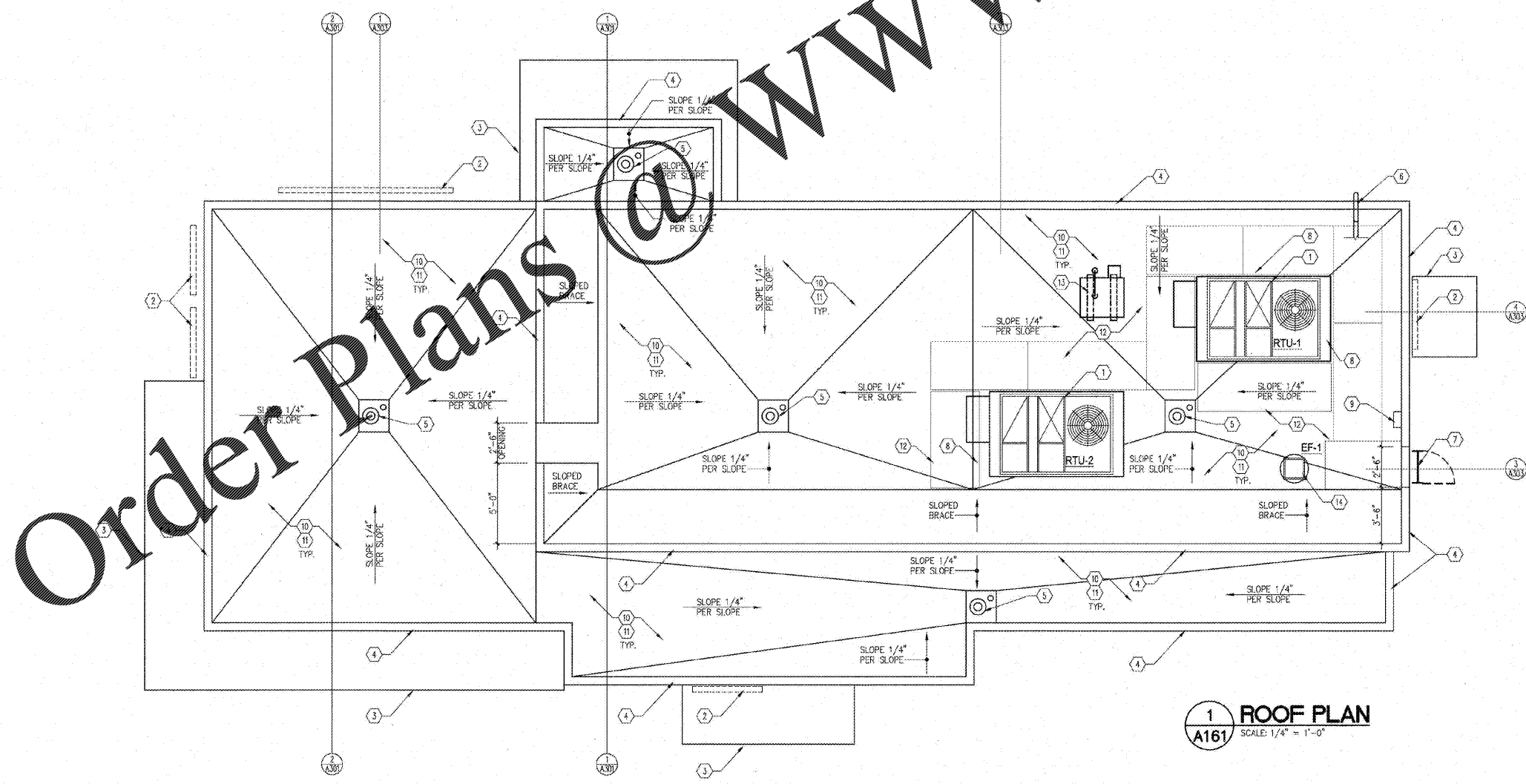

1 ROOF PLAN
A161 SCALE: 1/4" = 1'-0"

Order Plans

WWW.LDLINE.COM