

SPECIFIC DEVELOPMENT PLAN FOR BURGER KING NAHUNTA, GA.

OWNER

PREMIER KINGS COMPANIES
5525 CARMICHAEL ROAD
MONTGOMERY, ALABAMA 36117
(256) 945-9979

24-HOUR CONTACT

JOHN HOWARD
PREMIER KINGS COMPANIES
j.howard@premierkings.com
5525 CARMICHAEL ROAD
MONTGOMERY, ALABAMA 36117
(256) 945-9979

CIVIL ENGINEERING PLANS	
SHEET 1	TITLE SHEET
SHEET 2	GENERAL NOTES
SHEET 3	EXISTING CONDITIONS/DEMOLITION PLAN
SHEET 4	STAKING PLAN
SHEET 5	GRADING PLAN
SHEET 6	DRAINAGE PLAN
SHEET 7	UTILITY PLAN
SHEET 8-13	DETAILS
SHEET 14	LANDSCAPE PLAN
SHEET 15	IRRIGATION PLAN
SHEET EC01-EC02	SWPPP NOTES
SHEET EC03	EROSION CONTROL PLAN (INITIAL)
SHEET EC04	EROSION CONTROL PLAN (INTERMEDIATE)
SHEET EC05	EROSION CONTROL PLAN (FINAL)
SHEET EC06-EC09	SWPPP DETAILS
SHEET A3	GDOT SPECIAL DETAIL A-3
SHEET A4	GDOT SPECIAL DETAIL A-4
SHEET T-11A	GDOT STANDARD DETAIL T-11A
SHEET 9032B	GDOT STANDARD DETAIL 9032B

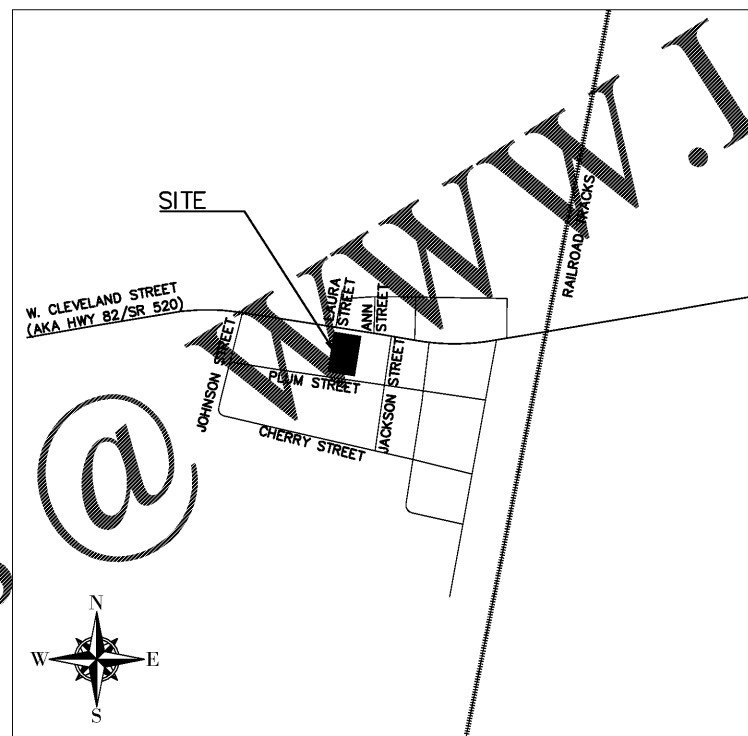

VICINITY MAP
N.T.S.

LOCATION: N31° 12' 06", W81° 59' 22.8"W
TOTAL DISTURBED ACREAGE: 1.81 AC.
TOTAL SITE ACREAGE: 1.49 AC.

ENGINEER

T. R. LONG ENGINEERING, P.C.
114 NORTH COMMERCE STREET
HINESVILLE, GEORGIA 31313
(912) 368-5664

DRAWING LEGEND		
DESCRIPTION	PROPOSED	EXISTING
RIGHT OF WAY	— R/W	— R/W
EDGE OF PAVEMENT	—	—
DITCH CENTERLINE	—	—
SANITARY SEWER	—	—
WATER LINE	— 10"W	— 10"W
FORCE MAIN	— FM	— FM
UNDERGROUND GAS LINE	— 8"C	— 8"C
CONTOURS	(81)	(81)
STORM DRAINAGE PIPE	—	—
ELEVATION	TP 17.82	TP 17.82
SILT FENCE TYPE A	(S1-A)	(S1-A)
SILT FENCE TYPE B	(S1-B)	(S1-B)
SILT FENCE TYPE C	(S1-C)	(S1-C)
SEDIMENT BARRIER	(S2-B)	(S2-B)
CHECK DAM— HAY BALE	(C4-1B)	(C4-1B)
CHECK DAM — RIP RAP	(C4-2B)	(C4-2B)
CONSTRUCTION EXIT	(C)	(C)
STORM OUTLET PROTECTION	(S)	(S)
SILT FENCE	—	—
MULCHING	(D1)	(D1)
TEMPORARY GRASSING	(D2)	(D2)
PERMANENT GRASSING	(D3)	(D3)
FIRE HYDRANT	—	—
SEWER MANHOLE	—	—
WATER VALVE	—	—
DRAINAGE FLOW	—	—
WATER METER	—	—
BENCHMARK	—	—
WELL	—	—
GUY POLE	—	—
IRON PIN	—	—
TELEPHONE PEDESTAL	—	—
POWER POLE	—	—
	SET ○ I.P.S	FOUND ○ I.P.F



T. R. Long Engineering, P.C.
SAVANNAH
306 Commercial Drive
Savannah, Georgia 31406
Office (912) 335-1046

HINESVILLE
114 North Commerce St.
Hinesville, Georgia 31313
Office (912) 368-5664
www.trlongeng.com

SPECIFIC DEVELOPMENT
PLAN FOR BURGER KING
NAHUNTA, GEORGIA

SHEET NAME:	TITLE SHEET
REVISIONS:	
1.	
2.	
3.	
4.	
5.	
6.	
7.	
8.	
9.	
10.	
INITIAL DATE: 4/01/2019	
DRAWN BY: BDP	
CHECKED BY: TR L	
PROJECT #: 2019-147	
SHEET NUMBER:	C-01