

CEILING KEYNOTES

- EXISTING CEILING GRID AND TILE TO BE REMOVED.
- EXISTING CEILING TILE TO BE REPLACED AND INFILLED/ PATCHED AS REQUIRED.
- EXISTING HVAC GRILLES TO BE RELOCATED AS REQUIRED.
- EXISTING HVAC GRILLES TO BE REPLACED ON SALES FLOOR AND 5-POS AREA PER REFLECTED CEILING PLAN.
- EXISTING EXIT SIGN AND EXTERIOR LIGHTS TO REMAIN.
- EXISTING EXIT SIGN TO BE RELOCATED PER REFLECTED CEILING PLAN.
- EXISTING CANOPY TO REMAIN.
- EXISTING TRACK AND TRACK LIGHTS FIXTURE TO BE REMOVED.
- EXISTING LIGHT FIXTURES TO BE REMOVED.
- EXISTING SECURITY SHUTTERS TO REMAIN.
- EXISTING DECORATIVE SOFFIT TO BE REMOVED.
- EXISTING LIGHT FIXTURE TO BE RELOCATED.

DEMOLITION NOTES REFER TO T-001 FOR GENERAL NOTES.

- DIMENSIONS ARE TO FACE OF SUBSTRATE, MASONRY AND/OR TO COLUMN REFERENCE LINES, UNLESS NOTED OTHERWISE.
 - THESE DRAWINGS WERE PREPARED BASED ON INFORMATION ATTAINED FROM A SITE SURVEY. CONTRACTOR TO VERIFY ALL EXISTING CONDITIONS IN FIELD PRIOR TO DEMOLITION & NOTIFY THE ARCHITECT IN CASE OF DISCREPANCIES IMMEDIATELY. DEMOLITION IS TO BE EXECUTED SO AS NOT TO DISTURB EXISTING STRUCTURAL & ROOFING SYSTEMS, AND OTHER AREAS THAT ARE INTENDED TO REMAIN INTACT. VERIFY ALL CONSTRUCTION TO BE REMOVED THAT IS NOT INTEGRAL TO STRUCTURAL SYSTEM PRIOR TO DEMOLITION UNLESS NOTED.
 - ALL DIMENSIONS SHOWN AS EXISTING SHOULD BE FIELD VERIFIED BY CONTRACTOR PRIOR TO DEMOLITION. VERIFY ALL DEMOLITION WORK W/ NEW CONSTRUCTION & INSTALLATION DRAWINGS PRIOR TO BEGINNING CONSTRUCTION.
 - DEMOLITION CONTRACTOR TO COORDINATE & REVIEW ALL CONSTRUCTION DOCUMENTS & DETERMINE THE EXTENT OF DEMOLITION WORK, & BECOME FAMILIAR WITH THEM THOROUGHLY BEFORE PERFORMING ANY DEMOLITION WORK. BY THE TIME OF STARTING DEMOLITION, THE CONTRACTOR WILL BE DEEMED TO HAVE COMPLIED WITH THE DRAWING, TO HAVE ACCEPTED SUCH CONDITIONS, AND TO HAVE MADE THE NECESSARY ALLOWANCES IN PREPARING HIS BID.
 - VERIFY DIMENSIONS ON ALL FURNISHINGS, MILLWORK, LIGHTING FIXTURES, ETC. TO BE REMOVED W/ VERIZON PROJECT MANAGER. ALL ITEMS TO BE DISPOSED SHALL BE DISPOSED OF OFF-SITE AND IN AN EXPEDITIOUS MANNER.
- SAWCUT & REMOVE EXISTING SLABS AS REQUIRED FOR UNDERGROUND ELECTRICAL & PLUMBING LINES. REFER TO ELECTRICAL DRAWINGS FOR ALL SAWCUT & TRENCHING WORK REQUIRED. ALL CONCRETE FLOOR WORK TO BE FINISHED FLUSH WITH EXISTING FLOOR. DOWEL NEW SLABS TO EXISTING W/ #4 REBAR @ 24" O.C. EACH SIDE (STAGGERED) UNLESS NOTIFIED OTHERWISE IN STRUCTURAL DRAWINGS. REBAR TO EXTEND 6" INTO EXISTING SLAB & ACROSS CUT OPENING UNLESS NOTED OTHERWISE IN STRUCTURAL DRAWINGS. SECURE REBAR INTO EXISTING SLAB W/ EPOXY GROUT. REPLACE OR REPAIR ANY VAPOR BARRIERS DISTURBED DURING EXCAVATIONS.
- PROTECT FROM DAMAGE DURING CONSTRUCTION ALL EXISTING WALLS, FLOORS, CEILINGS, ETC. THAT ARE TO REMAIN. CONTRACTOR TO PATCH & REPAIR ANY DAMAGED PORTIONS OF THE EXISTING BUILDING AS REQUIRED TO MATCH THE EXISTING ADJACENT CONSTRUCTION & FINISHES.
 - IF CONTRACTOR ENCOUNTERS ANY HAZARDOUS MATERIALS DURING DEMOLITION OR CONSTRUCTION, HE SHALL IMMEDIATELY SUSPEND WORK & NOTIFY THE AREA CONSTRUCTION MANAGER BEFORE PROCEEDING.
 - ALL DEMOLITION SHALL BE CARRIED OUT IN A SAFE MANNER & IN STRICT ACCORDANCE WITH OSHA REGULATIONS.
 - REMOVE ANY SINKS, WATER CLOSETS, URINALS, LAVATORIES, FLOOR DRAINS, NOTED ON DRAWINGS AS WELL AS ALL ASSOCIATED PLUMBING ACCESSORIES. CAP, PLUG ALL ABANDONED SUPPLY & WASTE LINES. PATCH & SEAL ALL FLOOR PENETRATIONS. SEE MECHANICAL & PLUMBING DRAWINGS FOR DETAILED DEMOLITION NOTES.
 - WHEN UTILITIES ARE REMOVED, CAP & SEAL A MINIMUM OF 8" BELOW FINISH FLOOR OR A MINIMUM OF 6" ABOVE FINISH CEILING.
 - ALL EXISTING MECHANICAL EQUIPMENTS AND DUCTWORK TO REMAIN.
 - REMOVE EXISTING FLOOR BOX COVER PLATE AND WIRES NOT BEING USED. INFILL EMPTY BOX WITH CONCRETE TRENCHING FLOOR AS REQUIRED FOR NEW UNDER SLAB CONDUITS AND FLOOR BOX PER ELECTRICAL PLAN.

FLOOR PLAN KEYNOTES

- EXISTING FIXTURE/MILLWORK TO BE REMOVED.
- EXISTING SALES/SERVICE DESK TO BE REMOVED. EXISTING POWER TO BE REMOVED.
- REMOVE FLOOR FINISHES DOWN TO EXISTING SLAB, U.O.N. CLEAN/PATCH AND REPAIR EXISTING CONCRETE SLAB AS REQUIRED FOR NEW FINISHES. REFER TO SHEET A-131.
- CARD READER TO BE RELOCATED.
- EXISTING STOREFRONT AND ENTRY DOOR TO REMAIN.
- EXISTING FIRE EXTINGUISHER TO BE RELOCATED. SEE SHEET G-101 FOR NEW LOCATION.
- EXISTING DOOR, FRAME, & ASSOCIATED HARDWARE TO BE REMOVED AND RELOCATED ON NEW OPERATIONS ROOM.
- EXISTING WALL, WALL COVERING AND WALL BASE TO BE REMOVED.
- EXISTING DOOR, FRAME, & ASSOCIATED HARDWARE TO BE REMOVED AND RELOCATED ON NEW POS AREA.
- NOT USED.
- PREPARE WALL FOR NEW DOOR.
- EXISTING ELECTRICAL METER TO REMAIN.
- HVAC THERMOSTATS TO BE RELOCATED AND REINSTALLED. REFER TO ELECTRICAL DRAWINGS FOR FINAL LOCATION. GC. TO COORDINATE WITH VERIZON CONSTRUCTION PM.
- SECURITY KEY PADS TO BE RELOCATED AND REINSTALLED.
- EXISTING WALK-OFF MAT TO BE REMOVED.
- EXISTING FIRE EXTINGUISHER TO REMAIN.
- EXISTING COPY MACHINE AND SHRED BIN TO BE RELOCATED.
- EXISTING POWER POLE TO BE REMOVED.
- EXISTING SHUTTER DOORS TO BE REMOVED.

FLOOR PLAN LEGEND NOT ALL SYMBOLS BELOW MAY BE USED.

- EXISTING CONSTRUCTION TO BE REMOVED
- EXISTING WALL CONSTRUCTION TO REMAIN
- AREA NOT IN CONTRACT
- 1HR FIRE RATED WALL

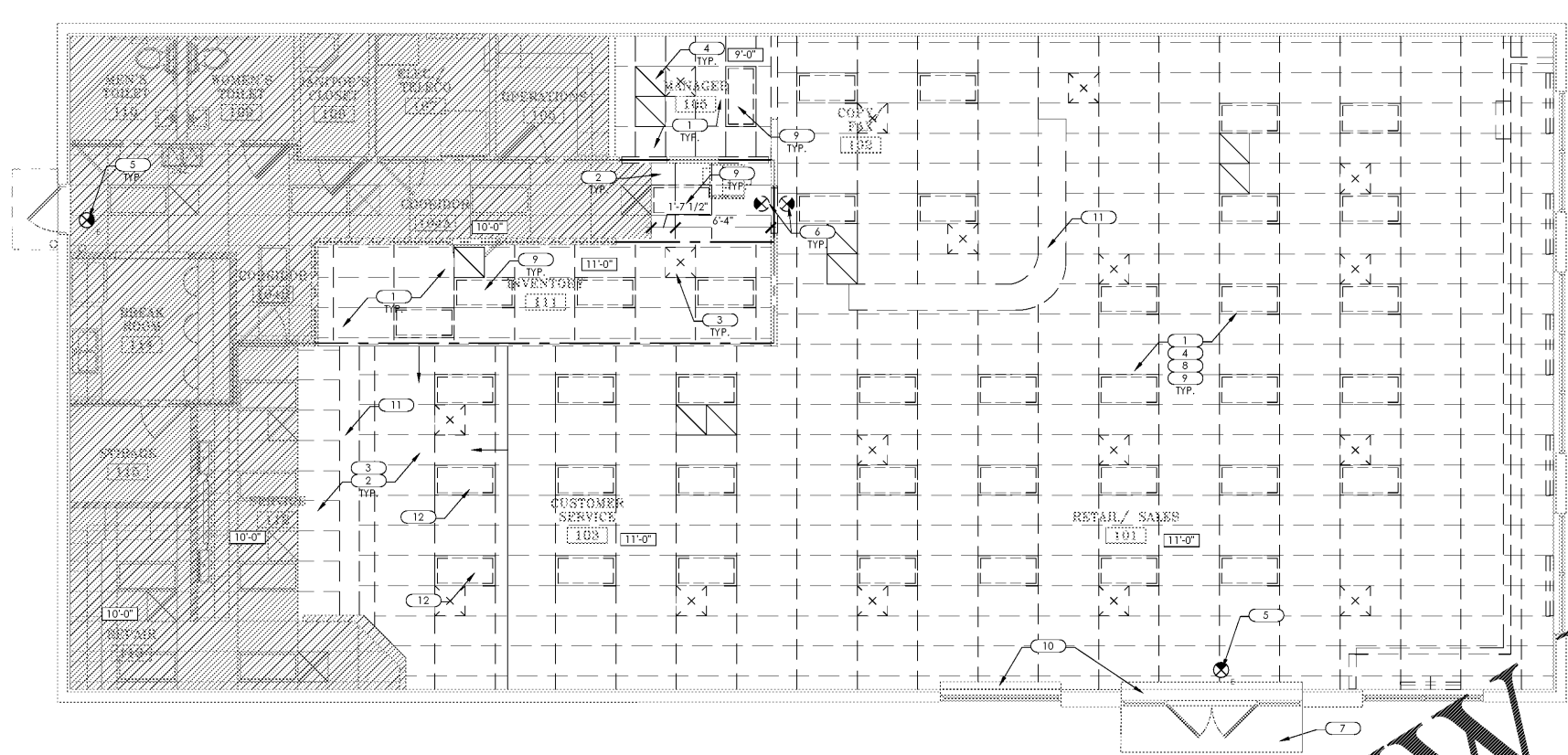

2 DEMOLITION CEILING PLAN
SCALE: 3/16" = 1'-0"

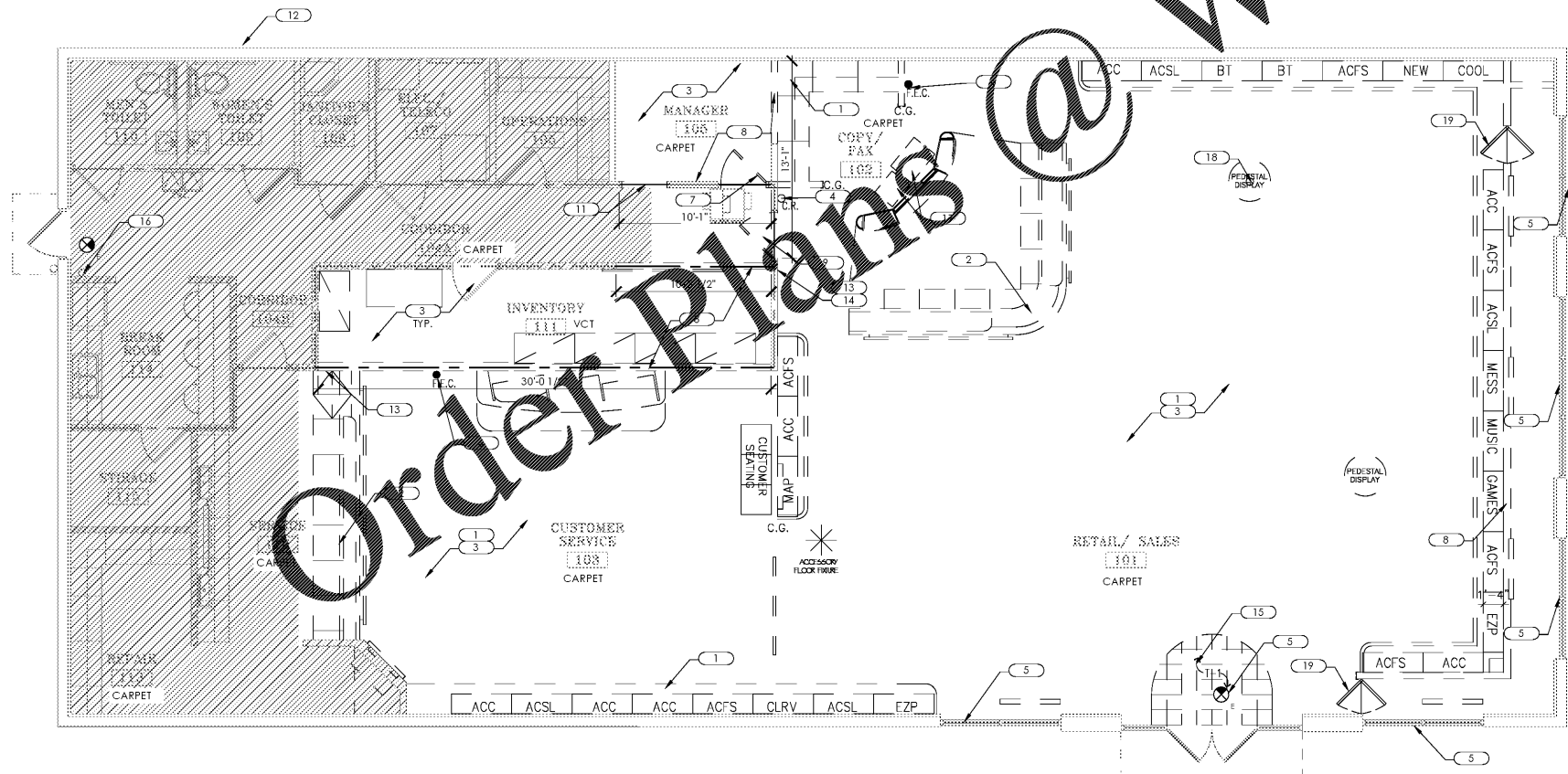

1 DEMOLITION FLOOR PLAN
SCALE: 3/16" = 1'-0"

Order Plans @

WWW.LDILine.com



VERIZON WIRELESS
NEXT GEN
149 FITNESS WAY
JOHNSON CITY, TN
37604



46 East Main Street
Suite 201
Cohen, TN 38204
908.463.3700
www.coreeng.com

ARCHITECT OF RECORD



ISSUE	DATE	DESCRIPTION
-	04/01/19	PERMIT/ BID SET

PROJECT INFORMATION

PROJECT NO:	V2W.26122
DATE:	04/01/2019
SCALE:	AS NOTED
DRAWN BY:	A. KLINKE
CHECKED BY:	V. ALVAREZ

DEMOLITION FLOOR & CEILING PLAN

SHEET NUMBER

D-101

P:\Verizon Wireless Johnson City, TN\141 Fitness Way\2019\2019 AMP\Drawings\10-Demolition\Floor & Ceiling\Flooring.dwg
Author: April 11, 2019 1:52:57 PM