



ISSUE	DATE	DESCRIPTION
-	03/25/19	ISSUED FOR PERMIT

PROJECT INFORMATION

PROJECT NO:	V2W.26121
DATE:	03/13/2019
SCALE:	AS NOTED
DRAWN BY:	N.GLUKHOMAN
CHECKED BY:	V.ALVAREZ

SHEET TITLE

LIFE SAFETY & ACCESSIBILITY PLAN

SHEET NUMBER

G-101

LIFE SAFETY/ ACCESSIBILITY NOTES

WHILE IT IS THE INTENT OF THE ARCHITECT, HIS/HER EMPLOYEES, AND ASSIGNS TO ADHERE TO ALL ASPECTS AND REGULATIONS OF THE AMERICANS WITH DISABILITIES ACT (ADA) AND LOCAL ACCESSIBILITY CODES, THE CONTRACTOR SHALL NOT BE RELIEVED OF SOLE RESPONSIBILITY TO VERIFY ALL REQUIREMENTS OF SAID ACTS AS PERTAINING TO CONTRACT DOCUMENT CONTAINED HEREIN PRIOR TO COMMENCEMENT OF ANY WORK.

THE CONTRACTOR SHALL ALSO BE RESPONSIBLE TO IMMEDIATELY NOTIFY THE ARCHITECT OF POSSIBLE DISCREPANCIES & TO PAY SPECIAL ATTENTION TO ITEMS LISTED BELOW:

- A. REFER TO COVER SHEET FOR CODE SUMMARY & BUILDING DATA.
- B. REFER TO ARCHITECTURAL FLOOR PLANS FOR BUILDING DIMENSIONS.
- C. REQUIRED ACCESSIBLE PARKING SPACES, CROISS WALKS, SIGNS, ETC., SHALL COMPLY WITH CURRENT STATE AND LOCAL CODES.
- D. TACTILE EXIT SIGNS SHALL BE PROVIDED AT THE FOLLOWING LOCATIONS:
 - D.1. EACH GRADE LEVEL EXTERIOR DOOR SHALL BE IDENTIFIED BY A TACTILE EXIT SIGN WITH THE WORD "EXIT".
 - D.2. EACH EXIT, EXCEPT EXTERIOR DOOR FROM AN INTERIOR ROOM OR AREA TO A CORRIDOR OR HALLWAY THAT IS REQUIRED TO HAVE A VISUAL EXIT SIGN, SHALL BE IDENTIFIED BY A TACTILE EXIT SIGN WITH THE WORDS, "EXIT ROUTE".
- E. THE BOTTOM 10" OF ALL DOORS SHALL HAVE A SMOOTH UNINTERRUPTED SURFACE TO ALLOW DOOR TO BE OPENED BY A WHEELCHAIR FOOTREST. NO THRESHOLD SHALL EXCEED 1/2" IN HEIGHT.
- F. HAND-OPERATED DOOR OPENING HARDWARE SHALL NOT REQUIRE TIGHT GRASPING OR TWISTING OF THE WRIST IN ORDER TO OPERATE, AND SHALL BE MOUNTED NO HIGHER THAN 48" A.F.F.
- G. MAXIMUM FORCE REQUIRED TO OPEN EXTERIOR DOORS SHALL NOT EXCEED 5 LBS. MAXIMUM FORCE REQUIRED TO OPEN INTERIOR DOORS SHALL NOT EXCEED 5 LBS.
- H. IF A DOOR HAS A CLOSER, THEN THE SWEEP PERIOD OF THE CLOSER SHALL BE ADJUSTED SO THAT FROM AN OPEN POSITION OF 70 DEGREES, THE DOOR WILL TAKE AT LEAST 3 SECONDS TO MOVE TO A POINT 5 INCHES FROM THE LATCH, MEASURED TO THE LEADING EDGE OF THE DOOR.
- I. FAUCET CONTROL AND OPERATING MECHANISMS SHALL BE OPERABLE WITH ONE HAND AND SHALL NOT REQUIRE TIGHT GRASPING, PINCHING, OR TWISTING OF THE WRIST. THE FORCE REQUIRED TO ACTIVATE CONTROLS SHALL BE NO GREATER THAN 5 LBS. LEVER OPERATED, FLUSH TYPE AND ELECTRONICALLY OPERATED MECHANISMS ARE EXAMPLES OF ACCEPTABLE DESIGNS. IF SELF CLOSING VALVES ARE USED, THE FAUCET SHALL REMAIN OPEN FOR A MINIMUM OF 10 SECONDS.
- J. PROVIDE SIGNAGE WITH INTERNATIONAL SYMBOL OF ACCESSIBILITY IN ACCORDANCE WITH ANSI A117.1 (LATEST EDITION) AND ADA REQUIREMENT.
- K. SIGNAGE HEIGHT SHALL BE IN ACCORDANCE WITH ALL APPLICABLE NATIONAL, STATE AND LOCAL ACCESSIBILITY CODES.
- L. RESTROOM SIGNAGE SHALL BE MOUNTED ON THE WALL ADJACENT TO THE LATCH SIDE OF THE RESPECTIVE RESTROOM DOOR.
- M. FLAME SPREAD RATING SHALL BE CLASS C MINIMUM.

OCCUPANCY LOAD CALCULATION

AREA	SQFT	OCCUPANCY LOAD FACTOR	OCCUPANTS (MAX)
MERCANTILE	2,385	60 gross	40
BUSINESS	777	100 gross	8
UTILITY/STORAGE	1,056	300 gross	4
TOTAL			52

EXITING REQUIREMENTS

AREA	REQUIRED	PROVIDED
COMMON PATH OF EGRESS TRAVEL (CPET)	75'	42'
MINIMUM NUMBER OF EXITS	1	2
TRAVEL DISTANCE MAXIMUM	200'	152'
DEAD END CORRIDOR LENGTH	20' MAX	N/A
DIAGONAL OF BUSINESS AREA: 1/2 OF DIAGONAL DISTANCE W/0 AUTOMATIC SPRINKLER	44'-1"	81'-8" (EXIST.)

EGRESS LEGEND

- A OCCUPANT LOAD AT THIS EXIT
- B REQUIRED EXIT WIDTH (0.2" PER OCCUPANT)
- C PROVIDED EXIT WIDTH

LIFE SAFETY LEGEND

- (A) LENGTH OF EXIT TRAVEL DISTANCE FROM START POINT (FEET)
- (B) CPET DISTANCE FROM START POINT (FEET)
- (EXIT SIGN) EXIT SIGN (SEE ELECTRICAL SHEETS)
- (LOCATION OF EXIT TEXT) LOCATION OF EXIT TEXT
- (---) EXIT TRAVEL DISTANCE (36" CLEAR WIDTH MIN.)

- FEC RECESSED FIRE EXTINGUISHER CABINET
- EX EXISTING RELOCATED
- (E) PORTABLE FIRE EXTINGUISHER
- EX EXISTING RELOCATED
- (TS) TACTILE "EXIT" SIGN

FLOOR PLAN LEGEND NOT ALL SYMBOLS BELOW MAY BE USED.

- (---) WALL CONSTRUCTION: REFER TO WALL TYPE DETAILS
- (---) EXISTING WALL CONSTRUCTION TO REMAIN
- (---) AREA NOT IN CONTRACT

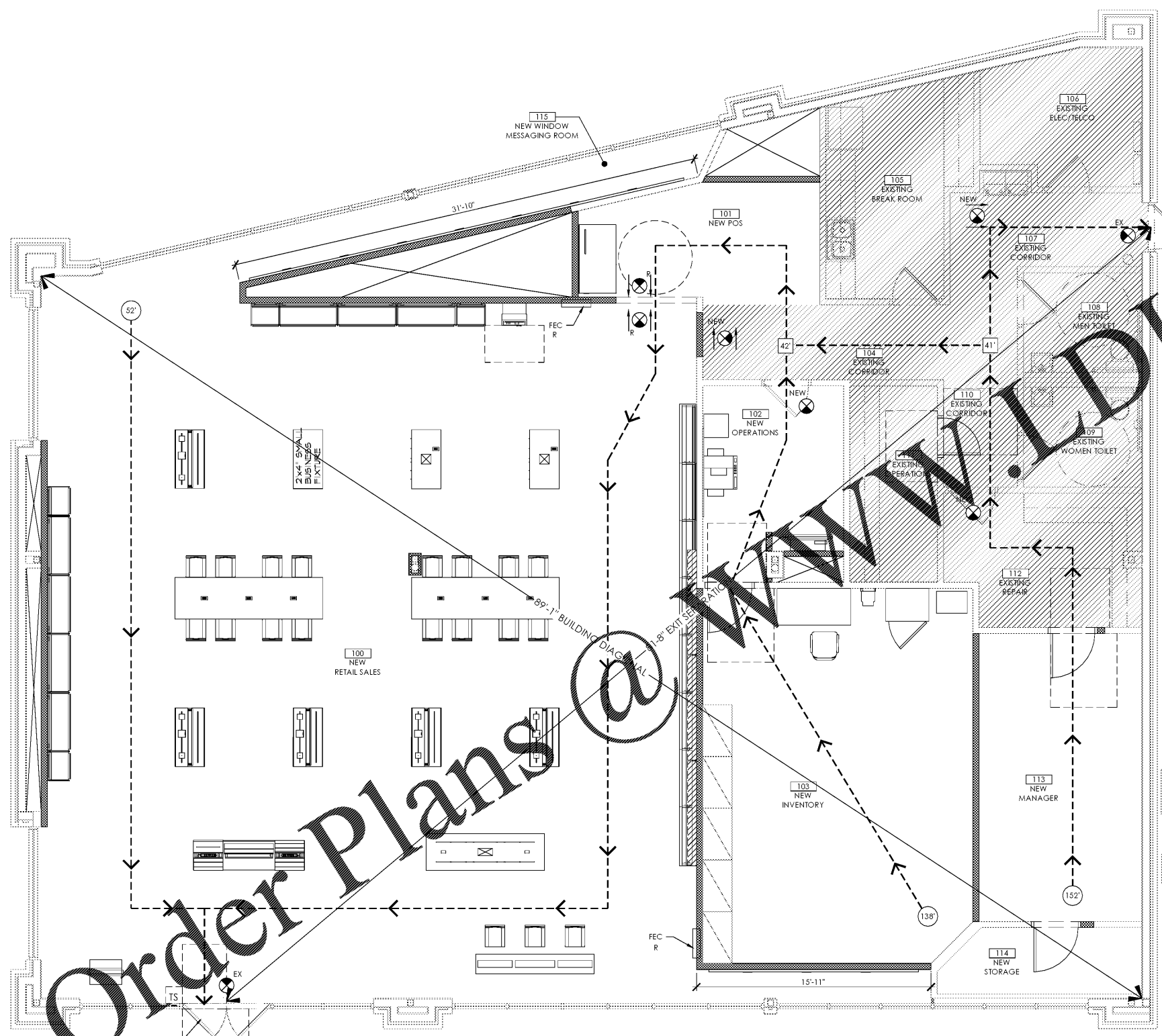

A	26
B	5.2
C	68

1 LIFE SAFETY/ACCESSIBILITY PLAN
SCALE: 1/4" = 1'-0"



Order Plans @ www.alddline.com

P:\Verizon Wireless\Hendersonville, NC\1602 Four Seasons Blvd\VTW2121\AMRPL\Drawings\G-101_1602 Four Seasons Blvd_CDW_Life Safety & Accessibility.rvt
 Author: JLD/2/19/2019 2:52:57 PM