

Alomance Consulting Engineers

961-F Burlington Ave.
Gibsonville, N.C. 27249
Phone: (336) 449-4558
www.ace-nc.net

N.C. Firm License Number C-2071

LINDSEY ARCHITECTURE
105 S. Elm Street, Suite 300
Greensboro, NC 27401
p. 336.617.4402
f. 336.617.4434
www.lindseyarchitecture.com

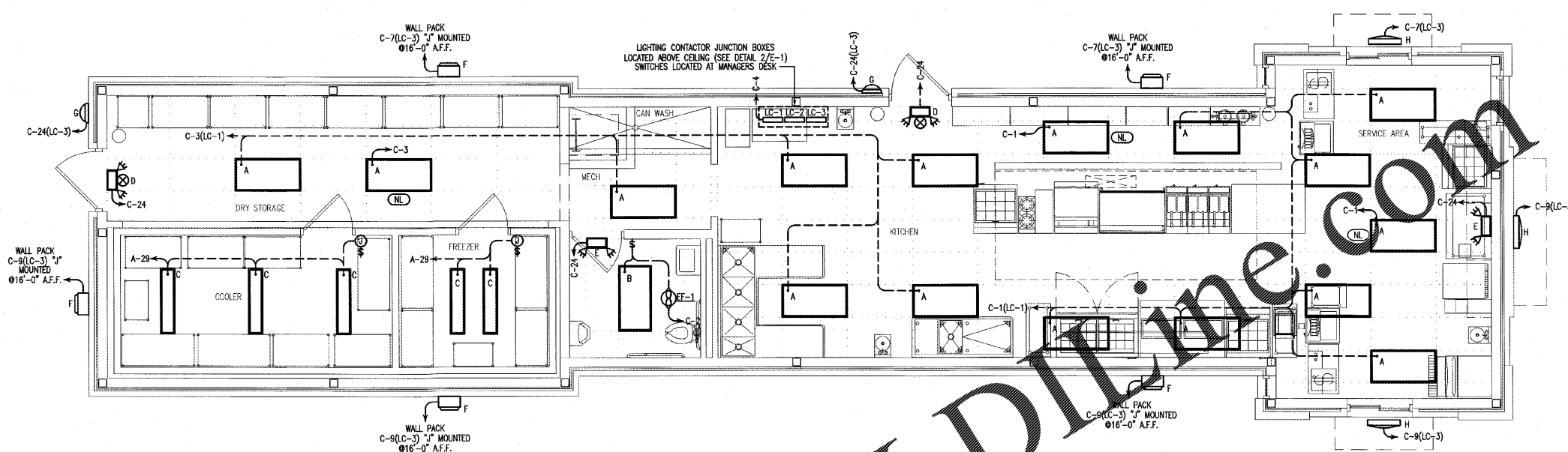

1 LIGHTING PLAN
SCALE: 1/4"=1'-0"

LIGHTING LEGEND		
MARK	SYMBOL	DESCRIPTION
A	[Symbol]	2'x4' LAY-IN LED LIGHT, WITH ACRYLIC LENS, 50W, 5000K LSI INDUSTRIES
B	[Symbol]	2'x4' LAY-IN LED LIGHT, WITH ACRYLIC LENS, 50W, 3000K LSI INDUSTRIES
C	[Symbol]	4'-0" LED SURFACE MOUNT FIXTURE, WITH ACRYLIC ANGLED LENS, 35W, 5000K LSI INDUSTRIES
D	[Symbol]	EMERGENCY/EXT LIGHT WITH BATTERY BACK-UP LSI INDUSTRIES
E	[Symbol]	EMERGENCY LIGHT WITH BATTERY BACK-UP LSI INDUSTRIES
F	[Symbol]	LED FULL CUT-OFF WALL PACK, 82W, 5000K, METALLIC SILVER FINISH, LSI INDUSTRIES
G	[Symbol]	EXTERIOR EMERGENCY SURFACE MOUNTED LIGHT WITH NiCAD BATTERY, DARK BRONZE, TWO BY LAMPS LSI INDUSTRIES
H	[Symbol]	LED EXTERIOR LINEAR LIGHTING, 30W
EF	[Symbol]	BATHROOM EXHAUST FAN, SEE EXHAUST FAN SCHEDULE FOR SPECIFICATIONS
--	[Symbol]	SINGLE POLE WALL SWITCH
--	[Symbol]	DENOTES LINE VOLTAGE WIRING

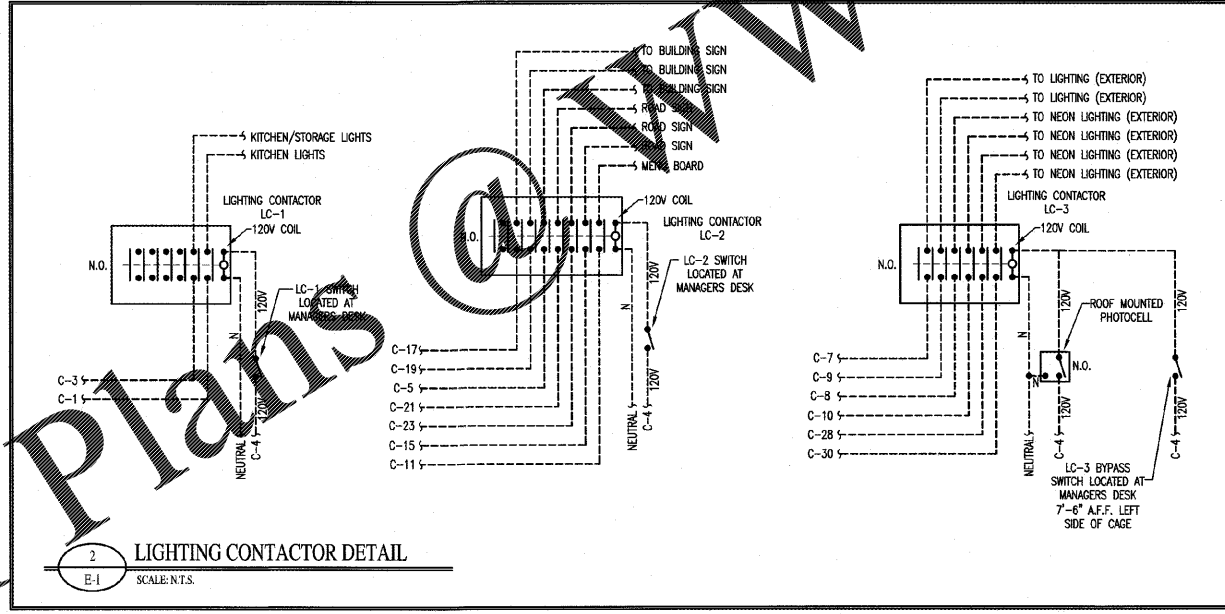

2 LIGHTING CONTACTOR DETAIL
SCALE: N.T.S.

COMcheck Software Version 4.1.1.0
Interior Lighting Compliance Certificate

Section 1: Project Information
Energy Code: 2012 North Carolina Energy Conservation Code
Project Title: Cook Out - Charlotte
Project Type: New Construction
Construction Site: 4455 Main Street, Charlotte, NC
Owner/Agent: [Blank]
Designer/Contractor: G. Kevin Bengel

Section 2: Interior Lighting and Power Calculation

	A	B	C	D
	Floor Area	Allowed Watts / ft2	Allowed Watts	Allowed Watts
Cook Out (Dining, Cafeteria/Fast Food)	1002	0.837	839	1341
			Total Allowed Watts = 1341	

Section 3: Interior Lighting Fixture Schedule

Fixture ID : Description / Lamp / Wattage Per Lamp / Ballast	A	B	C	D	E
	Lamps/ Fixture	# of Fixture	Watt	(C X D)	
Cook Out: Dining (refers to table 1602.4.1.1)					
2x4 LED, 2x4 LED, 2x4 LED, Other:	1	17	50	850	
			Total Proposed Watts = 850		

Section 4: Requirements Checklist

Lighting Wattage:

1. Total proposed watts must be less than or equal to total allowed watts.

Allowed Watts	Proposed Watts	Complies
1341	850	YES

Section 5: Compliance Statement

Compliance Statement: The proposed lighting design represented in this document is consistent with the building plans, specifications and other calculations submitted with this permit application. The proposed lighting system has been designed to meet the 2012 North Carolina Energy Conservation Code requirements in COMcheck Version 4.1.1.0 and to comply with the mandatory requirements in the Requirements Checklist.

NEW BUILDING FACILITY:
COOK OUT
4455 Main Street
Charlotte, North Carolina

DRAWING NAME:
LIGHTING PLAN

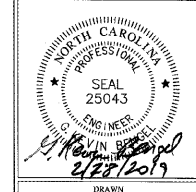

DRAWN:
TGW
DATE:
2/27/19
SCALE:
AS NOTED
JOB NO:
19021
SHEET

E-1