

elcary - 4/2/2019 1:14:47 PM

U:\LUCKY BRAND\BIZ\BUB (Dania Point) - L\Specialty\Drawings\Work in Progress\BIZ\BUB AZ - FK1.dwg

PATRICK G. BLEES
architecture · planning · interior design
PATRICK G. BLEES ARCHITECT, PLLC
800 WASHINGTON AVE. N., SUITE 208
MINNEAPOLIS, MN 55401-1330
PHONE: (612) 547-1300
FAX: (612) 547-1301

CONTACT: ELVY B. CLEARY
elcary@cmarch.com

CONSULTANTS:
CONSULTANT1:

SEAL:

PATRICK G. BLEES, ARCHITECT

DATE ISSUED: 04/03/19
REG. NO.: AR93439

LUCKY BRAND
DANIA
POINTE

1763 POINTE BLVD
DANIA BEACH, FL
33004
SPACE #M115

SPECIALTY

SHEET TITLE:
FIXTURE PLAN

REVISIONS:
ORIGINAL ISSUE: 01.17.19
NO. DATE: 04/03/19 BY: BOBG

PROJECT NO.: 18028.008
DRAWN BY: MGM

A2

COPYRIGHT PATRICK G. BLEES AIA, PLLC 2019

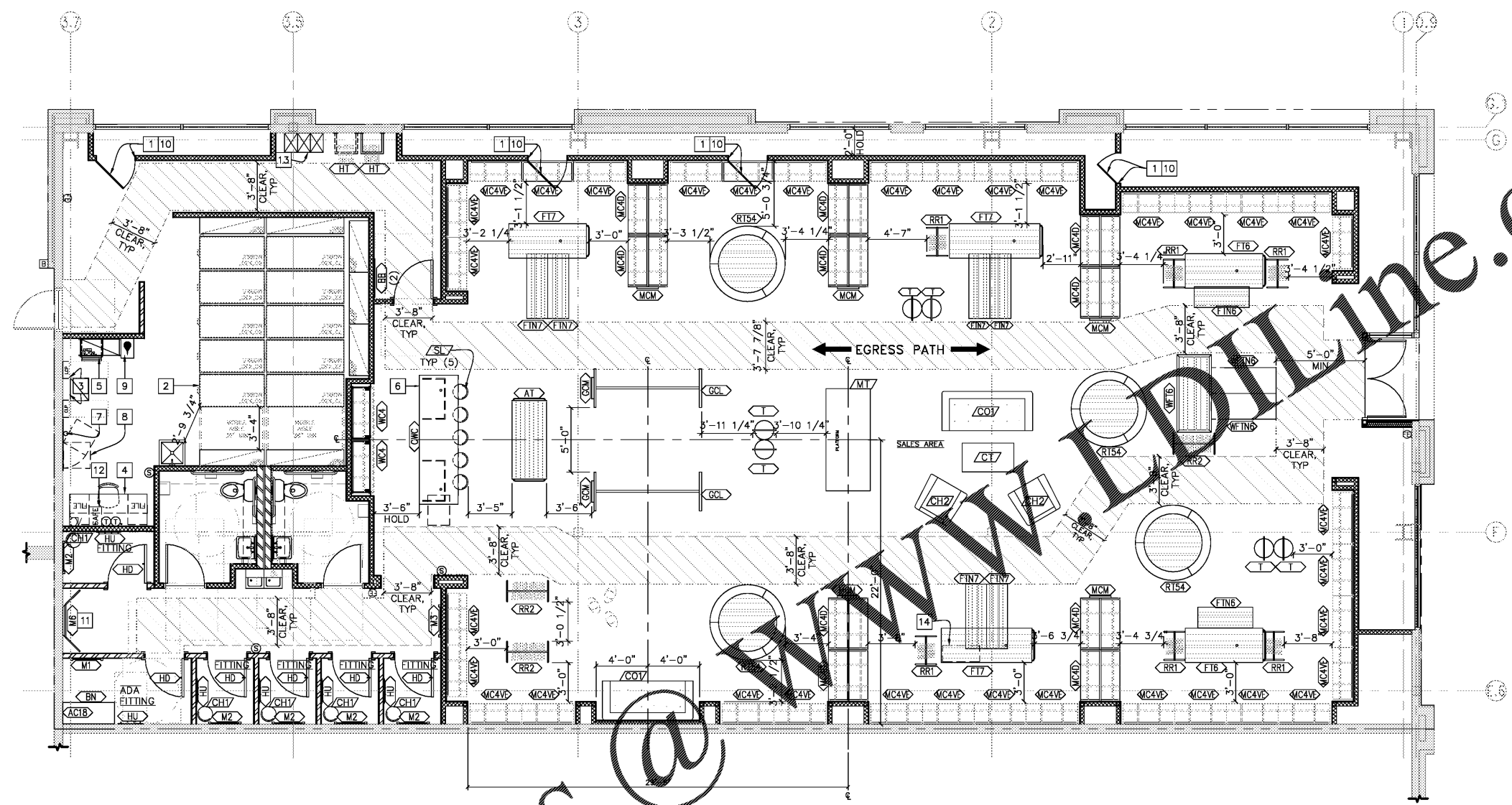

1 FIXTURE PLAN
A2 3/16" = 1'-0"

Order Plans @

- GENERAL NOTES**
- GC TO PROTECT FLOOR AND WALL FINISHES FROM DAMAGE WHILE STORING AND DURING PLACEMENT OF THE FLOOR FIXTURES.
 - CONFIRM W/ LUCKY BRAND CONSTRUCTION MANAGER THAT THE PLAN IS CURRENT BEFORE PLACING FLOOR FIXTURES.

SEE SHEET A2.1 FOR FIXTURE SCHEDULES

- FIXTURE PLAN KEYED NOTES**
- FINISH ENDS BY GC MILLWORK SUB CONTRACTOR. SEE 5/G3 & 6/G3.
 - STORAGE UNIT BY STOCKROOM SHELVING VENDOR. GC TO COORDINATE WITH VENDOR. VENDOR TO SUBMIT FINAL LAYOUT DRAWINGS, APPLICABLE DETAILS AND STRUCTURAL INFO FOR LBJ APPROVAL. ALL 30" WIDE UNITS (FIXED AND MOBILE) TO HAVE PEGBOARDS INSTALLED ON ENDS, SUPPLIED BY VENDOR, INSTALLED BY GC.
 - ELECTRICAL PANELS. SEE ELECTRICAL SHEETS.
 - GC TO SECURE MANAGER'S DESK TO WALL W/ CLEAT. UNIT REST ON OWNER SUPPLIED FILING CABINETS. GC TO PROVIDE POWER AND DATA. SEE 6/A5.2 FOR DETAIL.
 - REFRIGERATOR AND MICROWAVE (STACKED) IN FIXED SHELVING. GC TO PROVIDE DEDICATED GFCI OUTLET.
 - UNDER COUNTER FRIDGE.
 - PVC DRAWING TUBE (#4" x18"H) BOTTOM TO BE GLUED SHUT. GC TO PLACE MOST CURRENT SET OF PLANS.
 - LOCATION OF DATA STORAGE. SEE SHEET A5.2 FOR ADD'L INFO.
 - WATER DISPENSER, NO PLUMBING REQ.
 - GC MILLWORK SUB CONTRACTOR TO PROVIDE ACCESS DOOR. SEE 5/G3 & 6/G3.
 - GC TO PROVIDE SHEET METAL BACKING AS REQ BEHIND 3-WAY MIRROR, INCLUDING POWER. SEE SHEET A5.4 & ELEC. SHEETS.
 - INSTAL SAFE WITH SUITABLE ANCHORS IN CONC SLAB.
 - LOCKERS, SECURED TO WALL.
 - 34 1/2" X 15" CASHWRAP INSERT.

COPYRIGHT PATRICK G. BLEES AIA, PLLC 2019