

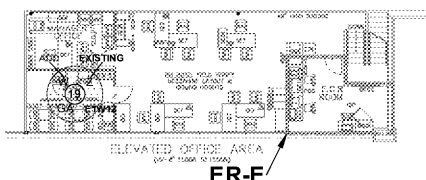

Order Plans @ www.lidline.com



- ACCESS POINT LOCATIONS**
- 1- (1) CATEGORY 4 AP AIR, UTP CABLE TERMINATED IN A SINGLE PORT BSOUT MOUNTED AT CEILING HEIGHT WITH A 254'001 SERVICE LOOP FOR 2-PORT MOUNTING WIRELESS AP #1 LOCATION, 2-PORT #1 LOCATION WITH SEQUENCE NUMBERING (SA IS FOR FLOOR USE ONLY)
 - 2- (1) CATEGORY 4 AP AIR, UTP CABLE MOUNTED AS REQUIRED FOR A FREEZER WIRELESS ACCESS POINT. SEE DETAIL ON SHEET T1.6.3
 - 3- (1) CATEGORY 4 AP AIR MOUNTED IN A SINGLE PORT BSOUT IN A FREEZER BOX INSIDE THE FREEZERPREP AREA.
 - 4- (1) CATEGORY 4 AP AIR MOUNTED IN A 2-PORT BSOUT IN A FREEZER BOX INSIDE THE FREEZERPREP AREA. SEE DETAIL ON SHEET T1.6.3
 - 5- (1) CATEGORY 4 AP AIR, UTP CABLE MOUNTED AS REQUIRED FOR AN OUTSIDE WIRELESS ACCESS POINT. SEE DETAIL ON SHEET T1.6.3

WITHIN THE WALLS
GA-214
 3139 US HIGHWAY 278 NE
 COVINGTON, GA

DATE	3/25/2019
DRAWN	BY: [Name]
CHECKED	BY: [Name]
PROJECT	GA-214
NO. OF SHEETS	11
SHEET NO.	11.6.1
OVERALL STORE AP LOCATIONS	
GA-214	
T1.6.1	



GENERAL OFFICE
FULL TIME EMPLOYING
MANAGER AT COVINGTON, GA



mpt
 INFRASTRUCTURE SOLUTIONS

ATLANTA
 (NEW) NEIGHBORHOOD

1175 W. COLLETSVILLE AVENUE
 ATLANTA, GA
 PHONE: (770) 498-7830 FAX: (770) 498-7839