

TRACK LINEAR FEET	CURRENT LIMITER TYPE & CATALOG NUMBER	WATTAGE	TRACK LINEAR FEET	CURRENT LIMITER TYPE & CATALOG NUMBER	WATTAGE
2 LF	COOPER (HALO) LC901-CB120 *	120	56 LF	COOPER (HALO) LC901-CB1200 *	1,200
4 LF	COOPER (HALO) LC901-CB120 *	120	80 LF	COOPER (HALO) LC901-CB1200 *	1,200
8 LF	COOPER (HALO) LC901-CB200 *	300	84 LF	COOPER (HALO) LC903-CB1200CB120 *	1,200
12 LF	COOPER (HALO) LC901-CB300 *	600	88 LF	COOPER (HALO) LC903-CB1200CB120 *	1,200
16 LF	COOPER (HALO) LC901-CB800 *	600	72 LF	COOPER (HALO) LC903-CB1200CB300 *	1,500
20 LF	COOPER (HALO) LC901-CB800 *	600	80 LF	COOPER (HALO) LC903-CB1200CB300 *	1,500
24 LF	COOPER (HALO) LC901-CB800 *	600	80 LF	COOPER (HALO) LC903-CB1200CB800 *	1,800
28 LF	COOPER (HALO) LC901-CB800 *	600	80 LF	COOPER (HALO) LC903-CB1200CB800 *	1,800
32 LF	COOPER (HALO) LC901-CB960 *	960	80 LF	COOPER (HALO) LC903-CB1200CB960 *	1,800
36 LF	COOPER (HALO) LC901-CB960 *	960	80 LF	COOPER (HALO) LC903-CB1200CB960 *	1,800
40 LF	COOPER (HALO) LC901-CB960 *	960	80 LF	COOPER (HALO) LC903-CB1200CB960 *	1,800
44 LF	COOPER (HALO) LC901-CB960 *	960	80 LF	COOPER (HALO) LC903-CB1200CB960 *	1,800
48 LF	COOPER (HALO) LC901-CB1200 *	1,200			
52 LF	COOPER (HALO) LC901-CB1200 *	1,200			

* NOTE: FINISH TO MATCH TRACK - ADD THE FOLLOWING TO CATALOG NUMBER FOR CORRESPONDING COLOR FINISH:
 "T" (WHITE), "M" (BLACK), "S" (SILVER)

TYPE	DESCRIPTION	MANUFACTURER	LAMP	QUANTITY	WATTAGE
C1	RECESSED 2"x4" w/ (3) TR LAMPS & (1) INSTANT START BALLAST, PRISMATIC LENS w/ NO REFR. GRID CEILING	COOPER (METALUX) 208-3324-UNV-QE3K325NCG	PHILIPS LIGHTING 1418/48-3500 IF 10/1 DM	25	43.8
K3	ARCHITECT CABLE HUNG, 18 IN LAMPS w/ SILVER PRISMATIC LENS & SILVER FINISH	COOPER (COBRELUX) MS 50W 278-1C-UNV-AC240-ST-12-DL1-CARDINAL SMOKE 1333-GR38	PHILIPS LIGHTING 1418/48-3500 IF 10/1 DM	1	33.6
R29	LED TRACK MOUNTED ACCENT LIGHT, NARROW FLOOD BEAM SPREAD (24")	COOPER (HALO) L8625N9000AH (SILVER)	LTDN INCLUDED	12	35
R30	LED TRACK MOUNTED ACCENT LIGHT, NARROW FLOOD BEAM SPREAD (24")	COOPER (HALO) L8625N9000AH (SILVER)	LTDN INCLUDED	4	35
S7	15W LED DOCK LIGHT WITH 42" ARM	ENERGY FOCUS LIGHTING L830-755-45W-15-PS-SY & (1) SL/42 ARM	LTDN INCLUDED	2	15
	2 FOOT TRAC	COOPER (HALO) L803P or MB or SL 2 FOOT TRAC			
	4 FOOT TRAC	COOPER (HALO) L803P or MB or SL 4 FOOT TRAC			
	8 FOOT TRAC	COOPER (HALO) L803P or MB or SL 8 FOOT TRAC			
	12 FOOT TRAC	COOPER (HALO) L803P or MB or SL 12 FOOT TRAC			
	MINI JOINER	COOPER (HALO) L803P or MB or SL MINI JOINER			
	POWER FEED	COOPER (HALO) L801P or MB or SL POWER FEED			
	FLEX CONNECTOR	COOPER (HALO) L803P or MB or SL FLEX CONNECTOR			
	STRAIGHT CONNECTOR (may be used as a feed point)	COOPER (HALO) L803P or MB or SL STRAIGHT CONN. (may be used as a feed point)			
	L CONNECTOR	COOPER (HALO) L804P or MB or SL L CONNECTOR			
	MONO POINT CHANDY ADAPTER	COOPER (HALO) L1973P or MB or SL MONO POINT CHANDY ADAPTER			
M01	MOMENTARY OVERRIDE	COOPER (DREINGH) AML-MML116			
O01	MOTION SENSOR	WATSTOPPER OS P/N WI-1100			
O02	MOTION SENSOR	WATSTOPPER OS P/N WI-2200			
O03	MOTION SENSOR	WATSTOPPER OS P/N WI-2200			
O04	MOTION SENSOR	WATSTOPPER OS P/N WI-2200			
PPK1	POWER PACK	WATSTOPPER OS P/N BE-50			
PPK2	POWER PACK, GLASS DOOR LED	WATSTOPPER OS P/N BE-50-RC			
MS1	OCCUPANCY SWITCH, SINGLE LOAD	WATSTOPPER OS P/N PW-100			
US1	OCCUPANCY SWITCH, DUAL LOAD	WATSTOPPER OS P/N LW-200			

- SPECIALTY LIGHTING NOTES (SPECIFIC)**
- VERIFY LOCATIONS AND QUANTITY OF DECOR RELATED TRACK LIGHTING. SEE FINAL DECOR DRAWINGS.
 - BOTTOM OF TRACK MOUNTED AT 11'-9" AFF (TYPICAL UNLESS INDICATED OTHERWISE).
 - SUSPENDING TYPE "X3" FIXTURE AT 7'-8" AFF CENTERED OVER FLORAL DESK.
 - EXTEND EXISTING EMS CONTROLLED CIRCUIT FOR RELOCATED TRACK LIGHTING.
 - CANDY LIGHTING FIXTURES PROVIDED BY OTHERS. 120V, 4', FLUORESCENT STRIPS WITH COORD. AND PLUG. SIMILAR FIXTURE (DASH CHAINED TO A MAXIMUM OF 7) OTHERS. PROVIDE RECEPTACLE ON TOP OF SHELVING OR IN WALL ABOVE SHELVING NEAR SIMILAR FIXTURE LOCATION. COORDINATE REQUIREMENTS WITH CHANDY INSTALLER.
 - INSTALL CURRENT LIMITERS FOR TRACK LIGHTING AS PER TRACK/CURRENT LIMITER MATRIX ON THIS SHEET.
 - COORDINATE TRACK HEAD PLACEMENT WITH CASE CONTENTS. LIGHT FRESH PRODUCT ONLY. DO NOT PLACE HEADS TO LIGHT PLASTIC BAGS.
 - TRACK AND HEADS INDICATED WITH "M" ARE EXISTING. RELOCATED TO POSITIONS SHOWN. FIELD VERIFY HEADS AND CONDITION. NOTIFY THE KROGER PROJECT MANAGER IF ADDITIONAL NEW TRACK AND/OR HEADS WILL BE LIGHTED FLORAL SLAT WALL. VERIFY LOCATION AND CONNECTION REQUIREMENTS.
 - CHECKING LANE LIGHT ATTACHED TO POWER POLE. COORDINATE QUANTITIES AND LOCATIONS WITH VENDOR. INSTALLATION SET ESD-82 AND ESD-82A. SET E1.3 FOR CIRCUITING.
 - NEW SPECIALTY LIGHTING CIRCUITS TO BE RUN THROUGH CONDUIT "IN" FOR ENG. APPROVAL PRIOR TO INSTALLATION IN FIELDS.
 - IF ON/OFF EXISTING, ADJACENT FIXTURE AS SHOWN. FIELD VERIFY CONDITIONS IN FIELDS.

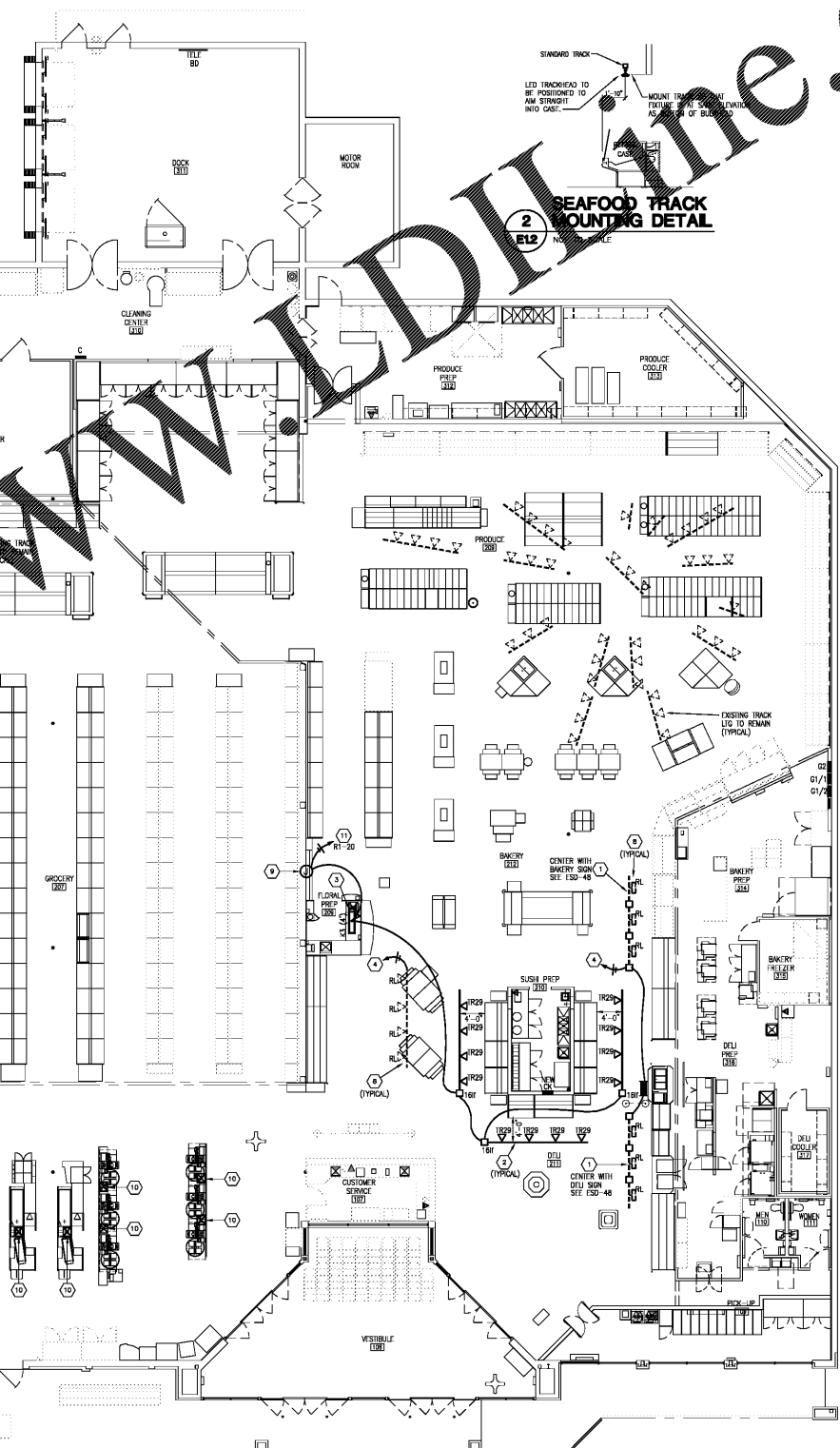

Order Plans @

1 SPECIALTY LIGHTING PLAN
E1.2 3/32" = 1'-0"



CONSULTANT

A REMODEL FOR:
KROGER GA-214
 3139 US HWY 278, N.E.
 COVINGTON, GA

PROJECT: KROGER ATLANTA

DATE: 04-01-2019
 CONSTRUCTION SET

SPECIALTY LIGHTING PLAN AND DETAILS

SHEET TITLE

NO.	DATE	DESCRIPTION

PROJECT NO: 19085
 CIO DWG FILE: GA-214E1.2
 DRAWN BY: WSM
 CWD BY: HCK

E1.2

SHEET NO.