

6E REFLECTED CEILING PLAN - ELEVATED OFFICE
SCALE: 3/32" = 1'-0"

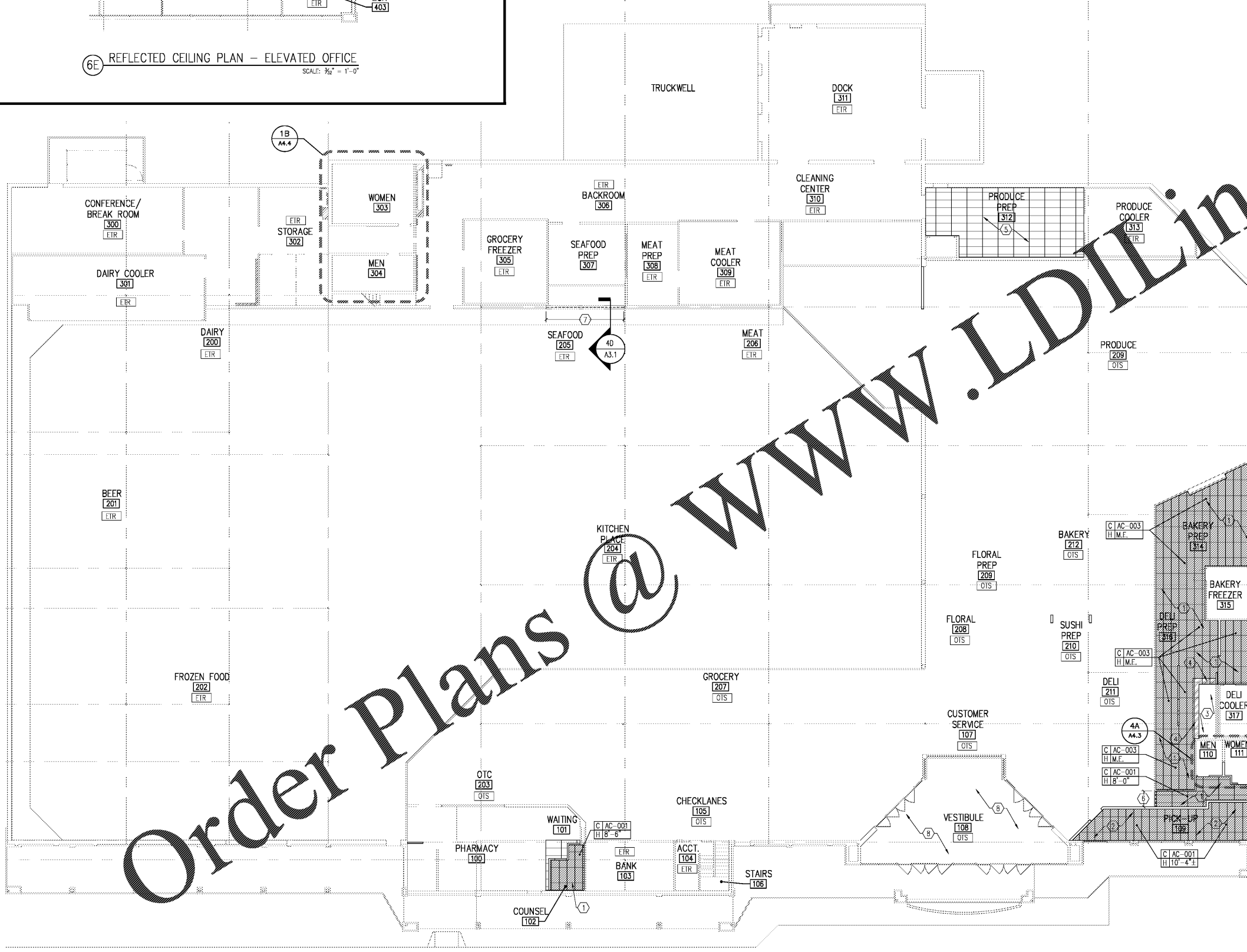

4A REFLECTED CEILING PLAN - MAIN LEVEL
SCALE: 3/32" = 1'-0"

PLAN NOTES

- FURNISH & INSTALL NEW 2x4 CEILING PANELS AND GRID SYSTEM COMPLETE. SEE ELECTRICAL & MECHANICAL DRAWINGS FOR ADDITIONAL REQUIREMENTS. FURNISH & INSTALL NEW OR MODIFY EXISTING FIRE SPRINKLER PROTECTION SYSTEM AS PART OF EXISTING SYSTEM.
- FURNISH & INSTALL NEW 2x4 CEILING PANELS AND GRID SYSTEM COMPLETE. INTENT IS FOR CEILING HEIGHT TO OCCUR AT TOP EDGE OF EXISTING WINDOW OPENINGS. SEE ELECTRICAL & MECHANICAL DRAWINGS FOR ADDITIONAL REQUIREMENTS. FURNISH & INSTALL NEW OR MODIFY EXISTING FIRE SPRINKLER PROTECTION SYSTEM AS PART OF EXISTING SYSTEM.
- INSTALL NEW EXHAUST HOOD. REFER TO MECHANICAL DRAWINGS FOR MORE INFORMATION.
- FURNISH & INSTALL NEW S.S. COVER OVER NEW CEILING PANELS AROUND EXPOSED PERIMETER OF EXIST. DELI HOOD FOR MIN. OF 18" BEYOND OPEN PERIMETER. REFER TO HVAC DRAWINGS FOR MORE INFORMATION.
- REPLACE ANY DAMAGED CEILING TILE AND GRID WHERE OCCURS WITHIN PRODUCE PREP ROOM.
- FURNISH & INSTALL NEW BULKHEAD @ 7'-6" A.F.F. (FIN. SURFACE) W/ 6" MIL. STUD BOX HEADER WRAPPED ON ALL EXPOSED SIDES W/ M.R. GYP. BD. SHEATHING (MATCH EXIST. ADJ. THICKNESS) & FINISHED TO MATCH ADJACENT SURFACE.
- FURNISH & INSTALL SECTIONS OF NEW BULKHEAD/SUPPORT WHERE LOWER SECTIONS OF WALLS AND PLASTER HAVE BEEN REMOVED PER ADA-2. NEW MATERIALS TO MATCH EXISTING ADJACENT. INTENT TO PROVIDE A SMOOTH/FLUSH TRANSITION ALONG FULL LENGTH OF BULKHEAD BOTTOM EDGE.
- CLEAN EXISTING SUSPENDED CEILING AND UPPER WALL INTERSECTION OS ALL DUST, COBWEBS, ETC.

GENERAL NOTES

- SEE SPECIFICATION SECTIONS 016125, 016127.08, 074300, 083113 & 095113 FOR MATERIALS INFORMATION.
- MAINTAIN ALL EXISTING FIRE PROTECTION AND DETECTION SYSTEMS DURING CEILING WORK.
- ALL NEW CEILING SYSTEM WORK AREAS TO HAVE A LICENSED FIRE PROTECTION ENGINEER ANALYZE AND PREPARE MODIFICATIONS AND ADDITIONAL WORK DESIGNED AS SEPARATE SUBMITTAL.
- GROUP ALL PIPE DROPS (REFRIGERATION, PLUMBING, ELECTRICAL, ETC.) TOGETHER AS NEATLY AS POSSIBLE AND PAINT TO MATCH INT. COLUMNS. G.C. IS TO COORDINATE THIS WITH ALL CONTRACTORS.
- RE-PAINT ALL EXPOSED PORTIONS OF BULKHEADS/SOFTIS, OCCURRING IN ROOMS/SPACES RECEIVING NEW FINISHES, TO MATCH ADJACENT OR CLOSEST WALL FINISH UNLESS OTHERWISE INDICATED ON DECOR DRAWINGS. THIS INCLUDES ALL BULKHEADS AND BOXED UTILITY DROPS ON SALES FLOOR.
- PAINT (MATCH EXISTING) ALL NEW EXPOSED UNPAINTED PIPING, CONDUITS, DUCTWORK, UNISTRUT, ETC. PER SPECIFICATIONS. DO NOT PAINT COMMUNICATIONS CABLES.
- FURNISH & INSTALL 500 NEW CEILING TILES AS/WHERE DIRECTED BY THE KROGER P.M. - G.C. IS ALSO RESPONSIBLE FOR REMOVAL & DISPOSAL OF EXISTING TILES BEING REPLACED.
- THE FOLLOWING AREAS OF WORK ARE TO BE PRICED AS ALTERNATES:
 - ALTERNATE #1 - ALL WORK IN DELI PREP AREA.
 - ALTERNATE #2 - ALL WORK IN FRONT RESTROOMS.
 - ALTERNATE #3 - ALL WORK IN REAR RESTROOMS.
 - ALTERNATE #4 - ALL WORK IN "PICK-UP" AREA.
 - ALTERNATE #5 - WORK FOR REFRIGERANT LEAK DETECTION SYSTEM.

LEGEND

- NEW SUSPENDED ACOUSTICAL CEILING SYSTEM (TILES & GRID)
- S.S. COVER OVER CEILING PANELS
- GYPSON BOARD SHEATHING (PAINTED)
- NEW/MODIFIED BULKHEAD
- C CEILING FINISH MATERIAL
- H CEILING HEIGHT (ABOVE FINISHED FLOOR)
- E/R EXISTING TO REMAIN
- O/S OPEN TO STRUCTURE
- M.E. MATCH EXISTING

CAPSTONE
Project Services, Inc.
2211 WIDMAN WAY, STE. # 220
FORT MYERS, FL. 33901

STATE OF GEORGIA
JOHN MARK HUGHES
REGISTERED ARCHITECT
4-3-2019

CAPSTONE
PROJECT SERVICES, PLC
ARCHITECTURAL & CONSTRUCTION SERVICES
OFFICE LOCATIONS: RONDISSE, VA & FT. INTERIOR, FL

A REMODEL FOR:
KROGER GA-214
3199 US HWY 278, N.E. COVINGTON, GA

PROJECT: KROGER ATLANTA
04-01-2019
CONSTRUCTION SET

REFLECTED CEILING PLAN

REVISIONS

PROJECT NO: CPS2019-017.4
CAD DWG FILE: CPS2019-017.4-A1.3
DRAWN BY: MERL
CHKD BY: JMH

A1.3