

Order Plans @

WWW.LDILine.com

NOTE:  
 COORDINATE WITH EQUIPMENT SCHEDULE, KROGER P.M. & EQUIPMENT PROVIDER FOR SPECIAL BREAKER & CONNECTION TYPES PRIOR TO BID & ROUGH-IN.  
 ALL 125V, SINGLE PHASE 15 AMP AND 20 AMP RATED RECEPTACLES INSTALLED IN THE LOCATIONS SPECIFIED IN SCHEDULE 210.8 (S1) - (S) SHALL HAVE GROUND FAULT CIRCUIT INTERRUPTER PROTECTION.  
 NOTE THAT THE ISOLATED GROUNDING TYPE RECEPTACLES AND CLOCK TYPE RECEPTACLES LOCATED IN THE KITCHEN/SERVING AREA SHALL BE PROTECTED BY GROUND FAULT TYPE CIRCUIT BREAKERS RATHER THAN GROUND FAULT TYPE RECEPTACLES. GFCI BREAKERS REQUIRE A DEDICATED NEUTRAL (NOT SHARED) TO OPERATE PROPERLY.  
 EC SHALL VERIFY IN FIELD ALL EQUIPMENT CONNECTIONS AND REQUIREMENTS PRIOR TO ROUGH-IN AND INSTALLATION OF DEVICES: VERIFY ALL DEVICE LOCATIONS AND MOUNTING HEIGHTS WITH KROGER P.M. EC SHALL MAKE ADJUSTMENTS IN FIELD TO MATCH ACTUAL EQUIPMENT BEING INSTALLED, AS DIRECTED BY THE EQUIPMENT INSTALLER.  
 CONTRACTOR IS REQUIRED TO INSTALL STANDARD RECEPTACLES FOR CIRCUITS DEDICATED TO SPECIFIC EQUIPMENT, SUBJECT TO THE APPROVAL OF CODE ENFORCING AGENCY.  
 REFER TO SHEET E1.3.1 FOR GENERAL AND KEYED NOTIS.

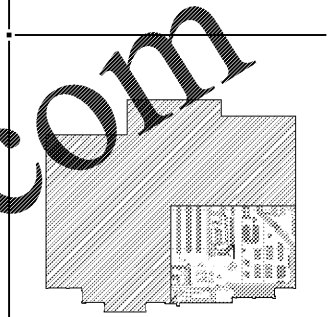

KEY PLAN

**INTERPLAN**  
 ARCHITECTURE  
 ENGINEERING  
 INTERIOR DESIGN  
 PROJECT MANAGEMENT  
 604 COURTLAND STREET  
 SUITE 100  
 ORLANDO, FLORIDA 32804  
 PH 407.645.3204  
 FX 407.629.9124

THIS DOCUMENT IS NOT FOR REGULATORY APPROVAL, PERMITTING, OR CONSTRUCTION.

A WITHIN THE WALLS REMODEL FOR:  
**KROGER STORE # 478 - MARIETTA - GA**  
 3162 JOHNSON FERRY RD.,  
 MARIETTA, GA 30062



NO DATE REVISIONS  
 REVISIONS  
 PROJECT NO: 2019 0125  
 DATE: 03/18/2019

**E1.3.4**  
 ELECTRICAL REFRIGERATION  
 POWER PLAN - 4 OF 4  
 CHECKED: DS DRAWN: VLD