

Order Plans @ www.LDILine.com

NOTE:
 COORDINATE WITH EQUIPMENT SCHEDULE, KROGER P.M. & EQUIPMENT PROVIDOR FOR SPECIAL BREAKER & CONNECTION TYPES PRIOR TO BID & ROUGH-IN.
 ALL 120V, SINGLE PHASE 15 AMP AND 20 AMP RATED RECEPTACLES INSTALLED IN THE LOCATIONS SPECIFIED IN SCHEDULE 210.8 (E)(1) - (5) SHALL HAVE GROUND FAULT CIRCUIT INTERRUPTER PROTECTION.
 NOTE THAT THE ISOLATED GROUNDING TYPE RECEPTACLES AND CLOCK TYPE RECEPTACLES LOCATED IN THE KITCHEN/SERVING AREA SHALL BE PROTECTED BY GROUND FAULT TYPE CIRCUIT BREAKERS RATHER THAN GROUND FAULT TYPE RECEPTACLES. GFCI BREAKERS REQUIRE A DEDICATED NEUTRAL (NOT SHARED) TO OPERATE PROPERLY.
 EC SHALL VERIFY IN FIELD ALL EQUIPMENT CONNECTIONS AND REQUIREMENTS PRIOR TO ROUGH-IN AND INSTALLATION OF DEVICES. VERIFY ALL DEVICE LOCATIONS AND MOUNTING HEIGHTS WITH KROGER P.M. EC SHALL MAKE ADJUSTMENTS IN FIELD TO MATCH ACTUAL EQUIPMENT BEING INSTALLED, AS DIRECTED BY THE EQUIPMENT INSTALLER.
 CONTRACTOR IS REQUIRED TO INSTALL STANDARD RECEPTACLES FOR CIRCUITS DEDICATED TO SPECIFIC EQUIPMENT, SUBJECT TO THE APPROVAL OF CODE ENFORCING AGENCY.
 REFER TO SHEET E1.3.1 FOR GENERAL AND KEYED NOTES.

INTERPLAN
 ARCHITECTURE
 ENGINEERING
 INTERIOR DESIGN
 PROJECT MANAGEMENT
 604 COURTLAND STREET
 SUITE 100
 ORLANDO, FLORIDA 32804
 PH 407.645.9208
 FX 407.629.9124

THIS DOCUMENT IS NOT FOR REGULATORY APPROVAL, PERMITTING, OR CONSTRUCTION.

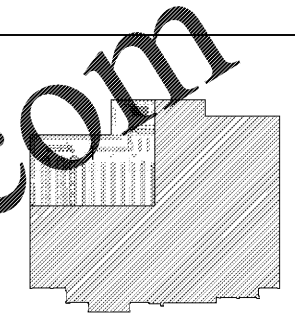

KEY PLAN

A WITHIN THE WALLS REMODEL FOR:
KROGER STORE # 478 - MARIETTA - GA
 3162 JOHNSON FERRY RD.,
 MARIETTA, GA 30062



NO DATE REVISIONS
 REVISIONS
 PROJECT NO: 2019.0125
 DATE: 03.18.2019

E1.3.2
 ELECTRICAL REFRIGERATION
 POWER PLAN - 2 OF 4
 CHECKED: DS DRAWN: VLD

COPYRIGHT © 2019 INTERPLAN, LLC. ALL RIGHTS RESERVED. THIS DOCUMENT IS THE ORIGINAL WORK OF INTERPLAN, LLC. REPRODUCTION, DISTRIBUTION, OR ANY OTHER USE WITHOUT THE WRITTEN PERMISSION OF INTERPLAN, LLC IS PROHIBITED.