

THIS DOCUMENT IS NOT
 FOR REGULATORY
 APPROVAL, PERMITTING,
 OR CONSTRUCTION.

A WITHIN THE WALLS REMODEL FOR:
KROGER STORE # 478 - MARIETTA - GA
 3162 JOHNSON FERRY RD.,
 MARIETTA, GA 30062



NO DATE REVISIONS
 REVISIONS
 PROJECT NO: 2019 0125
 DATE: 03/18/2019

A1.5
 FLOOR COVERING PLAN
 FINISHES
 CHECKED: CH DRAWN: MS

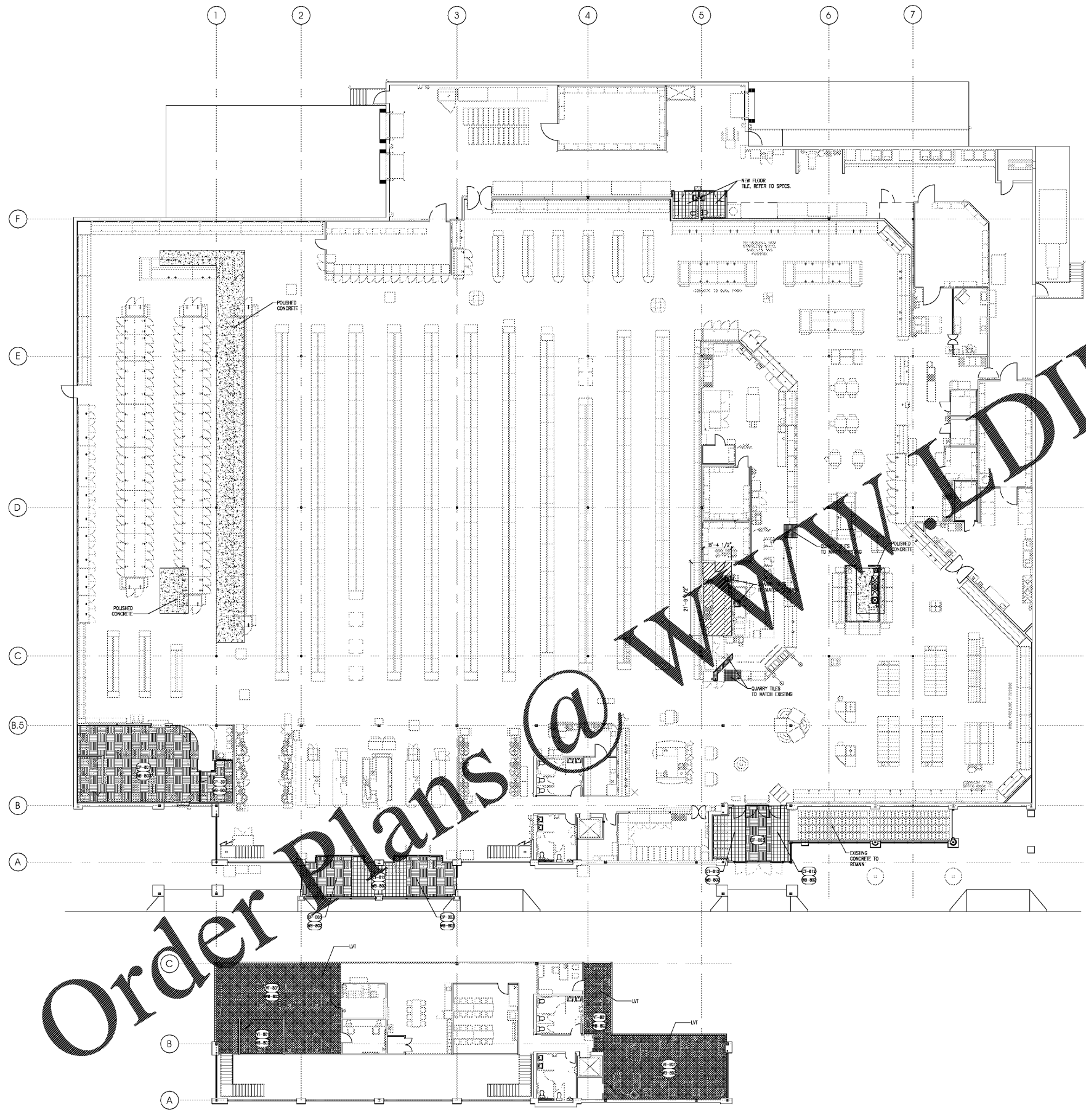

Order Plans @ WWW.IDILine.com

WWW.IDILine.com

FLOOR COVERING LEGEND

- CONCRETE SLABS FINISH TO MATCH EXISTING
 IN TYPICAL CONCRETE COLOR IN SALES AREA. REFER
 TO SPECIFICATIONS.
- QUARRY TILE FLOOR
- VINYL COMPOSITE TILE (VCT)
- NEW TILES
- OFFICES VINYL TILE
- VINYL WALL BASE
- TILE @ VESTIBULES
- WALK-OFF CARPET TILE @ VESTIBULES
- CARPET TILE @ PHARMACY
- INSTALL CARPET TILES AFTER FIXTURES ARE COMPLETELY SET.
 PROVIDE TRANSITION STRIPS PER AIA-48 OR AIA-49 AT ALL
 TRANSITION LOCATIONS.
- CARPET TILE
- EXTENTS OF TILE TO BE RE-GROUTED APPROXIMATELY
 1/8" SQ. FT.
- 1. COORDINATE WITH ALL BRANCHING FOR PLUMBING, ETC.
 AND MATCH ADJACENT FINISH.

1 FLOOR COVERING PLAN
 3/32" = 1'-0"



COPYRIGHT © 2019 INTERPLAN, LLC. ALL RIGHTS RESERVED. THIS DOCUMENT IS THE PROPERTY OF INTERPLAN, LLC. NO PART OF THIS DOCUMENT IS TO BE REPRODUCED, COPIED, OR TRANSMITTED IN ANY FORM OR BY ANY MEANS, WITHOUT THE WRITTEN PERMISSION OF INTERPLAN, LLC.