

Order Plans @

WWW.LDLINE.COM

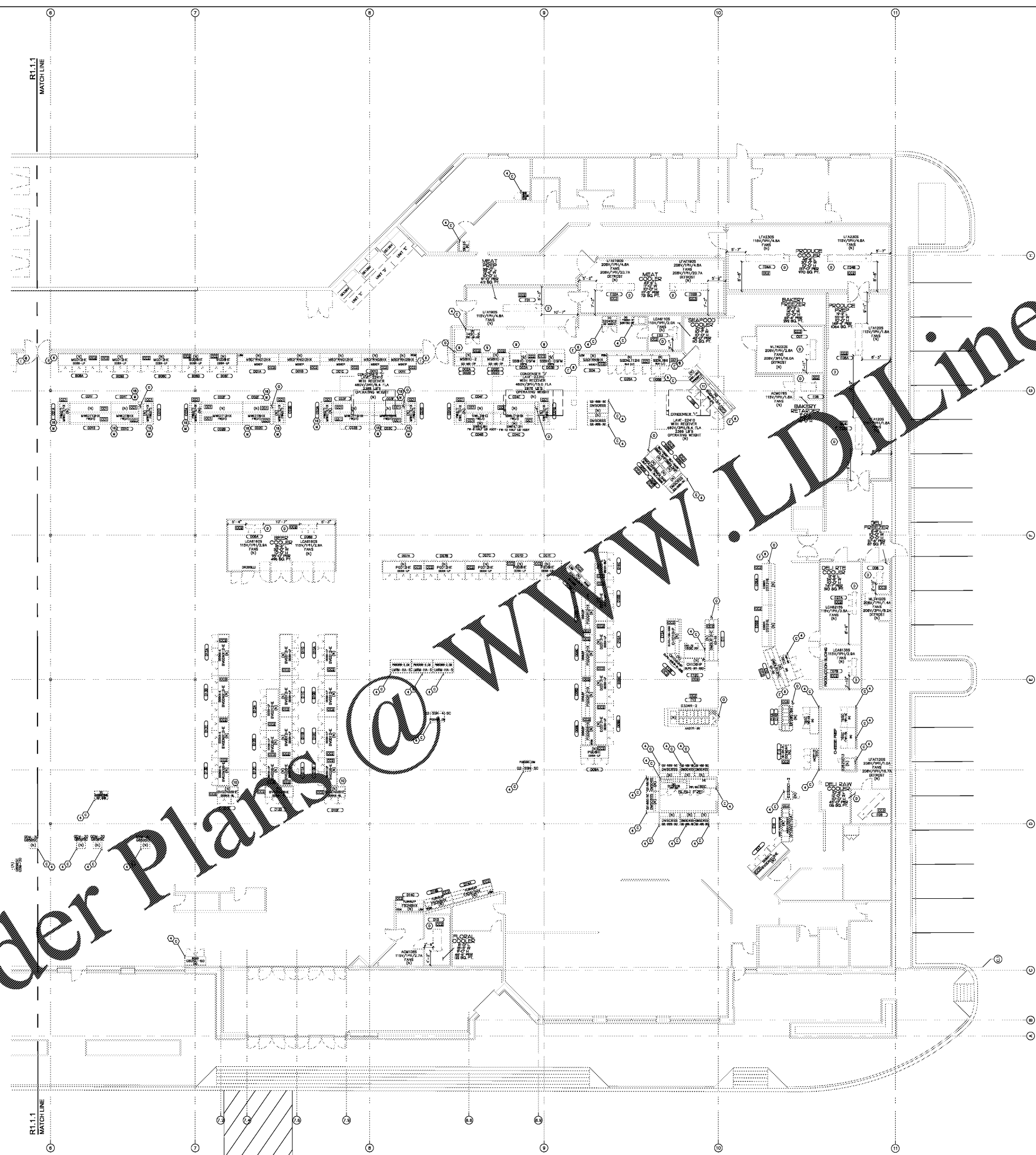

LEGEND, SYMBOLS AND NOTES APPLY TO BOTH R1.1.1 AND R1.1.2 SHEETS SOME ITEMS MAY NOT APPEAR ON THIS SHEET

- VENDOR BID DATA:**
- ① CASE COLORS FOR KROGER PROJECT MANAGER
 - ② ALL CASE COLORS FOR KROGER, FREEZERS AND COOLS SUPPLIED BY KROGER.
 - ③ KROGER SHALL REVIEW CONTRACTOR SUBMITTALS ON THE DAY OF THE MEETING AND PROVIDE ANY COMMENTS ON THE DAY OF THE MEETING. ANY COMMENTS MUST BE PROVIDED BY THE KROGER CO. VENDOR SHALL ALSO REVIEW THE CASE DRAWING (P1.2)
 - ④ REFRIGERATED SHALL BE ORDERED AND PURCHASED SEPARATELY BY THE KROGER PROJECT MANAGER
 - ⑤ NOT USED
 - ⑥ CASE END GLAZERS SUPPLIED BY MANUFACTURER.
 - ⑦ NOT USED
 - ⑧ NOT USED
 - ⑨ CASE OPEN IN BACK BELOW ELECTRIC RACEWAY FOR CLEANING AND FLOOR DRAIN ACCESS
 - ⑩ BACK OF CASE SAME COLOR AS FRONT
 - ⑪ SUPPLY DOMINANT TLY SHELVES FOR FROZEN BAKERY IN GLASS DOOR REFRIGERATOR
 - ⑫ NOT USED
 - ⑬ ALL FLOOR AND THE CASE MEDIUM TEMPERATURE CASES TO BE PROVIDED WITH CASE GLAZERS AND CASE MEDIUM TEMPERATURE CASES TO BE PROVIDED WITH GLASS DIVIDER
 - ⑭ NEW TO PROVIDE CASES WITH DUAL TEMPERATURE CONTROL KITS

- REFRIGERATION INSTALLATION NOTES:**
- ① SUGGESTED LOCATION FOR REFRIGERATION EQUIPMENT SHALL BE DETERMINED BY THE REFRIGERATION CONTRACTOR. THE REFRIGERATION CONTRACTOR SHALL BE RESPONSIBLE FOR OBTAINING ALL NECESSARY PERMITS AND APPROVALS FOR THE REFRIGERATION SYSTEM. THE REFRIGERATION CONTRACTOR SHALL BE RESPONSIBLE FOR OBTAINING ALL NECESSARY PERMITS AND APPROVALS FOR THE REFRIGERATION SYSTEM.
 - ② REFRIGERATION EQUIPMENT SHALL BE INSTALLED IN ACCORDANCE WITH THE REFRIGERATION CONTRACTOR'S SCHEDULE. THE REFRIGERATION CONTRACTOR SHALL BE RESPONSIBLE FOR OBTAINING ALL NECESSARY PERMITS AND APPROVALS FOR THE REFRIGERATION SYSTEM.
 - ③ INSTALL CONDENSATE DRAIN AND CONDENSATE PIPING TO NEAREST DRAIN
 - ④ CASE END GLAZERS SUPPLIED BY MANUFACTURER
 - ⑤ CONDENSATE PIPING REQUIRED FOR HEAT RECLAIM WATER HEATER, SEE P1.2
 - ⑥ NOT USED
 - ⑦ NOT USED
 - ⑧ NOT USED
 - ⑨ NOT USED
 - ⑩ REFRIGERATION PIPING TO BE REPAIRED WHERE PRACTICAL. IT'S THE REFRIGERATION CONTRACTOR'S RESPONSIBILITY TO REPAIR EXISTING PIPING AND REPAIR OR REPLACE AS NECESSARY TO AVOID CONTACT WITH AC WIRE OR OTHER PIPING OR OTHER CONDENSERS, AND NO CLOSER THAN 1/2" FROM EDGE OF WALLS. CONDENSERS TO BE MOUNTED LEVEL IN NON-SLOPED REFRIGERATED ROOF CORERS ADJACENT TO FLOOR SHALL BE KEPT AS NEARLY AS PRACTICABLE TO FACILITATE MOUNTING PERPENDICULAR TO ROOF JOISTS.
 - ⑪ PROVIDE A SINGLE 100# RECEPTACLE MOUNTED ON WALL BELOW EACH REFRIGERATION UNIT. RECEPTACLE TO BE INSTALLED WITH A CONTINUOUS OPERATOR WEATHERPROOF COVER AND TO 4" FROM WALL.
 - ⑫ REFRIGERATION INSTALLER RESPONSIBLE FOR INSTALLING ALL REFRIGERATION PIPING TO BE INSTALLED ON RLT DRAINS. REFRIGERATION PIPING NOT SHOWN TO BE SET AND INSTALLED FOR LABELS ON FLOOR.
 - ⑬ REFER TO R1.1 FOR REFRIGERATION INSTALLATION STANDARD DETAILS.
 - ⑭ SEE R1.1-33, R1.1-34, R1.1-35, R1.1-36, R1.1-37 AND R1.1-38 FOR REFRIGERATION PIPING SUPPORT AND PIPE SCHEDULE.

GENERAL NOTES:

CONDENSER LOCATIONS ARE APPROXIMATE. MOVE NO MORE THAN 20' LATER IF NECESSARY TO AVOID CONTACT WITH AC WIRE OR OTHER PIPING OR OTHER CONDENSERS, AND NO CLOSER THAN 1/2" FROM EDGE OF WALLS. CONDENSERS TO BE MOUNTED LEVEL IN NON-SLOPED REFRIGERATED ROOF CORERS ADJACENT TO FLOOR SHALL BE KEPT AS NEARLY AS PRACTICABLE TO FACILITATE MOUNTING PERPENDICULAR TO ROOF JOISTS.

PROVIDE A SINGLE 100# RECEPTACLE MOUNTED ON WALL BELOW EACH REFRIGERATION UNIT. RECEPTACLE TO BE INSTALLED WITH A CONTINUOUS OPERATOR WEATHERPROOF COVER AND TO 4" FROM WALL.

REFRIGERATION INSTALLER RESPONSIBLE FOR INSTALLING ALL REFRIGERATION PIPING TO BE INSTALLED ON RLT DRAINS. REFRIGERATION PIPING NOT SHOWN TO BE SET AND INSTALLED FOR LABELS ON FLOOR.

REFER TO R1.1 FOR REFRIGERATION INSTALLATION STANDARD DETAILS.

SEE R1.1-33, R1.1-34, R1.1-35, R1.1-36, R1.1-37 AND R1.1-38 FOR REFRIGERATION PIPING SUPPORT AND PIPE SCHEDULE.

- SHEET INDEX:**
- R1.1 PARTIAL REFRIGERATION EQUIPMENT PLAN WEST
 - R1.2 PARTIAL REFRIGERATION EQUIPMENT PLAN EAST
 - R1.3 PARTIAL REFRIGERATION EQUIPMENT PLAN EAST
 - R1.4 REFRIGERATION STANDARD DETAILS
 - R1.5 REFRIGERATION PIPING SCHEDULES

- LEGEND:**
- DISTRIBUTED UNIT OR UNIT DESIGNATION
 - CIRCLET LETTER (FOR ORIGINS WITH MORE THAN ONE LOAD)
 - CIRCLET NUMBER
 - DISTRIBUTED UNIT DESIGNATION

FOLLOWING NOTE APPLIES TO ALL COOLING COILS AND DISPLAY MERCHANDISERS:

DISPLAY MERCHANDISERS - THE FOLLOWING COMPONENTS WILL BE PROVIDED, INSTALLED AND WIRING BY EQUIPMENT CONTRACTOR. SEE DETAILS ON THE DRAWING.

COOLING COILS - THE FOLLOWING COMPONENTS WILL BE PROVIDED, INSTALLED AND WIRING BY EQUIPMENT CONTRACTOR. SEE DETAILS ON THE DRAWING.

- (1) PREHEAT TRANSFORMER INSTALLED AT OUTLET OF EVAPORATOR (E) TO PREHEAT REFRIGERANT
- (2) TEMPERATURE SENSOR MOUNTED ON REFRIGERANT LEAVING EVAPORATOR (E)
- (3) TEMPERATURE SENSOR MOUNTED IN RETURN AIR STREAM INLET TO TRANSFORMER (E)
- (4) TEMPERATURE SENSOR MOUNTED IN DISCHARGE AIR STREAM OUTLET TO TRANSFORMER (E)
- (5) TEMPERATURE SENSOR MOUNTED IN THE FOUNDATION IN LIFT OF BACK OF THE TRANSFORMER FOUNDATION OR USED ON REFRIGERANT WITH ELECTRIC STRIP ONLY

CONTROL NOTES:

① DAMPERS MOVED BY CC DRIVA CASE CONTROLLED AND ASSOCIATED COMPONENTS IN INCLUDES PROVIDED BY REFRIGERATION CONTRACTOR OR COOLING COIL SUPPLIER. REFRIGERATION CONTRACTOR TO VERIFY INPUTS & OUTPUTS FROM SENSORS TO CONTROL UNIT. REFRIGERATION CONTRACTOR TO VERIFY INPUTS & OUTPUTS FROM SENSORS TO CONTROL UNIT. REFRIGERATION CONTRACTOR TO VERIFY INPUTS & OUTPUTS FROM SENSORS TO CONTROL UNIT. REFRIGERATION CONTRACTOR TO VERIFY INPUTS & OUTPUTS FROM SENSORS TO CONTROL UNIT.

② DAMPERS MOVED BY CC DRIVA CASE CONTROLLED AND ASSOCIATED COMPONENTS IN INCLUDES PROVIDED BY REFRIGERATION CONTRACTOR OR COOLING COIL SUPPLIER. REFRIGERATION CONTRACTOR TO VERIFY INPUTS & OUTPUTS FROM SENSORS TO CONTROL UNIT. REFRIGERATION CONTRACTOR TO VERIFY INPUTS & OUTPUTS FROM SENSORS TO CONTROL UNIT. REFRIGERATION CONTRACTOR TO VERIFY INPUTS & OUTPUTS FROM SENSORS TO CONTROL UNIT.

③ DAMPERS MOVED BY CC DRIVA CASE CONTROLLED AND ASSOCIATED COMPONENTS IN INCLUDES PROVIDED BY REFRIGERATION CONTRACTOR OR COOLING COIL SUPPLIER. REFRIGERATION CONTRACTOR TO VERIFY INPUTS & OUTPUTS FROM SENSORS TO CONTROL UNIT. REFRIGERATION CONTRACTOR TO VERIFY INPUTS & OUTPUTS FROM SENSORS TO CONTROL UNIT. REFRIGERATION CONTRACTOR TO VERIFY INPUTS & OUTPUTS FROM SENSORS TO CONTROL UNIT.

ISSUE LOG

NO.	REV.	DESCRIPTION	DATE
1	-	PERMIT SET	12/06/18
2	-	BID SET	03/21/19

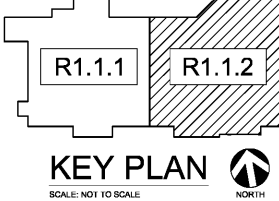

PARTIAL REFRIGERATION
01 EQUIPMENT PLAN EAST
SCALE: 3/32" = 1'-0"

KROGER
STORE #473

2013 UNIVERSITY AVENUE
OXFORD, MISSISSIPPI 38655

A DEVELOPMENT OF
THE KROGER COMPANY

naos
Naos Design Group Of Mississippi, PLLC.

MARC BREETZ, ARCHITECT

645 LakeLand East Drive
Suite 101
Flowood, Mississippi 39232
(p) 303.759.5777
(f) 720.360.4281

ARCHITECT OF RECORD

CDS
COMMERCIAL DESIGN SYSTEMS, INC.

13825 SW GALLIBREATH DRIVE
SHERWOOD, OREGON 97140
503.888.7000 (P) 503.825.8822

INTERIOR DESIGNER

Pickering Firm, Inc.
Architecture - Engineering
Planning - Surveying

8775 Lenox Center Court, Suite 300
Memphis, TN 38115
901.728.9119

ENGINEER OF RECORD:
STRUCTURAL
MECHANICAL
ELECTRICAL
CIVIL ENGINEER

AVSOFT
INFRASTRUCTURE

1840 CHESTNUT ROAD
CINCINNATI, OH 45216
T: 513-590-3089

LOW VOLTAGE

telgian
TELGIAN CORPORATION
10230 SOUTH 50TH PLACE
SUITE 100
PHOENIX, AZ 85044
T: (477) 838-4428
HTTP://WWW.TELGIAN.COM
FIRE PROTECTION

ISSUE LOG

NO.	REV.	DESCRIPTION	DATE
1	-	PERMIT SET	12/06/18
2	-	BID SET	03/21/19

JOB: 2018041 SCALE: 3/32" = 1'-0"

SHEET NO.

R1.1.2
PARTIAL REFRIGERATION EQUIPMENT PLAN EAST

COPYRIGHT © 2018 NAOS DESIGN GROUP OF MISSISSIPPI, PLLC. THESE DRAWINGS OR PARTS THEREOF MAY NOT BE REPRODUCED IN ANY FORM OR BY ANY METHOD, FOR ANY PURPOSE, WITHOUT PRIOR WRITTEN CONSENT FROM NAOS.