

Order Plans @ WWW.LDLINE.COM

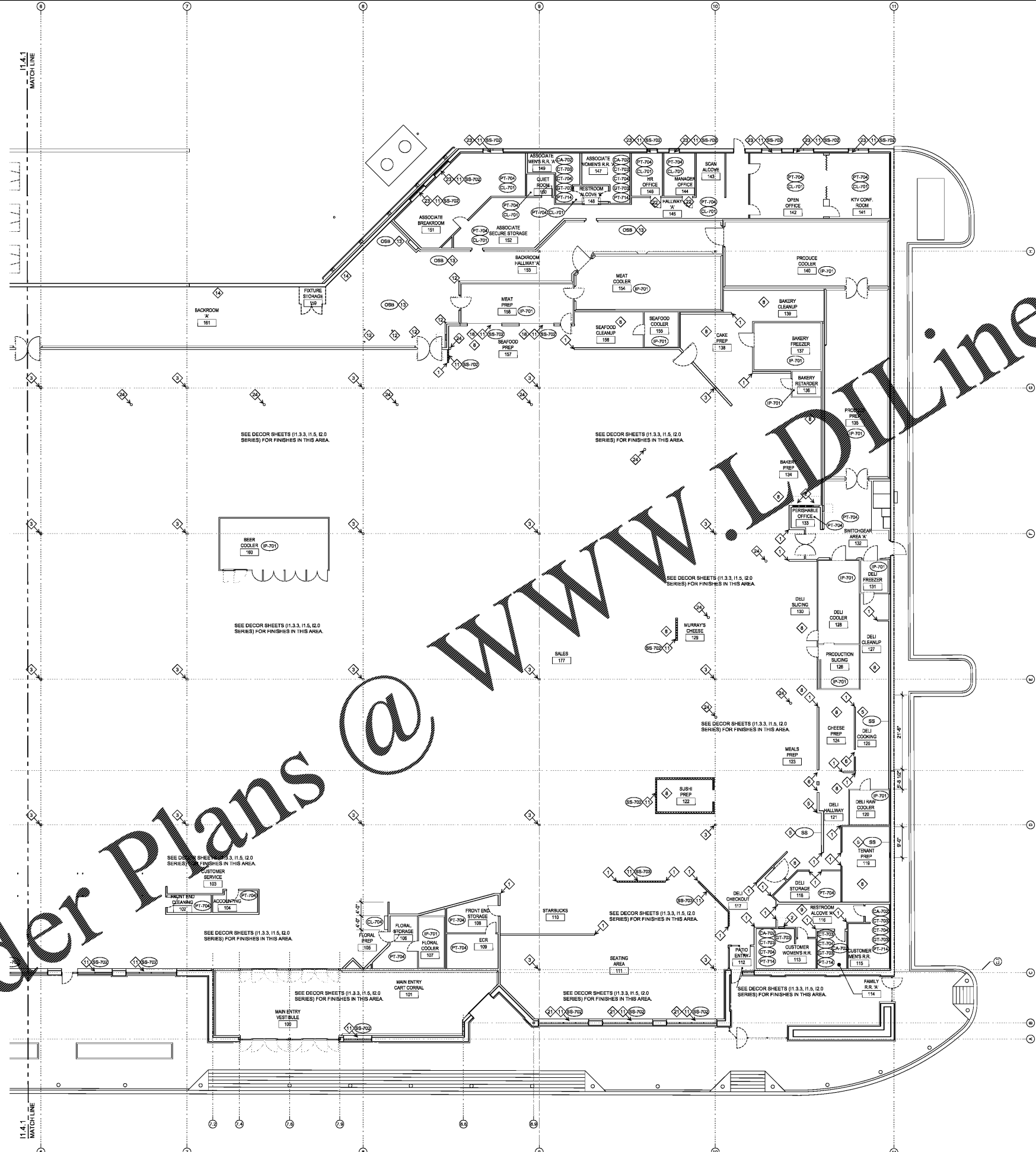

LEGEND, SYMBOLS AND NOTES APPLY TO BOTH 11.4.1 AND 11.4.2 SHEETS SOME ITEMS MAY NOT APPEAR ON THIS SHEET

SYMBOL LEGEND
 (xx-xxx) WALL FINISH TYPE - REFER TO FINISH LEGEND AND SPECIFICATIONS
 (x) KEYNOTE

- GENERAL NOTES**
- REFER TO SPECIFICATION SECTION 018127 DECOR INTERIOR FINISHES AND COLORS - ARTISIAN FOR ADDITIONAL FLOOR FINISH INFORMATION.
 - SEE MANUFACTURER'S SPECIFICATIONS FOR INSTALLATION REQUIREMENTS OF FINISHES SPECIFIED IN THESE DRAWINGS.
 - ALL MARLITE PREFINISHED WOOD FIBERBOARD PANELING IS TO RECEIVE A PREFINISHED METAL J-MOLDS TRIM CAP. THE METAL TRIM CAP IS TO BE MITERED AND BENT AROUND ALL OUTSIDE CORNERS. JOINTS WILL ONLY BE ACCEPTED ON INSIDE CORNERS AND STRAIGHT END TO END CONNECTIONS. ALL CONNECTIONS ARE TO BE GROUND SMOOTH FREE OF BURRS AND PAINTED.
 - ALL SALES FLOOR WALL PAINT TO BE SUPPLIED AND INSTALLED BY THE GENERAL CONTRACTOR, UNLESS NOTED OTHERWISE.
 - PROVIDE AND INSTALL ALL WALLCOVERINGS UNLESS NOTED OTHERWISE.
 - EDGE PROTECTION IS TO BE PROVIDED AT THE CORNERS OF ALL CERAMIC WALL TILE.
 - PAINT CHASES, REPAIR CRACKS IN CONCRETE AND COLUMNS.
 - ALL WALLS ARE TO BE FINISHED PER SPECIFICATIONS AND READY TO RECEIVE FINISH WALL COVERINGS.
 - REFER TO AS 1 SERIES FOR ARCHITECTURAL STANDARD DETAILS AND GENERAL INSTALLATION STANDARDS (GSDS).

- WALL FINISHES (xx-xxx)**
- PT-701 BUMPER - FOR USE ON CL-701
 - PT-702 PLASTIC COVE BASE
 - CT-703 CERAMIC WALL TILE
 - CT-704 CERAMIC WALL TILE
 - CL-703 FIBERGLASS REINFORCED PLASTIC (FRP) PANELS
 - CL-701 PAINTED BEADBOARD PANELING - WAINSCOT TO 2'-0" ABOVE FINISHED FLOOR.
 - CL-704 SLAT WALL
 - EXIST EXISTING FINISH TO REMAIN
 - GT-703 TILE GROUT - FOR WALL APPLICATION
 - IP-701 PREFABRICATED INSULATED WALL PANELS - FOR USE ON COOLER/FREEZER WITH A NATURAL GALVANIZED FINISH FOR SURFACES VISIBLE TO CUSTOMER
 - OSB ORIENTED STRAND BOARD
 - PT-704 PAINT
 - PT-706 PAINT
 - PT-714 PAINT
 - SS STAINLESS STEEL
 - SS-702 SOLID SURFACE CAP
 - SS-703 SOLID SURFACE CAP

- KEYED NOTES (x)**
- PROVIDE AND INSTALL STAINLESS STEEL CORNER GUARDS TO 4'-0" AFF. PER ASD-55A.
 - PAINT ELECTRICAL PANEL TO MATCH ADJACENT WALL.
 - GENERAL CONTRACTOR TO PROVIDE AND INSTALL COLUMN COVER PER ASD-157. PAINT PT-730 ABOVE COLUMN COVER.
 - PAINT COLUMN, PT-730.
 - INSTALL STAINLESS STEEL WALL PANELS AT NEW HOOD, RE: ASD-48.1.
 - WRAP THE OPENING IN STAINLESS STEEL, SIMILAR TO ASD-55A.
 - INSTALL DOOR AT PHARMACY GRILLE POCKET, RE: ASD-49.
 - SEE DECOR SHEET 11.5, FOR FINISHES IN THIS AREA.
 - SEE DECOR SHEETS 12.0 SERIES, FOR FINISHES IN THIS HALLWAY/COVE.
 - PAINT PT-717 AROUND THE COMPACTOR DOOR. THE PAINTED AREA IS TO EXTEND FROM THE FLOOR TO 8'-0" ABOVE FINISHED FLOOR AND 8'-0" WIDE CENTERED ON THE DOOR.
 - INSTALL SOLID SURFACE CAP OR WINDOW SILL.
 - PAINT BOLLARD - PT-716.
 - GYPSUM BOARD IS TO BE TAPED AND SANDED BUT NOT PAINTED ABOVE THE OSB. OSB IS NOT TO BE INSTALLED ON ANY COOLER PANELS.
 - THE CMU IS TO REMAIN EXPOSED.
 - GYPSUM BOARD IS TO BE TAPED AND SANDED BUT NOT PAINTED ABOVE THE FRP.
 - THE CMU IS TO REMAIN EXPOSED ABOVE THE OSB.
 - OSB IS TO BE ADDED TO THE EXISTING WALL.
 - DECOR CERAMIC TILE TO WRAP HEAD AND SILL OF WINDOW OPENING.
 - PAINT THE EXISTING HANDRAIL AROUND COMPACTOR - PT-716.
 - GENERAL CONTRACTOR TO PROVIDE AND INSTALL COLUMN COVER SIMILAR TO ASD-157. COLUMN COVER IS TO BE INSTALLED FULL HEIGHT IN THE COOLER.
 - INSTALL SOLAR SHADES, BL-701.
 - INSTALL MINI BLINDS OVER THE GLASS PANEL IN THE DOOR.
 - INSTALL MINI BLINDS IN WINDOW.
 - PAINT REFRIGERATION DROP PT-730.

Kroger
KROGER
STORE #473
 2013 UNIVERSITY AVENUE
 OXFORD, MISSISSIPPI 38655
 A DEVELOPMENT OF THE KROGER COMPANY

naos
 Naos Design Group Of Mississippi, PLLC.
 MARC BREETZ, ARCHITECT
 645 Lake and East Drive Suite 101
 Flowood, Mississippi 39232
 (p) 303.759.5777
 (f) 720.360.4281
 ARCHITECT OF RECORD

CDS
 COMMERCIAL DESIGN SYSTEMS, INC.
 13825 SW GALLIBREATH DRIVE
 SHERWOOD, OREGON 97140
 503.888.7900 (P) 503.828.8822
 INTERIOR DECOR

Pickering
 Pickering Firm, Inc.
 Architecture - Engineering
 Planning - Surveying
 8775 Lenox Center Court, Suite 300
 Memphis, TN 38115
 901.726.9919

ENGINEER OF RECORD:
 STRUCTURAL
 MECHANICAL
 ELECTRICAL
 CIVIL ENGINEER

V-SOFT
 INFRASTRUCTURE
 1820 CHESTNUT HORN
 CINCINNATI, OH 45216
 T: 513-595-3099
 LOW VOLTAGE

telgian
 TELGIAN CORPORATION
 10230 SOUTH 50TH PLACE
 SUITE 100
 PHOENIX, AZ 85044
 T: (477) 838-4428
 HTTP://WWW.TELGIAN.COM
 FIRE PROTECTION

ISSUE LOG

NO.	REV.	DESCRIPTION	DATE
1	-	PERMIT SET	12/05/18
2	-	BID SET	03/21/19

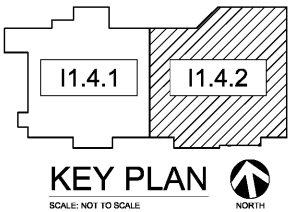

PARTIAL INTERIOR 01 FINISH PLAN EAST
 SCALE: 3/32" = 1'-0"

JOB: 2018041 SCALE: 3/32" = 1'-0"
 SHEET NO.
11.4.2
 PARTIAL INTERIOR FINISH PLAN EAST
 COPYRIGHT © 2018 NAOS DESIGN GROUP OF MISSISSIPPI, PLLC. THESE DRAWINGS, OR PART THEREOF, MAY NOT BE REPRODUCED IN ANY FORM, BY ANY METHOD, FOR ANY PURPOSE, WITHOUT PRIOR WRITTEN CONSENT FROM NAOS.