

Order Plans @

WWW.LDLINE.COM

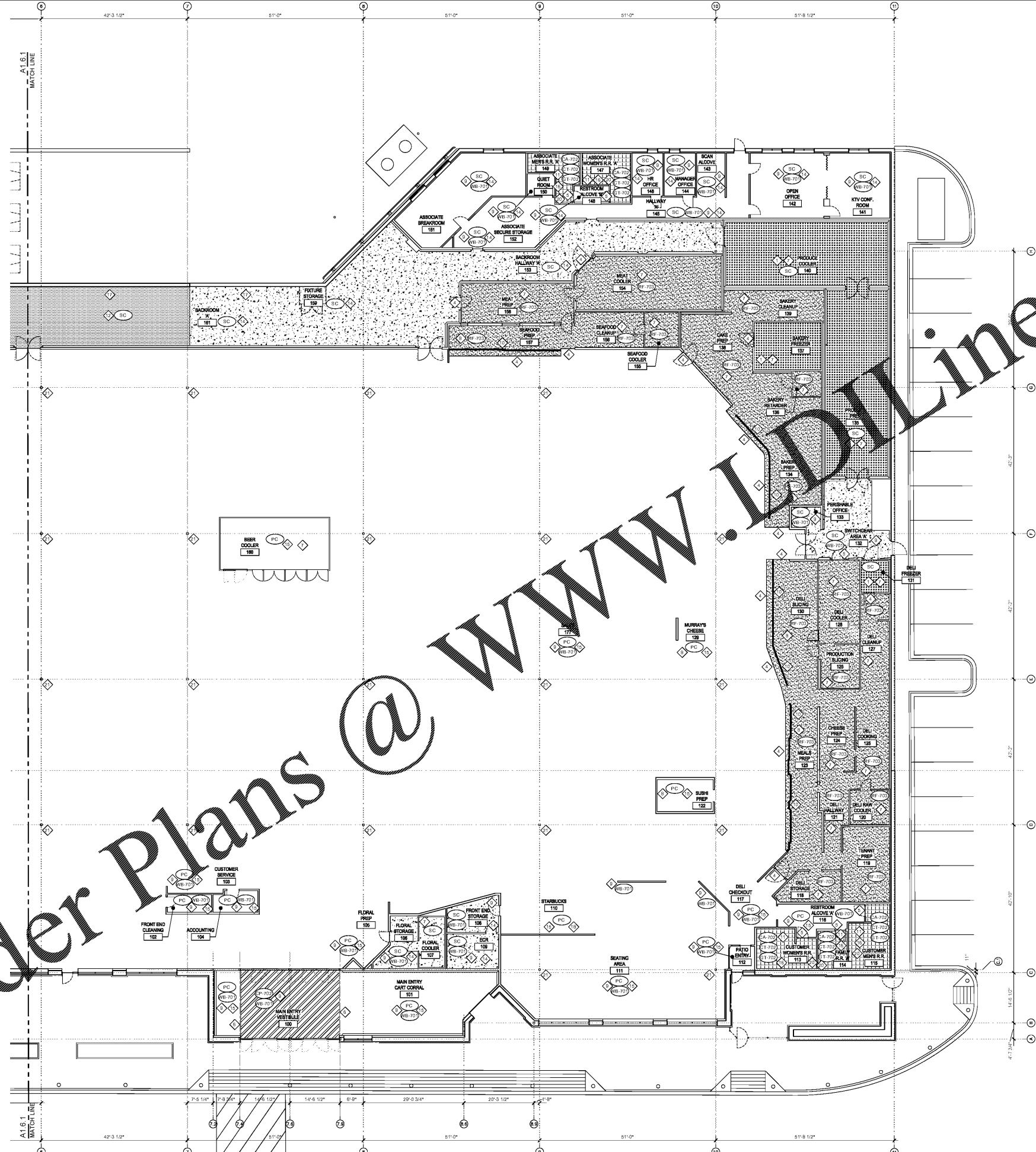

- LEGEND, SYMBOLS AND NOTES APPLY TO BOTH A1.6.1 AND A1.6.2 SHEETS, SOME ITEMS MAY NOT APPEAR ON THIS SHEET
- SYMBOL LEGEND**
- [Symbol] PADDED CARPET TILES
 - [Symbol] ENTRY CARPET TILES
 - [Symbol] RESINOUS FLOORING
 - [Symbol] CERAMIC TILE
 - [Symbol] SEALED CONCRETE WITH JF-701 JOINT FILLER
 - [Symbol] ANTI-SLIP FINISHED SEALED CONCRETE WITH JF-701 JOINT FILLER
 - [Symbol] EXISTING CONCRETE TO BE RESEALED, INCLUDING NEW JOINT FILLER, JF-701
 - [Symbol] POLISHED CONCRETE WITH JF-701 JOINT FILLER REFER TO A1.6.1 AND A1.6.2 FOR POLISH AREAS AND TREATMENTS
 - [Symbol] CUT OFF FLASHING PER GSD

- FLOOR FINISH LEGEND**
- CA-702 SANITARY CONCRETE
 - CP-701 CERAMIC TILE
 - CP-702 ENTRANCE CARPET
 - CT-702 CERAMIC TILE
 - CE-702 CERAMIC TILE
 - PC POLISHED GRAY CONCRETE
 - RF-703 RESINOUS FLOORING
 - SEALED GRAY CONCRETE
 - WB-701 RESILIENT WALL BASE

- GENERAL NOTES**
1. REFER TO SPECIFICATION SECTION 015127 FOR INTERIOR FINISHES AND COLORS - AS NOTATION FOR ADDITIONAL FLOOR FINISH INFORMATION.
 2. LEVEL FLOOR TRANSITION TO ADJOINING FLOOR SURFACES ARE REQUIRED.
 3. VERIFY ALL FIELD DIMENSIONS AND CONDITIONS INCLUDING, BUT NOT EXCLUSIVE TO, CASE LOCATIONS, FLOOR CONDITIONS AND CONSTRUCTIONS.
 4. SEE MANUFACTURER'S SPECIFICATIONS FOR INSTALLATION REQUIREMENTS OF FINISHES SPECIFIED IN THESE DRAWINGS.
 5. PROVIDE ALL TRANSITION/REDUCER STRIPS AT FLOORING TRANSITIONS.
 6. INSTALL RESILIENT WALL BASE ON ALL LAMINATED MILL WORK.
 7. TILE GRAIN TO RUN IN SINGLE DIRECTION UNLESS OTHERWISE NOTED.
 8. ALL EXPOSED WALL AREAS TO HAVE TOPSET BASE.
 9. REFER TO AS.1 SERIES FOR ARCHITECTURAL STANDARD DETAILS (ASD'S) AND GENERAL INSTALLATION DETAILS (GSD'S).

- KEYED NOTES**
1. PROVIDE ANTI-SLIP FINISH TO MATCH TEXTURE OF #120-150 GRIT SANDPAPER.
 2. CARPET TILES ARE TO BE INSTALLED AFTER THE FIXTURES HAVE BEEN SET.
 3. PROVIDE NEW RESINOUS, RF-703, OVER TOP OF THE NEW CURB.
 4. RESINOUS FLOOR TRANSITIONS, PER ASD-4A.
 5. CONCRETE TO CERAMIC FLOOR TRANSITIONS, PER ASD-4C.
 6. CARPET TO CONCRETE FLOOR TRANSITIONS PER ASD-4E.
 7. GRAY URETHANE JOINT SEALANT WALL TO FLOOR TRANSITION, PER ASD-51A.
 8. STAINLESS STEEL BENT COVE BASE WALL TO FLOOR TRANSITION, PER ASD-51B. THIS IS TO BE INSTALLED IN THE PREP AREAS THAT ARE VISIBLE TO THE CUSTOMER.
 9. RUBBER COVE BASE WALL TO FLOOR TRANSITION, PER ASD-51D.
 10. INSTALL STAINLESS STEEL WATER CUT OFF FLASHING IN DEPARTMENTS, RE: GSD-14.
 11. CONTINUE THE CONTROL JOINTS UP THRU NEW FLOORING AT ALL CONTROL JOINTS IN THE CONCRETE SLAB.
 12. TO INSTALL JOINT FILLER IN EXISTING SLAB JOINTS.
 13. FLOOR POLISHING CONSUL TANT TO INSTALL JOINT FILLER IN EXISTING SALES FLOOR SLAB JOINTS.
 14. INSTALL JOINT FILLER PER ASD-10S.
 15. FLOOR POLISHING CONSUL TANT TO INSTALL JOINT FILLER PER ASD-10S ON SALES FLOOR.
 16. INSTALL FLOOR SEALANT AT ALL FIXTURES; RE: PLUMBING DRAWINGS.
 17. PAINT 1" WIDE RODENT INSPECTION STRIPE ON FLOOR. THE STRIPE IS TO BE PAINTED IN BACKROOM AND DICK AREA ON FLOOR ADJACENT TO THE EXTERIOR WALL EXCEPT FOR COOLER AND FREEZER AREAS.
 18. INSTALL RUBBER WALL BASE PER STARBUCKS DRAWINGS.
 19. THE COMPACTOR STAR AND LANDING ARE TO BE RESEALED.
 20. INSTALL WATERPROOFING MEMBRANE AT WALL TRANSITION PER ASD-15A.
 21. INSTALL JOINT FILLER, JF-702 AT NEW AND OLD COLUMNS PER ASD-15B.

ISSUE LOG

NO.	REV.	DESCRIPTION	DATE
1	-	PERMIT SET	12/05/18
2	-	BID SET	03/21/19

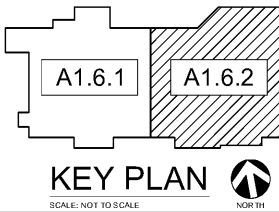

**PARTIAL FLOOR
01 FINISH PLAN EAST**
SCALE: 3/32" = 1'-0"

KROGER
STORE #473

2013 UNIVERSITY AVENUE
OXFORD, MISSISSIPPI 38655

A DEVELOPMENT OF
THE KROGER COMPANY

naos
Naos Design Group Of Mississippi, PLLC.

MARC BREETZ, ARCHITECT

645 Lakeland East Drive
Suite 101
Flowood, Mississippi 39232
(p) 303.759.5777
(f) 720.360.4281

ARCHITECT OF RECORD

CDS
COMMERCIAL DESIGN SYSTEMS, INC.

13225 SW GALBREATH DRIVE
SHERWOOD, OREGON 97140
503.855.7000 (P) 503.625.5902

INTERIOR DECOR

Pickering Firm, Inc.
Architecture - Engineering
Planning - Surveying

6775 Lenox Center Court, Suite 300
Memphis, TN 38115
901.726.0818

ENGINEER OF RECORD:
STRUCTURAL
MECHANICAL
ELECTRICAL
CIVIL ENGINEER

V-SOFT
INFRASTRUCTURE

1500 CHESTER ROAD
CINCINNATI, OH 45216
T: 513-670-3009

LOW VOLTAGE

telgian

TELGIAN CORPORATION
10230 SOUTH 50TH PLACE
SUITE 100
PHOENIX, AZ 85044
T: (677) 836-4428
HTTP://WWW.TELGIAN.COM
FIRE PROTECTION

JOB: 2018041 SCALE: 3/32" = 1'-0"

SHEET NO. **A1.6.2**

PARTIAL FLOOR FINISH PLAN EAST

COPYRIGHT © 2018 BY TELGIAN CORPORATION OF MISSISSIPPI. ALL RIGHTS RESERVED. NO PART OF THIS DRAWING MAY BE REPRODUCED OR TRANSMITTED IN ANY FORM OR BY ANY MEANS, ELECTRONIC OR MECHANICAL, WITHOUT THE WRITTEN CONSENT OF TELGIAN.