

Order Plans @ www.LDILine.com

LEGEND, SYMBOLS AND NOTES APPLY TO BOTH A1.5.1 AND A1.5.2 SHEETS, SOME ITEMS MAY NOT APPEAR ON THIS SHEET

OCCUPANCY LEGEND

AREAS SHOWN FOR MODIFIED, SALT, SLIP AND STAIN ARE FOR ESTIMATING PURPOSES ONLY. HAND GRINDING LINEAL FOOTAGE IS FOR ESTIMATING PURPOSES ONLY. ACTUAL LOCATIONS TO BE DETERMINED BY KROGER FLOOR AND MERCHANDISING PLANS.

	STANDARD CONCRETE POLISHING	65,133 S.F.
	MODIFIED CONCRETE POLISHING	1,483 S.F.
	SLIP RESISTANT TREATMENT	2,172 S.F.
	STAIN PROTECTION TREATMENT	6,899 S.F.
	HAND GRINDING	1,191 L.F.

GENERAL NOTES

- FLOOR POLISHING CONTRACTOR TO PROVIDE NEW JOINT SEALANTS.
- FLOORING CONTRACTOR TO PROVIDE A UNIFORM FINISH ON ENTIRE SALES FLOOR INCLUDING BLANKET POLISH AREA AS NECESSARY.
- FIXTURE CONTRACTOR IS TO REMOVE THE SIGNING, EQUIPMENT, ETC AS MAY BE NECESSARY TO COMPLETE THE FLOOR POLISHING. SHEETS WILL BE RELOCATED TO A TEMPORARY LOCATION AND RETURNED BACK TO THE ORIGINAL LOCATION ON POLISHING COMPLETION.
- FLOORING CONTRACTOR TO PROVIDE FOR ALL DUST CONTROL AND PARTITION POLISHING. IF CLEANING IS REQUIRED IT WILL BE AT THE COST OF THE FLOORING CONTRACTOR.

KEYED NOTES

NO HAND GRINDING IS REQUIRED IN THIS ROOM.

KROGER
STORE #473

2013 UNIVERSITY AVENUE
OXFORD, MISSISSIPPI 38655

A DEVELOPMENT OF:
THE KROGER COMPANY

Naos Design Group Of Mississippi, PLLC.

MARC BREETZ, ARCHITECT

645 Lakeland East Drive
Suite 101
Flowood, Mississippi 39232
(p) 303.759.5777
(f) 720.360.4281

ARCHITECT OF RECORD

CDS
COMMERCIAL DESIGN SYSTEMS, INC.

13825 SW GALBREATH DRIVE
SHERWOOD, OREGON 97140
503.855.7000 (P) 503.825.8002

INTERIOR DECOR

Pickering Firm, Inc.
Architecture - Engineering
Planning - Surveying

6775 Lenox Center Court, Suite 300
Memphis, TN 38115
901.726.0818

ENGINEER OF RECORD:
STRUCTURAL
MECHANICAL
ELECTRICAL
CIVIL ENGINEER

V-SOFT
INFRASTRUCTURE

1850 CHESTER ROAD
CINCINNATI, OH 45216
T: 513-670-3000

LOW VOLTAGE

telgian
TELGIAN CORPORATION
10230 SOUTH 50TH PLACE
SUITE 100
PHOENIX, AZ 85044
T: (677) 836-4428
HTTP://WWW.TELGIAN.COM
FIRE PROTECTION

ISSUE LOG

NO.	REV.	DESCRIPTION	DATE
1	-	PERMIT SET	12/05/18
2	-	BID SET	03/21/19

JOB: 2018041 SCALE: 3/32" = 1'-0"

SHEET NO.

A1.5.2
PARTIAL CONCRETE POLISHING PLAN EAST

PARTIAL CONCRETE 01 POLISHING PLAN EAST

SCALE: 3/32" = 1'-0"

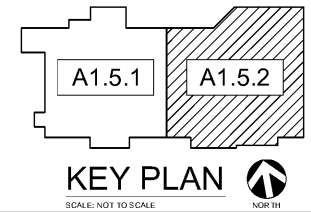

COPYRIGHT © 2018/2019 DESIGN GROUP OF MISSISSIPPI, PLLC. THESE DRAWINGS OR PARTS THEREOF MAY NOT BE REPRODUCED, COPIED, EITHER WHOLLY OR IN PART, OR TRANSMITTED IN ANY FORM OR BY ANY MEANS, WITHOUT WRITTEN PERMISSION FROM THE ARCHITECT.