

Order Plans @ www.ldline.com

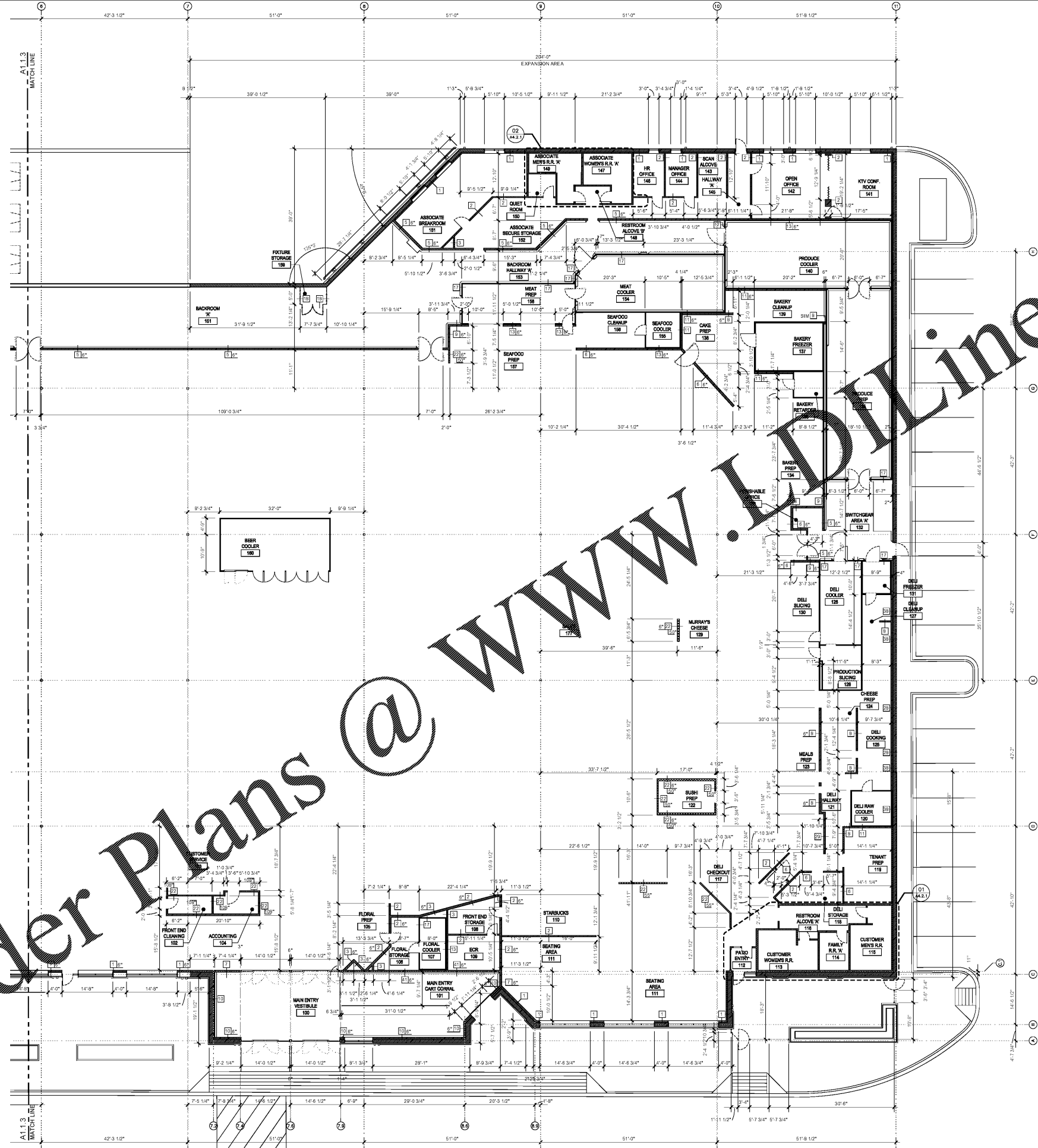

- SYMBOL LEGEND**
- EXISTING PARTITION TO REMAIN
 - NEW STUD PARTITION - REFERENCE PARTITION TYPES ON A3.2 SERIES
 - NEW LOW WALL STUD PARTITION - REFERENCE PARTITION TYPES ON A3.2 SERIES
 - NEW CHAINLINK FENCE PARTITION - REFERENCE PARTITION TYPES ON A3.2 SERIES
 - NEW COOLER/FREEZER PANEL
 - WALL TYPE: REFER TO A3.2 SERIES FOR WALL ASSEMBLY AND NOMENCLATURE.

- GENERAL NOTES**
1. THE REFRIGERATION CONTRACTOR IS TO SEAL ALL PENETRATIONS IN COOLERS AND FREEZERS.
 2. PATCH AND REPAIR WALLS AS NEEDED. PREP FOR NEW FINISHES.
 3. COORDINATE WITH KROGER PROJECT MANAGER WHEN TEMPORARY CONSTRUCTION BARRIERS WILL BE USED. SEE ASS-150A AND ASS-100C.
 4. PROVIDE BLOCKING FOR THE FOLLOWING EQUIPMENT:
 - FIRE EXTINGUISHERS - 1 PER 100 SQ. FT. OF FLOOR AREA AND LOCAL FIRE DEPARTMENT REQUIREMENTS.
 - EQUIPMENT RACKS - 1 PER 100 SQ. FT. OF FLOOR AREA.
 - FLAT SCREEN TV'S - 1 PER 100 SQ. FT. OF FLOOR AREA.
 - GATES
 - HOISTING AND LIFTING DEVICES
 - MONITOR RACKS
 - PAPER RACKS
 - WALL CABINETS WITH PARTITIONS
 - NEW COOLING UNIT OPERATOR
 - WALL MOUNTED SINKS PER GBD-15
 - WALL MOUNTED COMPUTER WORK STATIONS PER GBD-15
 5. PROVIDE BLOCKING PER KROGER'S STANDARD DESIGN GUIDELINES FOR PREP AREAS. SEE 05A3.1.1.
 6. PROVIDE TEMPORARY CHAINLINK FENCE WITH GREEN FABRIC FOR SCREENING EXTERIOR DEWOLITION AND CONSTRUCTION AREAS AND TO PREVENT BLOWING DEBRIS. COORDINATE LOCATIONS WITH KROGER PROJECT MANAGER.
 7. ALL CONDUIT AND UTILITY DROPS ARE TO BE KEPT AS TIGHT TO THE COLUMNS AS POSSIBLE AND WRAPPED IN METAL STUDS AND GYPSUM BOARD, SIMILAR TO GBD-4 AND GBD-5.
 8. PATCH EXISTING WALL AS NECESSARY AT LOCATIONS WHERE NEW PLUMBING OR REFRIGERATION LINES WERE INSTALLED.
 9. REFER TO A3.1 SERIES FOR ARCHITECTURAL STANDARD DETAILS (ASD'S) AND GENERAL INSTALLATION DETAILS (GBD'S).

Kroger
KROGER
STORE #473
 2013 UNIVERSITY AVENUE
 OXFORD, MISSISSIPPI 38655
 A DEVELOPMENT OF THE KROGER COMPANY

naos
 Naos Design Group Of Mississippi, PLLC.
 MARC BREETZ, ARCHITECT
 645 Lakeland East Drive Suite 101
 Flowood, Mississippi 39232
 (p) 303.759.5777
 (f) 720.360.4281
ARCHITECT OF RECORD

CDS
 COMMERCIAL DESIGN SYSTEMS, INC.
 13825 SW GALEREAH DRIVE
 SHERWOOD, OREGON 97140
 503.885.7000 (P)503.625.9002
INTERIOR DECOR

Pickering Firm, Inc.
 Architecture - Engineering
 Planning - Surveying
 6775 Lenox Center Court Suite 300
 Memphis, TN 38115
 901.726.0810
ENGINEER OF RECORD:
 STRUCTURAL
 MECHANICAL
 ELECTRICAL
 CIVIL ENGINEER

AVSOFT
 INFRASTRUCTURE
 1650 CHESTER ROAD
 CINCINNATI, OH 45216
 T: 513-670-3009
LOW VOLTAGE

telgian
 TELGIAN CORPORATION
 10230 SOUTH 50TH PLACE
 SUITE 100
 PHOENIX, AZ 85044
 T: (602) 836-4426
 HTTP://WWW.TELGIAN.COM
FIRE PROTECTION

ISSUE LOG

NO.	REV.	DESCRIPTION	DATE
1	-	PERMIT SET	12/05/18
2	-	BID SET	03/21/19

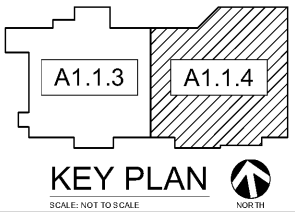

PARTIAL DIMENSION & PARTITION TYPE PLAN EAST
 SCALE: 3/32" = 1'-0"

JOB: 2018041 SCALE: 3/32" = 1'-0"
 SHEET NO.
A1.1.4
 PARTIAL DIMENSION & PARTITION TYPE PLAN EAST
COPYRIGHT © 2018 KROGER STORE GROUP OF MISSISSIPPI, INC. ALL RIGHTS RESERVED. THIS PLAN IS THE PROPERTY OF KROGER STORE GROUP OF MISSISSIPPI, INC. AND IS TO BE USED ONLY FOR THE PROJECT AND SITE SPECIFICALLY IDENTIFIED HEREON. WITHOUT PRIOR WRITTEN CONSENT FROM KROGER STORE GROUP OF MISSISSIPPI, INC.