

KEYED NOTES CONTINUED

31. NEW REFRIGERATED CASE CORNER GUARD (GE3C34) PER ASD-160.
32. NEW REFRIGERATED GLASS DOOR END CASE CORNER GUARD (GE3C33) PER ASD-160A.
33. NEW LEFT OUT GUARD RAIL AND BOLLARDS PER ASD-21A. INSTALL AFTER REFRIGERATION EQUIPMENT HAS BEEN SET.
34. INSTALL CART STOP RAILING PER SPECIFICATIONS.
35. EXISTING ARMOCO STYLE GUARD RAIL TO BE PAINTED.
36. NEW PAINTED ARMOCO STYLE GUARD RAIL.
37. NEW DECORATIVE METAL FENCING.
38. INSTALL NEW DOCK DOOR PROTECTORS DOCK SEALS AND BUMPERS, RE: ASD-152.
39. INSTALL NEW DOCK LIGHT SUPPORTS PER ASD-82A. INSTALL NEW LIGHTS PER ELECTRICAL DRAWINGS.
40. NEW METAL LADDER ATTACHED TO COOLER PER ASD-77.
41. NEW ROOF LADDER ABOVE THE MEAT COOLER PER ASD-50 AND OSAS.1.2.
42. NEW ROOF AND OVERFLOW DRAIN DOWNSPOUT WITH LAMBS TONGUE.
43. NEW ROOF DOWNSPOUT WITH LAMBS TONGUE.
44. INSTALL NEW BIKE RACK.
45. REFER TO CIVIL DRAWINGS FOR PICKUP PARKING INFORMATION.
46. REFER TO CIVIL DRAWINGS FOR PAVING AND STRIPING INFORMATION.
47. INSTALL MEAT CUTTING MONITOR PER ASD-72C.
48. THE GENERAL CONTRACTOR IS TO INSTALL A PLAN BOX PER GRID-24. THE GENERAL CONTRACTOR IS ALSO REQUIRED TO INSERT A COPY OF THE COMPLETE AS-BUILT SET OF DRAWINGS AND A COPY OF THE ISSUED SPECIFICATIONS INTO THE PLAN BOX AT THE COMPLETION OF THE JOB.
49. EXISTING COMPACTOR TO REMAIN AND BE PAINTED.
50. REFER TO STARBUCKS DRAWINGS FOR SCOPE OF WORK IN THIS AREA.
51. THE REFRIGERATION CONTRACTOR IS TO INSTALL NEW PROTOCOL UNIT, RE: REFRIGERATION DRAWINGS.
52. THE REFRIGERATION CONTRACTOR IS TO INSTALL WALL MOUNTED REFRIGERATION PIPE GUARDS PER GRID-17. RE: REFRIGERATION DRAWINGS.
53. THE REFRIGERATION CONTRACTOR IS TO INSTALL NEW COOLER/FREEZER BOX IN ITS ENTIRETY.
54. THE REFRIGERATION CONTRACTOR IS TO INSTALL NEW COOLER/FREEZER DOOR.
55. EXISTING FIRE RISER AND BACKFLOW TO REMAIN. RE: FIRE ALARM DRAWINGS.
56. NEW FIRE SPRINKLER PIPE FOR FDC CONNECTION. NEW FIRE DEPARTMENT CONNECTION, COORDINATE FINAL INSTALLATION. RE: FIRE WITH ADJUDICATORY JURISDICTION AND FIRE SPRINKLER DRAWINGS.
57. NEW PLUMBING FIXTURE, RE: PLUMBING DRAWINGS.
58. NEW HOT WATER HEATER, RE: PLUMBING DRAWINGS.
59. TWO NEW HEAT RECOVERY TANKS, RE: PLUMBING DRAWINGS.
60. INSTALL NEW GREASE INTERCEPTOR, RE: PLUMBING DRAWINGS.
61. INSTALL HOSE REEL WITH WATER THREAD ADAPTER TO WALL. TOP OF REEL AT 8" P.A.F.A. WITH FREEZE PROOF HOSE REEL, RE: PLUMBING DRAWINGS.
62. THE PLUMBING CONTRACTOR IS TO EXTEND THE HELM LINE THRU THE WALL AT THE TANKS AND FILLING STATION.
63. NO EXPOSED CONDUIT OR PIPING ALLOWED IN PREP AREAS.
64. EXISTING ELECTRICAL GEAR TO REMAIN, RE: ELECTRICAL DRAWINGS.
65. EXISTING ELECTRICAL PANELS TO REMAIN, RE: ELECTRICAL DRAWINGS.
66. NEW PAD MOUNTED SECONDARY TRANSFORMER, RE: ELECTRICAL DRAWINGS.
67. NEW PAD MOUNTED TRANSFORMER, RE: ELECTRICAL DRAWINGS.
68. NEW PAD MOUNTED SECONDARY CABINET, RE: ELECTRICAL DRAWINGS.
69. NEW GENERATOR, RE: ELECTRICAL DRAWINGS.
70. NEW ELECTRICAL GEAR, RE: ELECTRICAL DRAWINGS.
71. NEW TRANSFORMER MOUNTED TO THE FLOOR, RE: ELECTRICAL DRAWINGS.
72. NEW SURFACE MOUNTED ELECTRICAL PANEL, RE: ELECTRICAL DRAWINGS.
73. NEW RECESSED ELECTRICAL PANEL(S), RE: ELECTRICAL DRAWINGS.
74. NEW POWER POLE, RE: ELECTRICAL DRAWINGS.
75. NEW IDF CABINET LOCATED ABOVE THE COOLER, RE: LOW VOLTAGE DRAWINGS.
76. NEW IDF CABINET, RE: LOW VOLTAGE DRAWINGS.
77. NEW EGR ROOM, COORDINATE WITH LOW VOLTAGE AND ELECTRICAL DRAWINGS.
78. NEW DOWNSPOUT CONNECTED TO STORM DRAINAGE BELOW GRADE, RE: CIVIL AND PLUMBING DRAWINGS.
79. NEW MASONRY AND CUI PLANTER WITH A CASTSTONE CAP. RE: LANDSCAPE, CIVIL AND STRUCTURAL DRAWINGS.
80. NEW LANDSCAPE PLANTING BED, RE: LANDSCAPE DRAWINGS.
81. NEW WALL MOUNTED TRANSFORMER, RE: ELECTRICAL DRAWINGS.
82. INSTALL NEW DOCK LIGHT SUPPORT PER ASD-82. INSTALL NEW DOCK LIGHT PER ELECTRICAL DRAWINGS.
83. PROVIDE A 3 TUD WALL CLOSE OFF AT THIS LOCATION. PROVIDE FINISH PER 1.1.1 SERIES.

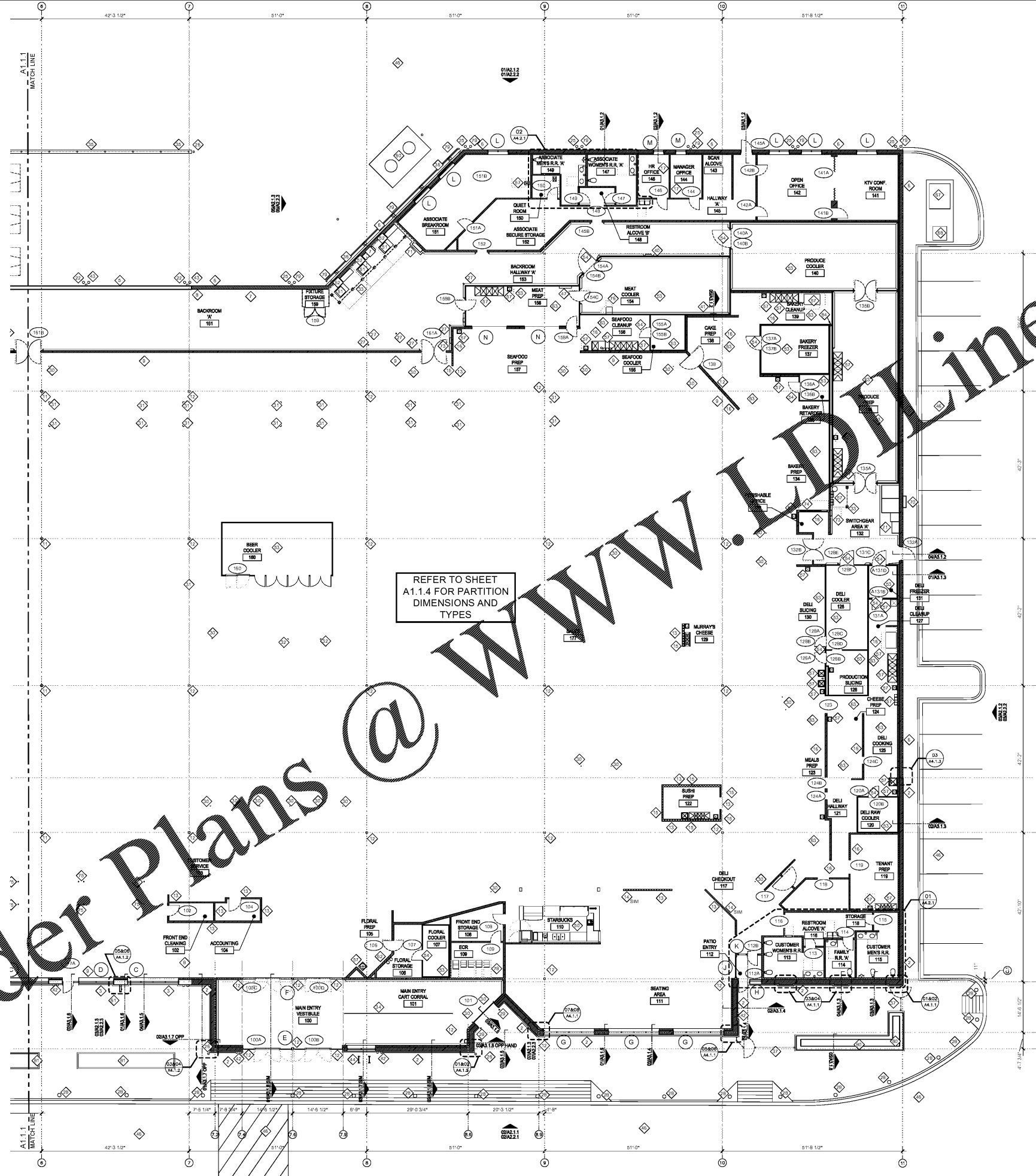

- SYMBOL LEGEND**
- EXISTING PARTITION TO REMAIN
 - NEW 5 TUD PARTITION - REFERENCE PARTITION TYPES ON A3.2 SERIES
 - NEW LOW WALL 5 TUD PARTITION - REFERENCE PARTITION TYPES ON A3.2 SERIES
 - NEW CHAINLINK FENCE PARTITION - REFERENCE PARTITION TYPES ON A3.2 SERIES
 - NEW COOLER/FREEZER PANEL
 - DOORFRAME NUMBER. REFER TO DOOR AND FRAME SCHEDULE ON A5.1.1 AND A5.1.2
 - WINDOW LETTER. REFER TO WINDOW SCHEDULE ON A5.1.4
- GENERAL NOTES**
1. THE REFRIGERATION CONTRACTOR IS TO SEAL ALL PENETRATIONS IN COOLERS AND FREEZERS.
 2. PATCH AND REPAIR WALLS AS NEEDED. PREP FOR NEW FINISHES.
 3. COORDINATE WITH KROGER PROJECT MANAGER FOR TEMPORARY CONSTRUCTION BARRIERS. SEE ASD-152A AND ASD-152C.
 4. PROVIDE BLOCKING FOR THE FOLLOWING TYPES AND EQUIPMENT. REFER TO THE FOLLOWING LOCATIONS: FIRE EXTINGUISHER, LOCATED IN THE NEARBY CORNER AND LOCAL FIRE ALARM EQUIPMENT, ELECTRICAL EQUIPMENT, REELS AND RACKS, REFRIGERATION RACKS, REFRIGERATION EQUIPMENT, WALL MOUNTED WORK STATIONS PER ASD-152A
 5. PROVIDE BLOCKING PER KROGER STANDARD DESIGN GUIDELINES FOR PREP AREAS. SEE OSAS.1.1.
 6. PROVIDE TEMPORARY CHAINLINK FENCE WITH GREEN FABRIC FOR SCREENING EXTERIOR DECONTAMINATION AND CONSTRUCTION AREAS AND TO PREVENT BLOWING DEBRIS. COORDINATE LOCATIONS WITH KROGER PROJECT MANAGER.
 7. ALL CONDUIT AND UTILITY DROPS ARE TO BE KEPT AS RIGHT TO THE COLUMN AS POSSIBLE AND WRAPPED IN METAL STRIPS AND GYPSUM BOARD, 5/8" X 4" TO GRID-4 AND GRID-2.
 8. PAINT ALL EXISTING CHASES AND COLUMNS, ABOVE COLUMN COVERS PT-130.
 9. PATCH EXISTING WALL AS NECESSARY AT LOCATIONS WHERE NEW PLUMBING OR REFRIGERATION LINES WERE INSTALLED.
 10. REFER TO AS.1 SERIES FOR ARCHITECTURAL STANDARD DETAILS (ASDs) AND GENERAL INSTALLATION DETAILS (GDs).

- KEYED NOTES**
1. INFILL OPENING WITH SALVAGED BRICK FROM DEMOLISHED WALL WITH WHITE MORTAR TO MATCH EXISTING. WALL BACKING BEING SALVAGED EXISTING BRICK SIMILAR TO WALL SECTION OSAS.1.3.
 2. NEW 8" CMU WALL WITH BRICK VENEER BASE COURSE, RE: SECTIONS AND STRUCTURAL DRAWINGS.
 3. EXISTING CMU WALL WITH NEW BRICK VENEER BASE COURSE, RE: SECTIONS AND STRUCTURAL DRAWINGS.
 4. EXISTING CMU WALL AND BRICK VENEER BASE COURSE, RE: SECTIONS AND STRUCTURAL DRAWINGS.
 5. EXISTING 12" CMU WALL TO REMAIN.
 6. NEW 12" CMU WALL, RE: SECTIONS AND STRUCTURAL DRAWINGS.
 7. FIRST COURSE OF CMU ABOVE FINISHED FLOOR IS TO BE GROUTED SOLID, ALONG THE BACK ROOM WALL.
 8. NEW WALL CONSTRUCTION TO MATCH AND ALIGN WITH ADJACENT WALL CONSTRUCTION.
 9. VERTICAL GYPSUM BOARD CONTROL JOINTS ARE TO BE INSTALLED AT WINDOWS CORNERS AND RUNS GREATER THAN 30'-0" LINEAL FEET. CONTROL JOINTS ARE TO BE COORDINATE WITH DECOR DRAWINGS.
 10. CUT IN NEW VERTICAL GYPSUM BOARD CONTROL JOINTS IN THE EXISTING GYPSUM BOARD WALL. JOINTS ARE TO BE INSTALLED IN RUNS GREATER THAN 30'-0" LINEAL FEET. CONTROL JOINTS ARE TO BE COORDINATE WITH DECOR DRAWINGS.
 11. EXISTING STEEL COLUMN, TYP. RE: STRUCTURAL DRAWINGS.
 12. NEW STEEL COLUMN, TYP. RE: STRUCTURAL DRAWINGS.
 13. PROVIDE STEEL TUBES AT PARTIAL HEIGHT WALL. PROVIDE TUBES AT EACH END AND 4'-0" ON CENTER COORDINATE TUBE LOCATIONS SO AS NOT TO INTERFERE WITH PLUMBING LINES. SEE PARTITION TYPE 22A3.2. PROVIDE SOLID SURFACE CAP PER 1.1.1 SERIES.
 14. INSTALL LOW WALL PER ASD-73.
 15. INSTALL FROSTED ACRYLIC PANEL ON LOW WALL PER ASD-72A.
 16. METAL STUDS ARE TO BE SPACED AT 16" ON CENTER.
 17. PROVIDE SOUND ATTENUATION INSULATION BETWEEN THE STUDS IN ALL PARTITIONS FOR THIS ROOM.
 18. INSTALL NEW PHARMACY WINDOW AND ACCESSORIES PER ASD-8.
 19. EXISTING CHAINLINK FENCING TO REMAIN, STRAIGHTEN AND REPAIR AS NECESSARY.
 20. NEW CHAINLINK FENCING TO MATCH EXISTING.
 21. NEW CLEANING CENTER SIMILAR TO GRID-8.
 22. EXISTING PIPE BOLLARD TO REMAIN AND BE STRAIGHTENED, PAINT PT-002.
 23. EXISTING RAIL PROTECTION TO REMAIN AND BE PAINTED PT-716.
 24. EXISTING PLASTIC COVERED BOLLARD TO REMAIN.
 25. 8" DIA 9'-0" LONG CONCRETE FILLED STEEL PIPE BOLLARD. EXPOSE 4'-0" ABOVE GRADE. PAINT PT-002. BOLLARD IS TO BE SET 5'-0" OFF THE FIXTURE, EQUIPMENT, WALL, ETC. IN BOTH DIRECTIONS. THE BOLLARD IS TO BE SET AT THE FIXTURE, EQUIPMENT, WALL, ETC. HAS BEEN LOCATED OR INSTALLED. RE: SIMILAR ASD-154.
 26. 8" DIA 9'-0" LONG CONCRETE FILLED STEEL PIPE BOLLARD. EXPOSE 4'-0" ABOVE GRADE. PAINT PT-716. BOLLARD IS TO BE SET 5'-0" OFF THE FIXTURE, EQUIPMENT, WALL, ETC. IN BOTH DIRECTIONS. THE BOLLARD IS TO BE SET AT THE FIXTURE, EQUIPMENT, WALL, ETC. HAS BEEN LOCATED OR INSTALLED. RE: ASD-154.
 27. 4" DIA 9'-0" LONG CONCRETE FILLED STEEL PIPE BOLLARD. EXPOSE 4'-0" ABOVE GRADE. PAINT PT-716. BOLLARD IS TO BE SET 5'-0" OFF THE FIXTURE, EQUIPMENT, WALL, ETC. IN BOTH DIRECTIONS. THE BOLLARD IS TO BE SET AT THE FIXTURE, EQUIPMENT, WALL, ETC. HAS BEEN LOCATED OR INSTALLED. RE: ASD-154.
 28. INSTALL DECORATIVE CONCRETE BOLLARD. RE: ASD-161.
 29. INSTALL ROLLER POST PER ASD-149 AND SIMILAR TO ASD-20.
 30. NEW CASE PROTECTION REMOVABLE POST (GE3) PER ASD-19.

- KEY PLAN**
- SCALE: NOT TO SCALE
- 01 PARTIAL FLOOR PLAN EAST
- SCALE: 3/32" = 1'-0"
- KEY PLAN
- SCALE: NOT TO SCALE
- NON-TH

KROGER
STORE #473

2013 UNIVERSITY AVENUE
OXFORD, MISSISSIPPI 38655

A DEVELOPMENT OF
THE KROGER COMPANY

naos
Naos Design Group Of Mississippi, PLLC.

MARC BREETZ, ARCHITECT

645 Lakeland East Drive
Suite 101
Flowood, Mississippi 39232
(p) 303.759.5777
(f) 720.360.4281

ARCHITECT OF RECORD

CDS
COMMERCIAL DESIGN SYSTEMS, INC.

1925 SW GALLERATH DRIVE
SHERWOOD, OREGON 97140
503.855.7000 (P) 503.855.5902

INTERIOR DECOR

Pickering Firm, Inc.
Architects - Engineers
Planners - Surveyors

6775 Lenox Center Court, Suite 300
Memphis, TN 38115
901.726.0910

ENGINEER OF RECORD:
STRUCTURAL
MECHANICAL
ELECTRICAL
CIVIL ENGINEER

V-SOFT
INFRASTRUCTURE

1650 CHESTER ROAD
CINCINNATI, OH 45216
T: 513-670-3009

LOW VOLTAGE

ISSUE LOG

NO.	REV.	DESCRIPTION	DATE
1	0	PERMIT SET	12/05/18
2	0	BID SET	03/21/19

JOB: 2018041 SCALE: 3/32" = 1'-0"

SHEET NO. **A1.1.2**

PARTIAL FLOOR PLAN EAST

Copyright © 2018 Naos Design Group of Mississippi, PLLC. These drawings are prepared under the supervision of Marc Breetz, Architect. No part of these drawings may be reproduced, stored in a retrieval system, or transmitted, in any form or by any means, without prior written consent of Naos Design Group of Mississippi, PLLC.