

Order Plans @ www.LDILine.com

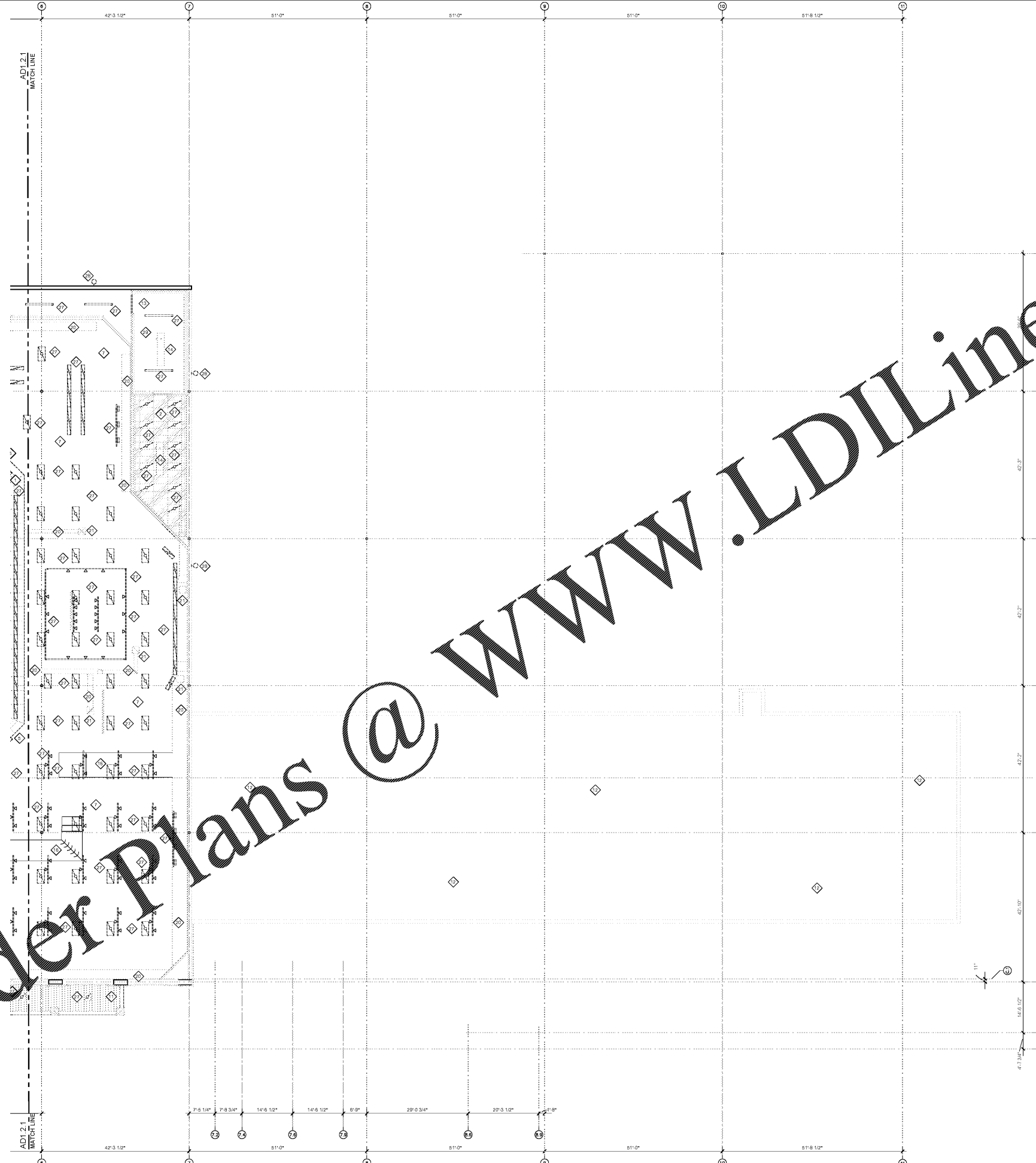

- LEGEND, SYMBOLS AND NOTES APPLY TO BOTH AD1.2.1 AND AD1.2.2 SHEETS. SOME ITEMS MAY NOT APPEAR ON THIS SHEET.
- SYMBOL LEGEND**
- ===== SOFFIT TO BE DEMOLISHED
 - PARTITION TO BE DEMOLISHED
 - 2x4 SUSPENDED ACOUSTICAL CEILING TO BE DEMOLISHED
 - 2x4 SUSPENDED VINYL CEILING TO BE DEMOLISHED
 - 2x4 SUSPENDED METAL CEILING TO BE DEMOLISHED
 - GYPSUM BOARD SOFFIT/CEILING TO BE DEMOLISHED
 - SOFFIT PANELS TO BE DEMOLISHED
 - EXISTING AIR DISTRIBUTION DEVICE TO BE DEMOLISHED
 - AIR DISTRIBUTION DEVICE TO BE DEMOLISHED
 - EXIT SIGN TO BE DEMOLISHED
 - EXISTING PROTRUSION TO BE DEMOLISHED
 - 2X2 LIGHT TO BE DEMOLISHED
 - 4'-0" SUSPENDED LIGHT TO BE DEMOLISHED
 - 4'-0" SUSPENDED LIGHT TO BE DEMOLISHED
 - 1'-0" LIGHT TO BE DEMOLISHED
 - BUILDING MOUNTED LIGHT TO BE DEMOLISHED
 - TRACK LIGHT TO BE DEMOLISHED
 - COOLER/FREEZER LIGHT TO BE DEMOLISHED
- GENERAL NOTES**
1. RAISE, LOWER AND OR RELOCATE PLUMBING, MECHANICAL, ELECTRICAL, REFRIGERATION AND FIRE SPRINKLER LINES AND EQUIPMENT AS REQUIRED FOR DEMOLITION AND NEW WORK. VERIFY IN FIELD. SEE PLUMBING, MECHANICAL, ELECTRICAL, REFRIGERATION, FIRE SPRINKLER AND STRUCTURAL DRAWINGS FOR ADDITIONAL INFORMATION AND DEMOLITION REQUIREMENTS.
 2. GENERAL CONTRACTOR TO PREP SURFACES FOR FINISHES. ALL MONEY SERVICES EXPOSED TO BE DEMOLISHED/SALVAGED AND BE RELOCATED AS DIRECTED BY KROGER INC.
 3. REFER TO AS1 SERIES FOR ARCHITECTURAL STANDARD DETAILS (ASD'S) AND GENERAL INSTALLATION DETAILS (GSD'S).
- KEYED NOTES**
1. EXISTING SUSPENDED ACOUSTICAL CEILING TILE AND TO BE DEMOLISHED.
 2. GRID EXISTING VINYL FACED CEILING TILE AND GRID TO BE DEMOLISHED.
 3. EXISTING METAL FACED CEILING TILE AND GRID TO BE DEMOLISHED.
 4. EXISTING GYPSUM BOARD CEILING TO BE DEMOLISHED.
 5. DEMOLISH ALL COMPONENTS OF EXISTING DROP PARTITION/SOFFIT.
 6. MODIFY HEIGHT OF DOOR OPENING IN PREPARATION FOR NEW DOOR AND FRAME.
 7. THE EXISTING SALES FLOOR STRUCTURE, DUCT WORK, CONDENSATE DRAIN, SPRINKLER LINES, ETC. ARE TO BE CLEANED AND PREPARED FOR PAINT.
 8. DEMOLISH ALL COMPONENTS OF EXISTING WOODEN PLATFORM ABOVE THE COOLER, RESTROOMS AND BREAKROOM.
 9. DEMOLISH ALL COMPONENTS OF EXISTING WOODEN PLATFORM ABOVE THE DELI COOLER.
 10. DEMOLISH ALL COMPONENTS OF EXISTING MEZZANINE, INCLUDING BUT NOT LIMITED TO SOFFIT PANELS, STRUCTURE, FRAMING, LIGHTING, GYPSUM BOARD, WALLS, ETC.
 11. DEMOLISH ALL COMPONENTS OF EXISTING EXTERIOR CANOPY, INCLUDING BUT NOT LIMITED TO SOFFIT PANELS, FRAMING, LIGHTING, GYPSUM BOARD, STRUCTURE, ETC.
 12. DEMOLISH ALL COMPONENTS OF EXISTING RETAIL BUILDING, INCLUDING BUT NOT LIMITED TO SOFFITS, WIRING, CEILING, LIGHTING, DUCT WORK, AIR DISTRIBUTION DEVICES, FRAMING, GYPSUM BOARD, ETC.
 13. THE REFRIGERATION CONTRACTOR IS TO DEMOLISH THE EXISTING COOLER/FREEZER IN THIS EXTERIORITY.
 14. THE REFRIGERATION CONTRACTOR IS TO DEMOLISH THE EXISTING REFRIGERATION COIL.
 15. EXISTING AIR DISTRIBUTION DEVICE IS TO REMAIN. RE: MECHANICAL DRAWINGS.
 16. EXISTING MECHANICAL DUCT WORK IS TO REMAIN. THE DUCT WORK IS TO BE CLEANED AND PREPARED FOR PAINT. RE: MECHANICAL DRAWINGS.
 17. THE REFRIGERATION CONTRACTOR IS TO DEMOLISH THE EXISTING PROTOCOL UNIT LOCATED ABOVE THE DELI COOLER CEILING ON A WOODEN PLATFORM.
 18. THE REFRIGERATION CONTRACTOR IS TO DEMOLISH THE EXISTING PROTOCOL UNIT LOCATED ABOVE THE BREAKROOM CEILING ON A WOODEN PLATFORM.
 19. EXISTING GAS FIRED UNIT HEATER TO REMAIN.
 20. DEMOLISH EXISTING MECHANICAL DUCT WORK. RE: MECHANICAL DRAWINGS.
 21. DEMOLISH EXISTING AIR DISTRIBUTION DEVICE. RE: MECHANICAL DRAWINGS.
 22. EXISTING GAS LINE TO REMAIN. RE: MECHANICAL DRAWINGS.
 23. EXISTING GAS LINE TO BE DEMOLISHED. RE: MECHANICAL DRAWINGS.
 24. EXISTING HOOD TO BE DEMOLISHED. RE: MECHANICAL DRAWINGS.
 25. EXISTING LIGHT FIXTURE TO REMAIN. RE: ELECTRICAL DRAWINGS.
 26. DEMOLISH EXISTING EXIT SIGN. RE: ELECTRICAL DRAWINGS.
 27. DEMOLISH EXISTING LIGHT FIXTURE. RE: ELECTRICAL DRAWINGS.
 28. EXISTING EXTERIOR WALL MOUNTED LIGHT TO BE DEMOLISHED. NEW LIGHT TO BE REINSTALLED IN THE SAME LOCATION. RE: ELECTRICAL DRAWINGS.
 29. THE REFRIGERATION CONTRACTOR IS TO DEMOLISH THE EXISTING PROTOCOL UNIT LOCATED ABOVE THE PRODUCE COOLER.

PARTIAL DEMOLITION
01 REFLECTED CEILING PLAN EAST
SCALE: 3/32" = 1'-0"

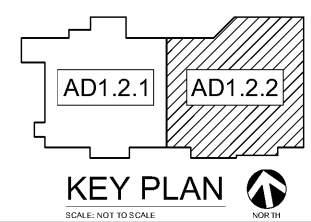

KROGER
STORE #473

2013 UNIVERSITY AVENUE
OXFORD, MISSISSIPPI 38655

A DEVELOPMENT OF:
THE KROGER COMPANY

naos
Naos Design Group Of Mississippi, PLLC.

MARC BREETZ, ARCHITECT

645 Lakeland East Drive
Suite 101
Flowood, Mississippi 39232
(p) 303.759.5777
(f) 720.360.4281

ARCHITECT OF RECORD

CDS
COMMERCIAL DESIGN SYSTEMS, INC.

13225 SW GALBREATH DRIVE
SHERWOOD, OREGON 97140
503.855.7000 (P)503.625.5002

INTERIOR DECOR

Pickering Firm, Inc.
Architectural - Engineering
Planning - Surveying

6775 Lenox Center Court Suite 300
Memphis, TN 38115
901.726.0810

ENGINEER OF RECORD:
STRUCTURAL
MECHANICAL
ELECTRICAL
CIVIL ENGINEER

V-SOFT
INFRASTRUCTURE

1500 CHESTER ROAD
CINCINNATI, OH 45216
T: 513-670-3069

LOW VOLTAGE

telgian
TELGIAN CORPORATION
10230 SOUTH 50TH PLACE
SUITE 100
PHOENIX, AZ 85044
T: (677) 836-4428
HTTP://WWW.TELGIAN.COM
FIRE PROTECTION

ISSUE LOG

NO.	REV.	DESCRIPTION	DATE
1	-	PERMIT SET	12/05/18
2	-	BID SET	03/21/19

JOB: 2018041 SCALE: 3/32" = 1'-0"

SHEET NO.

AD1.2.2
PARTIAL DEMOLITION
REFLECTED CEILING PLAN EAST

COPYRIGHT © 2018 KROGER DESIGN GROUP OF MISSISSIPPI, PLLC. THESE DRAWINGS OR PARTS THEREOF MAY NOT BE REPRODUCED IN ANY FORM, BY ANY METHOD, FOR ANY PURPOSE, WITHOUT THE WRITTEN CONSENT OF KROGER.