

FOUNDATION NOTES

- FOOTINGS HAVE BEEN DESIGNED FOR AN ALLOWABLE SOIL BEARING CAPACITY OF 2,500 PSF FOR ISOLATED FOOTINGS AND CONTINUOUS FOOTINGS. THIS CAPACITY IS BASED ON THE RECOMMENDATIONS OF THE GEOTECHNICAL REPORT BY TERRACON & ASSOCIATES, DATED SEPTEMBER 3, 2013. ALLOWABLE BEARING CAPACITY TO BE VERIFIED IN THE FIELD BY THE SOILS ENGINEER.
- REFER TO PLAN FOR FLOOR CONSTRUCTION.
- ELEVATIONS SHOWN ARE BASED ON EL. 100'-0" = USCS EL. 471.16' (MATCH EXISTING). REFER TO CIVIL DRAWINGS FOR MORE INFORMATION.
- TOP OF FOOTING ELEVATION IS AS SHOWN ON PLAN ON THIS SHEET.
- EXCAVATIONS ARE ASSUMED TO BE LAID BACK TO A 1.5H TO 1V SLOPE. IF REQUIRED, SHEETING OR SHORING TO BE INSTALLED TO MAINTAIN 1.5H TO 1V SLOPE. KEEP ALL EXCAVATIONS FREE OF WATER.
- SEE HVAC, PLUMBING & ARCHITECTURAL DRAWINGS FOR FLOOR SLOPES, DEPRESSIONS, HOUSEKEEPING PADS, ETC. VERIFY INFORMATION RELAY TO PLACING CONCRETE.
- SEE 06/S3.1 BASE, SITE AND ANCHOR BOLT INFORMATION.
- SEE SHEET S0.1 FOR STRUCTURAL NOTE.
- COORDINATE DIMENSIONS WITH THE ARCHITECTURAL DRAWINGS.
- CENTER ISOLATED FOOTINGS ON COLUMNS UNLESS NOTED OTHERWISE.

- CENTER CONTINUOUS FOOTINGS ON WALLS UNLESS NOTED OTHERWISE.
- REFER TO CMU WALL REINFORCING SCHEDULE ON SHEET S0.1 FOR WALL REINFORCEMENT.
- FOOTING LEGEND:

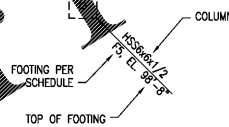

SLAB ON GRADE NOTES:

- ELEVATIONS SHOWN ARE TOP OF SLAB. THEY ARE BASED ON EL. 100'-0" = USCS EL. 471.16' (TO MATCH EXISTING).
- SAWCUTTING OPERATIONS MUST TAKE PLACE PRIOR TO THE BUILD-UP OF SHRINKAGE STRESS IN THE CONCRETE PER ACI REQUIREMENTS AND GUIDELINES. SAWCUTTING MUST OCCUR WITHIN 12.0 HOURS AFTER THE CONCRETE IS PLACED WITHOUT RAVELING CONCRETE. SCHEDULE POUR AT APPROPRIATE TIME OF DAY TO ACHIEVE THIS REQUIREMENT AND PROVIDE ALL THAT IS NECESSARY (i.e. LIGHTS, ACCESS, ETC.) TO ENSURE IT IS DONE PROPERLY. REFER TO SPECIFICATIONS.
- REFER TO SHEET S0.1 FOR STRUCTURAL NOTES.
- PER GEOTECHNICAL REPORT REFERENCED ON SHEET S1.1 SITE PREPARATION SHALL INCLUDE:
 - CUT AND FILL WITH SELECT FILL PER THE RECOMMENDATIONS OF THE GEOTECHNICAL REPORT.
 - ENSURE THAT SITE IS PROTECTED FROM MOISTURE DURING SITE PREPARATION.
- LOCATE EXISTING AND NEW UTILITIES AND TRENCHES BEFORE PLACING SLAB.
- SEE ARCHITECTURAL DRAWINGS AD1.1.3, AD1.1.4, A1.2.1, AND A1.2.2 FOR FLOOR SLOPES, DEPRESSIONS, AND PLUMBING TRENCH LOCATIONS.
- SEE 16/S3.1 FOR SLAB REPLACEMENT DETAIL. COORDINATE LOCATIONS WITH AD1.1.3, AD1.1.4, A1.2.1, AND A1.2.2 ALONG WITH ASD-89 ON A5.1.3
- MAXIMUM CONTROL JOINT SPACING SHALL BE 12'-0" UNO, SEE A1.2.1 AND A1.2.2 FOR LOCATIONS AND DIMENSIONS.
- MAXIMUM SLAB POUR SHALL BE 120 LINEAR FEET.
 - POUR SHALL HAVE A LENGTH TO WIDTH RATIO NO GREATER THAN 2 TO 1.

FOOTING SCHEDULE			
MARK	SIZE	REINFORCEMENT	REMARKS
W36	CONT. 3'-0"x16" THICK	4 #5 CONT.	
F4	4'-0"x4'-0"x16" THICK	5 #5 E.W. BOT.	
F6.5	6'-5"x6'-5"x16" THICK	7 #5 E.W. BOT.	

REINFORCING BARS ARE EQUALLY SPACED, UNO

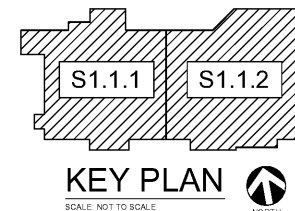

01 OVERALL FOUNDATION PLAN

SCALE: 1/16" = 1'-0"



Kroger
 KROGER
 STORE #473
 2013 UNIVERSITY AVENUE
 OXFORD, MISSISSIPPI 38655
 A DEVELOPMENT OF THE KROGER COMPANY

naos
 Naos Design Group Of Mississippi, PLLC.
 MARC BREETZ, ARCHITECT
 645 Lakeland East Drive Suite 101
 Flowood, Mississippi 39232
 (p) 303.759.5777 (f) 720.360.4281
 ARCHITECT OF RECORD

CDS
 COMMERCIAL DESIGN SYSTEMS, INC.
 13825 SW GALBREATH DRIVE
 SHERWOOD, OREGON 97140
 503.855.7000 (p) 503.855.8902
 INTERIOR DECOR

Pickering
 Pickering Firm, Inc.
 Architecture - Engineering
 Planning - Surveying
 6775 Lenox Center Court, Suite 300
 Memphis, TN 38115
 901.726.8810
 ENGINEER OF RECORD:
 STRUCTURAL
 MECHANICAL
 ELECTRICAL
 CIVIL ENGINEER

V-SOFT
 INFRASTRUCTURE
 11280 CHESTER ROAD
 CINCINNATI, OH 45248
 T: 513-990-3810
 LOW VOLTAGE

telgian
 TELGIAN CORPORATION
 10230 SOUTH 50TH PLACE
 SUITE 100
 PHOENIX, AZ 85044
 T: (602) 938-4426
 HTTP://WWW.TELGIAN.COM
 FIRE PROTECTION

ISSUE LOG

NO.	REV.	DESCRIPTION	DATE
1	-	PERMIT SET	12/05/18
2	-	BID SET	03/21/19

JOB: 2018041 SCALE: AS SHOWN

SHEET NO.

S1.1.0
 OVERALL FOUNDATION PLAN

COPYRIGHT © 2018 NAOS DESIGN GROUP OF MISSISSIPPI, PLLC. THESE DRAWINGS OR PARTS THEREOF MAY NOT BE REPRODUCED, COPIED, EITHER WHOLLY OR IN PART, FOR ANY PURPOSE, WITHOUT PRIOR WRITTEN CONSENT FROM NAOS.