

**SEQUENCING**

- PHASE 1:  
 DEMO AND REMOVE RETAIL BUILDING  
 CONSTRUCT EXPANSION  
 CONSTRUCT PICKUP
- PHASE 2:  
 DEMO MEZZANINE, PRODUCE, ENTRY, PICKUP,  
 CUSTOMER SERVICE, ECR  
 CONSTRUCT NEW ENTRY, COLLEGE AREA, CHECKLANES
- PHASE 3:  
 DEMO PRODUCE PREP AND COOLER, DELI, BAKERY,  
 CHEESE ISLAND, SUSHI ISLAND  
 NEW MEAT CASES AND GONDOLA SHELVING
- PHASE 4:  
 DEMO FREEZER, DAIRY COOLER, BREAK ROOM,  
 EMPLOYEE RESTROOMS, DAIRY CASES, RECEIVING AREA  
 NEW GROCERY FREEZER, DAIRY COOLER, CLEANING  
 CENTER AND RECEIVING AREA
- PHASE 5:  
 DEMO FROZEN DOORS, GONDOLA SHELVING  
 NEW FROZEN DOORS, DAIRY CASES AND GONDOLA  
 SHELVING
- PHASE 6:  
 TEMPORARY PHARMACY, SEE DETAIL 0101.3  
 DEMO SECOND ENTRY, PHARMACY AND PHARMACY  
 DRIVE THRU  
 NEW PHARMACY, PHARMACY DRIVE THRU,  
 CONSULTATION ROOMS, FAMILY RESTROOMS, SECURITY  
 AND COLLEGE AREA
- PHASE A:  
 REMEDIATION ELECTRICAL ROOM, SITE WORK AND  
 EXTERIOR WILL BE GOING THROUGH OUT THE DURATION  
 OF THE PROJECT.

LEGEND, SYMBOLS AND NOTES APPLY TO G1.2.1, G1.2.2, G1.2.3  
 AND G1.2.4 SHEETS. SOME ITEMS MAY NOT APPEAR ON THIS  
 SHEET.

**SYMBOL LEGEND**

- SEQUENCING AREA BOUNDARY
- P4** SEQUENCING AREA DESIGNATION - THE PHASE  
 NUMBERS ONLY INDICATE THE SEQUENCING  
 AREA AND DO NOT INDICATE THE ORDER OF  
 CONSTRUCTION.
- TEMPORARY SET DESIGNATION

**GENERAL NOTES**

1. SCHEDULING IS CRITICAL TO THE SUCCESS OF THIS PROJECT. THE GENERAL CONTRACTOR WILL BE REQUIRED TO PROVIDE A DETAILED JOB SCHEDULE BEFORE CONSTRUCTION BEGINS IDENTIFYING ALL CONSTRUCTION ACTIVITIES IN EACH PHASE OF WORK AND THE CRITICAL PATH. THIS SCHEDULE WILL BE MADE TO MEET THE CONSTRUCTION TIME FRAME AS OUTLINED IN THE BID AND CONSTRUCTION DOCUMENTS. THE GENERAL CONTRACTOR WILL PROVIDE A LIST OF DELIVERABLES FOR KROGER SUPPLIED EQUIPMENT AND FIXTURES. IN ADDITION TO THE OVERALL JOB SCHEDULE, THE GENERAL CONTRACTOR WILL PREPARE DETAILED WEEKLY WEEK-RUNNING SCHEDULES FOR EACH DAY'S CONSTRUCTION ACTIVITIES. THE GENERAL CONTRACTOR'S ACTIVITIES AND DATES SHALL BE IN ACCORDANCE FROM THE STORE TO AVOID PRODUCT NEEDS.
2. THIS SCHEDULE IS PLANNED TO CONVEY HOW THE CONSTRUCTION WORK IS TO BE PERFORMED AND TO MAINTAIN AN OPERATING STORE OPEN TO ALL DEPARTMENTS IN CONSTRUCTION OUR CUSTOMERS HAVE COME TO EXPECT. THE INTENTION IS TO LEAVE UP AS LITTLE OF THE STORE AS POSSIBLE. WHEREAS POSSIBLE, WORK CAN BE PERFORMED OUT OF PHASE IF THE WORK DOES NOT INTERFERE WITH THE STORE'S OPERATION OR NEGATIVELY AFFECT THE CONSTRUCTION SCHEDULE. KEEPING THE STORE AND DEPARTMENTS OPERATING WILL TAKE PRECEDENCE IN ALL CASES. UNDER NO CIRCUMSTANCES WILL MORE THAN ONE SECTING DEPARTMENT BE EFFECTED AT ANY ONE TIME UNLESS PRIOR APPROVAL IS GRANTED FROM THE KROGER PROJECT MANAGER. IT IS REQUIRED THAT ALL CONTRACTORS ADEQUATELY STAFF THIS PROJECT AND/OR WORK THE NECESSARY NUMBER OF SHIFTS TO MEET THE COMPLETION DATES FOR EACH AREA INDICATED ON THIS PLAN. COMPLETION DATES CANNOT AND WILL NOT BE MOVED BACK. SEQUENCING AREA DESIGNATION IS FOR REFERENCE ONLY. THE FINAL SEQUENCING SCHEDULE IS THE RESPONSIBILITY OF THE GENERAL CONTRACTOR AND THE KROGER PROJECT MANAGER.
3. THE TYPICAL WORK WEEK WILL BE 10-HOUR DAYS, MONDAY - FRIDAY, HOLIDAY WEEKS (I.E. EASTER, MEMORIAL DAY, INDEPENDENCE DAY, LABOR DAY, THANKSGIVING, CHRISTMAS) WILL REQUIRE ADJUSTMENTS TO WORK SCHEDULES IN ORDER TO MINIMIZE DISRUPTIONS TO STORE SALES. DOUBLE SHIFTS MAY BE REQUIRED DURING MOST PHASES OF THE WORK.
4. NIGHT WORK (10:00 PM - 7:00 AM) WILL BE REQUIRED WHEN THE CONSTRUCTION WORK CREATES EXCESSIVE DUST AND DEBRIS, NOXIOUS FUMES, LOUD NOISE OR INTERFERES WITH THE SHIPPING ENVIRONMENT OF OUR CUSTOMERS OR THE OPERATION OF THE STORE OR WHEN DICTATED BY THE CONSTRUCTION SCHEDULE. EXCEPTIONS AND VARIATIONS TO THIS REQUIREMENT WILL BE ALLOWED ON PROJECTS SUBJECT TO CURFEW OR NIGHT NOISE RESTRICTIONS.
5. ACCESS TO THE BUILDING DURING NIGHTTIME HOURS WILL BE RESTRICTED AND CONTROLLED TO PROTECT PROPERTY AND PRODUCT LOSS. KROGER MAY ELECT, AT ITS OWN COST, TO EMPLOY SECURITY GUARDS DURING NIGHTTIME HOURS TO MONITOR TRAFFIC IN AND OUT OF THE BUILDING.
6. THE STORE'S TELEPHONE, REFRIGERATION, COMPUTER SYSTEMS AND CHECK LANES MUST REMAIN OPERATING THROUGHOUT THIS PROJECT. THIS MAY REQUIRE TEMPORARY CABLES AND WIRING.
7. THE BUILDING MUST REMAIN WATER TIGHT THROUGHOUT THE CONSTRUCTION PROCESS. THE GENERAL CONTRACTOR WILL BE HELD LIABLE FOR PRODUCT DAMAGE CAUSED BY CONSTRUCTION ROOF LEAKS OR WATER SEEPAGE. IN ADDITION, THE GENERAL CONTRACTOR MUST MAINTAIN THE STORE BUILDING ENVELOPE IN A MANNER TO KEEP THE NEEDS OF THE STORE AND DEPARTMENTS AT NORMAL TEMPERATURES THROUGHOUT THIS PROJECT.
8. ALL CONSTRUCTION AREAS WILL HAVE ALL DEBRIS REMOVED FROM THE FLOORS AND THE FLOOR BROOM SWEEP DAILY. CONSTRUCTION SPOILS AND DEMO DEBRIS ARE TO BE REMOVED FROM THE BUILDING EACH DAY AND STORED IN DUMPSTERS UNTIL THE DUMPSTER IS FULL AND HAULED OFF-SITE.
9. MAINTAIN EXISTING WALL DECOR, EXCEPT IN DEPARTMENTS THAT ARE UNDERWAY. AS CLOSE TO THE END OF CONSTRUCTION AS POSSIBLE, NEW SOFFITS AND WALLS ARE TO BE DRYWALLED, TAPED AND PAINTED AS SOON AS POSSIBLE AFTER INSTALLATION.
10. GENERAL CONTRACTOR IS RESPONSIBLE FOR COORDINATING THE WORK OF ALL CONSTRUCTION TRADES, INCLUDING THOSE TRADES CONTRACTED DIRECTLY WITH KROGER WITH THE BUILDING CONSTRUCTION WORK AND THE SEQUENCING PLAN. EXAMPLES INCLUDE: REFRIGERATION CONTRACTORS AND FIXTURE CONTRACTOR.
11. GENERAL CONTRACTOR WILL COORDINATE AND PROVIDE SUPERVISION WHEN ANY WORK IS TAKING PLACE IN THE STORE. THIS WILL INCLUDE NIGHT AND WEEK END WORK WHEN APPLICABLE.
12. ALL CONTRACTORS WILL BE REQUIRED TO ATTEND WEEKLY SCHEDULED PROGRESS AND COORDINATION MEETINGS TO STAY CURRENT WITH THE SCHEDULE AND SCHEDULE CHANGES. EACH CONTRACTOR MUST SUPPLY TO THESE MEETINGS A PERSON CAPABLE OF MAKING COMMITMENTS AND DECISIONS FOR THEIR RESPECTED COMPANIES. THESE MEETINGS ARE IMPORTANT AND ATTENDANCE IS MANDATORY.
13. ALL CONTRACTORS (BUILDING AND FIXTURE) WILL BE REQUIRED TO CAREFULLY EXAMINE THIS SEQUENCING PLAN AND THE CONSTRUCTION PLANS. TEMPORARY POWER CIRCUITS, COMMUNICATIONS CABLEING, REFRIGERANT PIPING, DRAIN LINE TIE-INS AND WATER LINES WILL BE REQUIRED THROUGHOUT THE PROJECT TO ENSURE ALL DEPARTMENTS IN THE STORE REMAIN OPERABLE.
14. REFER TO SUPPLEMENTAL BARRICADE PLANS PROVIDED BY KROGER PROJECT MANAGER.
15. THE FIXTURE CONTRACTOR WILL MOVE THE STORE FIXTURES, CHECK STAIRS AND LIFTS AND MAKE FOR FLOORING CHANGES, TEMPORARY SETS AND FINAL SET.

Order Plans @ WWW.LDILine.com

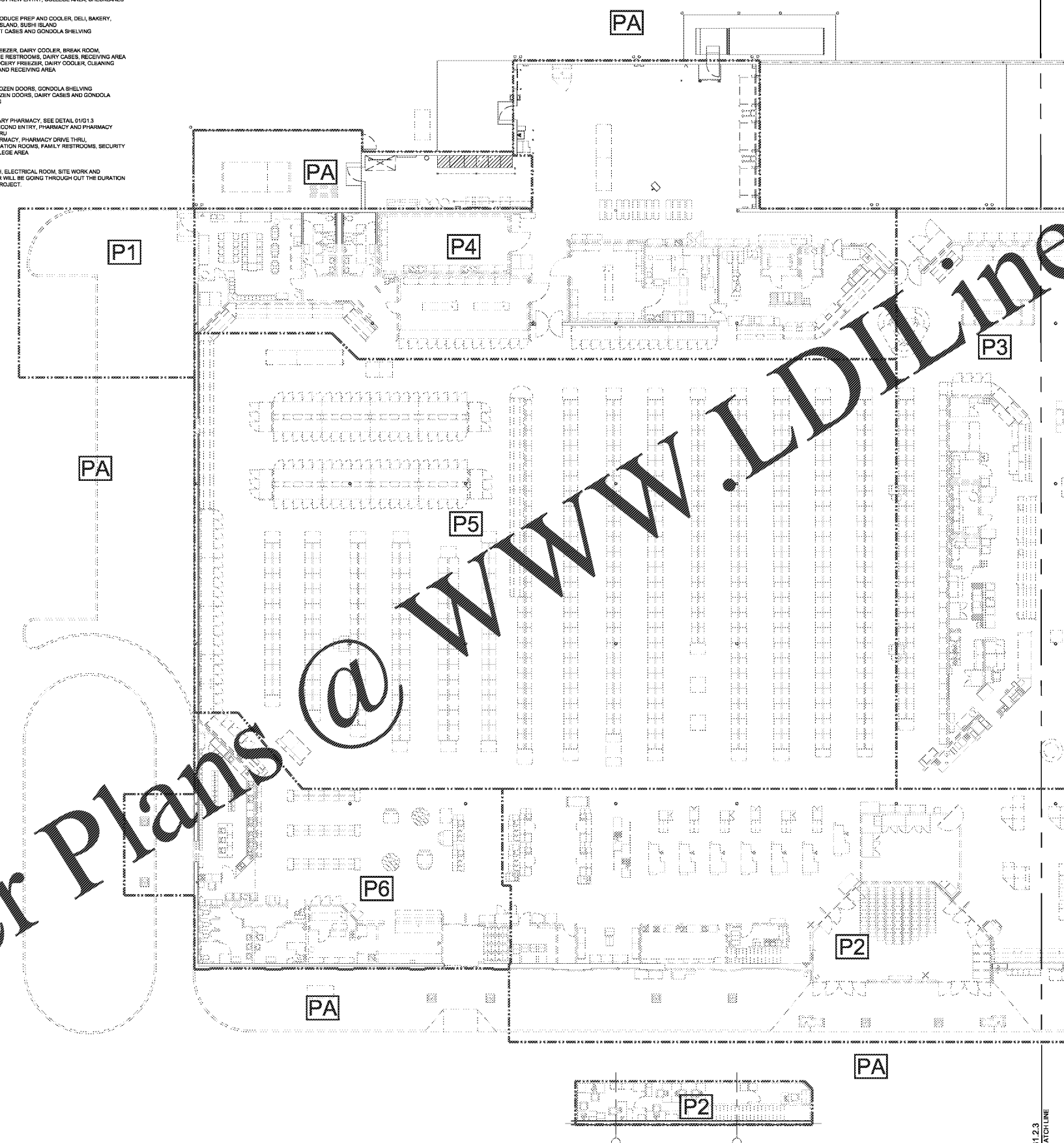

**PARTIAL DEMOLITION  
 01 SEQUENCING PLAN WEST**

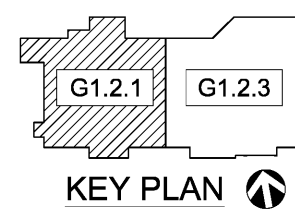

**Kroger**  
**KROGER**  
**STORE #473**  
 2013 UNIVERSITY AVENUE  
 OXFORD, MISSISSIPPI 38655  
 A DEVELOPMENT OF THE KROGER COMPANY

**naos**  
 Naos Design Group Of Mississippi, PLLC.  
 MARC BREETZ, ARCHITECT  
 645 Lake and East Drive, Suite 101  
 Flowood, Mississippi 39232  
 (p) 303.759.5777  
 (f) 720.360.4281  
**ARCHITECT OF RECORD**

**CDS**  
**COMMERCIAL DESIGN SYSTEMS, INC.**  
 13825 SW GALBREATH DRIVE  
 SHERWOOD, OREGON 97140  
 503.885.7900 (P) 503.825.8802  
**INTERIOR DECOR**

**Pickering Firm, Inc.**  
 Architecture - Engineering  
 Planning - Surveying  
 8775 Lenox Center Court, Suite 300  
 Memphis, TN 38115  
 901.726.9919  
**ENGINEER OF RECORD:  
 STRUCTURAL  
 MECHANICAL  
 ELECTRICAL  
 CIVIL ENGINEER**

**AV-SOFT**  
**INFRASTRUCTURE**  
 1620 CHESTER ROAD  
 CINCINNATI, OH 45216  
 T: 513-690-3089  
**LOW VOLTAGE**

**telgian**  
**TELGIAN CORPORATION**  
 10230 SOUTH 50TH PLACE  
 SUITE 100  
 PHOENIX, AZ 85044  
 T: (677) 836-4428  
 HTTP://WWW.TELGIAN.COM  
**FIRE PROTECTION**

**ISSUE LOG**

NO.	REV.	DESCRIPTION	DATE
1	-	PERMIT SET	12/06/18
2	-	BID SET	03/21/19

JOB:	SCALE:
2018041	3/32" = 1'-0"
SHEET NO.	

**G1.2.1**  
 PARTIAL DEMOLITION  
 SEQUENCING PLAN WEST  
COPYRIGHT © 2018 NAOS DESIGN GROUP OF MISSISSIPPI, PLLC. THESE DRAWINGS OR PARTS THEREOF MAY NOT BE REPRODUCED IN ANY FORM, BY ANY METHOD, FOR ANY PURPOSE, WITHOUT PRIOR WRITTEN CONSENT FROM NAOS.