

Order Plans @ www.LDILLinc.com

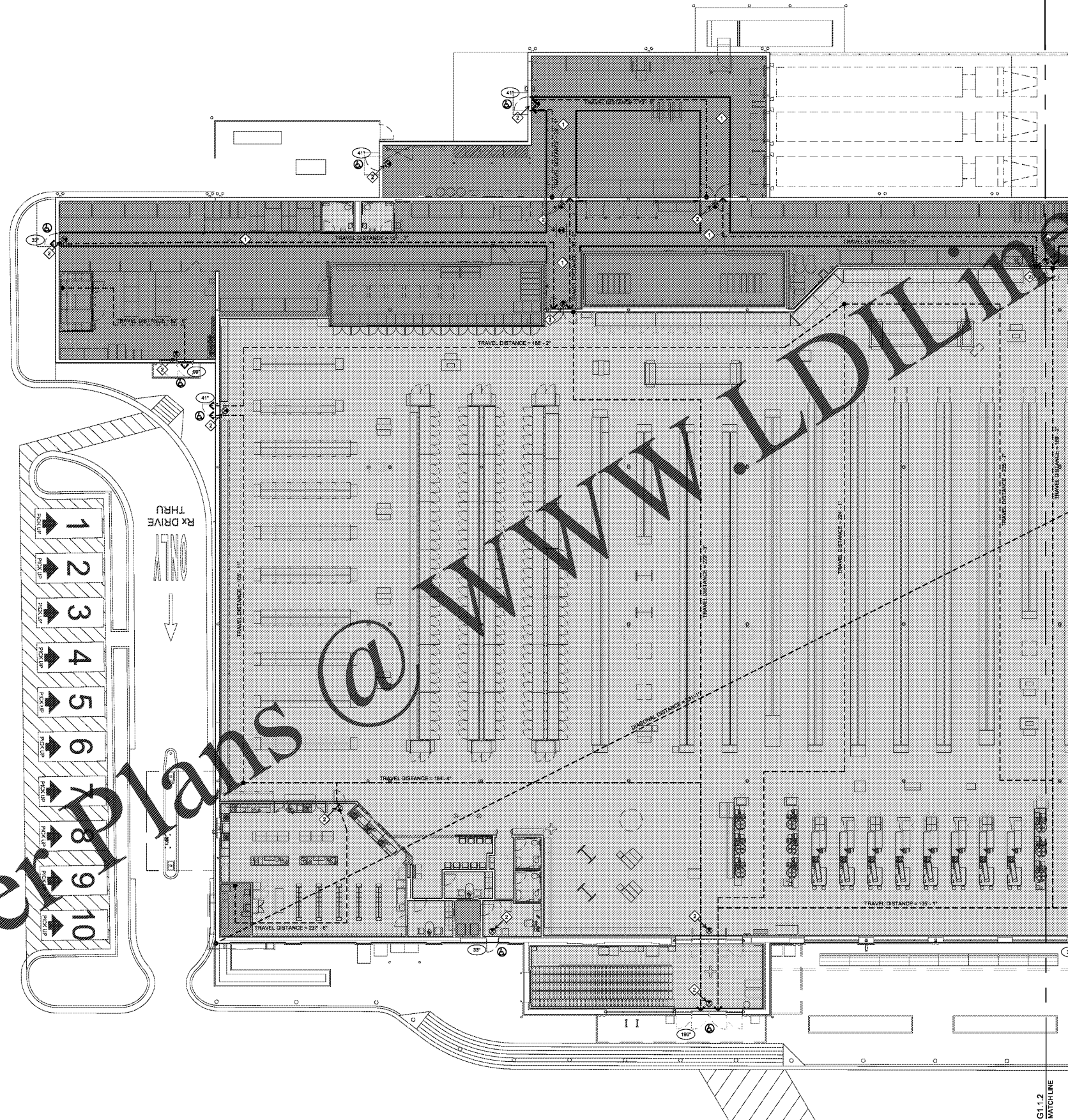

- LEGEND: SYMBOLS AND NOTES APPLY TO BOTH G1.1.1 AND G1.1.2 SHEETS SOME ITEMS MAY NOT APPEAR ON THIS SHEET
- OCCUPANCY LEGEND**
- AREAS ON OTHER FLOORS
 - BASEMENT & GRADE FLOOR AREAS (M)
 - STORAGE, STOCK AND SHIPPING (S-2)
 - BUSINESS (B)
 - UN-CONCENTRATED ASSEMBLY (A-3)
- SYMBOL LEGEND**
- INDICATED ADJUSTED EXIT DOOR WIDTH IN INCHES
 - EXIT SEPARATION/DIAGONAL DISTANCE/EGRESS PATH
 - START OF AN EGRESS PATH
 - DIRECTION OF EGRESS PATH
 - INDICATES ACCESSIBLE EGRESS PATH
 - PHOTOLUMINESCENT EXIT SIGN INDICATOR
 - CLEAR EXIT WITH PAINTED FLOOR

- GENERAL NOTES**
- ALL EXITING EXITS ARE TO REMAIN OPEN AND UNLOCKED DURING ALL CONSTRUCTION UNLESS THE DOOR IS TO BE DEMOLISHED. IF THE DOOR IS SCHEDULED FOR DEMOLITION IT IS TO REMAIN OPEN UNTIL THE DEMOLITION IS COMPLETE.
 - IF AN EXIT MUST BE CLOSED, A MEETING WITH THE FIRE MARSHAL AND BUILDING INSPECTOR MUST BE SCHEDULED AT LEAST TWO WEEKS PRIOR TO THE SHUT DOWN OF ANY EXIT. THE MEETING IS TO DISCUSS THE CONSTRUCTION SCHEDULE AS IT RELATES TO THE CLOSING OF ANY EXIT AND THE TEMPORARY EXITING STRATEGY IN THE AREAS AROUND THE CLOSED EXIT.
 - FIRE SPRINKLER AND FIRE ALARM SHUT DOWN SHALL OCCUR ONLY WITH FIRE DEPARTMENT APPROVAL. APPROVAL MUST BE RECEIVED AT LEAST TWO WEEKS PRIOR TO THE SHUT DOWN.
 - THE FIXTURE CONTRACTOR WILL MOVE THE STORE FIXTURES, CHECK STANDS AND U-SCANS FOR FLOOR POLISHING, TEMPORARY SETS AND FINAL SET.
 - PROVIDE A MINIMUM OF THIRTY (30) FIRE EXTINGUISHERS WITH CURRENT CERTIFICATION TAGS. PROVIDE FIRE EXTINGUISHER SIGNS AT EACH LOCATION. COORDINATE THE LOCATION AND TYPE OF EXTINGUISHERS WITH THE FIXTURE PLAN, ON SHEET 11, THE PROJECT MANAGER AND THE AUTHORITY HAVING JURISDICTION. MOUNT THE EXTINGUISHERS PER CODE REQUIREMENTS. THE FIRE EXTINGUISHER SHALL HAVE A MINIMUM RATING OF 2-A AND SHALL BE LOCATED IN READILY ACCESSIBLE LOCATIONS WITH A MAXIMUM TRAVEL DISTANCE OF 75'.
- KEYED NOTES**
- PAIN A 3" WIDE STRIPE, SAFETY YELLOW (PT-716), ON FLOOR, 44" CLEAR PATH TYPICAL. PAINT THE WORDS "FIRE LANE" EVERY 20'-0" ALONG THE CENTER OF THE PATH.
 - NEW PHOTOLUMINESCENT EXIT SIGN, SUPPLIED AND INSTALLED BY GENERAL CONTRACTOR. ALL EXIT SIGNS ARE TO BE REPLACED WITH PHOTOLUMINESCENT EXIT SIGNS, NOTED OR OTHERWISE.

KROGER
STORE #473

2013 UNIVERSITY AVENUE
OXFORD, MISSISSIPPI 38655

A DEVELOPMENT OF
THE KROGER COMPANY

naos
Naos Design Group Of Mississippi, PLLC.

MARC BREETZ, ARCHITECT

645 Lake and East Drive Suite 101
Flowood, Mississippi 39232
(p) 303.759.5777
(f) 720.360.4281

ARCHITECT OF RECORD

CDS
COMMERCIAL DESIGN SYSTEMS, INC.

13825 SW GALBREATH DRIVE
SHERWOOD, OREGON 97140
503.885.7900 (P) 503.825.8822

INTERIOR DESIGNER

Pickering Firm, Inc.
Architecture - Engineering
Planning - Surveying

8775 Lenox Center Court, Suite 300
Memphis, TN 38115
901.726.9819

ENGINEER OF RECORD:
STRUCTURAL
MECHANICAL
ELECTRICAL
CIVIL ENGINEER

iVSOFT
INFRASTRUCTURE

1820 CHESTER ROAD
CINCINNATI, OH 45216
T: 513-690-3069

LOW VOLTAGE

telgian
TELGIAN CORPORATION
10230 SOUTH 50TH PLACE
SUITE 100
PHOENIX, AZ 85044
T: (477) 535-4426
HTTP://WWW.TELGIAN.COM
FIRE PROTECTION

ISSUE LOG

NO.	REV.	DESCRIPTION	DATE
1	-	PERMIT SET	12/05/18
2	-	BID SET	03/21/19

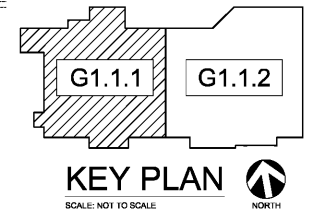

**PARTIAL EMERGENCY
01 EXITING PLAN WEST**

SCALE: 3/32" = 1'-0"

JOB: 2018041 SCALE: 3/32" = 1'-0"

SHEET NO.

G1.1.1
PARTIAL EMERGENCY
EXITING PLAN WEST

COPYRIGHT © 2018 NAOS DESIGN GROUP OF MISSISSIPPI, PLLC. THESE DRAWINGS, OR PARTS THEREOF, ARE NOT TO BE REPRODUCED IN ANY FORM, BY ANY MEANS, WITHOUT THE WRITTEN CONSENT FROM NAOS.