

EROSION AND SEDIMENT CONTROL LEGEND			
CODE	PRACTICE	DETAIL	MAP S. M. OL.
FIP	FABRIC DROP INLET PROTECTION		
M	MULCHING		
PS	PERMANENT VEGETATION		
SOD	SODDING		
	LIMITS OF DISTURBANCE	N/A	
	SEDIMENT BARRIER		

SOIL TYPE	
	MARLY LOAM SAND, 1 TO 10 PERCENT SLOPES

SITE DATA	
TOTAL SITE AREA	0 AC
TOTAL DISTURBED AREA	0 AC

Order Plans

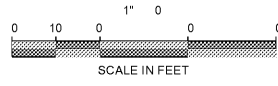
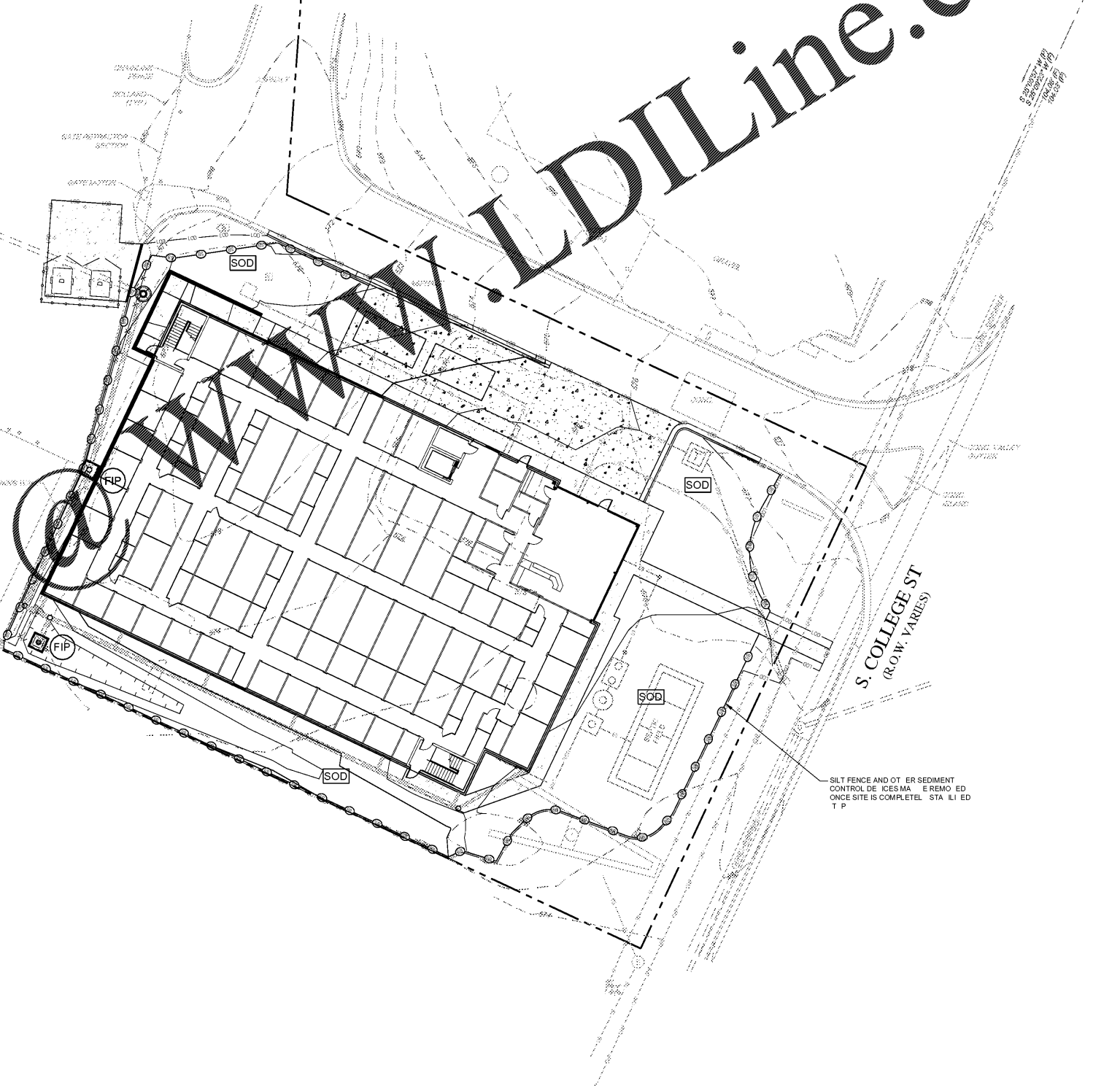

ENGINEER:  
**FORESITE**  
 group  
 Foresite Group, Inc.  
 2128 Moores Mill Rd.  
 Suite C  
 Auburn, AL 36830  
 o | 334.887.6064  
 f | 334.887.6024  
 w | www.fg-inc.net

DEVELOPER:  
 LIFE STORAGE  
 6467 MAIN STREET  
 WILLIAMSVILLE, NY 14221  
 CONTACT: ROBERT FISHER

PROJECT:  
**LIFE STORAGE 354 EXPANSION**  
 2020 S COLLEGE ST  
 AUBURN, LEE COUNTY, AL 36832  
 SECTION 12, TOWNSHIP 18 N, RANGE 25 E

SEAL:

REVISIONS	DATE
PERMIT SET	03/20/2019

PROJECT MANAGER: SWT  
 DRAWING BY: ZLR  
 JURISDICTION: LEE COUNTY, AL  
 DATE: 12/21/2018  
 SCALE: 1" = 20'  
 TITLE:

FINAL EROSION & SEDIMENT CONTROL PLAN  
 SHEET NUMBER:  
**C-4.2**  
 COMMENTS: NOT RELEASED FOR CONSTRUCTION  
 JOB/FILE NUMBER: 1208.001