

GENERAL NOTES

1 ALL PROPOSED DIMENSIONS SET TO S O T E GEOMETRIC LA O T O F T E PROPOSED PARKING LOT ARE S O N A T T E FACE O F C R ALL PROPOSED DIMENSIONS SET TO S O T E GEOMETRIC LA O T O F T E PROPOSED BUILDING LOCATION ARE G I EN A T T E O T SIDE FACE O F T E BUILDING CORNERS ALL C R RADI ARE G I EN A T T E FACE O F C R

CONTRACTOR SHALL NOTIFY ENGINEER OF ANY DISCREPANCIES BETWEEN EXISTING CONDITIONS IN THE FIELD AND THE RESUBMITTED PLANS BEFORE PROCEEDING WITH ANY CONSTRUCTION

CONTRACTOR IS RESPONSIBLE FOR CORRECT ORIGINAL AND VERTICAL ALIGNMENT OF ALL TIES BETWEEN PROPOSED AND EXISTING PAVEMENTS, CURBS AND GUTTERS, SIDE WALKS, ALLEYS, AND UTILITIES

SITE NOTES

1 TRACT IS ZONED N A JURISDICTION OF LEE COUNTY

SEE ARCHITECTURAL PLANS FOR BUILDING FLOOR PLAN DIMENSIONS, DOOR LOCATIONS, SITE LIGHTING PLAN, AND OTHER ARCHITECTURAL DETAILS

NO CERTIFICATE OF OCCUPANCY WILL BE ISSUED UNTIL ALL SITE IMPROVEMENTS HAVE BEEN COMPLETED ON THE SITE

IF INTENSIVE LIGHTING FACILITIES ARE SO ARRANGED THAT EXPOSURE OF AN LIGHT IS CONCEALED FROM THE PUBLIC AND DOES NOT INTERFERE WITH TRAFFIC SEE PHOTO METRICS PLAN IN ARCH PLANS

ALL TREES, TREE SAVES AREAS, AND INDISTURBED AREAS SHALL BE CLEARLY IDENTIFIED FLAGGING AND OR FENCING PRIOR TO COMMENCEMENT OF ANY LAND DISTURBANCE

NO OUTSIDE STORAGE IS PROPOSED THAT INCLUDES PILES, ETC., EXCEPT FOR PRODUCTION, STORAGE, ETC.

SIGN LOCATION, NUMBER, AND SIZE ARE NOT APPROVED UNLESS THE DEVELOPER OBTAINS A SEPARATE PERMIT ISSUED FOR ON-SITE SIGNAGE

ALL CONSTRUCTION RELATED PERMITS DURING CONSTRUCTION PHASE OF THIS PROJECT ARE THE RESPONSIBILITY OF THE OWNER, OWNER'S CONTRACTOR, DEVELOPER, AND DO NOT PERMITTING AGENT AUTHORITY

CONSTRUCTION TRAILERS ARE TO BE PERMITTED TO STOP BY THE ENGINEERING DEPARTMENT

10 ALL EROSION, SEDIMENT CONTROL AND TREE PROTECTION MEASURES SHALL BE INSTALLED PRIOR TO ANY GRADING

11 ALL PAVEMENT MARKING IN LEE COUNTY RIGHT OF WAY SHALL BE ERMOPLASTIC AND ACCORDING TO STATE OR LEE COUNTY SPECIFICATIONS

1 MAINTENANCE FILL SLOPE 1:1

1 CONTACT RETENTION IN P.E.

1 IN ALL AREAS OF FILL OR OTHER USE DISTURBANCE OF EXISTING CONDITIONS, UNLESS OTHERWISE NOTED, THE CONTRACTOR SHALL COMPLETELY REMOVE AND LEGALLY DISPOSE OFF-SITE ALL PLANT MATERIALS, INCLUDING BUT NOT LIMITED TO ROOTS, STEMS, CONCRETE, REINFORCED CONCRETE, ASPHALT, DEBRIS, UNDERLAYS, TOPSOIL, AND OTHER DEBRIS MATERIALS. THE GRADE TO REMAIN SHALL BE COMPACTED TO STANDARD PROCTOR MAXIMUM DENSITY FOLLOWING FLL REMOVAL OF THESE MATERIALS

1 ALL SURFACE PREP AND AREAS OF THE SITE TO RECEIVE FILL SHALL BE COMPLETED IN STRICT CONFORMANCE WITH THE RECOMMENDATIONS IN THE REPORT BY THE PROJECT GEOTECHNICAL ENGINEER PROFESSIONAL SERVICES, INC. DATED OCTOBER 10, 2017. THE CONTRACTOR SHALL ADVISE THE REPORT ON THE SITE FOR REFERENCE AT ALL TIMES. THE CONTRACTOR SHALL PROVIDE EARLY OPERATIONS AND CONSTRUCTION PHASE MONITORING TO ENSURE THAT ALL COMPACTION IS COMPLETED IN ACCORDANCE WITH THE GEOTECHNICAL REPORT. THE CONTRACTOR SHALL PROVIDE TESTING REPORTS TO THE OWNER REGARDING COMPACTION TESTING PER THE TESTING PROTOCOL IN THE GEOTECHNICAL REPORT

1 CONTRACTOR SHALL BE RESPONSIBLE FOR CONSTRUCTION AND MAINTENANCE OF EROSION AND SEDIMENTATION CONTROLS DURING CONSTRUCTION FOR PROTECTION OF ADJACENT ROADWAYS

17 IN HEAVY DUTY PAVEMENT AREAS G.A.B. SHALL EXTEND UNDER THE GUTTER TO PROVIDE ADDITIONAL STABILITY FOR TRUCK TRAVEL

LEGEND

	CONCRETE SIDEWALK PAVING
	CONCRETE PAVING
	PROPOSED FENCE
	PROPERTY LINE
	PARKING CONTOUR
	TRAFFIC SIGN

SITE DATA

PROJECT	CLIMATE CONTROLLED SELF STORAGE FACILITY
ZONING	N A JURISDICTION OF LEE COUNTY
TOTAL DEVELOPMENT SITE AREA	0 AC
DISTURBED AREA	0 AC
PERMITTED SURFACE AREA	0 AC
IMPERVIOUS SURFACE AREA	0 AC
IMPERVIOUS SURFACE RATIO	0 AC
TOTAL FLOOR AREA	32,000 SF
PARKING RATIO REQUIRED	N/A
PARKING REQUIRED	SPACES
PARKING PROVIDED	SPACES
ACCESSIBLE PARKING REQUIRED	1 SPACES WITH 1 ACCESSIBLE
ACCESSIBLE PARKING PROVIDED	1 SPACES WITH 1 ACCESSIBLE

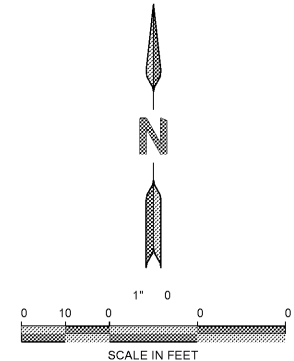
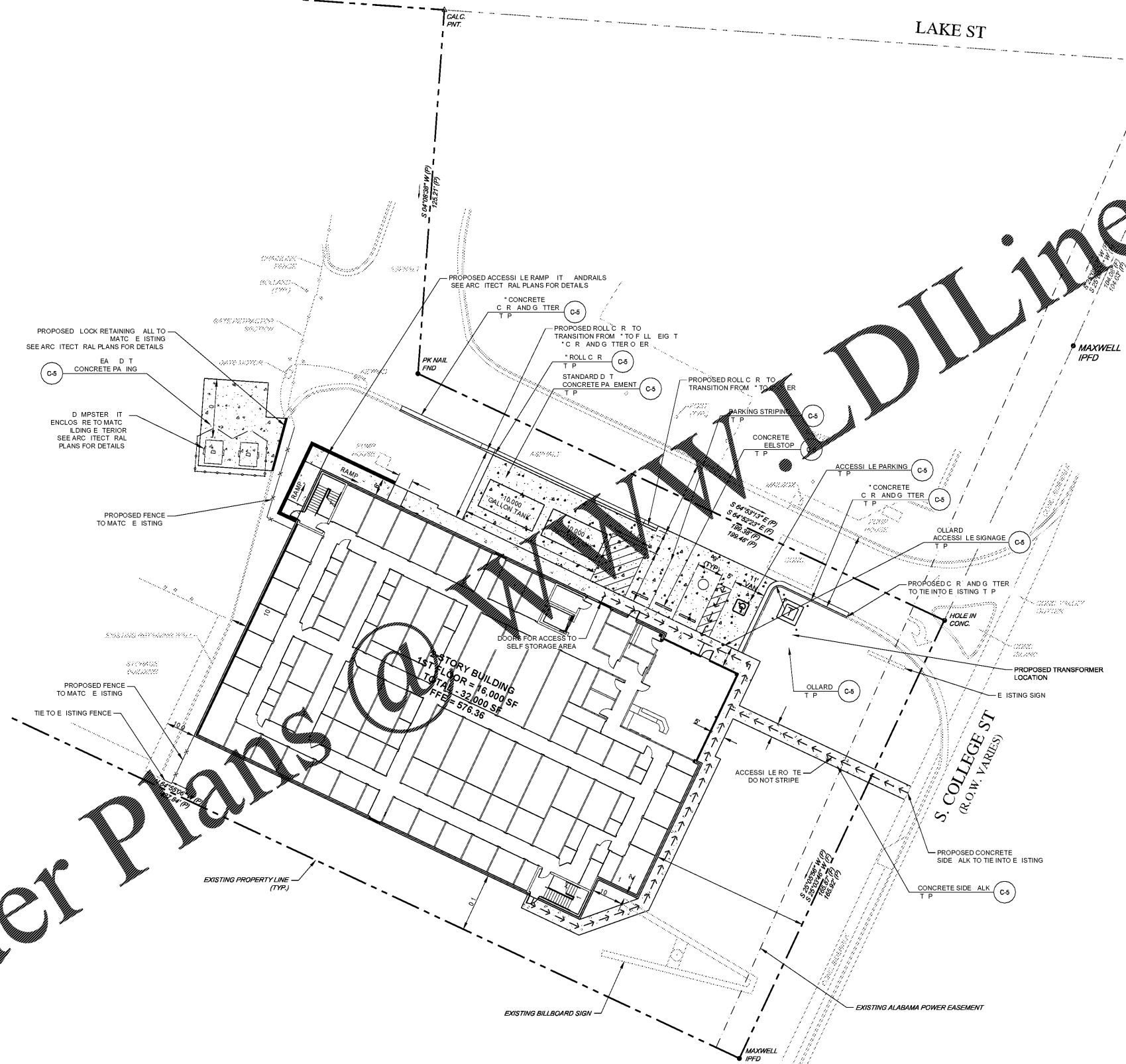
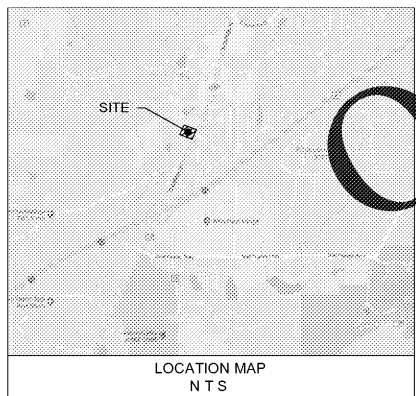

ENGINEER:
FORESITE
 group
 Foresite Group, Inc.
 2128 Moores Mill Rd.
 Suite C
 Auburn, AL 36830
 Phone: 334.887.6064
 Fax: 334.887.6024
 Website: www.fg-inc.net

DEVELOPER:
 LIFE STORAGE
 6467 MAIN STREET
 WILLIAMSVILLE, NY 14221
 CONTACT: ROBERT FISHER

PROJECT:
LIFE STORAGE 354 EXPANSION
 2020 S COLLEGE ST
 AUBURN, LEE COUNTY, AL 36832
 SECTION 12, TOWNSHIP 18 N, RANGE 25 E

SEAL:

REVISIONS	DATE
PERMIT SET	03/20/2019

PROJECT MANAGER:	SWT
DRAWING BY:	ZLR
JURISDICTION:	LEE COUNTY, AL
DATE:	12/21/2018
SCALE:	1" = 20'
TITLE:	

SITE & PAVING PLAN
 SHEET NUMBER:
C-1
 COMMENTS: NOT RELEASED FOR CONSTRUCTION
 JOB/FILE NUMBER: 1208.001