

- USE MOISTURE-RESISTANT GYP. BD. TO HEIGHT OF 4'-0" AROUND ALL MOP SINKS, EXTERIOR EXPOSURES, AND OTHER LOCATIONS SUSCEPTIBLE TO MOISTURE.
- EXISTING ELECTRICAL EQUIPMENT TO BE REUSED SHALL BE PUT IN "LIKE-NEW" CONDITION. ALL MARKINGS AND LABELS NOT ORIGINALLY PROVIDED BY MANUFACTURER SHALL BE REMOVED. DAMAGED OR MISSING PANEL COVERS, BREAKERS, ETC. SHALL BE REMOVED AND REPLACED. CLEAN AND PAINT TRANSFORMERS, PANEL BOXES, AND COVERS AS NEEDED. REMOVED PANEL SCHEDULES AND REPLACE WITH NEW TYPEWRITTEN PANEL SCHEDULES.
- PATCH ALL EXISTING WALLS SMOOTH AND FLUSH AS NEEDED.

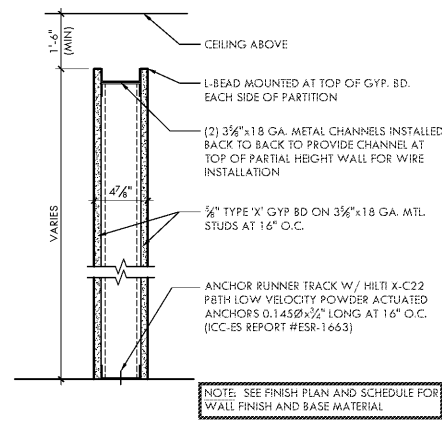

3 -
SCALE -

- SALES FLOORING SHALL BE COVERED IMMEDIATELY TO PROTECT FROM DAMAGE.
- SEE ELEVATIONS FOR ADDITIONAL FINISH INFORMATION.
- EXISTING FLOORING TO REMAIN. REPLACE ANY DAMAGED OR MISSING FLOOR TO MATCH EXISTING. CLEAN EXISTING FLOORING AND APPLY (2) COATS OF WAX.

Artifex
design studio
architects

Artifex Design Studio, Inc.
1215 Fern Ridge Pkwy
Suite 210
St Louis, MO 63141
p. 314-390-1945

COPYRIGHT © 2019
Artifex Design Studio, Inc.

GENERAL FLOOR PLAN NOTES

4 PARTITION TYPE

SCALE: 1-1/2" = 1'-0"

3 -

SCALE -

2 -

SCALE -

GENERAL FINISH PLAN NOTES

PROFESSIONAL SEAL

CONSULTANTS:

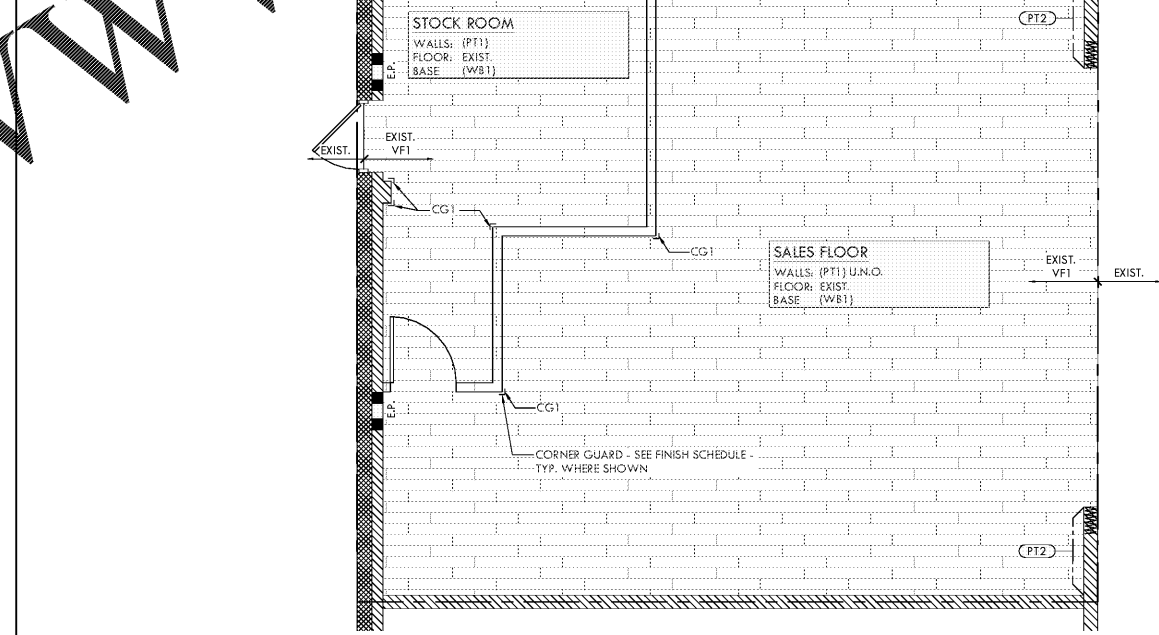
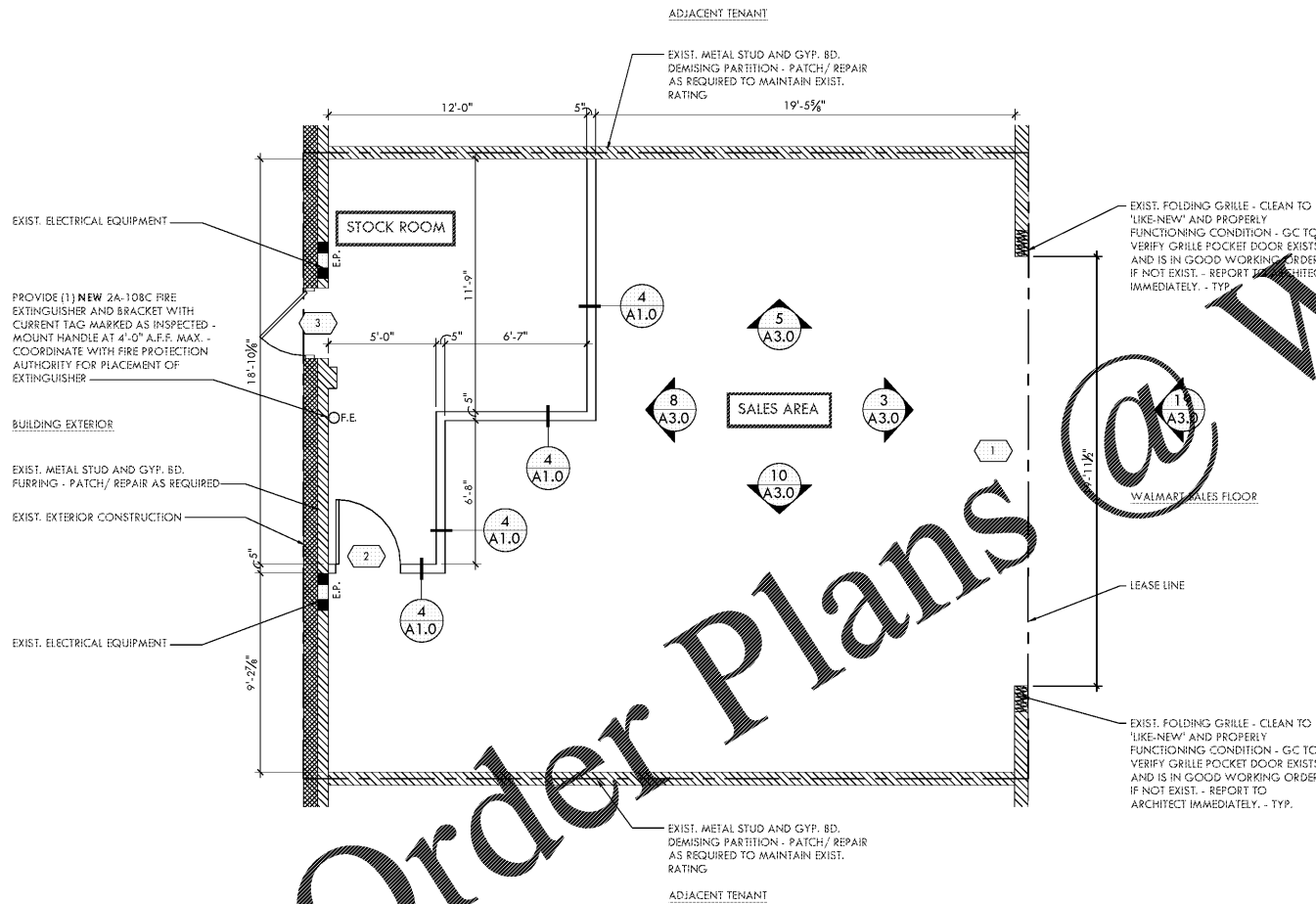

20 FLOOR PLAN

SCALE: 1/4" = 1'-0"

18 FINISH PLAN

SCALE: 1/4" = 1'-0"

PROJECT TITLE:
BUILD-A-BEAR WORKSHOP
WOODSTOCK WALMART #5275
WOODSTOCK, GA



No.	Date	Revision Description
BY:		PCJ
DATE:	04/01/19	
PROJ. NO.:	19026	

SHEET TITLE:
FLOOR PLAN
AND
FINISH PLAN

SHEET NO.:
A1.0