

Order Plans @ WWW.WALDDLINE.COM



PANDA EXPRESS, INC.
 1683 Walnut Grove Ave.
 Rosemead, California
 91770
 Telephone: 626.799.9898
 Facsimile: 626.372.8288

All ideas, designs, arrangement and plans indicated or represented by this drawing are the property of Panda Express Inc. and were created for use on this specific project. None of these ideas, designs, arrangements or plans may be used by or disclosed to any person, firm, or corporation without the written permission of Panda Express Inc.

REVISIONS:

ISSUE DATE:

1st	ISSUE FOR PERMIT	11-30-18

DRAWN BY: RR

PANDA PROJECT # S8-19-D6559
 ARCH PROJECT # 1805

Project No.
 PE1805

Kurzynske & Associates
 CONSULTING ENGINEERS
 2900 Lebanon Pike
 Suite 201
 Nashville, Tennessee 37214



11-30-18

PANDA EXPRESS
 ELM HILL PIKE AT DONELSON PIKE
 2740 ELM HILL PIKE
 NASHVILLE, TN 37214

2200 TRUE R1 (DAB 013)

E-101.1

CANOPY LIGHTING PLAN

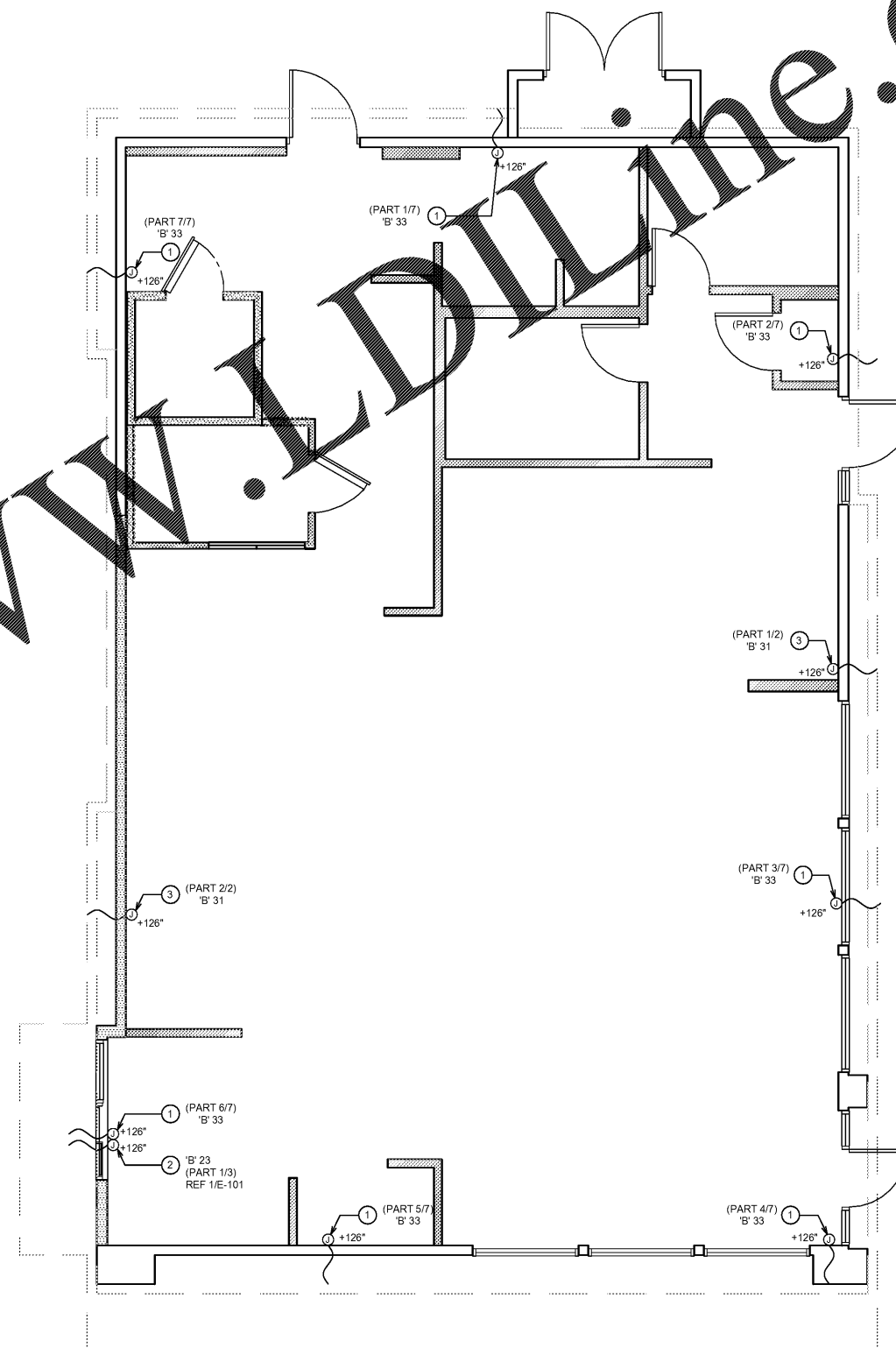

1. E.C. TO PROVIDE J-BOX WITH 3' WHIP FOR CONNECTION TO PANDA EXPRESS PROVIDED LIGHTED CANOPY. E.C. TO MAKE FINAL CONNECTION.
2. E.C. TO PROVIDE J-BOX WITH 3' WHIP FOR CONNECTION TO PANDA EXPRESS PROVIDED LIGHTED DRIVE THRU CANOPY. E.C. TO MAKE FINAL CONNECTION.
3. EXTERIOR FIN LIGHTING. FIELD VERIFY EXACT LOCATION WITH AWNING MANUFACTURER. CONTRACTOR SHALL PROVIDE J-BOX WITH 3' WHIP FOR CONNECTION OF 12 VOLT TRANSFORMER(S) TO FIXTURE. FIELD COORDINATE LOCATION OF TRANSFORMER. PROVIDE TRANSFORMER ENCLOSURE IF NOT SUPPLIED. COORDINATE ANY ADDITIONAL REQUIREMENTS PRIOR TO CONSTRUCTION. INCLUDE ALL ASSOCIATED COST IN BID.

© CANOPY LIGHTING KEYED NOTES 2

NOT TO SCALE E-101.1

CANOPY LIGHTING PLAN 1

Scale: 1/4"=1'-0" E-101.1