

**POTABLE WATER PIPING NOTES:**

- ① - 3/4" HW
- ② - 1 1/2" WATER UP THRU SLAB w/ SLEEVE (COORDINATE w/ GENERAL CONTRACTOR) PROVIDE SHUT-OFF VALVE AND PRESSURE REDUCING VALVE
- ③ - 3/4" HW UP TO MEZZANINE
- ④ - 1/2" CW DOWN
- ⑤ - 3/4" CW DOWN
- ⑥ - 1/2" CW & HW DOWN
- ⑦ - 3/4" CW & HW DOWN, STUB 3/4" CW & HW THRU WALL WITH SHUT-OFF VALVES. (INSTALL PER MANUFACTURER'S RECOMMENDATIONS)
- ⑧ - 1 1/4" CW UP TO MEZZANINE
- ⑨ - 3/4" CW UP
- ⑩ - ROUTE POTABLE WATER PIPING AS SHOWN
- ⑪ - POTABLE WATER PIPING IS LOCATED IN CEILING SPACE. (TYPICAL U.N.O.)
- ⑫ - 1/2" CW & HW UP
- ⑬ - 1/2" CW & HW (UNDER SLAB)
- ⑭ - 1 1/4" HW FROM MEZZANINE
- ⑮ - 1 1/4" CW & HW DOWN TO SERVE TEMPERING VALVE FOR SAFETY SHOWER

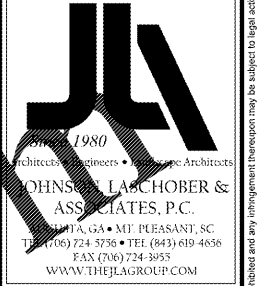

JOHNSON, LABCOBER & ASSOCIATES, P.C.  
 ARCHITECTS ENGINEERS INTERIORS  
 1111 W. GA. 400 MT. PLEASANT, SC  
 TEL: (706) 724-5736 • TEL: (843) 619-4656  
 FAX: (706) 724-3935  
 WWW.THEJLAGROUP.COM

CLIENT: AUGUSTA, GA  
 535 TELFAIR STREET, AUGUSTA, GA 30901

PROJECT NAME: **FIRE STATION #20**

PROJECT LOCATION: 2820 OLD HIGHWAY 1, HEPHIZBAH, GEORGIA 30815

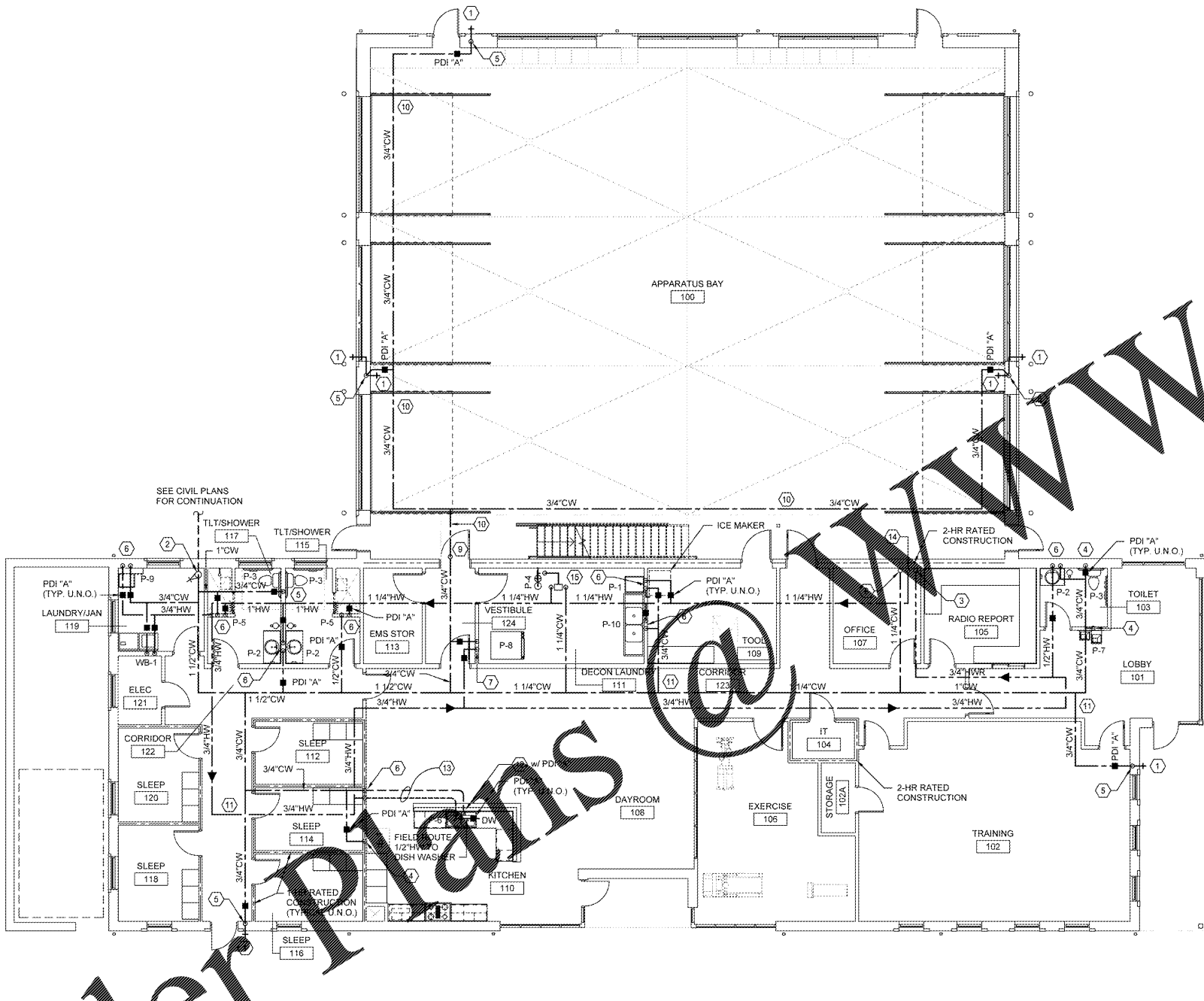

① POTABLE WATER PIPING PLAN  
 SCALE: 1/8" = 1'-0"

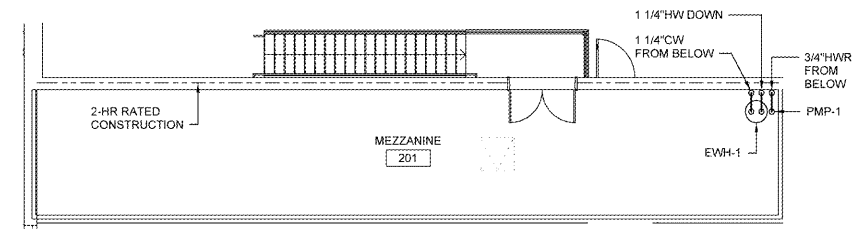

② MEZZANINE POTABLE WATER PIPING PLAN  
 SCALE: 1/8" = 1'-0"

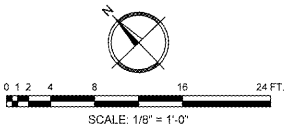

REV	DATE	BY	DESCRIPTION
0	12/21/18	MNB	ISSUED FOR BID

PROJECT NO: 3042.1604  
 DRAWN BY: WBR  
 CHECKED BY: MNB  
 DATE: 8/10/18

**POTABLE WATER PIPING PLANS**

SCALE: AS NOTED  
 DRAWING NO: **P-201**  
 REV: 0

Order Plans

WWW.LDILine.com

This document is the property of Johnson, Labcober & Associates, P.C. The unauthorized reproduction, copying or otherwise use of this document is strictly prohibited and any infringement thereupon may be subject to legal action.