

AUGUSTA TREE NOTES

ILLUSTRATED TREE ORDINANCE SECTION 6.5

- CONTRACTOR MUST CONTACT THE AUGUSTA PLANNING DEPARTMENT TO SET UP A PRE-CONSTRUCTION MEETING PRIOR TO ANY TREE DISTURBANCE.
- ALL TREE PROTECTION DEVICES MUST BE INSTALLED PRIOR TO INSPECTION BY THE CODE INSPECTION OFFICER AND PRIOR TO ANY TREE DISTURBANCE ACTIVITIES.
- REMOVAL OR DAMAGE OF TREES IN THE CONSERVATION AREA WILL BE SUBJECT TO THE PENALTIES ESTABLISHED IN THE PENALTIES SECTION OF THIS ORDINANCE.
- THESE PLANS SHALL BE REVIEWED BY THE CODE INSPECTION OFFICER FOR CONFORMANCE WITH APPLICABLE PROVISIONS OF THIS SECTION AND FOR TREE AND VEGETATION VIABILITY. THE PLANS WILL EITHER BE APPROVED OR RETURNED FOR REVISIONS. REASONS FOR RETURN SHALL BE NOTED ON THE PROPOSED PLAN.
- ALL TREE PROTECTION MEASURES SHALL BE INSTALLED PRIOR TO INSPECTION OF CODE INSPECTION OFFICER AND PRIOR TO TREE DISTURBANCE.
- THE CODE INSPECTION OFFICER WILL CONDUCT FOLLOW-UP SITE INSPECTIONS FOR ENFORCEMENT OF THE TREE PROTECTION REQUIREMENTS.
- NO LIGHTING CAN BE WITHIN 20' OF A REQUIRED TREE OR WITHIN A REQUIRED LANDSCAPE ISLAND.
- LIGHTING ON THE ELECTRICAL PLAN MUST BE CONSISTENT WITH LIGHTING DELINEATED ON THE TREE PROTECTION/TREE ESTABLISHMENT PLAN. IF CONFLICTS BETWEEN THE TWO PLANS ARISE, THE LIGHTING ON THE TREE PROTECTION/TREE ESTABLISHMENT PLAN SUPERSEDES LIGHTING ON THE ELECTRICAL PLAN.
- NO SIGNS, WITH THE EXCEPTION OF SMALL DIRECTIONAL SIGNS (THESE SIGNS MAY NOT EXCEED (30") IN HEIGHT NOR MORE THAN (4 SQ. FT.) IN AREA), MAY BE LOCATED WITHIN 20' OF A RETIRED TREE OR WITHIN REQUIRED LANDSCAPE ISLANDS.
- NO BICYCLE RACKS, FIRE HYDRANTS, UTILITY BOXES, TRANSFORMERS OR OTHER SITE APPURTENANCES MAY BE LOCATED IN REQUIRED LANDSCAPE ISLANDS.
- A PERMANENT WATER SOURCE MUST BE WITHIN 100' OF ALL REQUIRED TREES.
- NO NEW UTILITIES (UNDERGROUND OR OVERHEAD) MAY BE LOCATED DIRECTLY ABOVE OR BELOW EXISTING OR PROPOSED TREE LOCATIONS. PROPOSED UTILITIES MUST BE ROUTED AWAY FROM ALL REQUIRED TREES ON THIS SITE.
- ALL REQUIRED TREES ARE RECOMMENDED TO BE GROWN WITHIN ONE CLIMATIC ZONE OF AUGUSTA, GA.
- TREES PLANTED FOR CANOPY COVER CREDIT SHALL MEET QUALITY AND SIZE STANDARDS AS DESCRIBED IN THE ANSI Z 601 AMERICAN STANDARD FOR NURSERY STOCK DATED 1990 AND PUBLISHED BY THE AMERICAN NURSERY AND LANDSCAPE ASSOCIATION, AS OFFICIALLY REVISED AND AMENDED FROM TIME TO TIME. ALL TREES SHALL BE PER IGO LIST.
- ALL TREES SELECTED FOR PLANTING SHOULD BE OF URBAN TOLERANT SPECIES AND SUITABLE FOR THE SITE CONDITIONS OF PLANTING LOCATION, INCLUDING GROWING SPACE LIMITS, SOIL MOISTURE, SOIL VOLUME, AND CLASSIFIED AS WATER WISE PLANT ONCE ESTABLISHED. ALL TREES SHALL BE PER IGO LIST.
- ALL REQUIRED TREES SHALL BE NURSERY GROWN, TYPICAL OF THEIR SPECIES OR VARIETY, WITH NORMAL, DENSELY DEVELOPED BRANCHES AND VIGOROUS, FIBROUS ROOT SYSTEMS. TREES SHALL BE SOUND, HEALTHY, VIGOROUS, FREE FROM DEFECTS, FREE FROM DISFIGURING KNOTS, FREE FROM SUN SCALD INJURIES, FROST CRACKS AND/OR ABRASIONS OF THE BARK, AND BE FREE FROM PLANT DISEASES, INSECT EGGS, BORERS, AND ALL FORMS OF INFESTATION. ALL TREES SHALL HAVE A FULLY DEVELOPED FORM WITHOUT VOIDS AND OPEN SPACE. TREES SHALL NOT BE LOOSE IN THE CONTAINER OR ROOT BALL. IT IS RECOMMENDED THAT DUG TREES SHALL HAVE BEEN ROOT PRUNED AT LEAST ONCE.
- ALL REQUIRED TREES SHALL HAVE STRAIGHT, SINGLE CENTRAL LEADERS. TREES THAT ARE NOT FULLY BRANCHED WILL NOT BE ACCEPTED. TREES SHALL HAVE NO BARK DAMAGE AND SHALL NOT BE LEANING OR HAVE SIGNIFICANT SWEEP, CROOK, OR BEND. TREES SHALL HAVE A MINIMUM 3" CALIPER AND SHALL HAVE NO BRANCH MORE THAN HALF THE DIAMETER OF THE MAIN LEADER AND SHALL A STRAIGHT UNBRANCHED TRUNK TO 6' TREES SPECIFIED AS "MULTI-STEMMED" SHALL HAVE A MINIMUM OF 3 AND A MAXIMUM OF 5 SEPARATE CANES A MINIMUM OF 1" CALIPER EACH COMING FROM THE ROOT BALL AND PRUNED INTO TREE FORM WITH NO BRANCHES ON THE LOWER HALF OF THE TREE. MULTIPLE PLANTS SHALL NOT BE USED AS A "MULTI-STEMMED" PLANT.
- ALL REQUIRED TREES SHALL BE SET IN THE PLANTING PIT TO PROPER GRADE AND ALIGNMENT. AND SHALL BE SET UPRIGHT PLUMB AND FACED TO GIVE THE BEST APPEARANCE OR RELATIONSHIP TO OTHER TREES. EACH TREE SHALL BE SET 1'-2" ABOVE THE FINISH GRADE AND BACKFILL SHALL BE BROUGHT EVEN WITH THE TOP OF THE ROOT BALL. NO FILL SHALL BE PERMITTED ATOP THE ROOT BALL.
- ALL BURLAP, ROPES, STRAPS AND WIRES SHALL BE REMOVED FROM THE ROOT BALL. IF NOT POSSIBLE TO REMOVE THE BURLAP AND WIRE FROM THE BOTTOM OF THE ROOT BALL, THE BURLAP AND WIRE SHALL BE CUT AWAY FROM THE SIDES AND REMOVED FROM THE HOLES AFTER REQUIRED TREES ARE SET. THE BACKFILL SHALL BE MUDDLED AROUND THE BASE OF THE ROOT BALL AND ALL VOIDS SHALL BE FILLED.
- ALL REQUIRED TREES SHALL HAVE THEIR PLANTING PITS MULCHED WITH APPROVED MULCHING MATERIAL IMMEDIATELY AFTER PLANTING. THE MULCHED AREAS SHALL BE THOROUGHLY WATERED. NOTE: MULCH SHALL BE PLACED WITH A MINIMUM THICKNESS OF 3", NO MULCH WITHIN 8" OF TRUNK OF TREE.
- IF STAKING AND SUPPORTS HAVE BEEN INSTALLED ON THE REQUIRED TREE(S), ALL STAKING AND SUPPORTS SHALL BE REMOVED AFTER ONE GROWING SEASON.
- AS A GENERAL RULE, THE FOLLOWING GUIDELINES FOR TREE DIVERSITY WITHIN THE TREE PLANTING SITE AND POPULATION SHOULD BE ADHERED TO: 1) PLANT NO MORE THAN 10% OF ANY SPECIES; NO MORE THAN 20% OF ANY GENUS; AND NO MORE THAN 30% OF ANY FAMILY.

TREE ORDINANCE SECTION 8.4.13(D-8)

- ALL REQUIRED TREES ARE RECOMMENDED TO BE GROWN WITHIN ONE CLIMATIC ZONE OF AUGUSTA, GA.

TREE ORDINANCE SECTION 8.4.13(D-12)

- NO NEW UTILITIES (UNDERGROUND OR OVERHEAD) MAY BE LOCATED DIRECTLY ABOVE OR BELOW EXISTING OR PROPOSED TREE LOCATIONS. PROPOSED UTILITIES MUST BE ROUTED AWAY FROM ALL REQUIRED TREES ON THIS SITE.

TREE ORDINANCE SECTION 8.4.13(G)

- ALL REQUIRED TREES ARE RECOMMENDED TO BE GROWN WITHIN ONE CLIMATIC ZONE OF AUGUSTA, GA.

TREE ORDINANCE REQUIREMENTS

LANDSCAPE STRIP TREES

- 1 TREE/ 45 L.F. OF TOTAL LOT FRONTAGE (OLD HIGHWAY 1)
136 LF - REQUIRES 3 LARGE TREES
- 2 LANDSCAPE STRIP TREES PROVIDED DUE TO SITE ANGLES FOR EMERGENCY VEHICLE EXITING
- 1 TREE/ 45 L.F. OF TOTAL LOT FRONTAGE (WINDERMERE DRIVE)
303 LF - REQUIRES 7 LARGE TREES
- 7 LARGE TREES PROVIDED
- *ADDITIONAL TREES TO BE MITIGATED TO AN OFF SITE LOCATION DETERMINED BY THE AUGUSTA PLANNING AND ZONING DEPARTMENT

PARKING LOT TREES

- 1 TREE/ 3000 S.F. OF TOTAL PARKING LOT SURFACE AREA (NO PARKING SPACE IS MORE THAN 65' FROM THE TRUNK OF ANY PROPOSED TREE)
- 10,000 SF - REQUIRES 3 LARGE OR MEDIUM TREES
- 3 LARGE OR MEDIUM TREES PROVIDED ON SITE

MINIMUM CANOPY REQUIREMENT

ALL LAND UNDERGOING DEVELOPMENT SHALL PROVIDE FOR THIRTY PERCENT (30%) MINIMUM TREE CANOPY COVERAGE. TREE CANOPY COVERAGE IS THE SUM TOTAL OF PRESERVED TREES AND REPLACEMENT TREES AT THEIR ANTICIPATED CANOPY COVERAGE TEN (10) YEARS FROM THE TIME THAT THE SITE IS DEVELOPED.

TOTAL DISTURBED AREA: 1.3 ACRES (56,192 SF)
REQUIRED MINIMUM CANOPY: 56,192 x 0.3 = 16,857 SF (.39 ACRES)
TOTAL PRESERVED TREE CANOPY: 0 SF (0 ACRES)
ADDITIONAL CANOPY REQUIRED: 16,857 - 0 = 16,857 SF (.39 ACRES)
1 LARGE TREE= 1400 SF
12 PROVIDED= 16,800 SF
1 MEDIUM TREE= 750 SF
13 PROVIDED= 9,750 SF
TOTAL= 26,550

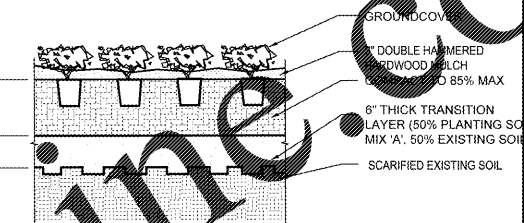
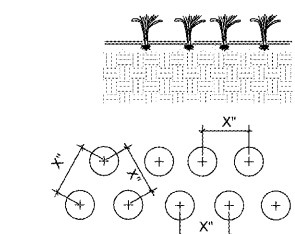

NOTES:
SEE PLANT SCHEDULE FOR SPACING REQUIREMENTS.
REMOVE CONTAINER GROWN PLANTS FROM THEIR CONTAINER AND CUT ANY CIRCLING ROOTS.
GROUND COVER PLANTING DETAIL
NOT TO SCALE

PLANTING NOTES:

- THE LANDSCAPE CONTRACTOR SHALL LOCATE AND VERIFY THE EXISTENCE OF ALL UTILITIES PRIOR TO STARTING WORK.
- THE LANDSCAPE CONTRACTOR SHALL SUPPLY ALL PLANT MATERIAL IN QUANTITIES SUFFICIENT TO COMPLETE THE PLANTING SHOWN ON ALL DRAWINGS.
- ALL MATERIAL SHALL CONFORM TO THE GUIDELINES ESTABLISHED IN THE CURRENT AMERICAN STANDARDS FOR NURSERY STOCK, PUBLISHED BY THE AMERICAN ASSOCIATION OF NURSERYMEN.
- NO PLANT SHALL BE PUT INTO THE GROUND BEFORE ROUGH GRADING IS COMPLETE AND APPROVED BY THE PROJECT LANDSCAPE ARCHITECT OR EQUAL.
- ALL PLANTS SHALL BE SET AT THE SAME ELEVATION TO FINISHED GRADE AS THE PLANT'S ORIGINAL GROUND SURFACE PRIOR TO DIGGING.
- ALL PLANTS SHALL BE BAGED AND WRAPPED OR CONTAINER GROWN AS SPECIFIED. NO CONTAINER GROWN STOCK SHALL BE ACCEPTED IF IT IS ROOT BOUND. ALL ROOT PRUNING MATERIAL MADE OF PLASTIC OR PLASTICS SHALL BE REMOVED AT TIME OF PLANTING.
- PRIOR TO PLANTING, THE LOCATION OF TREES SHALL BE STAKED AND ALL PLANT MATERIAL SHALL BE INSPECTED FOR APPROVAL BY THE PROJECT LANDSCAPE ARCHITECT OR EQUAL. NO PLANT MATERIAL WILL BE ACCEPTED IF IT IS DAMAGED, DISEASED OR INADEQUATE IN SIZE AS SPECIFIED ON PLANS. SUBSTITUTIONS DUE TO AVAILABILITY MUST BE APPROVED BY THE LANDSCAPE ARCHITECT.
- AT THE TIME OF PLANTING, ALL PLANTS SHALL BE THINNED BY REMOVING A BALANCED ONE THIRD OF THE VEGETATIVE MATERIAL. PRUNE FOR OPTIMUM APPEARANCE AND DESIGN INTENT BY ELIMINATING TALL SHOOTS, DEAD WOOD AND SUCKERS.
- ALL PLANTS SHALL BE INSTALLED AS PER DETAILS AND THE INSTALLATION SPECIFICATIONS.
- THE LANDSCAPE CONTRACTOR SHALL PROVIDE FERTILIZER, PRE-EMERGENT HERBICIDE, LIME, TOPSOIL AND PLANTING MIXTURE AS PER THE INSTALLATION SPECIFICATIONS.
- BEDLINES SHALL HAVE A 3" DEEP SHOVEL CUT TRENCH EDGE WHERE MULCH MEETS GRASS, CONCRETE WALKS OR CURBS UNLESS OTHERWISE SPECIFIED. BEDLINES SHALL BE SMOOTH AND CONTINUOUS AND BE WITHIN A REASONABLE LOCATION AND SHAPE AS ILLUSTRATED ON PLANS.
- BERM PLANTING AREAS W/ 4" TOP SOIL. USE TOPSOIL STOCKPILED DURING GRADING OPERATIONS IF SUITABLE. ALL PLANTING AREAS SHOULD HAVE POSITIVE DRAINAGE AND NOT ENCOURAGE SATURATED ROOT SYSTEMS.
- PLACE A MINIMUM 3" OF MULCH OVER ALL PLANTING BEDS. TUCK MULCH UNDER PLANTS AND INTO BEDLINE TRENCHES.
- LANDSCAPE CONTRACTOR IS RESPONSIBLE FOR CLEAN UP OF ALL CONTAINERS, PALLETS, DEBRIS, ETC. RESULTING FROM HIS/HER WORK.

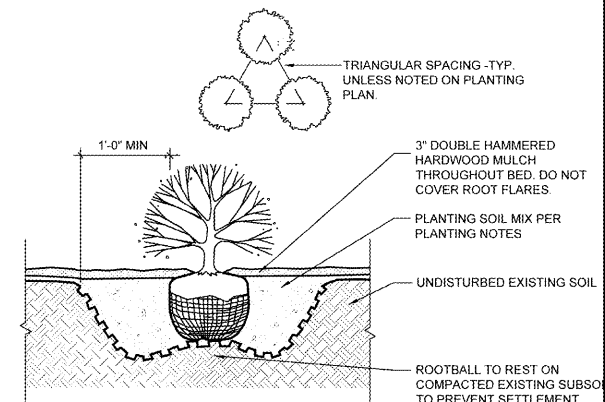

TYPICAL BED LAYOUT:
1. LAY OUT PERIMETER PLANTING SPACED AS PER PLAN.
2. FILL IN PLANTING BED WITH TRIANGULAR SPACING. ADJUST AS PER L.A.'S INSTRUCTIONS.
NOTES:
1. VERIFY FINISH GRADE ELEVATION. PLANT TOP OF ROOTBALL AT FINISH GRADE.
2. REMOVE BURLAP FROM TOP 1/2 OF BALL. REMOVE CONTAINER PLANTS FROM CONTAINERS AND CUT ANY CIRCLING ROOTS.

SHRUB PLANTING DETAIL

NOT TO SCALE

IRRIGATION SPECIFICATIONS:

- CONTRACTOR SHALL DESIGN AND INSTALL AN IRRIGATION SYSTEM FOR 100% COVERAGE OF ALL NEW TREES, SHRUBS AND GRASS WITHIN THE IRRIGATION LIMITS. A SHOP DRAWING OF THE PROPOSED SYSTEM LAYOUT AND PROPOSED EQUIPMENT SCHEDULE MUST BE SUBMITTED TO OWNER FOR APPROVAL PRIOR TO CONSTRUCTION.
- ALL IRRIGATION EQUIPMENT SHALL BE MANUFACTURED BY RAINBIRD INC. OR APPROVED EQUAL. CONTRACTOR SHALL FIELD VERIFY EXISTING WATER PRESSURE AND AVAILABLE VOLUME FOR MINIMUM MANUFACTURER SPECIFIED WORKING PRESSURE BEFORE INSTALLING IRRIGATION SYSTEM. CONTRACTOR SHALL SUPPLY POWER TO CONTROLLER UTILIZING NEAR-EST EXISTING POWER SUPPLY.
- CONTRACTOR SHALL CONSULT WITH OWNER AS TO THE LOCATION AND PLACEMENT OF THE CONTROLLER.
- CONTRACTOR WILL INSTALL HEADS AND NOZZLES THAT WILL LIMIT THE AMOUNT OF WATER THROWN ON IMPERVIOUS SURFACES AND STILL MAINTAIN 100% COVERAGE OF PLANTED AREAS WITHIN THE IRRIGATION LIMITS. WATER OVERSPRAY ONTO IMPERVIOUS SURFACES MUST BE MINIMIZED TO THE GREATEST EXTENT POSSIBLE. IRRIGATION WATER MUST BE DIRECTED AWAY FROM BUILDINGS & OTHER STRUCTURES.
- CONTRACTOR SHALL LOCATE ALL UTILITIES BEFORE IRRIGATION INSTALLATION BEGINS.
- NO IRRIGATION WATER SHALL BE THROWN ON BUILDING MASONRY. NO FUNNY PIPE OR OTHER FLEXIBLE PIPE CAN BE USED FOR SUPPLY OR FEEDER LINES. NO STATIONARY RISERS CAN BE USED.
- ALL PLASTIC PIPE FROM SIZES 4" AND ABOVE SHALL BE CLASS 200. SDR 21. UNPLASTICIZED RIGID PVC PIPE WITH INTEGRAL BELL AND RUBBER RING GASKET UNLESS OTHERWISE SPECIFIED. PIPE FROM SIZES 3" TO 3/4" SHALL BE CLASS 200. SOLVENT WELD PVC PIPE. 1/2" PIPE SHALL BE CLASS 200. SOLVENT WELD PVC PIPE. ALL PIPE SHALL BE SUPPLIED IN 20' STANDARD LENGTHS AND SHALL BE MANUFACTURED BY CERTAINTED CORP., CRESTLINE, DURA, OR EQUAL. ALL PIPE THAT IS EXPOSED OR NOT BELOW GRADE SHALL BE SCHEDULE 80 PVC. ALL IN-GROUND WIRE CONNECTIONS MUST BE MADE WITH 3M-DBY WIRE CONNECTIONS OR APPROVED EQUAL.
- CONTROLLER SHALL BE BY RAIN BIRD OR APPROVED EQUAL. CONTROLLER SHALL INCLUDE RAIN SENSOR. CONTROLLER SHALL BE WEATHER TIGHT. CONSTRUCTION.
- ALL CONTROL VALVES MUST BE BRASS OR SCHD. 80 PVC WITH A SCHD. 80 ISOLATION VALVE AT EACH CONTROL VALVE.
- VALVES IN BOXES MUST BE EASILY ACCESSIBLE AND INSTALLED WITH 8" DRAINAGE ROCK IN BOTTOM.
- ALL VALVE BOXES SHALL BE SET 1" ABOVE FINISHED GRADE.

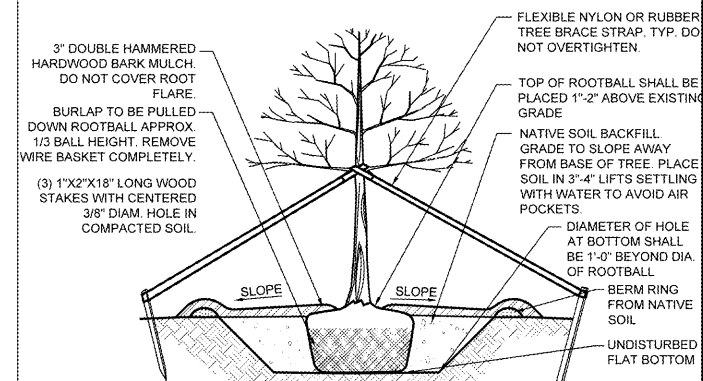

NOTES: TREES TO BE WATERED THOROUGHLY AFTER PLANTING.
NOTES:
1. MIN. ROOT MASS TO BE IN ACCORDANCE WITH "AMERICAN STANDARDS FOR NURSERY STOCK"
2. DO NOT ALLOW ROOT BALL TO DRY OUT DURING INSTALLATION PROCESS.
3. ALL STRAPS, STAKES AND ASSOCIATED MATERIALS SHALL BE REMOVED BY CONTRACTOR WITHIN ONE WEEK OF THE END OF THE 90 DAY MAINTENANCE PERIOD.
4. NOTE COMPASS ORIENTATION OF TREE PRIOR TO DIGGING AND MATCH PRIOR ORIENTATION AT INSTALLATION.

TYP. TREE PLANTING DETAIL

NOT TO SCALE

COUNT	SYMB.	SIZE	BOTANICAL NAME	COMMON NAME	HEIGHT	SPACING
3	Lt	3" CAL.	Liriodendron tulipifera	Tulip Poplar	10'-12'	AS SHOWN
11	Mv	3" CAL.	Magnolia virginiana australis	Sweetbay Magnolia	10'-12'	AS SHOWN
3	Na'G'	3" CAL.	Nyssa sylvatica 'Green Gables'	Green Gables Black Gum	10'-12'	AS SHOWN
6	Sh'S'	3" CAL.	Shawnee Brave Bald Cypress	Shawnee Brave Bald Cypress	10'-12'	AS SHOWN
11	Em'G'	3" CAL.	Emerald Green Arborvitae	Emerald Green Arborvitae	10'-12'	AS SHOWN
55	M'	7" CAL.	Myrica cerifera	Southern Wax Myrtle	FULL	AS SHOWN
10	Dw'G'	3" CAL.	Dwarf Fothergilla	Dwarf Fothergilla	FULL	AS SHOWN
5	Co'G'	3" CAL.	Compact Inkberry	Compact Inkberry	FULL	AS SHOWN
55	Lm'S'	3" CAL.	Liriope muscari 'Super Blue'	Super Blue Mondo Grass	FULL	24" O.C.
55	As'G'	3" CAL.	Asiatic Jasmine	Asiatic Jasmine	FULL	24" O.C.

APPROXIMATELY 7,500 SF HYBRID BERMUDA SOD *CONTRACTOR IS RESPONSIBLE FOR HIS OR HER OWN TAKE OFFS
APPROXIMATELY 3,500 SF HYBRID BERMUDA SEED *CONTRACTOR IS RESPONSIBLE FOR HIS OR HER OWN TAKE OFFS

1980
Architects • Engineers • Landscape Architects
JOHNSON, LASCHNER & ASSOCIATES, P.C.
1000 W. PLEASANT ST. SUITE 200
AUGUSTA, GA 30901
TEL: (706) 724-3756 • TEL (843) 619-4656
FAX: (706) 724-3935
WWW.THEJLAGROUP.COM

CLIENT:
AUGUSTA, GA
535 TELFAIR STREET, AUGUSTA, GA 30901

PROJECT NAME:
FIRE STATION #20

PROJECT LOCATION:
2820 OLD HIGHWAY 1, HEPHIZBAH, GEORGIA 30815

NO.	ISSUED FOR	REV.	DATE	BY	DESCRIPTION
0	12/21/18	EDH			

PROJECT NO.	3042.1604
DRAWN BY:	JNR
CHECKED BY:	EDH
DATE:	8/10/18
SHEET TITLE:	
LANDSCAPE DETAILS	
SCALE:	AS NOTED
DRAWING NO.	L-201
REV.	0

C
B
A
A1
B1
C3
C4
B3
A3
A4
B4

Original Plans

This document is the property of Johnson, Laschner & Associates, P.C. The unauthorized reproduction, copying or otherwise use of this document is strictly prohibited and any infringement thereon may be subject to legal action.