

SPEED LIMIT CURRENTLY 45 MPH BEING CHANGED TO 35 MPH PER NEWTON COUNTY DOT

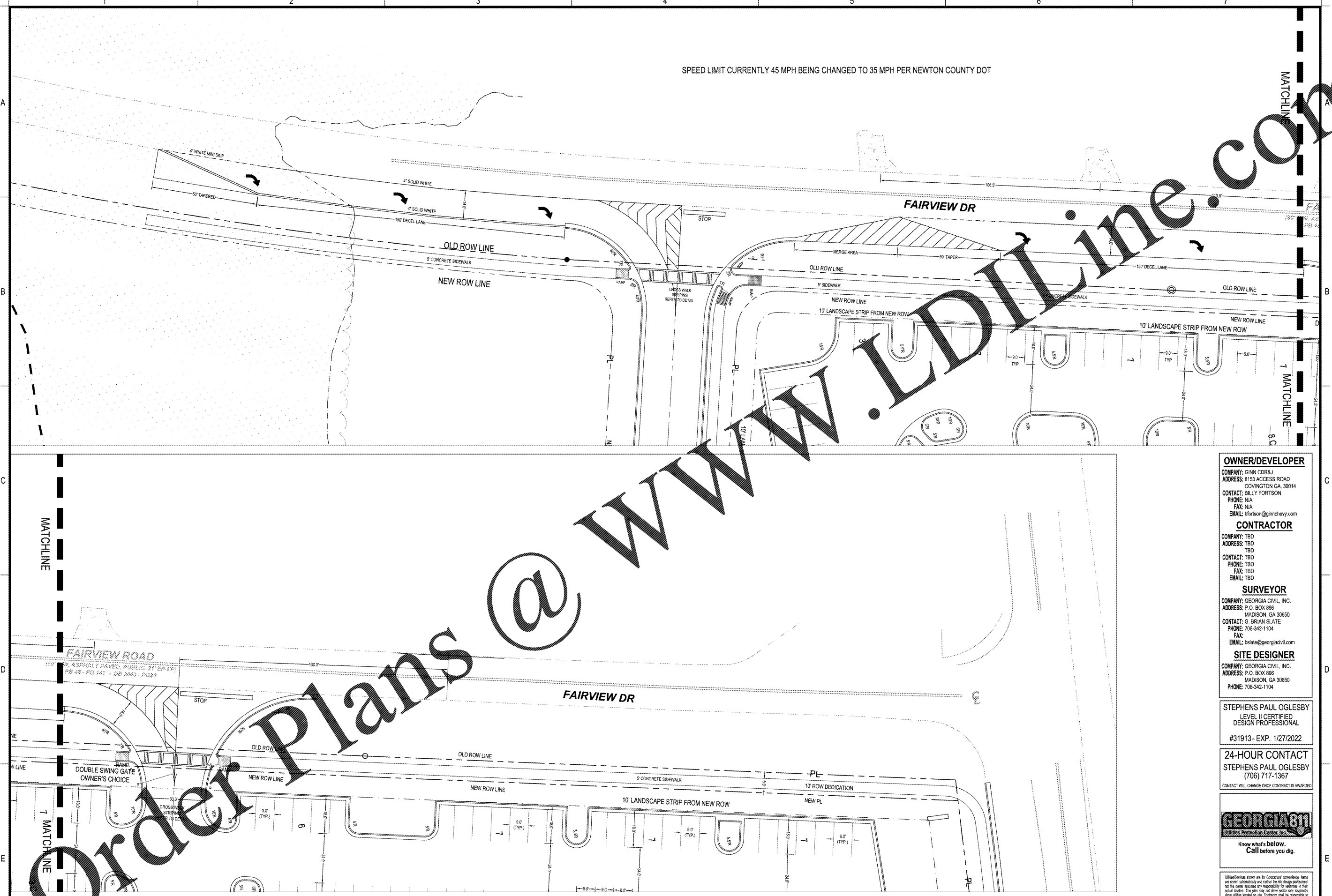

**OWNER/DEVELOPER**  
 COMPANY: GINN CDR&J  
 ADDRESS: 8153 ACCESS ROAD  
 COVINGTON GA. 30014  
 CONTACT: BILLY FORTSON  
 PHONE: N/A  
 FAX: N/A  
 EMAIL: bfortson@ginnchevy.com

**CONTRACTOR**  
 COMPANY: TBD  
 ADDRESS: TBD  
 PHONE: TBD  
 FAX: TBD  
 EMAIL: TBD

**SURVEYOR**  
 COMPANY: GEORGIA CIVIL, INC.  
 ADDRESS: P.O. BOX 896  
 MADISON, GA 30650  
 CONTACT: G. BRIAN SLATE  
 PHONE: 706-342-1104  
 FAX:  
 EMAIL: bslate@georgiacivil.com

**SITE DESIGNER**  
 COMPANY: GEORGIA CIVIL, INC.  
 ADDRESS: P.O. BOX 896  
 MADISON, GA 30650  
 PHONE: 706-342-1104

STEPHENS PAUL OGLESBY  
 LEVEL II CERTIFIED  
 DESIGN PROFESSIONAL  
 #31913 - EXP. 1/27/2022

24-HOUR CONTACT  
 STEPHENS PAUL OGLESBY  
 (706) 717-1367  
 CONTACT WILL CHANGE ONCE CONTRACT IS AWARDED

**GEORGIA811**  
 BUSINESS PROTECTION CENTER, INC.  
 Know what's below.  
 Call before you dig.

Utilities shown are for Contractor's information. Items are shown schematically and neither the site design professional nor the owner assume any responsibility for utilities at their actual location. This plan may not show and/or may incorrectly show utilities located on site. Contractor shall be responsible to locate and use the services of a private utility locator for locating the entire scope of work and shall pay for said service. Contractor shall locate utilities and any obstructions including, but not limited to, water, gas, and electric lines that are to be used and protected. Contractor shall verify the design professional of any utility conflicts prior to installation of new utilities, grading, etc. The Contractor, at their expense, shall be responsible to report, remove and/or relocate, as necessary, any utilities contacted, whether shown or not. Appropriate, reasonable, etc. of utilities shall be coordinated with the responsible utility company.

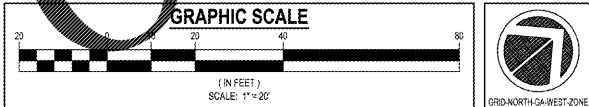

**georgia civil**  
 CIVIL ENGINEERING  
 LANDSCAPE ARCHITECTURE  
 LAND SURVEYING  
 311 N. Main St., Unit C, Suite 101  
 P.O. Box 896 | Madison, GA 30650  
 P: 706.342.1104 | F: 706.342.1105  
 www.georgiacivil.com  
 Professional Seal

**GINN CDR&J**  
 0025-041, 0025-042, PORTION OF 0025-042B  
 ACCESS ROAD - FAIRVIEW ROAD INTERSECTION  
 COVINGTON, GA  
 NEWTON COUNTY  
 CG-GENERAL COMMERCIAL (NEWTON COUNTY)

DRAWING DATE:	2/15/2019
DRAWN BY:	SPO
CHECKED BY:	SPO
REVISIONS	
DATE:	DESCRIPTION:

© Copyright 2016 georgia civil, inc.  
 This document and its reproduction are the property of Georgia Civil, Inc. and may not be reproduced, published, or used in whole or in part without the written consent of Georgia Civil, Inc.

Sheet Number  
**C-9.1**