



ELLSWORTH ARCHITECTS
 3136 LANIER DRIVE
 ATLANTA, GEORGIA 30319
 PHONE: 404.949.9351

PRO BUILDING SYSTEMS
 DESIGN BUILD CONTRACTORS
 3678 North Peachtree Road
 Atlanta, Georgia 30341
 (770) 455-1791 / Fax 455-4123
 www.probidgsystems.com

GINN CHRYSLER - DODGE - RAM AND JEEP
 1-20 ACCESS ROAD
 COVINGTON GEORGIA 30040

DATE: 09.26.2018
 SCALE: 3/8"=1'-0"
 BY: RJE
 JOB ID: 18YGIN001

INTERIOR PARTITION TYPES
 DRAWING TITLE

A9.1

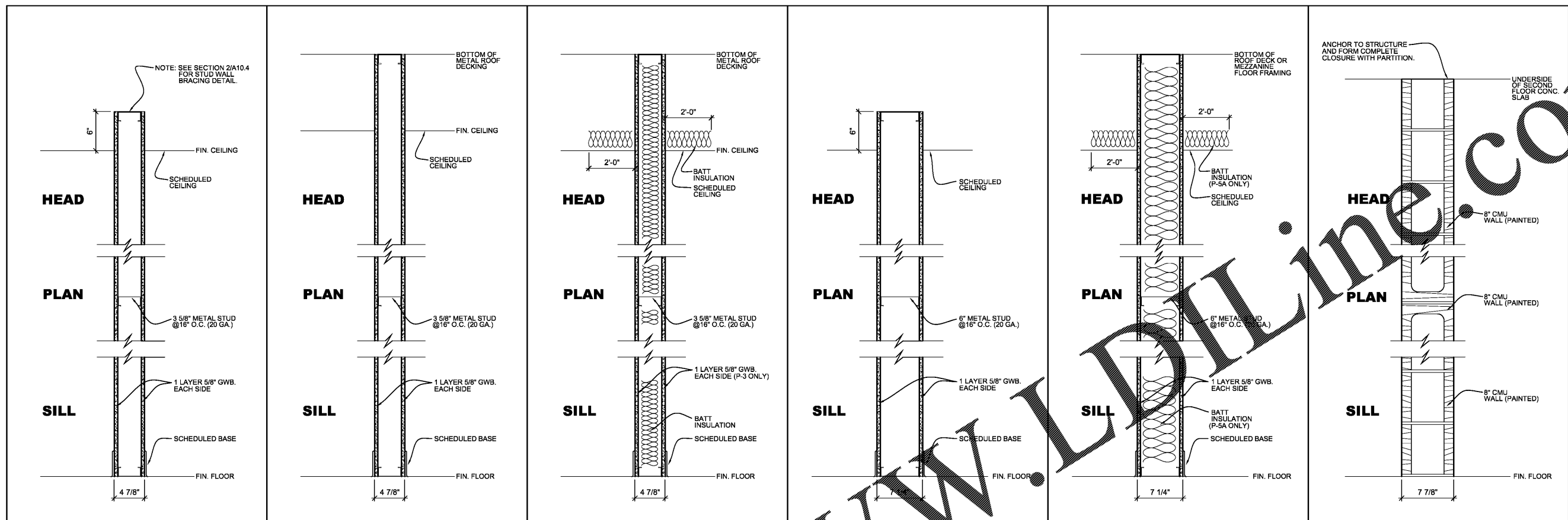

P-1 WALL TO 6" ABOVE CEILING **P-2 FULL HEIGHT WALL** **P-3 FULL HEIGHT WALL** **P-4 WALL TO 6" ABOVE CEILING** **P-5 FULL HEIGHT WALL** **P-6 FULL HEIGHT WALL**

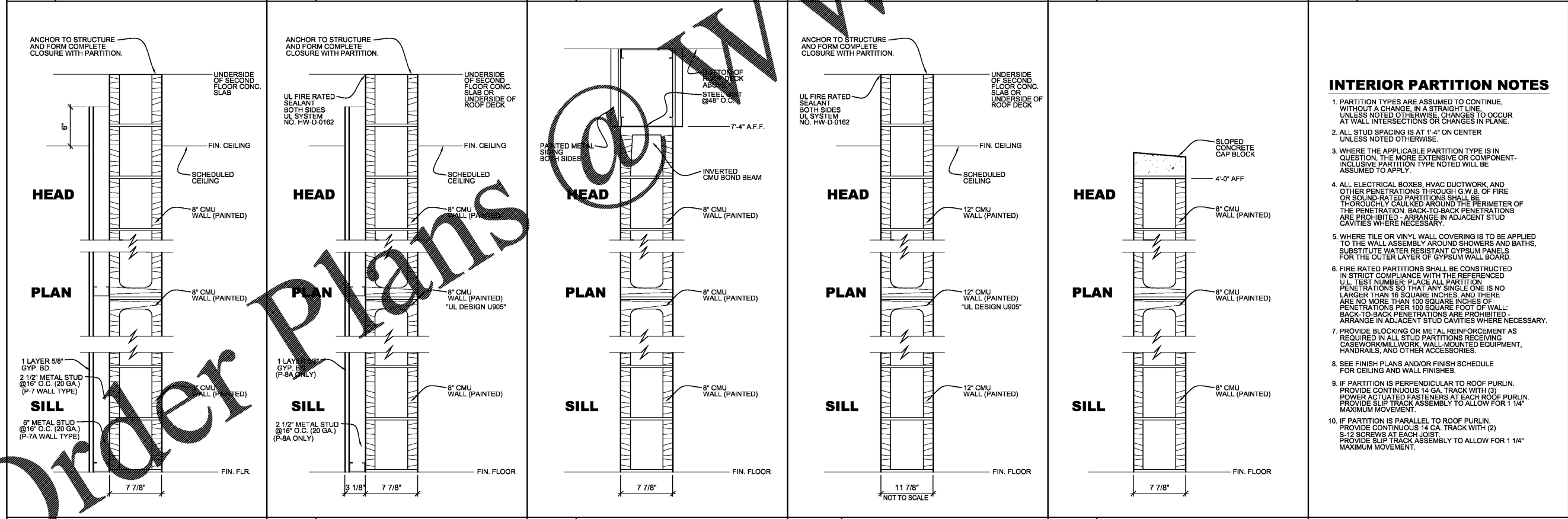

P-7 FULL HEIGHT WALL **P-8 FULL HEIGHT WALL ONE-HOUR FIRE RATED** **P-9 FULL HEIGHT WALL** **P-10 FULL HEIGHT WALL ONE-HOUR FIRE RATED** **P-11 4'-0" HIGH CMU WALL**

INTERIOR PARTITION NOTES

- PARTITION TYPES ARE ASSUMED TO CONTINUE, WITHOUT A CHANGE, IN A STRAIGHT LINE, UNLESS NOTED OTHERWISE, CHANGES TO OCCUR AT WALL INTERSECTIONS OR CHANGES IN PLANE.
- ALL STUD SPACING IS AT 1'-4" ON CENTER UNLESS NOTED OTHERWISE.
- WHERE THE APPLICABLE PARTITION TYPE IS IN QUESTION, THE MORE EXTENSIVE OR COMPONENT-INCLUSIVE PARTITION TYPE NOTED WILL BE ASSUMED TO APPLY.
- ALL ELECTRICAL BOXES, HVAC DUCTWORK, AND OTHER PENETRATIONS THROUGH G.W.B. OF FIRE OR SOUND-RATED PARTITIONS SHALL BE THOROUGHLY CAULKED AROUND THE PERIMETER OF THE PENETRATION. BACK-TO-BACK PENETRATIONS ARE PROHIBITED - ARRANGE IN ADJACENT STUD CAVITIES WHERE NECESSARY.
- WHERE TILE OR VINYL WALL COVERING IS TO BE APPLIED TO THE WALL ASSEMBLY AROUND SHOWERS AND BATHS, SUBSTITUTE WATER RESISTANT GYPSUM PANELS FOR THE OUTER LAYER OF GYPSUM WALL BOARD.
- FIRE RATED PARTITIONS SHALL BE CONSTRUCTED IN STRICT COMPLIANCE WITH THE REFERENCED U.L. TEST NUMBER. PLACE ALL PARTITION PENETRATIONS SO THAT ANY SINGLE ONE IS NO LARGER THAN 16 SQUARE INCHES, AND THERE ARE NO MORE THAN 100 SQUARE INCHES OF PENETRATIONS PER 100 SQUARE FOOT OF WALL. BACK-TO-BACK PENETRATIONS ARE PROHIBITED - ARRANGE IN ADJACENT STUD CAVITIES WHERE NECESSARY.
- PROVIDE BLOCKING OR METAL REINFORCEMENT AS REQUIRED IN ALL STUD PARTITIONS RECEIVING CASEWORK/MILLWORK, WALL-MOUNTED EQUIPMENT, HANDRAILS, AND OTHER ACCESSORIES.
- SEE FINISH PLANS AND/OR FINISH SCHEDULE FOR CEILING AND WALL FINISHES.
- IF PARTITION IS PERPENDICULAR TO ROOF PURLIN, PROVIDE CONTINUOUS 14 GA. TRACK WITH (3) POWER ACTUATED FASTENERS AT EACH ROOF PURLIN. PROVIDE SLIP TRACK ASSEMBLY TO ALLOW FOR 1 1/4" MAXIMUM MOVEMENT.
- IF PARTITION IS PARALLEL TO ROOF PURLIN, PROVIDE CONTINUOUS 14 GA. TRACK WITH (2) 5-12 SCREWS AT EACH JOIST. PROVIDE SLIP TRACK ASSEMBLY TO ALLOW FOR 1 1/4" MAXIMUM MOVEMENT.

Order Plans