

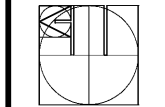

REVISION DATE

ELLSWORTH ARCHITECTS  
3136 LANIER DRIVE  
ATLANTA, GEORGIA 30319  
PHONE: 404.949.9351



PRO BUILDING SYSTEMS  
DESIGN BUILD CONTRACTORS

3878 North Peachtree Road  
Atlanta, Georgia 30341  
(770) 455-1781 / Fax 455-4123  
www.probdgsystems.com

GINN CHRYSLER - DODGE - RAM AND JEEP  
1-20 ACCESS ROAD  
COVINGTON GEORGIA 30040

DATE: 09.26.2018  
SCALE: 3/32"=1'-0"  
BY: RJE  
JOB ID: 18YGIN001

FIRST FLOOR LIFE SAFETY PLAN  
DRAWING TITLE

A0.1

SHEET 2 OF 33

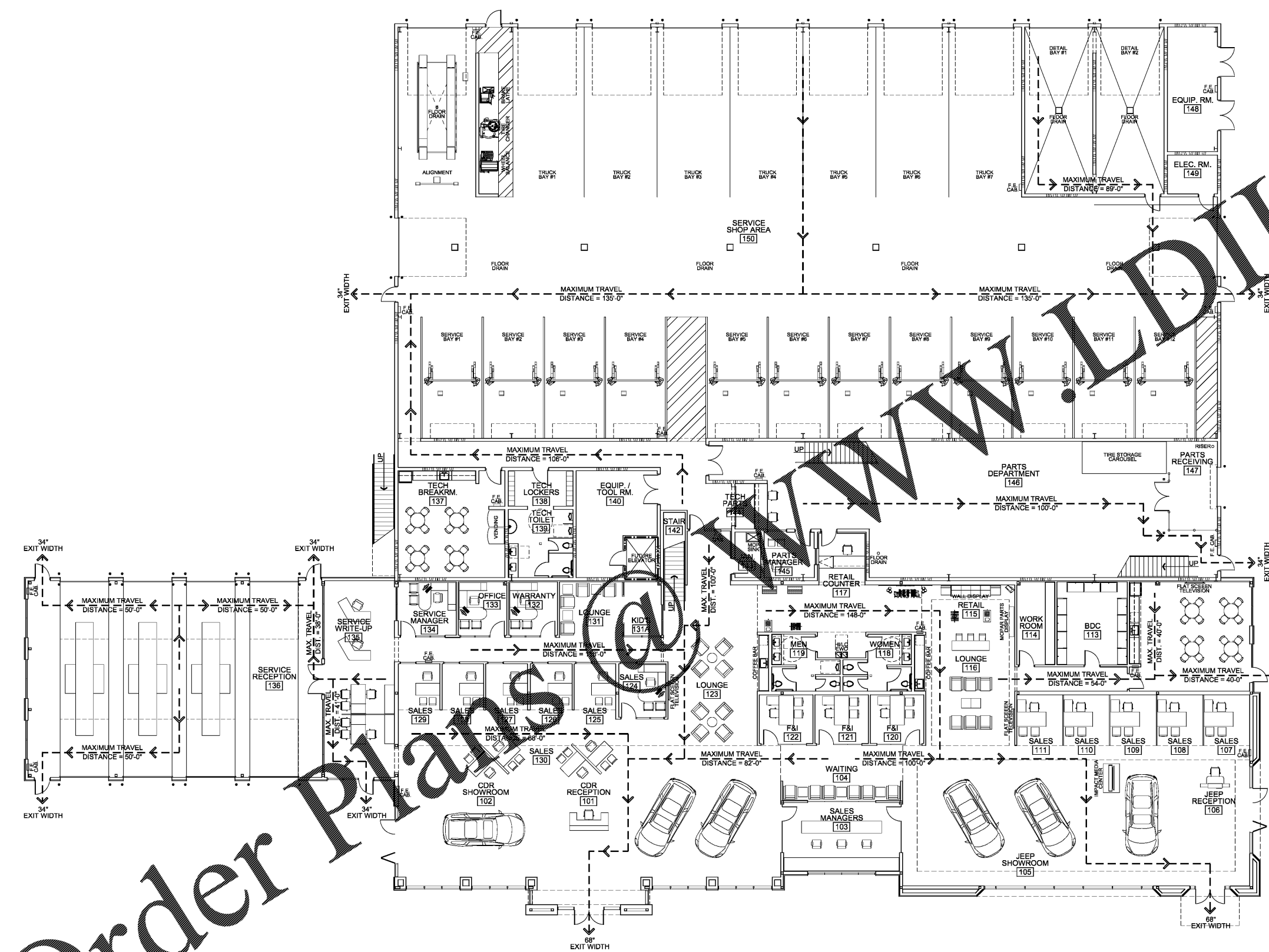

### FIRST FLOOR BUILDING CLASSIFICATION

- BUILDING OCCUPANCY TYPE: NON-SEPARATED MIXED USE SHOWROOM; BUSINESS GROUP B - PER IBC, 2012 EDITION
- SERVICE AREA / PARTS: MODERATE HAZARD STORAGE GROUP S1
- OCCUPANCY LOAD - GROUP B: 1 PERSON PER 100 S.F. (FIRST FLOOR) 12,015 S.F. / 100 = 120 PERSONS
- OCCUPANCY LOAD - GROUP S1: 1 PERSON PER 300 S.F. (FIRST FLOOR) 21,919 S.F. / 300 = 73 PERSONS
- TOTAL FIRST FLOOR OCCUPANCY LOAD - 120 + 73 = 193 PERSONS
- CONSTRUCTION TYPE: TYPE II - AS PER IBC 2012 WITH AUTOMATIC SPRINKLER SYSTEM
- MAXIMUM ALLOWABLE BUILDING HEIGHT: GROUP B - FIVE STORIES
- ACTUAL BUILDING HEIGHT: GROUP B - TWO STORIES
- MAXIMUM ALLOWABLE BUILDING HEIGHT: GROUP S1 - FOUR STORIES
- ACTUAL BUILDING HEIGHT: GROUP S1 - ONE STORY
- MAXIMUM ALLOWABLE BUILDING AREA: GROUP B - 46,000 S.F.
- ACTUAL FIRST FLOOR BUILDING AREA: GROUP B - 12,015 S.F.
- MAXIMUM ALLOWABLE BUILDING AREA: GROUP S1 - 35,000 S.F.
- ACTUAL FIRST FLOOR BUILDING AREA: GROUP S1 - 21,919 S.F.
- ACTUAL TOTAL FIRST FLOOR BUILDING AREA: 33,934 S.F.
- EGRESS WIDTH REQUIRED (GROUP B) 120 PERSONS x 0.2' = 24'
- EGRESS WIDTH PROVIDED: 306"
- EGRESS WIDTH REQUIRED (GROUP S1) 73 PERSONS x 0.2' = 14.6'
- EGRESS WIDTH PROVIDED: 102"
- MINIMUM ALLOWABLE CLEAR OPENING OF EXIT DOORS: 34"
- MAXIMUM TRAVEL DISTANCE LIMIT (WITH SPRINKLER SYSTEM) GROUP B: 300'-0"
- MAXIMUM TRAVEL DISTANCE LIMIT (WITH SPRINKLER SYSTEM) GROUP S1: 250'-0"
- MAXIMUM COMMON PATH LIMIT (WITH SPRINKLER SYSTEM) GROUP B: 100'-0"
- MAXIMUM COMMON PATH LIMIT (WITH SPRINKLER SYSTEM) GROUP S1: 100'-0"
- MAXIMUM DEAD-END CORRIDOR LIMIT (WITH SPRINKLER SYSTEM) GROUP B: 20'-0"
- MAXIMUM DEAD-END CORRIDOR LIMIT (WITH SPRINKLER SYSTEM) GROUP S1: 50'-0"
- MINIMUM ALLOWABLE CORRIDOR WIDTH: 44"
- MINIMUM ALLOWABLE STAIR WIDTH: 44"
- MINIMUM ALLOWABLE MEANS OF EGRESS (GROUP B): TWO REQUIRED
- NUMBER OF MEANS OF EGRESS (GROUP B): SEVEN PROVIDED
- MINIMUM ALLOWABLE MEANS OF EGRESS (GROUP S1): TWO REQUIRED
- NUMBER OF MEANS OF EGRESS (GROUP S1): THREE PROVIDED
- FIRE SEPARATION REQUIRED BETWEEN OCCUPANCIES: NO SEPARATION REQUIRED
- HAZARDOUS AND FLAMMABLE CHEMICAL STORAGE: NO HAZARDOUS OR FLAMMABLE CHEMICALS TO BE STORED AT THIS FACILITY

1 FIRST FLOOR LIFE SAFETY PLAN  
A0.1 3/32"=1'-0"  
FIRST FLOOR BUILDING AREA: 33,934 S.F.  
NOTE: THIS BUILDING IS EQUIPPED WITH AN AUTOMATIC SPRINKLER SYSTEM.

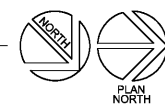

Order Plans