

Plot Date: 3/7/2019

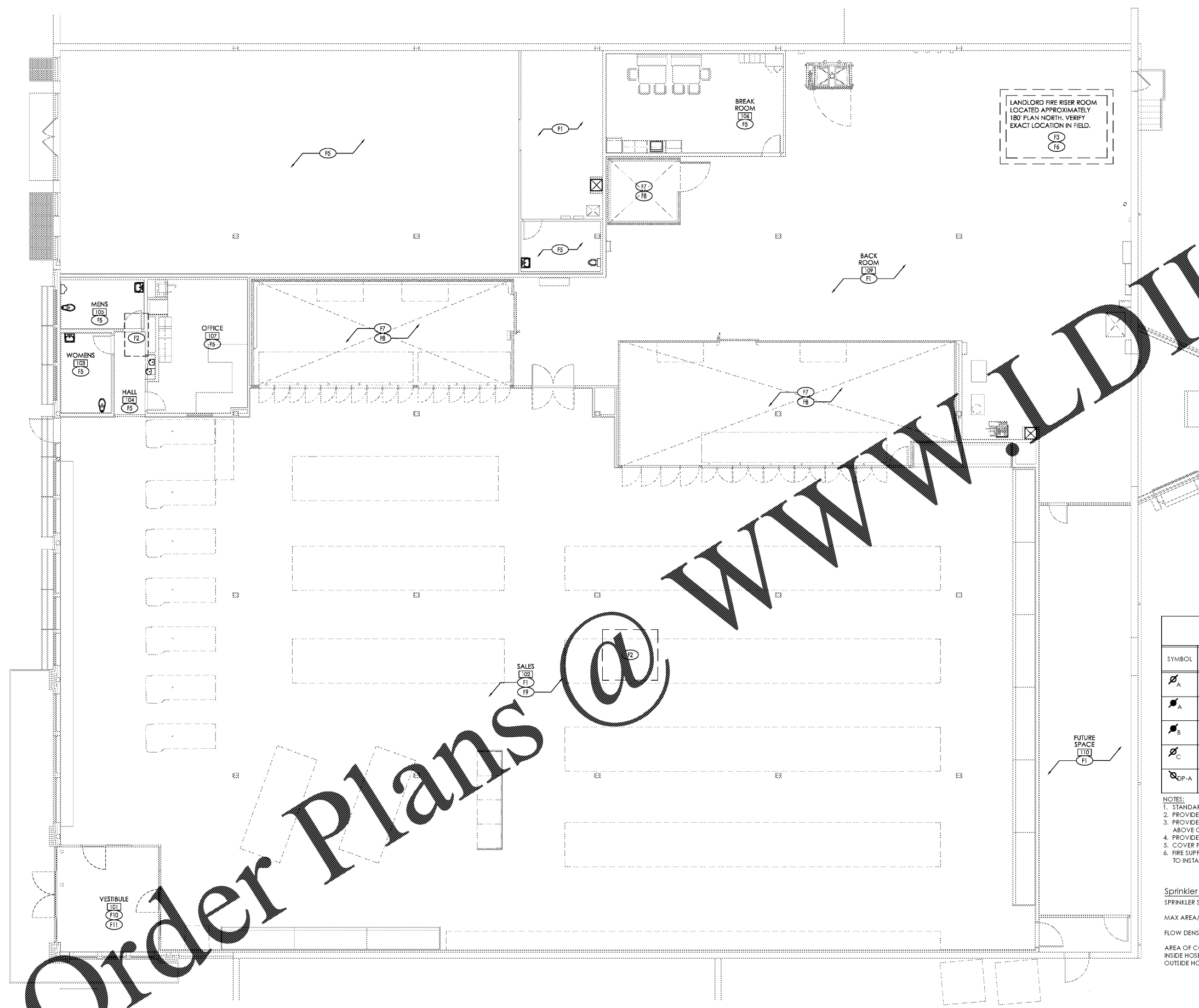

**General Fire Protection Notes:**

1. PROVIDE ALL WORK IN COMPLIANCE WITH ALL LOCAL, STATE AND FEDERAL CODES. COORDINATE ALL WORK WITH LOCAL FIRE MARSHAL.
2. SPRINKLER CONTRACTOR SHALL OBTAIN AND PAY FOR ALL STATE AND LOCAL PERMITS REQUIRED FOR HIS WORK, AND SCHEDULE ANY INSPECTIONS REQUIRED BY GOVERNING RULES AND REGULATIONS.
3. PROVIDE FULL SPRINKLER COVERAGE FOR ALL SPACES IN COMPLIANCE WITH LOCAL, STATE AND FEDERAL CODES, NFPA-13 AND OWNER'S INSURANCE CARRIER/UNDERWRITER.
4. COORDINATE FIRE PROTECTION SYSTEM WITH ALL OTHER TRADES, BUILDING CONDITIONS, ETC.
5. COORDINATE MODIFICATIONS TO EXISTING FIRE PROTECTION SYSTEM WITH LANDLORD REPRESENTATIVE.
6. PROVIDE (2) EXTRA HEADS FOR EACH TYPE OF SPRINKLER HEAD AND TEMPERATURE AND ASSOCIATED WRENCHES FOR EACH HEAD STYLE FOR SPARES. PROVIDE SURFACE MOUNTED SPRINKLER HEAD/WRENCH CABINET FOR SPARE HEADS AND WRENCHES. MOUNT HEAD CABINET WITHIN UTILITY ROOM, ADJACENT TO FIRE RISER. CABINET SHALL BE EASILY ACCESSIBLE.
7. FIRE PROTECTION CONTRACTOR SHALL TEST AND FLUSH PIPING.
8. FIRE PROTECTION CONTRACTOR SHALL BE SOLELY RESPONSIBLE FOR FINY AND ALL WORK INVOLVING THE FIRE PROTECTION SYSTEM, INCLUDING MODIFICATION OR REVISION OF THE SPRINKLER SYSTEM SERVING REFRIGERATION EQUIPMENT.
9. BASE THE HYDRAULIC CALCULATIONS FOR EXTENSION OF SYSTEM INTO NEW PORTION.
10. GC IS TO COORDINATE ALL TRADES WITH WORK IN THE CEILING SPACE FOR COORDINATION CONFLICTS BETWEEN HVAC, FIRE PROTECTION, SECURITY AND ELECTRICAL TRADES.

**Fire Protection Keyed Notes:**

- (F1) EXISTING FIRE SUPPRESSION TO REMAIN. RELOCATE ALL FIRE PROTECTION LINES TO BE TIGHT TO BOTTOM OF STEEL. MODIFY EXISTING SYSTEM AS REQUIRED TO PROVIDE ADEQUATE COVERAGE WITH UPRIGHT SPRINKLER HEADS IN THIS AREA.
- (F2) COORDINATE LOCATION OF SPRINKLER HEADS WITH RTU DUCT DROPS AND ASSOCIATED DUCT WORK AS REQUIRED TO MAINTAIN CODE REQUIRED FIRE PROTECTION COVERAGE.
- (F3) EXISTING FIRE PROTECTION RISER AND FDC LOCATED IN ADJACENT TENANT SPACE.
- (F4) PROVIDE UPRIGHT HEAD(S) ABOVE LAY-IN CEILING.
- (F5) PROVIDE PENDENT HEAD(S) IN CEILING AND/OR SOFFIT.
- (F6) IF A SHUTDOWN OF SPRINKLER EQUIPMENT IS REQUIRED PRIOR TO CEASING DAILY STORE OPERATIONS, THE FIRE PROTECTION CONTRACTOR SHALL BE RESPONSIBLE FOR PROVIDING A FIRE WATCH.
- (F7) MODIFY EXISTING SYSTEM TO PROVIDE DRY PIPE HEADS (FOR WET PIPE SYSTEMS) WITH HEAD GUARDS AND LOCATE WITHIN COOLER AND FREEZER UNITS PER NFPA-13. PROVIDE UPRIGHT WET PIPE HEADS ABOVE UNITS.
- (F8) PRIOR TO SPRINKLER ROUGH IN, COORDINATE LOCATION OF DRY PIPE HEADS WITH REFRIGERATION CONTRACTOR. ANY DRY PIPE HEAD THAT FALLS WITHIN 48" OF EVAPORATOR SHALL BE A HIGH TEMPERATURE HEAD.
- (F9) EXISTING FIRE PROTECTION LINES IN THIS AREA, INCLUDING MAINS, ARE TO BE RAISED ABOVE BOTTOM CHORD OF JOISTS.
- (F10) PROVIDE UPRIGHT HEADS ABOVE CEILING AT DECK.
- (F11) PROVIDE SIDEWALL EXTENDED COVERAGE HEADS IN SOFFIT.

**SPRINKLER HEAD SCHEDULE**

SYMBOL	DESCRIPTION	ORIFICE SIZE	K VALUE	TEMP (°F)	FINISH	NOTES
⊘A	PENDANT - TYCO TY-FRB (TY3231), OR APPROVED EQUAL	1/2"	5.60	155	WHITE	1,2,3,6
⊘A	UPRIGHT - TYCO TY-FRB (TY3131), OR APPROVED EQUAL	1/2"	5.60	155	CHROME	1,6
⊘B	UPRIGHT - TYCO TY-FRB (TY3131), OR APPROVED EQUAL	1/2"	5.60	200	CHROME	1,6
⊘C	CONCEALED PENDANT - TYCO RFI (TY3531), OR EQUAL	1/2"	5.60	155	MATCH CLG	1,3,5,6
⊘DP-A	PENDANT DRY HEAD- DS-1 (TY3255), OR EQUAL	1/2"	5.60	155	CHROME	1,4,6

- NOTES:
1. STANDARD RESPONSE
  2. PROVIDE RECESSED ESCUTCHEON (FINISH: WHITE)
  3. PROVIDE 1" STAINLESS STEEL CORRUGATED FLEXIBLE TUBING TO PENDANT SPRINKLER HEAD ABOVE CEILINGS.
  4. PROVIDE SPRINKLER HEAD GUARD.
  5. COVER PLATE SHALL MATCH SURROUNDING CEILING COLOR.
  6. FIRE SUPPRESSION SHOP DRAWINGS FOR BE REVIEWED BY ARCHITECT AND ENGINEER PRIOR TO INSTALLATION

**Sprinkler System Information**  
 SPRINKLER SYSTEM TYPE: Wet-Pipe  
 MAX AREA / SPRINKLER: 130 SQ.FT.  
 FLOW DENSITY: 0.2 GPM/SQ.FT.  
 AREA OF COVERAGE: 1,500 SQ.FT.  
 INSIDE HOSE DEMAND: N/A  
 OUTSIDE HOSE DEMAND: 250 GPM

**Building Sprinkler Information**  
 OWNER: ALDI, Inc.  
 1985 Old Union Church Road  
 Salisbury, NC 28146  
 LOCATION: Aldi - Inc.  
 1315 Kildaire Farm Rd.  
 Cary, NC 27511  
 OCCUPANCY: Mercantile  
 HAZARD CLASSIFICATION: Store - Ordinary Hazard Group 2

**Water Supply Information:**  
 FIRE PROTECTION CONTRACTOR IS RESPONSIBLE FOR OBTAINING HYDRANT FLOW TEST DATA FOR HYDRAULIC CALCULATIONS

Issued:	Date:
A Client Review Set	02/15/19
B Bid Set	03/08/19
C	
D	
Revisions:	Date:
1	
2	
3	
4	
5	
6	
7	
8	

**DO NOT SCALE PLANS**  
 Copying, Printing, Software and other processes required to produce these prints can stretch or shrink the actual paper or layout. Therefore, scaling of this drawing may be inaccurate. Contact us consultants with any need for additional dimensions or clarifications.

**ms consultants, inc.**  
 engineers, architects, planners  
 920 Main Campus Drive  
 Suite 430  
 Raleigh, NC 27606-5213  
 (919)-772-5565  
 fax: (919)-779-2308

DRAWN BY: JMM

REVIEWED BY: KFF

Seal

ENGINEER FIRM LICENSE #C-3239  
 PROFESSIONAL OF RECORD:  
 DANIEL E. DOWLER No. 042448  
 EXP. DATE: 12/31/2019

**ALDI Inc.**  
 1985 Old Union Church Road  
 Salisbury, NC 28146  
 (704) 642-0023  
 (704) 642-0079 fax

**ALDI Inc. Store #: 59**  
 Cary, NC  
 1315 Kildaire Farm Rd  
 Cary, NC 27511  
 Wake County  
 Project Name & Location:

<b>Fire Protection Floor Plan</b>	
Drawing Name:	
Prototype Rls.	Project No.
Type: v7.1	40452-25
	FP-101
Scale: As Noted	Drawing No.

Order Plans @ WWW.LDDILLING.COM

D1 Fire Protection Floor Plan  
 SCALE: 1/8" = 1'-0"  
 PLAN NORTH