



**PROJECT: FIVE GUYS BURGERS & FRIES**  
**630 CRANE CREEK DRIVE**  
**AUGUSTA, GA, 30907**  
**DRAWING: ELECTRICAL POWER PLAN + SCHEDULES**

Revisions
REVISION DATE

PROJECT DATE: 12.3.18  
Drawn By: JP  
Checked By: CIT  
Sheet No. **E101**

### CONSTRUCTION NOTES

- 11 EXISTING JUNCTION BOX PROVIDED UNDER SHELL. E.C. SHALL EXTEND TO EXTERIOR SIGN LOCATION AS REQUIRED. VERIFY EQUIPMENT PROVIDED HAS LOCAL DISCONNECTING MEANS OR PROVIDE LOCKABLE BREAKER PER NEC 600.6. COORDINATE FINAL SIGN LOCATIONS WITH SIGN VENDOR AND OWNER.
- 12 ELECTRICAL PANELS. E.C. SHALL PROVIDE TYPE-WRITTEN SCHEDULE AFTER WORK IS COMPLETE. PROVIDE PANEL COVERS FOR RECESSED INSTALLATION. PROVIDE LOCK AND KEY FOR PANEL DOOR.
- 13 RESTROOM EXHAUST FANS TO BE SWITCHED WITH RESTROOM LIGHTING. SEE SHEETS E201 AND E301.
- 14 PROVIDE J-BOX FOR GAS WATER HEATER. MAKE FINAL LIQUID TIGHT CONNECTION TO UNIT. VERIFY MOUNTING HEIGHT WITH PLUMBING CONTRACTOR.
- 15 J-BOX FOR WIRING COOLER DOOR HEATER AND LIGHTS. ALL CONDUITS ENTERING COOLER SHALL BE INSTALLED WITH RISER AND FITTINGS IN ACCORDANCE WITH NEC 300.7. DOOR HEATER, LIGHTS AND LIGHT SWITCH FURNISHED BY OTHERS.
- 16 UP TO CONDENSER LOCATED ON TOP OF WALK IN COOLER. COORDINATE WITH REFRIGERATION CONTRACTOR.
- 17 PROVIDE 120V/1P-20A, NF, SAFETY DISCONNECT SWITCH FOR UNIT COOLER AIR DEHUMID EVAPORATOR/COILS W/ REFRIGERATION CONTRACTOR.
- 18 SHOW WINDOW RECEPTACLES TO BE MOUNTED ABOVE SHOW WINDOW. COORDINATE LOCATION OF RECEPTACLES AND COVER PLATES WITH ARCHITECT. CONTROLLED VIA SWITCH "K" IN SWITCH BANK. SEE DETAIL 2/E401 FOR MORE INFORMATION.
- 19 PROVIDE OUTLET IN CEILING FOR ETHERNET SERVICE. COORDINATE EXACT LOCATION AND REQUIREMENTS WITH OWNER PRIOR TO ROUGH-IN.
- 20 INSTALL RECEPTACLE TO COKE FREESTYLE BEVERAGE AND DRINK DISPENSER.
- 21 PROVIDE 3/4" PLYWOOD BLOCKING FOR EQUIPMENT INSTALLATION. SEE MUSIC SYSTEM PLANS BY OTHERS FOR MORE INFORMATION.
- 22 PROVIDE OUTLET FOR ETHERNET SERVICE FOR COKE FREESTYLE MACHINE.
- 23 PROVIDE J-BOX FOR REIRC. PUMP LOCATED ABOVE CEILING. COORDINATE W/ P.C. FOR EXACT LOCATION AND REQUIREMENTS.
- 24 PROVIDE RMC CONDUIT FOR TELEPHONE FROM P.O.S. GROUPING TO NEAREST AVAILABLE WALL THEN ABOVE CEILING TO PUNCH DOWN BLOCK AT MANAGER'S DESK WALL. ALSO SEE CONSTRUCTION NOTE 16 THIS SHEET.
- 25 PROVIDE 1-1/4" RMC CONDUIT FOR DATA TO BE RUN FROM P.O.S. GROUPING TO NEAREST AVAILABLE WALL. THEN ABOVE CEILING TO PUNCH DOWN BLOCK BEHIND SERVER AT THE MANAGER'S DESK WALL.
- 26 PROVIDE PHONE BOARD PUNCH DOWN BLOCK - INSTALLED ABOVE THE LAY-IN CEILING. E.C. SHALL PROVIDE #6 BARE COPPER WIRE TO TELEPHONE BOARD.
- 27 REFER TO KEY PLAN 3/E101, THIS SHEET AND SHELL BUILDING DRAWINGS FOR ACTUAL LOCATION OF ELECTRICAL SERVICE.
- 28 REFER TO "MANAGER'S RACK ELEVATION" DETAIL ON SHEET E501.
- 29 REFER TO "DRESSING TABLE WALL DATA" DETAIL ON SHEET E501.
- 30 REFER TO "POS TERMINAL DATA" DETAIL ON SHEET E501.
- 31 REFER TO "MILKSHAKE DATA" DETAIL ON SHEET E501.
- 32 SECURITY CAMERAS INCLUDE 8 BOXES FOR FUTURE SECURITY CAMERAS AND 1" CONDUITS TO MANAGER'S DESK. LOCATION SHALL BE DETERMINED BY SECURITY CONTRACTOR PRIOR TO ROUGH-IN.
- 33 BOX TO BE INSTALLED FOR SPEAKER CONNECTION. COORDINATE EXACT NUMBER AND LOCATION WITH MUSIC SYSTEM VENDOR.
- 34 3/4" EMPTY CONDUIT WITH PULL-STRING FOR SPEAKER WIRING TO MANAGER'S DESK AREA.
- 35 BOX FOR MICROPHONE STATION TO BE INSTALLED AT 6" BELOW COUNTER TOP. COORDINATE EXACT REQUIREMENTS AND LOCATION WITH MANUFACTURER OF EQUIPMENT.
- 36 3/4" EMPTY CONDUIT WITH PULL STRING TO FULL HEIGHT WALL AND UP ABOVE CEILING TO MANAGER'S DESK AREA. USE FMC CONDUIT THRU THE COUNTER AREA AND EMT ELSEWHERE.
- 37 PROVIDE (1) 2-GANG J-BOX WITH (2) 1" CONDUIT WITH PULL-STRING TO 6" ABOVE CEILING FOR AUDIO WIRE AND SPEAKER WIRES.
- 38 PROVIDE DATA PORT BEHIND MUSIC EQUIPMENT RACK TO BE RUN TO DATA PORT AT MANAGER'S DESK AREA. SEE ELEVATION DETAIL 6/E501 FOR MORE INFORMATION.
- 39 ALL PENETRATIONS OF 1-HOUR RATED DEMISING WALL SHALL BE SEALED WITH APPROPRIATE 1-HOUR RATED FIRE STOP MATERIAL AND METHODS. PROVIDE A 24" MINIMUM HORIZONTAL SEPARATION BETWEEN OUTLET BOXES INSTALLED ON OPPOSITE SIDES OF WALL PER NEC 300.21. E.C. SHALL VERIFY OPPOSITE SIDE CONDITIONS PRIOR TO ROUGH IN. CONTACT LOCAL FIRE MARSHAL IF CLEARANCE CANNOT BE MAINTAINED. CONTACT ENGINEER IF FIRE MARSHAL WILL NOT GRANT VARIANCE. SEE UL DETAILS AT 2/E401.
- 40 PROVIDE 1-1/4" RMC CONDUIT FOR TELEPHONE FROM NEW PHONE LOCATION SEE DETAIL ON SHEET E501 THEN ABOVE CEILING TO PUNCH DOWN BLOCK AT MANAGER'S DESK WALL. ALSO SEE CONSTRUCTION NOTE 16 THIS SHEET.
- 41 E.C. SHALL PROVIDE RECEPTACLE AT 72" AFF FOR GREASE HEAT TAPE. SEE HOOD SHEETS H401 FOR MORE INFORMATION. HEAT TAPE IS PROVIDED BY HOOD SUPPLIER AND INSTALLED BY E.C. COORDINATE WITH PLUMBING CONTRACTOR FOR EXACT ROUTING OF GREASE DRAIN PIPE.
- 42 MOUNT RECEPTACLE FOR BUG LIGHT AT 84" A.F.F.
- 43 E.C. SHALL PROVIDE 3/4" CONDUIT WITH PULL-STRING STUBBED UP TO 6" ABOVE FINISHED CEILING FOR DATA LINE.
- 44 PROVIDE J-BOX FOR "FIVE GUYS" WALL SIGN. E.C. SHALL COORDINATE EXACT POWER REQUIREMENTS AND LOCATION WITH SIGN CONTRACTOR. SIGN SHALL BE CONTROLLED VIA SWITCH "P" IN SWITCH BANK. SEE DETAIL 2/E201 FOR MORE INFORMATION.

### GENERAL NOTES

- 1. E.C. SHALL PROVIDE GFI BREAKERS FOR ALL SINGLE PHASE RECEPTACLES RATED 150 VOLTS TO GROUND OR LESS, 50A OR LESS. FOR THREE PHASE RECEPTACLES RATED 150 VOLTS TO GROUND OR LESS, 100A OR LESS IN THE KITCHEN AND SERVING AREAS TO COMPLY WITH NEC 210.8.B.2. E.C. SHALL NOT USE GFI OUTLETS, UNLESS OTHERWISE NOTED. COORDINATE WITH PANEL SCHEDULES.
- 2. ALL CONDUITS SHALL BE CONCEALED WITHIN WALLS OR MILLWORK, UNLESS NOTED OTHERWISE.
- 3. ALL COVER PLATES IN PREP AREA, BACKROOM AND RESTROOMS SHALL BE STAINLESS STEEL WITH WHITE DEVICES. IN DINING AREA DEVICES AND COVER PLATES SHALL MATCH COLOR OF SURROUNDING SURFACES.
- 4. TELEPHONE BOARD/PUNCHDOWN BLOCK SHALL BE MOUNTED ABOVE THE CEILING ABOVE MANAGER'S DESK IN WORK ROOM, NOT EXPOSED TO PUBLIC.
- 5. ALL TELEPHONE AND DATA CABLE SHALL BE RUN ABOVE CEILING AND IN CONDUIT IN WALLS TO BE CONCEALED FROM VIEW.
- 6. ALL DATA CABLES SHALL TERMINATE ON RJ45 CATEGORY 5e EIA/EIA 568-B RJ45 STANDARDS.
- 7. ALL DATA CABLE HOMERUNS SHALL TERMINATE ON CATEGORY 5e EIA/EIA 568-B RJ45 PATCH PANELS AT THE NETWORK CABINET.
- 8. ALL CABLES SHALL BE CONTINUITY TESTED FOR POLARITY AND CORRECT PIN CONFIGURATION AND MACHINE LABELED.
- 9. PROVIDE SEPARATE 3/4" RIGID METALLIC (RMC) CONDUIT FOR TELEPHONE AND DATA P.O.S. GROUPING, UNLESS NOTED OTHERWISE.
- 10. NO FLEXIBLE CONDUIT SHALL BE USED EXCEPT AS SPECIFICALLY NOTED ON DRAWINGS.
- 11. ALL DEVICES REQUIRED TO BE ADA ACCESSIBLE SHALL BE INSTALLED PER ANSI A117.1.
- 12. E.C. SHALL PROVIDE OWNER/FRANCHISEE WITH COMPLETE SET OF ELECTRICAL AS-BUILT DRAWINGS SHOWING ALL DEVIATIONS FROM ORIGINAL DESIGN WITHIN 30 DAYS OF ACCEPTANCE.
- 13. E.C. SHALL PROVIDE OWNER/FRANCHISEE WITH OPERATIONS & MAINTENANCE MANUAL(S) FOR ALL ELECTRICAL SYSTEMS AND EQUIPMENT WITHIN 30 DAYS OF ACCEPTANCE.

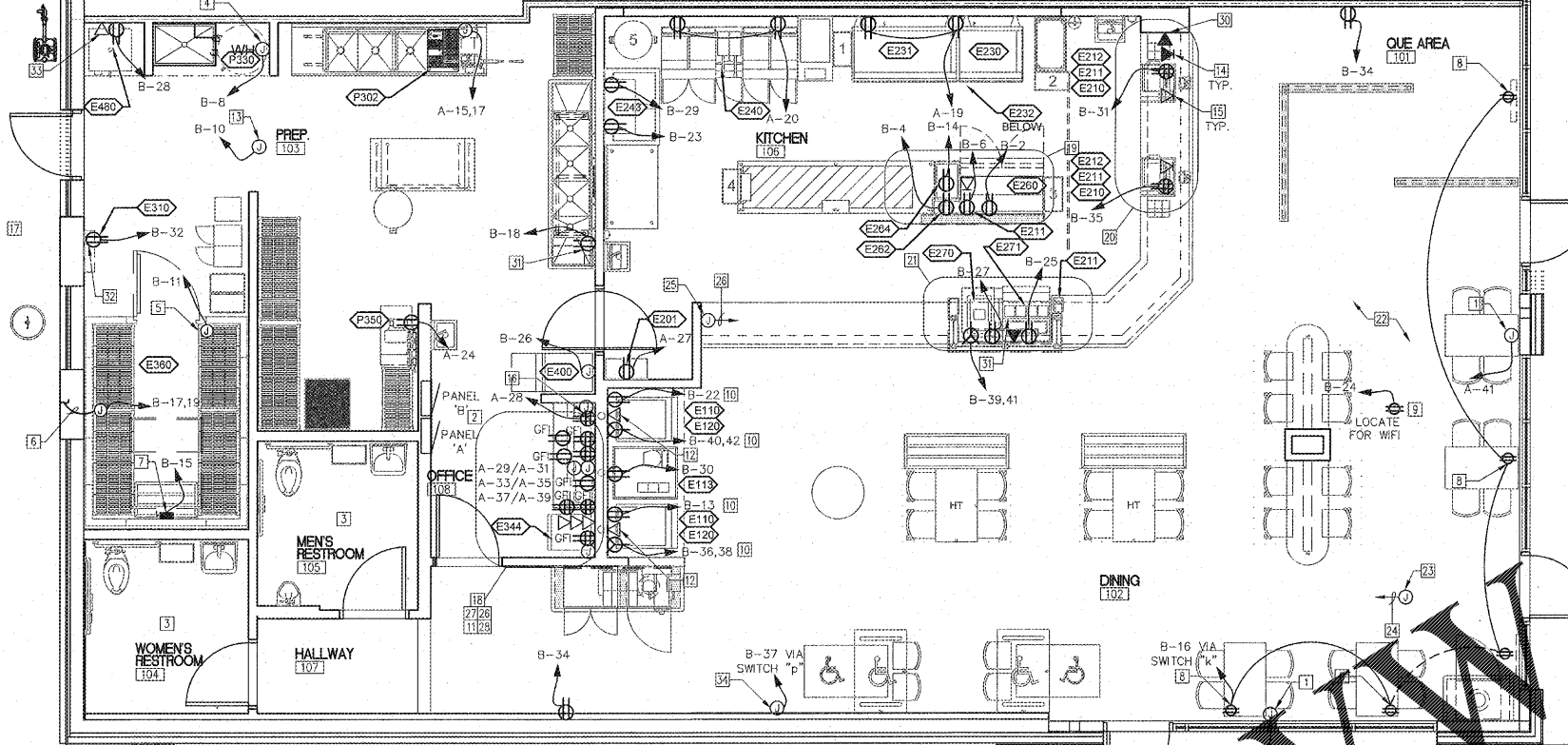

**1 POWER PLAN**  
**E101** SCALE: 1/4" = 1'-0"

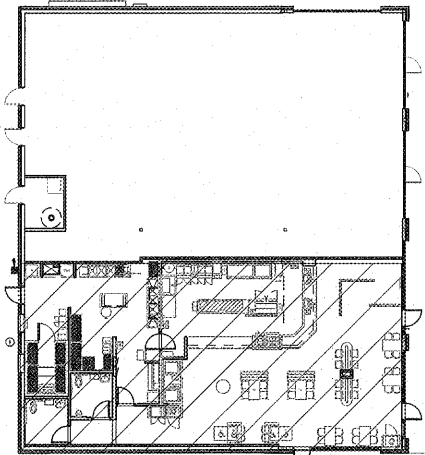

**3 KEY PLAN**  
**E101** SCALE: N.T.S.

NO.	QTY.	DESCRIPTION	SUPP. BY	MANUFACTURER	MODEL	VOLTAG.	PH.	AMP.	WVA	COLLECTION	REMARKS
E110	2	FREESTYLE SODA DISPENSER	GC	COCA-COLA	FREESTYLE	110	1	2	PLUG	BY COKE	BY COKE
E113	1	TEA DISPENSER (DOLD PEAK - VTY)	V	COCA-COLA	VARIABLE	120	1	2	PLUG	BY COKE	STANDARD TEA DISPENSER
E200	2	ICE MACHINE	GC	HOSHIZAKI	55MAH	208-230	1	7.5	PLUG	FOR FREESTYLE INSTALLATION. INSTALL ICE CONTROL EXTENSION BRACKET 3" BELOW TOP OF FREESTYLE	
E201	1	TOUCH-LOCK	GC	MBA TECHNOLOGY	184DC	120	1	1	PLUG	PROVIDE OUTLET FOR DOCKING STATION	
E210	2	P.O.S.	GC	PAR TECH		120	1	1	PLUG		
E211	4	TICKET PRINTER	GC	PAR TECH		120	1	1	PLUG		
E212	2	P.O.S. PED.	GC	VERIFONE	MAP	120	1	1.5A	PLUG		
E220	1	SHRDLDE 30"	GC	MAGKITCHN	F-3-MK2	120	1	1.3A	PLUG	INSTALL 6" STANDOFF BRACKET	
E231	1	SHRDLDE 60"	GC	MAGKITCHN	F-6-MK2	120	1	1.3A	PLUG	INSTALL 6" STANDOFF BRACKET	
E232	1	CHEF BASE	GC	SILVER KING	SKRKB07H	120	1	3.1A	PLUG	UNDER 30" AND 60" GRIDDOLES	
E400	1	GAS FRYER	GC	PITCO	PG-B9H50FF	120	1	8.2A	(2) PLUG	TWO SEPARATE DEDICATED OUTLETS	
E403	1	COOKED FRY STATION	GC	MARSHALL AIR SYSTEMS	145-488	(2) 120	1	(2) 9A	(2) PLUG	TWO SEPARATE DEDICATED OUTLETS	
E404	1	DRESSING TABLE	GC	SILVER KING	SKR4812	115	1	4.3A	PLUG	REFRIGERATED PREP TABLE	
E405	1	SANDWICH WRAP TABLE 120"	GC	MARSHALL AIR SYSTEMS, INC.	152398	120	1	2.2A	PLUG	18"x20" WARMER SHELF ON SIDE	
E204	1	COUNTERTOP WARMER	GC	BEAUX	6055A	120	1	1.5A	PLUG		
E270	1	GRAVITY SHAKE FREEZER W BASE CAB.	GC	SILVER KING	SKF200	208/230	1	12.6A	PLUG	ORDER W 27-1/2" H BASE CAB. FRONT MOUNT SHAKE MIXER. SPLASH GUARD & TOP AIR DISCHARGE CHUTE	
E271	1	MILKSHAKE FOAMER/TAPETTE	GC	SILVER KING	SKF2A/GS	115	1	3.6A	PLUG	ORDER WITH CASTER KIT	
E310	1	BUG LIGHT	GC	DODGE		120	1		PLUG		
E344	1	DATA CABINET	GC			120	1		PLUG	42 U DATA CABINET X 24" DEEP BLACK. VERIFY EXACT SPEC / ACCESSORIES WITH FGO. COORDINATE DATA AND POWER REQUIREMENTS BEHIND RACK.	
E500	1	WALK-IN COOLER	GC	BRUNNEN STAINLESS	FG-100	208	1	17.5A	PLUG	22" HIGH DIAMOND PLATE OR ALL EXPOSED SURFACES & 48" INTERIOR FLOOR LIGHT. SEE ENGINEERING DIVISION FOR LOCATION OF EVAPORATOR COIL AND CONDENSER. 8'-0" TOTAL HEIGHT 10'-1" MIN CLG HEIGHT. BLASTOPROOF INSULATION MEETS UL SUBJECT 725 / ASTM E54 FLAME SPREAD INDEX 25, E-84 SMOKE-DEVELOPED INDEX 450	
E501	1	WALK-IN FREEZER	GC	BRUNNEN STAINLESS	W110H68	208-230	1	12.4A	PLUG	HARDWARE	
E502	1	ICE MAKER	GC	HOSHIZAKI	KM451M3H	115	1	8.7A	HARDWARE		
E503	1	DEL. REFRIG. SYS. - 2 TON	GC	BRUNNEN	207524N4	110	1	3.5A	PLUG	SEE MANUF. INSTALLATION SPECS	
E504	1	COFFIN - COCA-COLA VTY SINK	GC	BRUNNEN	PE5478-LV/R (OUTTER SIDE)	208	1	9.2A	HARDWARE	POOD PREP. CAULK TO PARTITION	
E505	1	WATER HEAT. 40 GAL	GC	BRADFORD WHITE	EF-60T-109E-3NA	120	1		HARDWARE	NEEDS 24" CLEAR ABOVE FOR MAINTENANCE	
E506	1	WATER BOOBS	GC	MCCANN	18-2172	115	1	7A	PLUG		

**2 ELECTRICAL EQUIPMENT**  
**E101** SCALE: NTS