

Order Plans @ WWW.DIMMING.COM

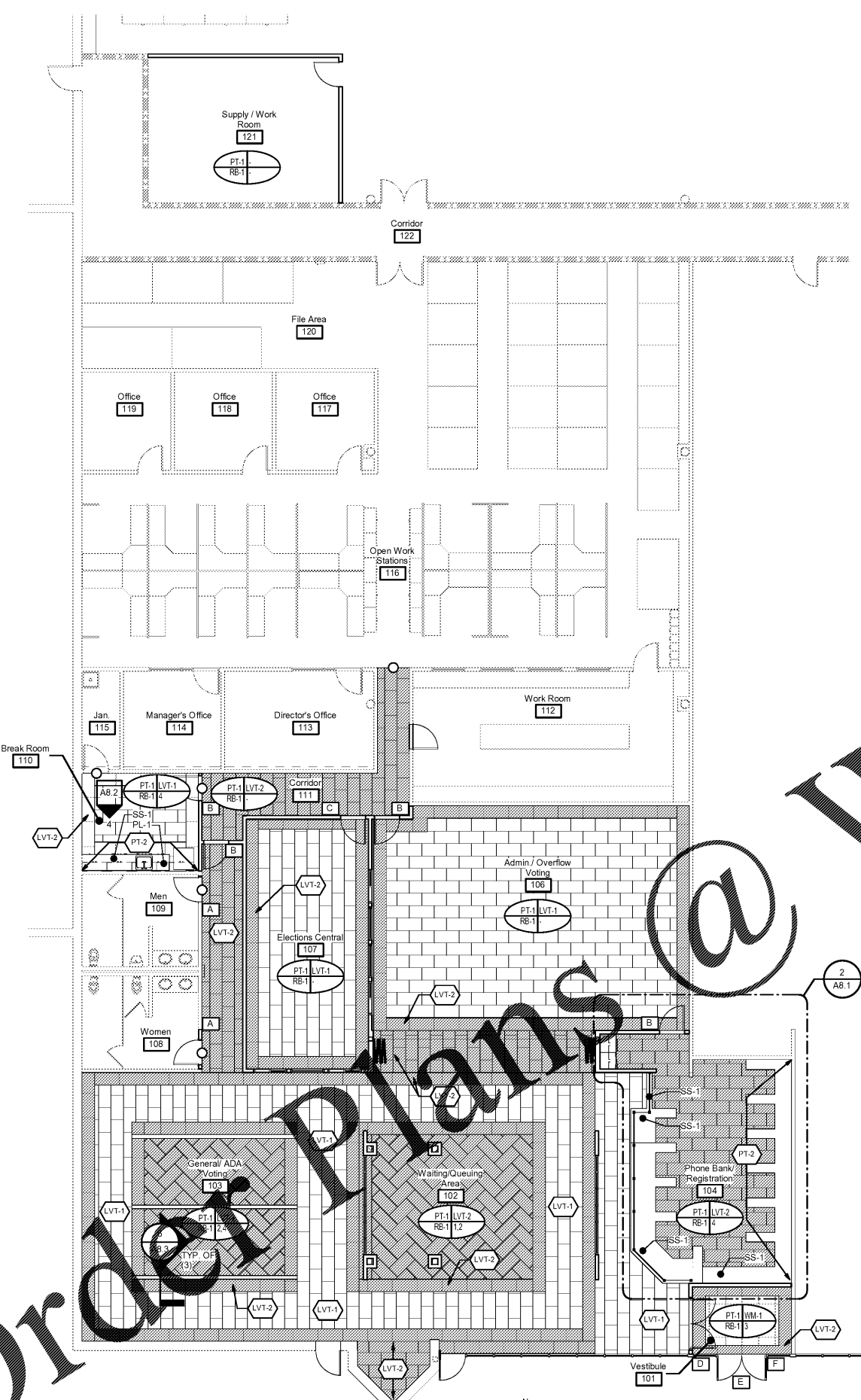

1 Finish Plan  
 A8.1 1/8" = 1'-0"

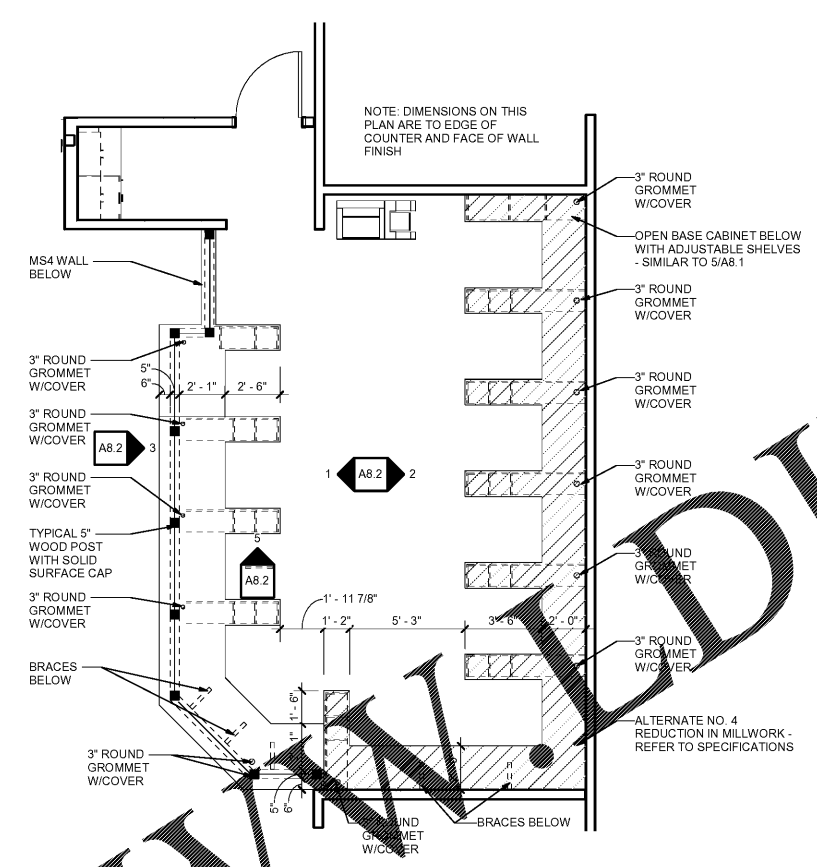

2 Enlarged Millwork Plan  
 A8.1 1/2" = 1'-0"

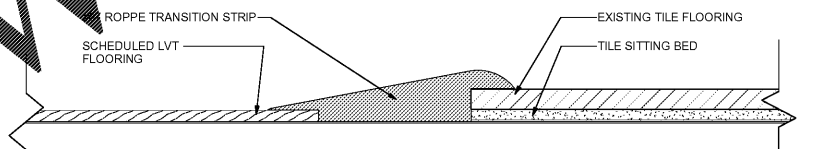

3 LVT to Existing Tile Transition Detail  
 A8.1 1/2" = 1'-0"

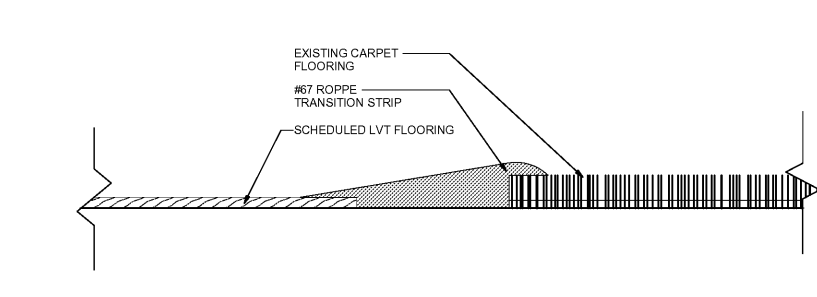

4 LVT to Existing and New Carpet Transition Detail  
 A8.1 1/2" = 1'-0"

**Finish Plan General Notes**

- ALL INTERIOR FINISH SPECIFICATIONS ARE INCLUDED HEREIN OR IN THE ATTACHED SPECIFICATIONS. IF APPLICABLE, DISCREPANCIES, OMISSIONS, AND DISCONTINUED OR DELAYED MATERIALS ARE TO BE REPORTED TO THE ARCHITECT IMMEDIATELY FOR RESOLUTION PRIOR TO PROCEEDING. THE ARCHITECT IS NOT RESPONSIBLE FOR DISCREPANCIES OR OMISSIONS THAT ARISE DUE TO CHANGES BY ANOTHER PARTY AFTER ORIGINAL DRAWING ISSUANCE DATE UNLESS RECORDED AS A REVISION BY THE ARCHITECT.
- CONTRACTOR SHALL SUBMIT THE FOLLOWING ITEMS TO THE ARCHITECT FOR REVIEW AND APPROVAL PRIOR TO FABRICATION OF THE SEAL -  
 - COMPLETE SHOP DRAWINGS AND DETAILS  
 - COLOR SAMPLES
- SUBMIT SAMPLES OF ALL FINISH MATERIALS TO THE ARCHITECT FOR APPROVAL PRIOR TO ORDERING MATERIALS AND COMMENCING WORK. SUBMIT ACTUAL COLOR AND FINISH OF PAINT ON 6-1/2" X 11" SIZE SAMPLES. WALL COVERING SAMPLES SHALL BE CUT FROM THE ACTUAL ROLL TO BE USED FOR THE INSTALLATION. SAMPLES OF NATURAL STONE OR OTHER MATERIALS WITH WIDE COLOR VARIATIONS SHALL COME FROM THE ACTUAL MATERIAL TO BE REFERRED TO SPECIFICATIONS FOR PAINT MOCK-UP REQUIREMENTS.
- SUBSTITUTIONS OF FINISH MATERIALS SHALL BE SUBMITTED IN WRITTEN FORM AND ACTUAL SAMPLES PROVIDED FOR REVIEW BY ARCHITECT AND OWNER. CONTRACTOR SHALL OBTAIN AN APPROVAL SIGNATURE BEFORE PROCEEDING. REVIEW OF SUBSTITUTIONS IS TO CONFORM WITH THE ORIGINAL SCHEDULE OR BUDGET MAY BE CONSIDERED AN ADDITIONAL SERVICE.
- INSTALL FINISH MATERIALS ACCORDING TO MANUFACTURER'S WRITTEN INSTRUCTIONS.
- ONLY ONE DIRECTION OF FINISH STYLE AND COLOR SPECIFIED IN THE FINISH SCHEDULE SHALL BE USED.
- REMOVE FINISH MATERIALS FROM PACKAGING AND ALLOW TO ACCLIMATE TO AREA OF INSTALLATION ACCORDING TO MANUFACTURER'S INSTRUCTIONS. ALL SURFACES WHICH ARE TO RECEIVE A FINISH APPLICATION SHALL BE COMPLETELY SMOOTH AS SUITABLE FOR SCHEDULED FINISH MATERIAL. REPAIR EXISTING CONDITIONS AS REQUIRED.
- ALL MISCELLANEOUS GRILLS, PLATES, ETC. OCCURRING ON WALLS OR CEILINGS ARE TO BE FINISHED TO MATCH WALL OR CEILING ON WHICH THEY OCCUR. CONSULT ARCHITECT ON FINAL FINISH.
- ALL PAINT SURFACES ARE TO RECEIVE ONE PRIME COAT AND A MINIMUM OF TWO FINISH COATS. APPLY ADDITIONAL COATS OF PRIME AND FINISH COATS REQUIRED UNTIL EXISTING UNDERCOATS OR OTHER CONDITIONS ARE FULLY CONCEALED AND PAINT FILM IS OF UNIFORM FINISH, COLOR, AND APPEARANCE.
- PRIOR TO FLOORING INSTALLATIONS, PERFORM A CALCIUM CHLORIDE MOISTURE TEST TO ENSURE MOISTURE CONTENT MEETS MANUFACTURER'S ACCEPTABLE LEVELS. CONTRACTOR TO DOCUMENT AND MAINTAIN RECORDS.
- INSTALL CARPET USING A DIRECT GLUE APPLICATION WITH ALL NAP RUNNING IN THE SAME DIRECTION, UNLESS NOTED OTHERWISE.
- CARPET SEAMS WILL BE BUTT JOINTED. NO TWO (2) SEAMS SHALL MEET. SUBMIT A CARPET SEAMING DIAGRAM TO THE ARCHITECT FOR APPROVAL PRIOR TO COMMENCING WORK.
- FLOORING TRANSITIONS WILL OCCUR UNDER CENTERLINE OF DOOR IN CLOSED POSITION, UNLESS NOTED OTHERWISE.
- WHERE FLOORING MATERIALS OF DIFFERING THICKNESS MEET, LEVEL AS REQUIRED TO MEET ADA GUIDELINES AND ENSURE SMOOTH TRANSITION.
- PAINT FIRE EXTINGUISHER CABINETS SEMI-GLOSS TO MATCH WALL FINISH.
- BASE CABINET PLASTIC LAMINATE TOE KICKS TO MATCH CORRESPONDING BASE CABINET PLASTIC LAMINATE SPECIFICATION, UNLESS NOTED OTHERWISE.
- ALL FLOOR FINISHES SHALL HAVE A STATIC COEFFICIENT OF FRICTION > 0.6 WHEN WET PER ADA STANDARDS FOR ACCESSIBLE DESIGN.

**Interior Finish Legend**

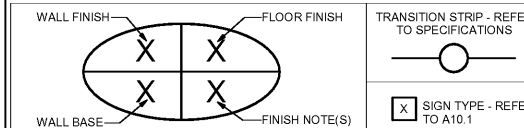

WALL FINISHES:		FLOOR FINISHES:	
PT-1	MANUFACTURER: SHERWIN WILLIAMS COLOR: SW 7070 SITE WHITE FINISH: SATIN	LVT-1	MANUFACTURER: MOHAWK GROUP STYLE: HIT THE MARK COLOR: ACCOMPLISH 721 SIZE: 18"x36"
PT-2	MANUFACTURER: SHERWIN WILLIAMS COLOR: SW 6473 SURF GREEN FINISH: SATIN	LVT-2	MANUFACTURER: MOHAWK GROUP STYLE: HIT THE MARK COLOR: ONLINE 946 SIZE: 18"x36"
PT-3	MANUFACTURER: SHERWIN WILLIAMS COLOR: CEILING BRIGHT WHITE FINISH: EGGSHELL	WM-1	MANUFACTURER: MOHAWK GROUP STYLE: TUFF STUFF II COLOR: STEP UP II - IRON ORE 983 SIZE: 24" x 24"
PT-4	MANUFACTURER: SHERWIN WILLIAMS COLOR: SW 2735 ROCKWEED FINISH: SATIN	<b>BASE FINISHES:</b>	
EPT-1	MANUFACTURER: SHERWIN WILLIAMS COLOR: T.B.D. FINISH: SEMIGLOSS	RB-1	MANUFACTURER: ROPPE COLOR: 147 LIGHT BROWN
EPT-2	MANUFACTURER: SHERWIN WILLIAMS COLOR: T.B.D. FINISH: SEMIGLOSS	<b>PLASTIC LAMINATE:</b>	
EPT-3	MANUFACTURER: SHERWIN WILLIAMS COLOR: T.B.D. FINISH: SEMIGLOSS	PL-1	MANUFACTURER: WILSONART COLOR: MANGALORE MANGO 7984-38
EPT-4	MANUFACTURER: SHERWIN WILLIAMS COLOR: T.B.D. FINISH: SEMIGLOSS	SS-1	MANUFACTURER: WILSONART COLOR: NORTHERN MELANGE
		SS-2	MANUFACTURER: WILSONART COLOR: SIENNA RIVERSTONE

- INTERIOR FINISH NOTES:**
- PAINT ALL COLUMN FURRING WALLS PT-2
  - LVT-1 SHALL BE IN HERRINGBONE PATTERN WITH ONE LVT-1 TILE BORDER. REFER TO PLAN FOR LOCATIONS.
  - WALK-OFF MAT WM-1 TO BE INSTALLED INSIDE LVT-2 BORDER.
  - PAINT ALL GYPSUM SOFFITS AND BULKHEADS PT-3.

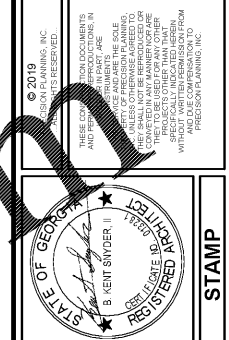

**PRECISION Planning Inc.**  
 planners • engineers • architects • surveyors  
 400 Pike Boulevard,  
 Lawrenceville, GA 30046  
 770.338.6000 • www.ppi.us

**GWINNETT COUNTY  
 VOTER REG. AND  
 ELEC. RENOVATION**  
 455 Grayson Hwy  
 Lawrenceville, GA 30046

NEW FINISH PLAN AND DETAILS

Date	No.	Description
02-13-19	RELEASED FOR BID	

02-13-19	A16-137AGSB	PROJ. NUMBER	XXX.rvt	FILE NAME	FILE NUMBER
----------	-------------	--------------	---------	-----------	-------------

A8.1