

Order Plans

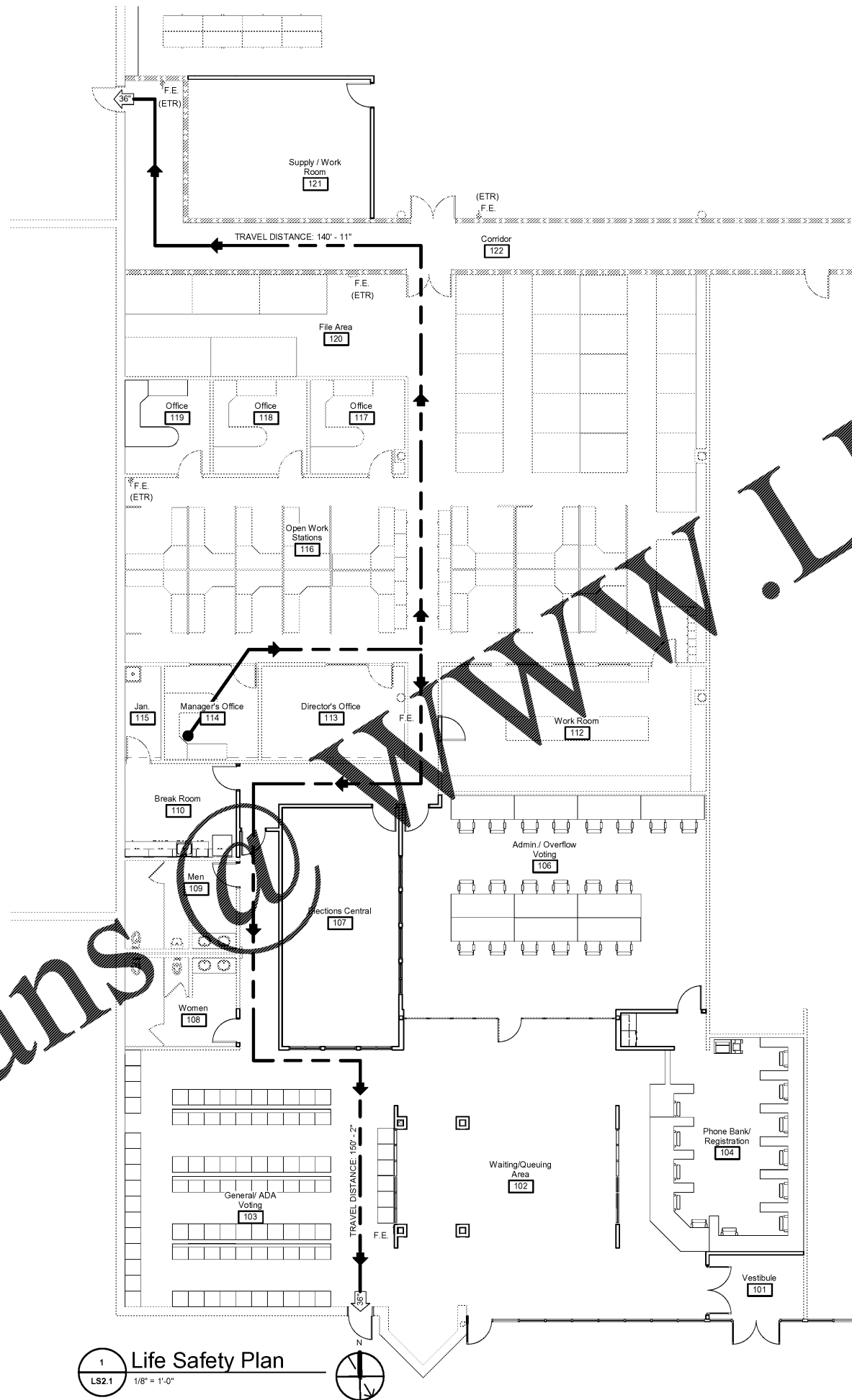

1 Life Safety Plan  
 LS2.1 1/8" = 1'-0"

### Life Safety Legend and Notes

**NOTES:**  
 1. REFER TO FIRE-RATED ASSEMBLY LEGEND ON THIS SHEET AND REFERENCE FLOOR PLANS FOR PARTITION ASSEMBLY AND FIRE RATING REQUIREMENTS.  
 2. CONTRACTOR SHALL EXAMINER IDENTIFY ALL FIRE-RESISTANT RATED WALLS (AND CORRELATING FIRE RESISTANCE RATING) INCLUDE FIRE BARRIER WALLS, SMOKE BARRIER WALLS, FIRE PARTITIONS, FIRE WALLS AND SHAFT ENCLOSURES EITHER BY INSTALLING SIGNAGE OR BY STENCILING IN CONCEALED SPACES THE FOLLOWING: (1) HOUR FIRE AND SMOKE BARRIER PROTECT ALL OPENINGS IDENTIFICATION SHALL BE SPACED NO MORE THAN TWELVE (12) FEET ON CENTER WITH A MINIMUM LETTER SIZE OF TWO (2) INCHES IN HEIGHT ON A CONTRASTING BACKGROUND.  
 3. THE PARTITION HATCH PATTERNS INDICATED ON THIS SHEET APPLY ONLY TO THIS SHEET.  
 4. REFER TO DOOR AND WINDOWS REFERENCE PLANS FOR RATED OPENING TYPES.

### Existing Fire-Rated Assembly Legend

SYMBOL	ASSEMBLY	FIRE RATING	UL LISTING
	REFER TO PARTITION SCHEDULE	(1) HOUR	REFER TO UL DETAIL U309

### Occupancy Load Tabulation

TENANT TOTAL	AREA	NO. OF OCCS.
<b>BUSINESS (B)</b>	<b>22,521 SQ. FT.</b>	<b>289</b>
100 SQ. FT. PER OCCUPANT	7,044 SQ. FT.	71
<b>ASSEMBLY (A)</b>		
15 SQ. FT. PER OCCUPANT	3,263 SQ. FT.	218
<b>STORAGE (S)</b>		
300 SQ. FT. PER OCCUPANT	12,409 SQ. FT.	

TOTAL EGRESS WIDTH REQUIRED = 289 OCC. X 0.2 IN. = 58" MIN.  
 TOTAL EGRESS WIDTH PROVIDED = 4 EXITS = 170"

STAMP

**PRECISION**  
Planning Inc.

planners • engineers • architects • surveyors

400 Pike Boulevard,  
Lawrenceville, Ga 30046  
770.338.6000 • www.ppi.us

**GWINNETT COUNTY  
VOTER REG. AND  
ELEC. RENOVATION**

455 Grayson Hwy  
Lawrenceville, GA 30046

PROJECT

LIFE SAFETY PLAN,  
NOTES AND  
DETAILS

DESIGN	PPI	CHECKED	BKS
DRAWN	MEF	CHECKED	BKS

Date	No.	Description
02-13-19		RELEASED FOR BID

RELEASE

02-13-19	A16-137AGSB	XXX.nvt
DATE	PROJ. NUMBER	FILE NAME

FILE NUMBER

LS2.1