

1 ADA Toe and Knee Clearance

LS1.1 NOT TO SCALE

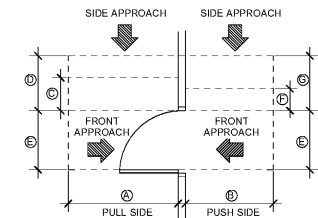

- A) 60" MINIMUM CLEARANCE
- B) 48" MINIMUM CLEARANCE
- C) 18" MINIMUM CLEARANCE FOR FRONT APPROACH
- D) 24" MINIMUM CLEARANCE FOR SIDE APPROACH
- E) 32" MINIMUM CLEARANCE FOR OPENING
- F) 32" MINIMUM CLEARANCE FOR FRONT APPROACH WITH CLOSER
- G) 32" MINIMUM CLEARANCE FOR LATCH APPROACH WITH CLOSER

NOTE: DOORS SHALL COMPLY WITH USDOJ 2010 ADA STANDARDS FOR ACCESSIBLE DESIGN PART 404

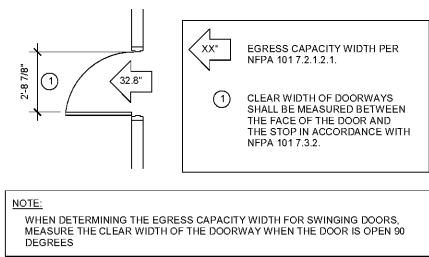

NOTE: WHEN DETERMINING THE EGRESS CAPACITY WIDTH FOR SWINGING DOORS, MEASURE THE CLEAR WIDTH OF THE DOORWAY WHEN THE DOOR IS OPEN 90 DEGREES

3 Swinging Door Egress Capacity

LS1.1 NOT TO SCALE

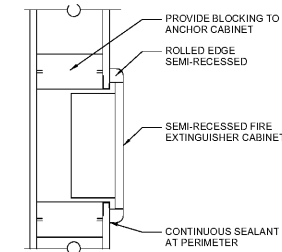
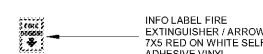

4 Fire Extinguisher Cabinet Detail

LS1.1 NOT TO SCALE

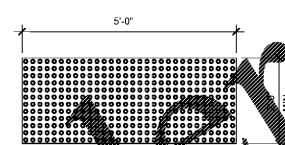

- NOTES:
- TEXTURE SHALL CONTRAST WITH THAT OF THE SURROUNDING SURFACE
 - DETECTABLE WARNING SHALL BE IN COMPLIANCE WITH 2010 ADA STANDARDS FOR ACCESSIBLE DESIGN.
 - DETECTABLE WARNINGS SHALL BE FULLY ADHERED SURFACE MOUNTED WITH ANCHOR BOLTS.

5 Detectable Warning Detail

LS1.1 NOT TO SCALE

Code Review Summary

BUILDING OCCUPANCY:	BUSINESS	(IBC 304.1)
CHANGE OF OCCUPANCY:	NO	
ALLOWABLE HEIGHTS AND AREAS:	40 FT HEIGHT 9,000 SF /STORY (2 STORIES)	(IBC TABLE 503) (IBC TABLE 503)
CONSTRUCTION TYPE:	IIB, SPRINKLERED	(IBC TABLE 503)
REQUIRED PROTECTED ASSEMBLIES:	STRUCTURAL FRAME = 0 HOUR FLOOR CONSTRUCTION = 0 HOURS (INCLUDING SUPPORTING BEAMS AND JOISTS) ROOF CONSTRUCTION = 0 HOUR (INCLUDING SUPPORTING BEAMS AND JOISTS) EXTERIOR BEARING WALLS = 0 HOUR EXTERIOR NON-BEARING WALLS = 0 HOUR INTERIOR BEARING WALLS = 0 HOUR AND PARTITIONS	(IBC TABLE 601) (IBC TABLE 601) (IBC TABLE 601) (IBC TABLE 601) (IBC TABLE 601) (IBC TABLE 601)
RATING EXTERIOR WALL BASED ON FIRE SEPARATION DISTANCE:	LESS THAN 5 FT = 1 HOUR 5 FT TO LESS THAN 10 FT = 1 HOUR 10 FT TO LESS THAN 30 FT = 0 HOUR 30 FT OR GREATER = 0 HOUR	(IBC TABLE 602) (IBC TABLE 602) (IBC TABLE 602) (IBC TABLE 602)
INTERIOR WALLS AND PARTITIONS:	OCCUPANCY SEPARATION = 1 HOUR STORAGE OCCUPANCY SEPARATION = 1 HOUR SHAFT ENCLOSURE = 1 HOUR (UP TO 3 STORIES) 2 HOUR (UP TO 4 STORIES)	(NFPA101 38.3.2.1) (NFPA101 38.3.2.1) (GDL 300-3.6.19)
INTERIOR FINISH REQUIREMENTS:	FLAME SPREAD INDEX EXIT PASSAGEWAYS EXIT ACCESS CORRIDORS ROOMS	B or C B or C A, B or C (IBC TABLE 803.5) (IBC TABLE 803.5) (NFPA101 38.3.3.2)
REQUIRED EXIT CAPACITIES:	0.2 INCHES PER PERSON (LEVEL COMPONENTS) 0.3 INCHES PER PERSON (STAIRS)	(NFPA101 7.3.3.1) (NFPA101 7.3.3.1)
REQUIRED NUMBER OF EXITS:	2 (GENERAL REQUIREMENT)	(NFPA101 7.3.1)
OCCUPANCY LOAD FACTORS:	BUSINESS 100 SF/PERSON	(NFPA101 7.3.1.1)
TRAVEL DISTANCE REQUIREMENTS:	COMMON PATH LIMIT = 75 FT (< 30% OCC. LOAD) DEAD-END LIMIT = 20 FT (< 30% OCC. LOAD) TRAVEL DISTANCE LIMIT = 200 FT (UNOBSTRUCTED)	(NFPA101 38.2.5.3) (NFPA101 38.2.5.3) (NFPA101 38.2.5.6)
SEPARATION OF EXITS:	WHERE TWO EXIT ACCESS DOORS ARE REQUIRED, THEY SHALL BE PLACED AT A DISTANCE FROM ONE ANOTHER NOT LESS THAN ONE-FIFTH THE LENGTH OF THE MAXIMUM OVERALL DIAGONAL DIMENSION OF THE BUILDING OR AREA TO BE SERVED, MEASURED IN A STRAIGHT LINE BETWEEN THE NEAREST EDGE OF THE EXIT DOORS OR EXIT ACCESS DOORS.	
DOOR REQUIREMENTS:	MAXIMUM WIDTH = 48 IN. MINIMUM WIDTH = 32 IN. MINIMUM HEIGHT = 80 IN. CLEAR OPENING = 32 IN. FORCE TO OPEN = 15 LBF. (LATCH RELEASE) 30 LBF. (SET IN MOTION) 15 LBF. (SWING)	(IBC 1008.1.1) (NFPA101 7.2.1.2.3) (IBC 1008.1.1) (IBC 1008.1.1) (NFPA101 7.2.1.4.5) (NFPA101 7.2.1.4.5) (NFPA101 7.2.1.4.5)
CORRIDOR REQUIREMENTS:	WIDTH = 44 IN. MINIMUM HEIGHT = 80 IN. CLEAR RATING = NOT REQUIRED	(IBC 1017.2) (IBC 1017.2) (NFPA101 38.3.6.1)
PORTABLE FIRE EXTINGUISHERS:	75 FT TRAVEL DISTANCE MAX.	(NFPA101)
DETECTION AND NOTIFICATION:	INITIATION: MANUAL FIRE DETECTION SYSTEM NOTIFICATION: NOT REQUIRED	(NFPA101 38.3.4.1)
EMERGENCY EXIT LIGHTING REQUIREMENTS:	10 SECOND DELAY MAX. DURATION = 1 1/2 HOURS MIN.	(NFPA101 7.9.2) (NFPA101 7.9.2)

Code Review Notes

- CONTACT THE GWINNETT COUNTY FIRE MARSHAL'S (INSPECTION REQUEST LINE) AT (678) 518- 6102 FOR INSPECTIONS AT 60%, 80%, AND 100% COMPLETION. NOTE: (50%) INSPECTION OF FLOOR CEILING PENETRATIONS, (80%) INSPECTION OF ANY FIRE RATED BARRIERS, FLOOR OR CEILING, (100%) FINAL INSPECTION: ALL SYSTEMS, EQUIPMENT INSTALLED ANDSD OPERATING, READY FOR OCCUPANCY. THE INSPECTION REQUEST MUST BE PHONED IN BEFORE 2:00 PM THE DAY PRIOR TO THE DATE THE INSPECTION IS NEEDED.
- SWING AND FORCE TO OPEN DOORS SHALL MEET THE REQUIREMENTS OF THE NFPA 101 LIFE SAFETY CODE 2012 EDITION CHAPTER 7-2.1.4.
- EXIT DOORS SHALL NOT BE SUBJECT TO THE USE OF A KEY OR REQUIRE SPECIAL KNOWLEDGE TO OPERATE PER NFPA 101 LIFE SAFETY CODE 2012 EDITION CHAPTER 7-2.1.5.1.
- SIGNS, LOCATION, NUMBER AND SIZE ARE NOT APPROVED UNDER THIS BUILDING PERMIT. A SEPARATE SIGN LOCATION PERMIT IS REQUIRED FOR EACH SIGN.
- ALL CONCEALED INSULATING MATERIALS WITHIN WALL, FLOORS, ROOF AND CEILING CAVITIES SHALL HAVE A FLAME SPREAD INDEX OF LESS THAN 25 AND A SMOKE DEVELOPED INDEX OF LESS THE 450 AS DETERMINED IN ACCORDANCE WITH ASTM E84.
- SELF CLOSING DEVICES SHALL BE PROVIDED ON DOORS IN A MEANS OF EGRESS AND SHALL MEET THE REQUIREMENTS OF THE NFPA 101 LIFE SAFETY CODE 2012 EDITION CHAPTER 7-2.1.8.
- (FIRE EXTINGUISHERS) SHALL BE LOCATED PER THE REQUIREMENTS OF NFPA 101 TABLE 3-2.1 (LOW HAZARD). THE SIZE SHALL BE A MINIMUM OF 2 A 10 BC (REFER TO PLANS) AND SHALL BE INSTALLED AT A MINIMUM OF 5' ABOVE THE FINISHED FLOOR TO THE TOP OF THE HANDLE. 1 REQUIRED PER 3,000 SF, OR 75% OF THE DISCRETE AREA.
- PLANS FOR FIRE PROTECTION SPRINKLER PIPING, INCLUDING COMPLETE SMOKE SUPPORT DETAILS, SHALL BE APPROVED BY THE CHEROKEE COUNTY FIRE MARSHALS OFFICE IN COMPLIANCE WITH SECTION 903 AND NFPA 13 PRIOR TO INSTALLATION. SPRINKLER SCHEDULES SHOWING PIPING LOCATIONS AND HEAD LAYOUT SHALL BE AVAILABLE ON JOB SITE AT ALL TIMES. ANY FIRE SPRINKLER PLAN INCLUDING THESE DOCUMENTS ARE FOR REFERENCE ONLY, NOT FOR PERMIT.
- (COMBUSTIBLE INTERIOR FINISH PRODUCTS) SHALL BE PROVIDED PER THE REQUIREMENTS OF THE RESPECTIVE OCCUPANCY CHAPTER OF THE NFPA 101 LIFE SAFETY CODE 2012 EDITION AND PROVIDE VERIFICATION THE TIME OF FINAL INSPECTION THAT THE PRODUCTS COMPLY WITH THE REQUIREMENTS.
- (EXIT DOORS AND EXTERIOR FACE) HOT WATER AND DRAIN PIPES UNDER LAVATORIES SHALL BE INSULATED OR OTHERWISE CONFIGURED TO PROTECT AGAINST CORROSION THERE SHALL BE NO SHARP OR ABRASIVE SURFACES UNDER LAVATORIES.
- THE FLOOR LEVEL SHALL BE THE SAME ON BOTH SIDES OF THE DOOR. THE ELEVATION SHALL BE MAINTAINED FOR A DISTANCE EQUAL TO THE WIDTH OF THE DOOR LEAF OF THE DOORS NFPA 101 LIFE SAFETY CODE, CHAPTER 7, SECTION 7.2.1.3, 2012 EDITION.
- MECHANICAL HARDWARE SHALL BE PROVIDED FOR ALL EXIT DOORS PER THE REQUIREMENTS OF NFPA 101 LIFE SAFETY CODE CHAPTER 7, SECTION 7.2.1.7, 2012 EDITION.
- EXITS COMPLIING WITH NFPA 101 LIFE SAFETY CODE CHAPTER 7, SECTION 7.10, 2012 EDITION SHALL BE INSTALLED. ADDITIONAL SIGNAGE MAY BE REQUIRED UPON FIELD INSPECTION.
- US DEPARTMENT OF JUSTICE ADA STANDARDS FOR ACCESSIBLE DESIGN- SECTION 404.2.3: CLEAR WIDTH DOOR OPENINGS SHALL PROVIDE A CLEAR WIDTH OF 32 INCHES (815 MM) MINIMUM. CLEAR OPENINGS OF DOORWAYS WITH SWINGING DOORS SHALL BE MEASURED BETWEEN THE FACE OF THE DOOR AND THE STOP, WITH THE DOOR OPEN 90 DEGREES. OPENINGS MORE THAN 24 INCHES (610 MM) DEEP SHALL PROVIDE A CLEAR OPENING OF 36 INCHES (915 MM) MINIMUM. THERE SHALL BE NO PROJECTIONS INTO THE REQUIRED CLEAR OPENING WITHIN LOWER THAN 34 INCHES (865 MM) ABOVE THE FINISH FLOOR OR GROUND. PROJECTIONS INTO THE CLEAR OPENING WITHIN BETWEEN 34 INCHES (865 MM) AND 80 INCHES (2030 MM) ABOVE THE FINISH FLOOR OR GROUND SHALL NOT EXCEED 4 INCHES (100 MM), EXCEPTIONS: 1. IN ALTERATIONS, A PROJECTION OF 5/8 INCH (16 MM) MAXIMUM INTO THE REQUIRED CLEAR WIDTH SHALL BE PERMITTED FOR THE LATCH SIDE STOP.
- US DEPARTMENT OF JUSTICE ADA STANDARDS FOR ACCESSIBLE DESIGN- SECTION 309.4 OPERATION: OPERABLE PARTS SHALL BE OPERABLE WITH ONE HAND AND SHALL NOT REQUIRE TIGHT GRASPING, PINCHING, OR TWISTING OF THE WRIST. THE FORCE REQUIRED TO ACTIVATE OPERABLE PARTS SHALL BE 5 POUNDS (22.2 N) MAXIMUM.
- US DEPARTMENT OF JUSTICE ADA STANDARDS FOR ACCESSIBLE DESIGN- SECTION 703.1 GENERAL: SIGNS SHALL COMPLY WITH 703 WHERE BOTH VISUAL AND TACTILE CHARACTERS ARE REQUIRED. EITHER ONE SIGN WITH BOTH VISUAL AND TACTILE CHARACTERS, OR TWO SEPARATE SIGNS, ONE WITH VISUAL, AND ONE WITH TACTILE CHARACTERS, SHALL BE PROVIDED.
- US DEPARTMENT OF JUSTICE ADA STANDARDS FOR ACCESSIBLE DESIGN- SECTION 211.2 MINIMUM NUMBER: NO FEWER THAN TWO DRINKING FOUNTAINS SHALL BE PROVIDED. ONE DRINKING FOUNTAIN SHALL COMPLY WITH 602.1 THROUGH 602.6 AND ONE DRINKING FOUNTAIN SHALL COMPLY WITH 602.7. EXCEPTION: WHERE A SINGLE DRINKING FOUNTAIN COMPLES WITH 602.1 THROUGH 602.6 AND 602.7, IT SHALL BE PERMITTED TO BE SUBSTITUTED FOR TWO SEPARATE DRINKING FOUNTAINS.
- US DEPARTMENT OF JUSTICE ADA STANDARDS FOR ACCESSIBLE DESIGN- SECTION 307.1 GENERAL: PROTRUDING OBJECTS SHALL COMPLY WITH 307.307.2 PROTRUSION LIMITS: OBJECTS WITH LEADING EDGES MORE THAN 27 INCHES (685 MM) AND NOT MORE THAN 80 INCHES (2030 MM) ABOVE THE FINISH FLOOR OR GROUND SHALL PROTRUDE 4 INCHES (100 MM) MAXIMUM HORIZONTALLY INTO THE CIRCULATION PATH. EXCEPTION: HANDRAILS SHALL BE PERMITTED TO PROTRUDE 4 1/2 INCHES (115 MM) MAXIMUM.
- US DEPARTMENT OF JUSTICE ADA STANDARDS FOR ACCESSIBLE DESIGN- SECTION 702.1 GENERAL: FIRE ALARM SYSTEMS SHALL HAVE PERMANENTLY INSTALLED AUDIBLE AND VISIBLE ALARMS COMPLYING WITH NFPA 72 (2012 EDITION) (INCORPORATED BY REFERENCE, SEE "REFERENCED STANDARDS" IN CHAPTER 1), EXCEPT THAT THE MAXIMUM ALLOWABLE SOUND LEVEL OF AUDIBLE NOTIFICATION APPLIANCES COMPLYING WITH SECTION 4-3.2.1 OF NFPA 72 (1999 EDITION) SHALL HAVE A SOUND LEVEL NO MORE THAN 110 DB AT THE MINIMUM HEARING DISTANCE FROM THE AUDIBLE APPLIANCE. IN ADDITION, ALARMS IN GUEST ROOMS REQUIRED TO PROVIDE COMMUNICATION FEATURES SHALL COMPLY WITH SECTIONS 4-3 AND 4.4 OF NFPA 72 (2012 EDITION) OR SECTIONS 7.4 AND 7.5 OF NFPA 72 (2012 EDITION).
- PASSAGES OF PIPES, CONDUITS, BUS DUCTS, CABLES, WIRES, AIR DUCTS, PNEUMATIC DOORS, AND SIMILAR BUILDING SERVICE EQUIPMENT THROUGH FIRE OR SMOKE BARRIERS SHALL BE PROTECTED WITH A SYSTEM CAPABLE OF MAINTAINING THE FIRE OR SMOKE BARRIER. THIS SYSTEM MUST BE UL APPROVED.
- ALL PENETRATIONS OF A FIRE OR SMOKE BARRIER SHALL BE PROVIDED WITH A LISTED FIRE / SMOKE DAMPER OR THROUGH PENETRATION SYSTEM AS REQUIRED BY NFPA AND IN ACCORDANCE WITH APPROVED UL DESIGNS. ALL SUPPLY DUCTS WITHIN OR THROUGH A RATED ASSEMBLY SHALL BE METAL.
- DOORS SHALL MEET THE REQUIREMENTS OF THE NFPA 101 LIFE SAFETY CODE, CHAPTER 7, SECTION 7.2.1, 2012 EDITION.
- FIRE COMPARTMENTS SHALL BE FORMED WITH FIRE BARRIERS THAT ARE CONTINUOUS FROM OUTSIDE WALL TO OUTSIDE WALL FROM ONE FIRE BARRIER TO ANOTHER OR A COMBINATION THEREOF, INCLUDING CONTINUITY THROUGH ALL CONCEALED SPACES, SUCH AS THOSE FOUND ABOVE A CEILING, INCLUDING INTERSTITIAL SPACES. (NFPA 101 CHAPTER 8 SECTION 8.2.2.2)
- FIRE PARTITIONS SHALL EXTEND FROM THE TOP OF THE FOUNDATION OR FLOOR/CEILING ASSEMBLY BELOW TO THE UNDERSIDE OF THE FLOOR OR ROOF SHEATHING, SLAB OR DECK ABOVE OR TO THE FIRE-RESISTANCE-RATED FLOOR/CEILING OR ROOF/CEILING ASSEMBLY ABOVE, AND SHALL BE SECURELY ATTACHED THERETO. IF THE PARTITIONS ARE NOT CONTINUOUS TO THE SHEATHING, DECK OR SLAB, AND WHERE CONSTRUCTED OF COMBUSTIBLE CONSTRUCTION, THE SPACE BETWEEN THE CEILING AND THE SHEATHING, DECK OR SLAB ABOVE SHALL BE FIREBLOCKED OR DRAFTSTOPPED IN ACCORDANCE WITH SECTIONS 717.2 AND 717.3 AT THE PARTITION LINE. (IBC 2012 EDITION CHAPTER 7 SECTION 708.4)
- SMOKE DETECTORS ARE TO BE INSTALLED PER THE REQUIREMENTS OF THE OCCUPANCY CHAPTER OF NFPA 101 LIFE SAFETY CODE 2012 EDITION.
- CONTRACTOR SHALL PERMANENTLY IDENTIFY ALL FIRE-RESISTANT RATED WALLS (AND CORRESPONDING FIRE RESISTANCE RATING) INCLUDING FIRE BARRIER WALLS, SMOKE BARRIER WALLS, FIRE PARTITIONS, FIRE WALLS AND SHAFT ENCLOSURES EITHER BY INSTALLING SIGNS OR BY STENCILING IN CONCEALED SPACES THE FOLLOWING: (1) HOUR FIRE AND SMOKE BARRIER PROTECT ALL OPENINGS. IDENTIFICATION SHALL BE SPACED NO MORE THAN TWELVE (12) FEET ON CENTER WITH A MINIMUM LETTER SIZE OF TWO (2) INCHES IN HEIGHT ON A CONTRASTING BACKGROUND (IFC SECTION 703.5 OF THE 2012 GA STATE AMENDMENTS).
- AT ALL WALL TO CEILING/ROOF STRUCTURE JOINTS, AT FIRE RATED ASSEMBLIES PROVIDE ACRYLIC FIRE STOP SEALANT - REFER TO SPECIFICATIONS.
- MATERIALS EXPOSED WITHIN PLENUMS ARE REQUIRED TO BE NONCOMBUSTIBLE OR SHALL HAVE A FLAME SPREAD INDEX OF NOT MORE THAN 25 AND A SMOKE DEVELOPED INDEX OF NOT MORE THAN 50 AS DETERMINED IN ACCORDANCE WITH ASTM E 84 EXCEPT FOR TESTED AND LABELED WIRING, FIRE SPRINKLER PIPING, PNEUMATIC TUBING, AND ELECTRICAL EQUIPMENT.
- RECESSED FIXTURES SHALL BE INSTALLED SUCH THAT THE REQUIRED FIRE-RESISTANCE RATING IS NOT REDUCED.
- DURING ITS SWING, ANY DOOR IN A MEANS OF EGRESS SHALL LEAVE NOT LESS THAN ONE-HALF OF THE REQUIRED WIDTH OF AN AISLE, CORRIDOR, PASSAGEWAY, OR LANDING UNOBSTRUCTED AND SHALL NOT PROJECT MORE THAN 7 IN. INTO THE REQUIRED WIDTH OF AN AISLE, PASSAGEWAY, OR LANDING, WHERE FULLY OPEN. DOORS SHALL NOT OPEN DIRECTLY ONTO A STAIR WITHOUT A LANDING. THE LANDING SHALL HAVE A WIDTH NOT LESS THAN THE WIDTH OF THE DOOR. (NFPA 101 CHAPTER 7 SECTION 7.2.1.4.4)

NOTE: THESE DETAILS ARE SCHEMATIC IN NATURE AND ARE INTENDED TO CONVEY CLEARANCE CHARACTERISTICS AND MOUNTING HEIGHTS TO COMPLY WITH 2010 ADA STANDARDS

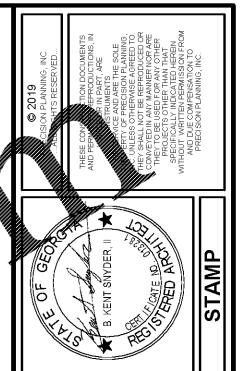

PRECISION Planning Inc.
planners • engineers • architects • surveyors
400 Pike Boulevard,
Lawrenceville, Ga 30046
770.538.6000 • www.ppi.us

GWINNETT COUNTY VOTER REG. AND ELEC. RENOVATION
455 Grayson Hwy
Lawrenceville, GA 30046

LIFE SAFETY AND CODE NOTES	DRAWN	CHECKED	BKS
	PPI	MEF	

Date	No.	Description
02-13-19		RELEASED FOR BID

02-13-19	A16-137AGSB	PROJ. NUMBER	XXX.vvt	FILE NAME	
					FILE NUMBER

LS1.1