

GENERAL NOTES

1. GYPSUM WALLS TO RECEIVE PAINT SHALL HAVE GYPSUM WALLBOARD PRIMER APPLIED PRIOR TO PAINTING
2. GYPSUM FINISH LEVELS SHALL COMPLY WITH GYPSUM ASSOCIATION GA-214
3. LIGHT GAUGE COLD FORMED STEEL MEMBERS SHALL BE FROM ANY STEEL FRAMING INDUSTRY ASSOCIATION (SFA) MEMBER MILL.
 - A. NON-LOAD BEARING METAL FRAMING SHALL BE 20 GA. AT 24" O.C. SPACING
 - B. EXTERIOR AND LOAD BEARING METAL FRAMING SHALL BE 18 GA. AT 18" O.C.
4. GYPSUM WALLBOARD SHALL BE 5/8" THICK, ONLY PRODUCTS FROM A GYPSUM ASSOCIATION MEMBER COMPANY SHALL BE USED.

FLOOR LEGEND

- CONC EXPOSED CONCRETE FLOORING
- CT CERAMIC TILE
- LVP LUXURY VINYL PLANK LAMINATE FLOORING

FLOOR FINISH NOTES

1. G.C. TO INSTALL WHITE FRP BOARD MIN. 6"-8" CENTERED BETWEEN FIXTURES. INSURE ALL EDGES ARE SEALED WITH MANUFACTURES TRIM.
2. G.C. TO INSTALL 4"x4"x5/8" PLYWOOD FOR BATTERY CHARGER CIRCUIT. BOTTOM OF BOARD @ 36" AFF.
3. G.C. TO INSTALL 2x6 PRESSURE TREATED BASE AT PERIMETER OF ROOM.
4. G.C. TO INSTALL 5/8" PLYWOOD ABOVE WOOD BASE TO 8'-0" MIN. OVER GYP. BD.
5. G.C. TO INSTALL 3"x3"x5/8" PLYWOOD IN CORNER. INSTALL 6" BELOW BELOW CEILING PAINT TO MATCH WALL.
6. G.C. TO INSTALL 4" CROWN MOLDING ON ALL SIDES OF T WALL.
7. G.C. TO INSTALL 5/8" PLYWOOD BEHIND GYP. BD. FULL EXTENT OF WALL.
8. G.C. TO INSTALL 2x4 BLOCKING IN ALL PERIMETER WALLS. BLOCKING TO BE 6"-10" AFF TO CENTER.
9. ACCENT WALL WITH SW7036 CITYSCAPE WALL FINISHES - SEE FINISH SCHEDULES BELOW.

WALL TYPE LEGEND

- 6" METAL STUD EXTERIOR WALL - 5/8" OSB SHEATHING ON EXTERIOR FACE OF STUDS - REFER TO EXTERIOR ELEVATIONS FOR FINISH
- HARDCOAT STUCCO WITH BRICK VENEER WAINSCOT BELOW
- METAL STUD FRAMING - SEE GENERAL FINISH NOTES ON SHEET A131
- SOUND ATTENUATION

DIMENSION NOTES

- 3'-0" TO FACE OF STUD
- 3'-0" MIN. MINIMUM DIMENSION ALLOWED (MAY BE MORE)
- 3'-0" MAX. MAXIMUM DIMENSION ALLOWED (MAY BE LESS)
- 3'-0" EXACT DISTANCE BETWEEN FINISHED SURFACES (ALL DIMENSIONS TO FACE OF FRAMING UNLESS OTHERWISE NOTED)
- 3'-0" TARGET DIMENSION WHICH MAY NOT BE ACHIEVED IN FIELD - BE AWARE OF POSSIBLE CHANGE
- ALL DIMENSIONS ON THESE FINISH SURFACES

EXPOSED STRUCTURE PAINT SCHEDULE

ROOM	ITEM	COLOR	SURFACE	PRIMER	# OF COATS	FINISH	# OF COATS
100 SALES	EXPOSED ROOF STRUCTURE	BA202 - TINT TO SW 7036 AESTHETIC WHITE	STL	DTM ACRYLIC PRIMER B06W	1	WATERBORNE ACRYLIC DRYFALL EG-SHEL B42 W 2 TINT	2
100 SALES	EXPOSED HVAC	BA202 - TINT TO SW 7036 AESTHETIC WHITE	ALUM	DTM ACRYLIC PRIMER B06W	1	WATERBORNE ACRYLIC DRYFALL EG-SHEL B42 W 2 TINT	2
100 SALES	EXPOSED HVAC	BA202 - TINT TO SW 7036 AESTHETIC WHITE	ALUM	DTM ACRYLIC PRIMER B06W	1	WATERBORNE ACRYLIC DRYFALL EG-SHEL B42 W 2 TINT	2
100 SALES	EXPOSED HVAC	BA202 - TINT TO SW 7036 AESTHETIC WHITE	STL	DTM ACRYLIC PRIMER B06W	1	WATERBORNE ACRYLIC DRYFALL EG-SHEL B42 W 2 TINT	2

PAINT SCHEDULE

ROOM(S)	LOCATION	COLOR	SURFACE	PRIMER	# OF COATS	FINISH	# OF COATS
100 SALES	ALL WALLS EXCEPT WINDOW WALL AND T-WALL	SW 7036 ACCESSIBLE BEIGE	CMB	ROLLER OR SPRAY USE ORIGINAL PRIMER INTERIOR LATEX B28 W 08000	1	EMERALD INTERIOR LATEX SATN K37 ** EXTRA WHITE BASE	2
100 SALES	ACCENT WALL AND T-WALL	SW 7067 CITYSCAPE	CMB		1	EMERALD INTERIOR LATEX SATN K37 ** DEEP BASE	2
104 OFFICE, 101 MEN, 102 WOMEN	ALL WALLS	SW 7036 ACCESSIBLE BEIGE	CMB	SPRAY ONLY HIGH BUILD INT LTY DRYWALL PRIMER (E207W500)	1	EMERALD INTERIOR LATEX SATN K37 ** EXTRA WHITE BASE	2
105 STOCKROOM	ALL FINISHED DRYWALL	WHITE	CMB		1	PROMAR 200 INTERIOR LATEX EGOSHELL B20 WF 6000	2
100 SALES	DRYWALL CEILING	SW 7036 ACCESSIBLE BEIGE	CMB		1	EMERALD INTERIOR LATEX SATN K37 **	2
AS APPLICABLE	DRYWALL CEILING	WHITE	CMB		1	EMERALD INTERIOR FLAT EXTRA WHITE K32 W 00251 **	2
ALL ROOMS EXCEPT WINDOW WALL AND T-WALL	DOORS AND TRIM	SW 7036 ACCESSIBLE BEIGE	NO	PRERIE WALL AND WOOD INT OIL PRIMER B49W2	1	PROCLASSIC WATERBORNE INTERIOR ACRYLIC SEMI-GLOSS ENAMEL B31 W 1150	2
100 SALES	WINDOW WALL WINDOW TRIM AND T-WALL CROWN MOLDING	SW 7036 AESTHETIC WHITE	NO	IF NOT FACTORY PRIMED, USE STEEL - KEM KROMK PRIMER ALUM - DTW WASH PRIMER	1	PROCLASSIC WATERBORNE INTERIOR ACRYLIC SEMI-GLOSS ENAMEL B31 W 1150	2
105 STOCKROOM	EXIT AND RECEIVING DOORS INSIDE AND OUTSIDE	MATCH EXTERIOR BUILDING	MTL	IF NOT FACTORY PRIMED, USE STEEL - KEM KROMK PRIMER ALUM - DTW WASH PRIMER	1	INDUSTRIAL ENAMEL B54 - CUSTOM MATCH TO BUILDING EXTERIOR	2
103 STAGING	CONCRETE FLOOR	HAZE GRAY	CONCRETE			BESAGO - ARMORSEAL / RESINANE URETHANE FLOOR COATING*	2
105 STOCKROOM	CONCRETE FLOOR	HAZE GRAY	CONCRETE			BESAGO - ARMORSEAL / RESINANE URETHANE FLOOR COATING*	2

* MAY APPLY FIRST COAT WITH UP TO 10% REDUCTION USING RTKES. ADD H3C SHARK-GRP IN SECOND COAT AS ANTI-SHED ADDITIVE.
 ** FOR EMERALD PRODUCTS USE ONLY ONE OF THESE ROLLER COVERS, SW 3/8" CONTRACT SERIES 100X POLYESTER OR FURDY 3/8" WHITE DOVE.

FINISH SCHEDULE

MARK	MATERIAL	MANUFACTURE	STYLE/COLOR	REMARKS
ACT	ACOUSTIC CEILING TILE	USG	FSURED 2x2 TILE WITH SLANT EDGE, #506 WITH DA/DXL GRID	GRID AND TILE TO BE WHITE
CONC	CONCRETE (PAINTED)		EXPOSED CONCRETE	SEE PAINT SCHEDULE FOR FINISH COLOR
CT	CERAMIC TILE	DALRE	SALERNO ORIGO PERLA #EL84	12"x12" CERAMIC TILE AND 3"x12" BULLINGS CAP. GROUT: LATICRETE #865 BOLORIAN GRAY
LVP	LUXURY VINYL PLANK LAMINATE FLOORING	MANNINGTON	NATURES PATH HERITAGE CHERRY 12103	LAY IN RANDOM PATTERN; OWNER SUPPLIED, G.C. INSTALLED
PLM	PLASTIC LAMINATE	WILSON ART	LUMBER MAPLE 10734-60	PLAN FOR BUILT-IN DESKTOP AND SHELF
VCB	VINYL COVE BASE	MANNINGTON	907-4CL STONE GRAY	4" HEIGHT; OWNER SUPPLIED, G.C. INSTALLED
VCT	VINYL TILE	MANNINGTON	PROGRESSIONS 55131 OYSTER WHITE	LAY IN CHECKERBOARD PATTERN; USE MANNINGTON V-11 ADHESIVE

ROOM FINISH SCHEDULE

ROOM	FLOOR	BASE	CEILING		REMARKS
			MATERIAL	HEIGHT	
100 SALES	LVP AND VCT	VCB			SEE FINISH PLAN; USE VINYL TRANSITION STRIPS AT CONCRETE
103 STAGING	PAINTED CONCRETE	VCB	2x2 ACT	10'-0"	INCLUDE BATT INSULATION FOR NOISE CONTROL. USE VINYL TRANSITION STRIPS AT CONCRETE
104 OFFICE	VCT	VCB	2x2 ACT	8'-0"	INCLUDE BATT INSULATION FOR NOISE CONTROL
101 MEN	CT	CT	2x2 ACT	8'-0"	INCLUDE CERAMIC WAINSCOT TO 63" AFF; INCLUDE BATT INSULATION FOR NOISE CONTROL
102 WOMEN	CT	CT	2x2 ACT	8'-0"	INCLUDE CERAMIC WAINSCOT TO 63" AFF; INCLUDE BATT INSULATION FOR NOISE CONTROL
105 STOCKROOM	PAINTED CONCRETE	2x6 PRESSURE TREATED WD			PAINT ALL WALLS AND DOORS; PLYWOOD PROTECTION TO 8'-0" AFF ABOVE BASE ON ALL WALLS

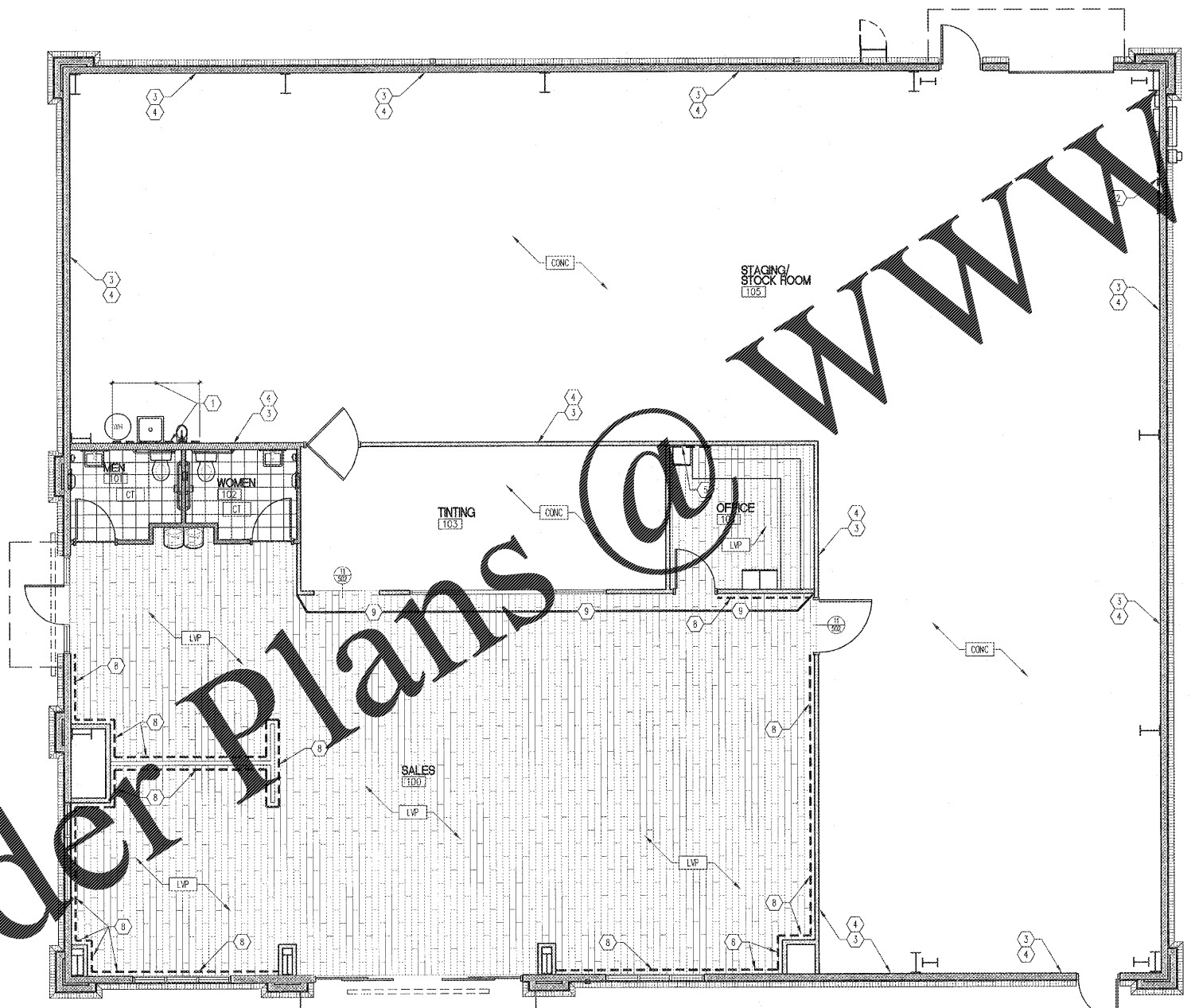

1 FLOOR FINISH PLAN
 SCALE: 3/16" = 1'-0"

Order Plans @ www.LDOnline.com



PROJECT: SHERWIN WILLIAMS
 1880 GADSDEN HIGHWAY
 TRUSSVILLE, AL 35225
 DRAWING: FINISH FLOOR PLAN

Revisions

REVISION DATE

PROJECT DATE: 1/17/2019
 Drawn By: MTP
 Checked By: TD
 Sheet No: A131